

29 June 2018

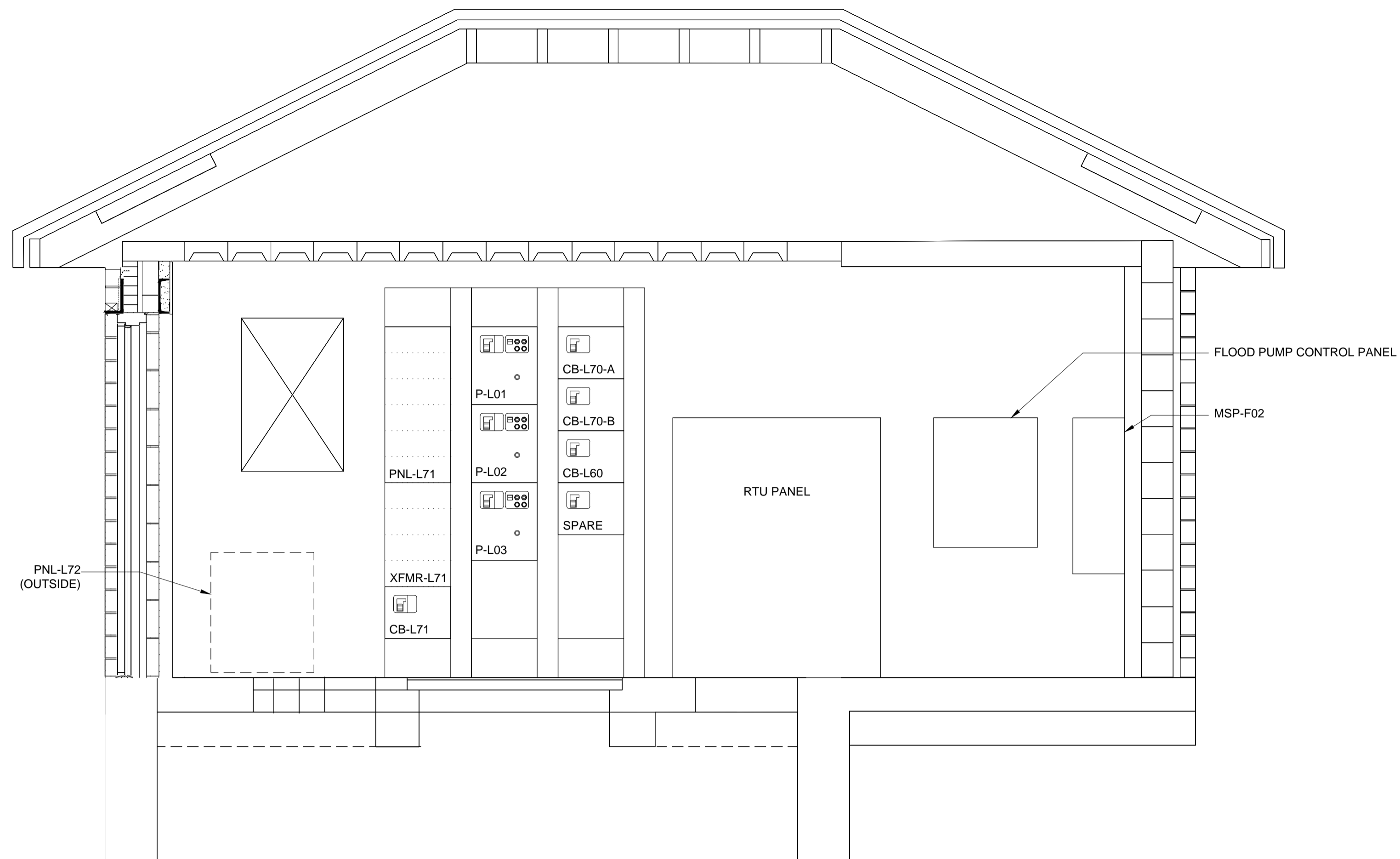

PANEL PNL-L71									
CCT NO	DESCRIPTION	LOAD	TRIP AMPS	N ABC	TRIP AMPS	LOAD	DESCRIPTION	CCT NO	
01			15		15		MAIN FLOOR RECEPT.	02	
03	UH-L60-1		3P		15		MAIN FLOOR LIGHTING	04	
05					15		2ND FLOOR RECEPT.	06	
07					15		2ND FLOOR LIGHTING	08	
09	UH-L60-2		15		15		COMM. ROOM RECEPT.	10	
11			3P		15		COMM. ROOM LIGHTING	12	
13	HVAC CONTROLLER		15		15		MOTOR ROOM RECEPT.	14	
15	RTU CONTROL PANEL		15		15		MOTOR ROOM LIGHTING	16	
17	PUMP ROOM SUMP PUMP P-L04		15		15		PUMP ROOM RECEPT.	18	
19	COMM ROOM SUMP PUMP P-L05		15		15		PUMP ROOM LIGHTING	20	
21	SF-L61		15		15		SPACE	22	
23			2P		15		SPACE	24	
25							SPACE	26	
27	UH-L60-3		15				SPACE	28	
29			3P				SPACE	30	
31	EF-L61		15				SPACE	32	
33			2P				SPACE	34	
35	SPACE						SPACE	36	
37	SPACE						SPACE	38	
39	SPACE						SPACE	40	
41	SPACE						SPACE	42	

VOLTAGE: 120/208V      PHASE: 3      WIRE: 4      BREAKER I.C.: 10 kA  
 MAIN BREAKER:      MAINS: 100A      FEEDER:  
 MOUNTING:      LOCATION:  
 FED FROM:  
 NOTES:

**A SECTION**  
E-04 1:25

**NOTE**

1. PROVIDE AND INSTALL ONE SPARE MCC BUCKET COMPLETE WITH 15 AMP 3 POLE CIRCUIT BREAKER.

**NOT FOR CONSTRUCTION**



		ENGINEER'S SEAL  CONSULTANT PROJECT NUMBER <b>18-6936</b>		
			<b>HAWTHORNE WASTEWATER PUMPING STATION UPGRADES</b>	
DESIGNED BY: B.B.	CHECKED BY: B.L.M.	CITY DRAWING NUMBER: 1-0145L-E0008-001		CONSULTANT DRAWING NUMBER: E-05
DRAWN BY: S.C.K.	APPROVED BY: MH	SHEET 19 OF 21		
HOR. SCALE: AS SHOWN	RELEASED FOR CONSTRUCTION: DATE	ELECTRICAL - SECTIONS AND SCHEDULES		
VERTICAL: AS SHOWN	DATE: June 2018			
NO. REVISIONS	DATE BY			
0 ISSUED FOR TENDER	06/29/18 BLM			

186936-E-105.dwg