

### GENERAL NOTES

1. ROOF SECTION 2 AREA = 125 FT<sup>2</sup> [12 m<sup>2</sup>]
2. NEW ROOF COMPOSITION:
  - EXISTING WOOD DECK
  - NEW DENSDECK
  - NEW VAPOUR BARRIER
  - NEW SLOPED POLYISO INSULATION
  - NEW SBS COMPOSITE PANEL
  - NEW SBS CAP SHEET
3. ROOF SECTION 3 AREA = 100 FT<sup>2</sup> [9 m<sup>2</sup>]
4. NEW ROOF COMPOSITION:
  - EXISTING CONCRETE DECK
  - NEW VAPOUR BARRIER
  - NEW SLOPED POLYISO INSULATION
  - NEW SBS COMPOSITE PANEL
  - NEW SBS CAP SHEET

### LEGEND

- ROOF EDGE
- = ROOF PARAPET
- - - GUTTER EDGE
- HIGH
- - - LOW
- - - ADJACENT ROOF EDGE
- - - HIP/RIDGE
- - - VALLEY
- FENCE
- DRAINAGE ROOF SCUPPER
- INTERNAL ROOF DRAIN AND SUMP

### KEY PLAN

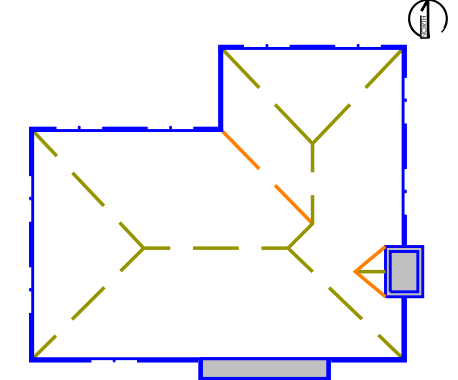

RMIS ENGINEERING



389 MAXWELL CRESCENT  
Regina, SK S4N 5X9  
www.rmiseng.ca  
Phone 306.352.4606  
Fax 306.352.4607



WESTWOOD LIBRARY  
C.13.MB.35-18.02.03

66 ALLARD AVENUE  
WINNIPEG, MB R3K 0T3

CITY OF WINNIPEG

4TH FLOOR - 185 KING STREET  
WINNIPEG, MB R3B 1J1

No.	DATE	DESCRIPTION

DESIGNED BY SMC 04/27/2018  
DRAWN BY SED 04/27/2018  
REVIEWED BY SMC 05/03/2018

ROOF SECTION 2 & 3  
PLAN

**A 1.04**