

NOTE: CHAINAGES SHOWN ARE ALONG  $\phi$  OF FIFE STREET

FIFE STREET

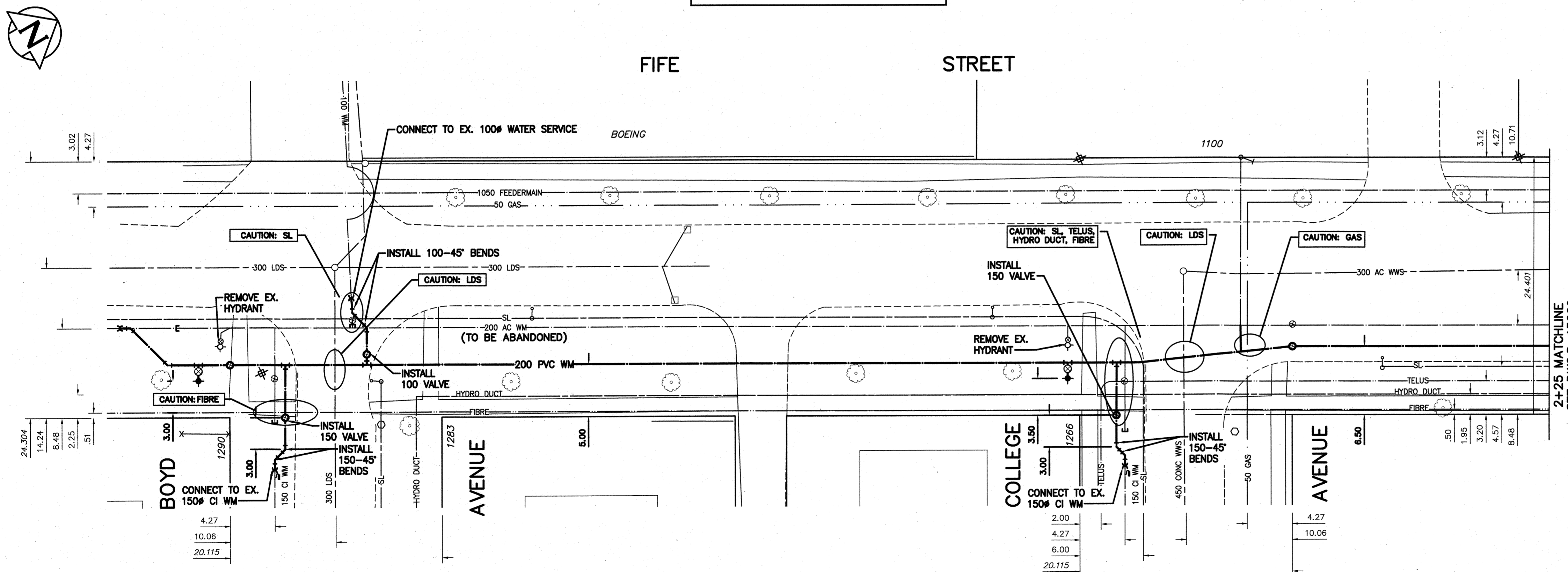

WATER SERVICE TABLE

ADDRESS	PIPE SIZE & MATERIAL (STREET)	PIPE SIZE & MATERIAL (PROP.)	SHORT & LONG MEASUREMENT	CORP. LOCATION	REMARKS
1100 FIFE ST	25	-	15.54 NSL COLLEGE AV	OPP SC	RECONNECT SERVICE
COMMERCIAL	COPPER	-	-	-	-
1290 BOYD AV	20	20	8.08 EWBL	1.37 W SC	OUTSIDE LIMITS
COMMERCIAL	COPPER	COPPER	16.00 EEL FIFE ST	-	-
1283 BOYD	-	-	-	-	OUTSIDE LIMITS
COMMERCIAL	-	-	-	-	-
1266 COLLEGE AV	38	38	13.56 WEBL	OPP SC	OUTSIDE LIMITS
RESIDENTIAL	COPPER	COPPER	24.38 EEL FIFE ST	-	-

NOTE: VALVES TO BE INSTALLED COUNTERCLOCKWISE TO CLOSE

METRIC  
WHOLE NUMBERS INDICATE MILLIMETRES  
DECIMALIZED NUMBERS INDICATE METRES



**ENGINEERS GEOSCIENTISTS MANITOBA**  
Certificate of Authorization  
Stantec Consulting Ltd.  
No. 1301

LOCATION APPROVED  
UNDERGROUND STRUCTURES

SUPV. U/G STRUCTURES COMMITTEE DATE  
NOTE:  
LOCATION OF UNDERGROUND STRUCTURES AS SHOWN ARE BASED ON THE BEST INFORMATION AVAILABLE BUT NO GUARANTEE IS GIVEN THAT ALL EXISTING UTILITIES ARE SHOWN OR THAT THE GIVEN LOCATIONS ARE EXACT. CONFIRMATION OF EXISTENCE AND EXACT LOCATION OF ALL UTILITIES MUST BE OBTAINED FROM THE INDIVIDUAL UTILITIES BEFORE PROCEEDING WITH CONSTRUCTION.

B.M. 26-24  
ELEV. 231.334 m  
654535 - Burrows Ave. & Charles St. intersection in median, Tabl. in 7.6 m Conc. pile, 13.7 m N. of S.L. of Burrows Ave. & 5.2 m E. of W.L. of Charles St.



DESIGNED BY RS CHECKED BY WB  
DRAWN BY SG APPROVED BY RS  
SCALE:  
HORIZONTAL 1:250  
VERTICAL 1:50  
DATE 2018 02 06  
PLOT DATE: 2018 03 16

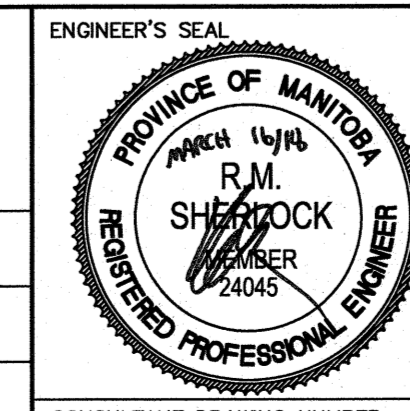

CONSULTANT DRAWING NUMBER  
C-207

**THE CITY OF WINNIPEG**  
WATER AND WASTE DEPARTMENT  
ENGINEERING DIVISION

2018 WATERMAIN RENEWALS  
CONTRACT 4  
FIFE STREET  
BOYD AVENUE TO  
125 NSL BOYD AVENUE

SHEET 9 OF 11  
CITY DRAWING NUMBER  
D-15008