

NOTE: CHAINAGES SHOWN ARE ALONG ϕ OF JEFFERSON AVENUE

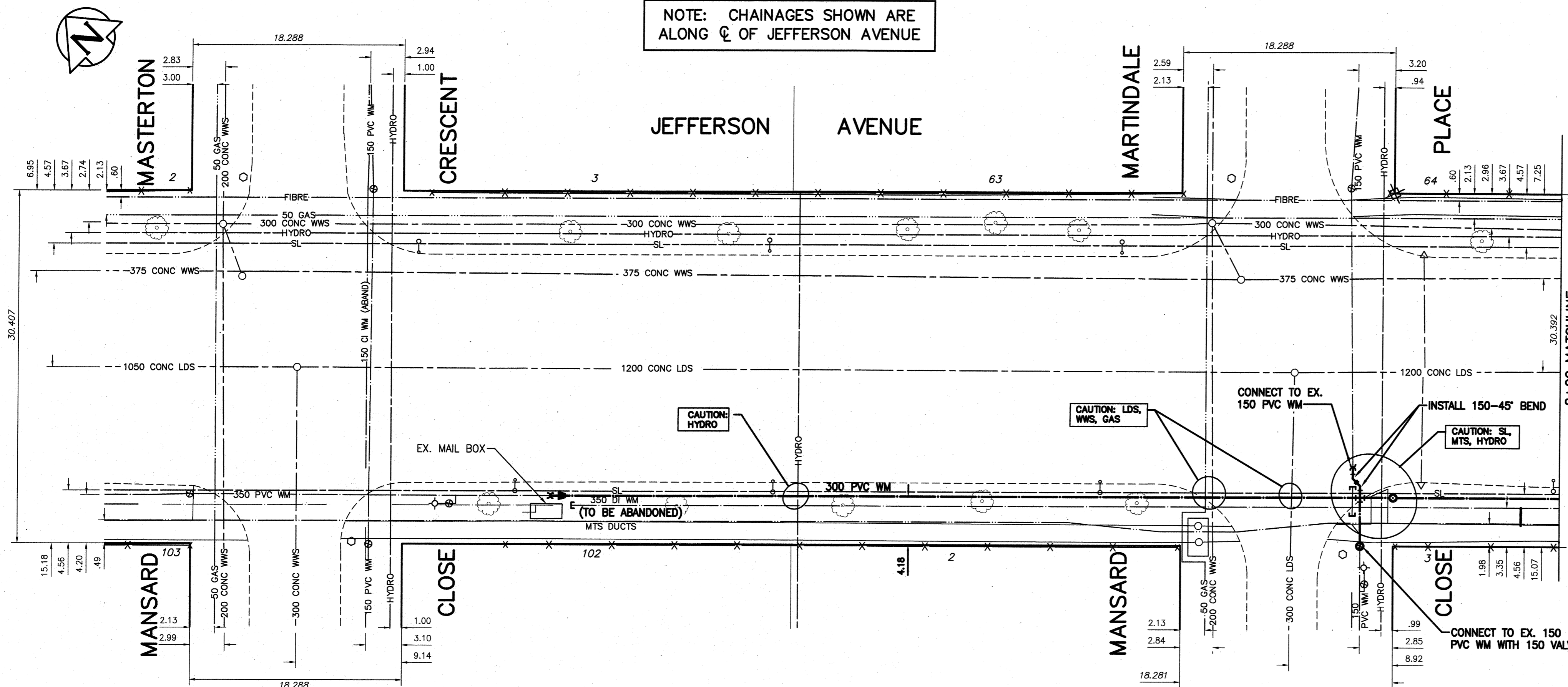

ADDRESS	PIPE SIZE & MATERIAL (STREET)	PIPE SIZE & MATERIAL (PROP.)	SHORT & LONG MEASUREMENT	CORP. LOCATION	REMARKS
3 MASTERTON RESIDENTIAL	20 COPPER	20 COPPER	6.10 S/NBL 9.00 S/NBL	1.00 N S/C	OUTSIDE LIMITS
63 MARTINDALE RESIDENTIAL	20 COPPER	-	6.88 N SHL 10.06 NBL JEFFERSON	0.03 S S/C	OUTSIDE LIMITS
102 MANSARD RESIDENTIAL	-	-	6.10 SNL HOUSE 9.85 SSL JEFFERSON	-	OUTSIDE LIMITS
2 MANSARD RESIDENTIAL	20 COPPER	-	8.08 SNL HOUSE 9.50 SSL JEFFERSON	0.26 N OF S/C	OUTSIDE LIMITS

NOTE: VALVES TO BE INSTALLED CLOCKWISE TO CLOSE

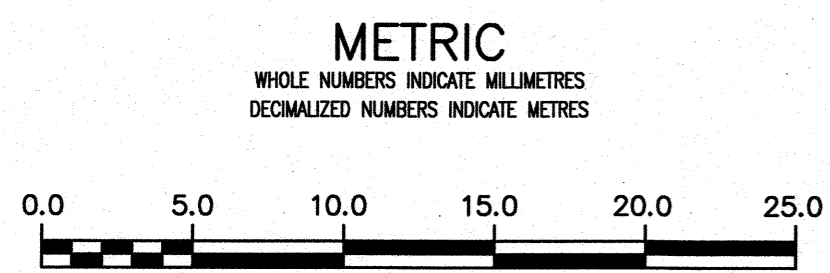

ENGINEERS GEOSCIENTISTS MANITOBA
Certificate of Authorization
Stantec Consulting Ltd.
No. 1301

LOCATION APPROVED UNDERGROUND STRUCTURES

SUPV. U/G STRUCTURES COMMITTEE DATE

NOTE: LOCATION OF UNDERGROUND STRUCTURES AS SHOWN ARE BASED ON THE BEST INFORMATION AVAILABLE BUT NO GUARANTEE IS GIVEN THAT ALL EXISTING UTILITIES ARE SHOWN OR THAT THE GIVEN LOCATIONS ARE EXACT. CONFIRMATION OF EXISTENCE AND EXACT LOCATION OF ALL SERVICES MUST BE OBTAINED FROM THE INDIVIDUAL UTILITIES BEFORE PROCEEDING WITH CONSTRUCTION.

B.M. 14-6	S.W. Cor. McPhillips St. & Stardust Ave., Tbt. in N. Conc. foundation No.
ELEV. 232.126 m	2100 McPhillips St., 3 m E. & 0.1 m below brick of N.W. Cor. of Bldg.

DESIGNED BY	RS	CHECKED BY	WB
DRAWN BY	SG	APPROVED BY	RS
SCALE:	HORIZONTAL 1:250	RELEASED FOR CONSTRUCTION	DATE 3/16/19
	VERTICAL 1:50		
DATE	2018 02 06		
PLOT DATE:	2018 03 15		

Stantec

ENGINEER'S SEAL
PROVINCE OF MANITOBA
MARCH 16/19
JRM
SWEETLOCK
MEMBER
24045
REGISTERED PROFESSIONAL ENGINEER

THE CITY OF WINNIPEG
WATER AND WASTE DEPARTMENT
ENGINEERING DIVISION

2018 WATERMAIN RENEWALS
CONTRACT 4
JEFFERSON AVENUE
MANSARD CLOSE TO
100 EEL MANSARD CLOSE

SHEET 5 OF 11
CITY DRAWING NUMBER
D-15004

CONSULTANT DRAWING NUMBER
C-203