

235.20
234.80
234.40
234.00
233.60
233.20

235.20
234.80
234.40
234.00
233.60
233.20

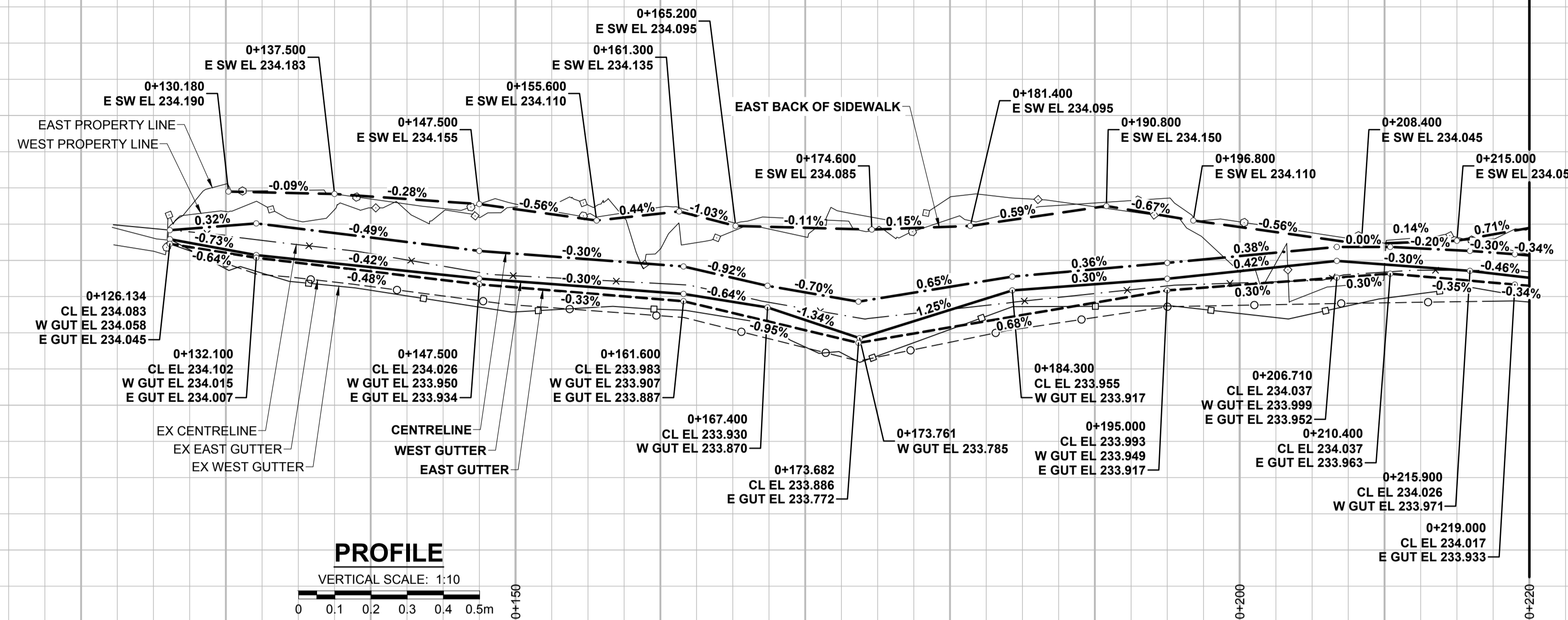

NOTES

1. ADJUST MH AND CB RIMS TO NEW GRADES.
2. LAMP STANDARDS, HYDRO POLES, AND ANCHORS THAT REQUIRE TEMPORARY SUPPORT, REMOVAL OR REPLACEMENT, TO BE DONE SO AT THE EXPENSE OF THE CONTRACTOR AS NECESSARY.
3. CONTRACTOR TO REGRADE/RENEW EXISTING PRIVATE SIDEWALKS TO LIMITS AS SHOWN. SIDEWALKS TO BE RENEWED WITH CONCRETE UNLESS NOTED OTHERWISE.
4. CONTRACTOR TO TAKE PRECAUTIONARY STEPS TO PROTECT EXISTING TREES WITHIN THE LIMITS OF CONSTRUCTION FROM DAMAGE FROM CONSTRUCTION ACTIVITIES AS OUTLINED IN THE SPECIFICATIONS.
5. CONTRACTOR TO CONFIRM THE LOCATION OF ALL UTILITIES/SERVICES IN THE FIELD PRIOR TO CONSTRUCTION.
6. MODIFIED BARRIER CURB TO BE USED AT ALL INTERSECTION RADI, BACK LANE RADI AND BULLNOSES.
7. CONTRACTOR TO OVERLAY DRIVEWAYS TO ENSURE POSITIVE DRAINAGE TO NEW STREET GRADES. FINAL LIMITS TO BE DETERMINED IN THE FIELD BY CONTRACT ADMINISTRATOR.
8. CB SD-023 & SD-024 OFFSETS ARE DIMENSIONED TO BOC. CB SD-025 OFFSETS ARE DIMENSIONED OIC.
9. REFER TO BID OPPORTUNITY FOR DETAILS REGARDING TRAFFIC MANAGEMENT.
10. ADD 200.000 m TO ABBREVIATED ELEVATIONS TO OBTAIN GEODETIC ELEVATIONS.

CHAINAGE ALONG C PAVEMENT

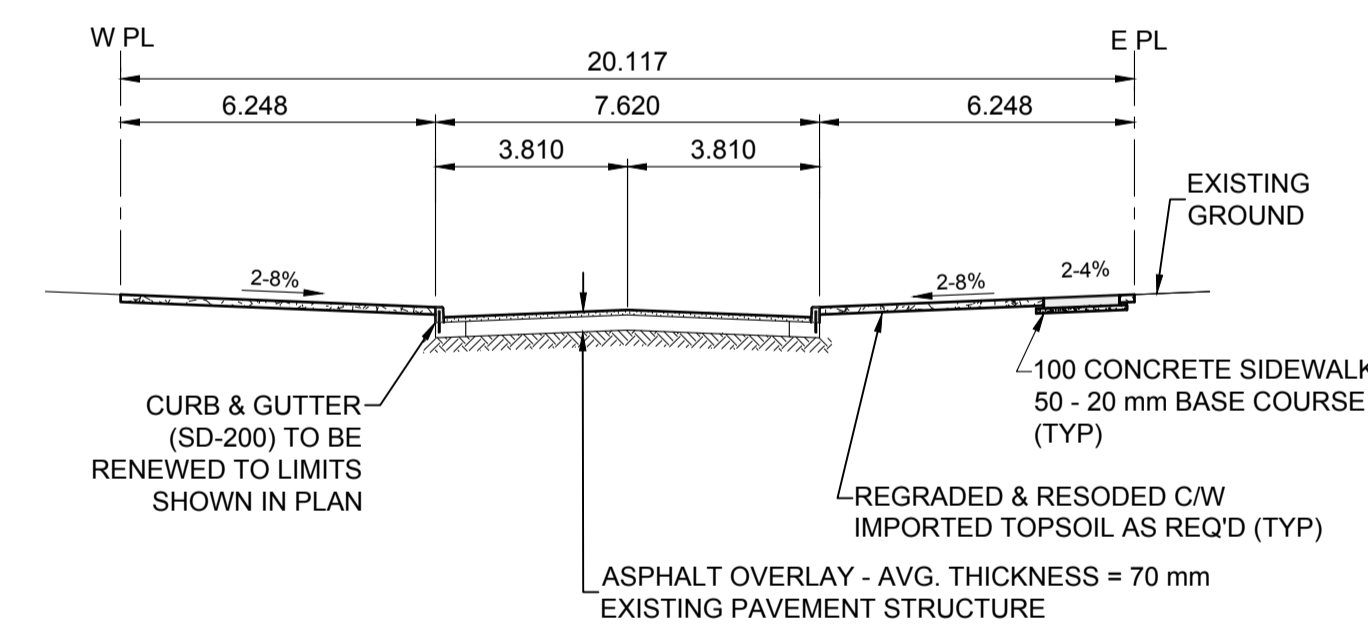
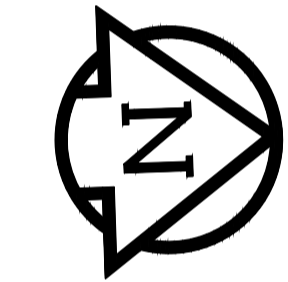
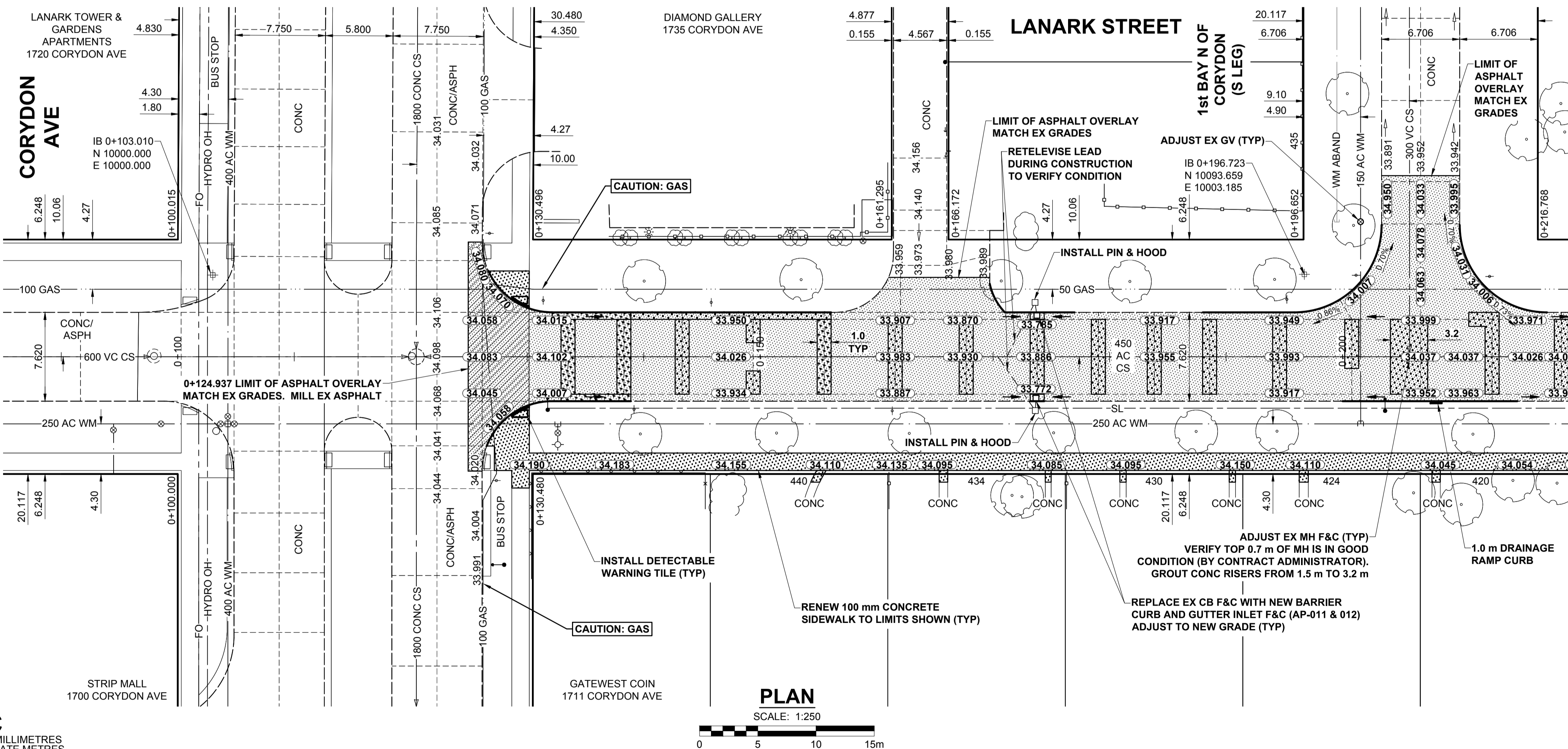

METRIC

WHOLE NUMBERS INDICATE MILLIMETRES
DECIMALIZED NUMBERS INDICATE METRES

EXISTING	LEGEND - PLAN	NEW	EXISTING	LEGEND - PLAN	NEW	EXISTING	LEGEND - PLAN	NEW	
	GAS		MANHOLE		CONCRETE PAVEMENT		CATCH BASIN/CATCH PIT		CONC SIDEWALK/MEDIAN
	MTS HANDWELL/PEDESTAL		CATCH BASIN/CATCH PIT		ASPHALT PAVEMENT		TREE		PAVING STONE
	HYDRO HANDWELL/CABINET		PROPERTY LINE		GRAVEL		TEST HOLE		RAMP CURB
	CATV/FIBRE OPTIC		SURVEY BAR		PLANING/REMOVAL		FENCE		
	TRAFFIC SIGNALS/PIT		BOC/EDGE OF PAVEMENT				ELEVATION (33.333)		
	LAND DRAINAGE SEWER		TRAFFIC SIGN						
	SANITARY/COMBINED SEWER								
	CB LEAD/SSP/DCP								
	WATERMAIN								
	SUBDRAIN								
	DITCH								

LOCATION APPROVED UNDERGROUND STRUCTURES

DATE: _____
 SURF. UTIL. STRUCTURES COMMITTEE: _____
 NOTE: LOCATION OF UNDERGROUND STRUCTURES AS SHOWN ARE BASED ON THE BEST INFORMATION AVAILABLE BUT NO GUARANTEE IS GIVEN THAT ALL EXISTING UTILITIES ARE SHOWN OR THAT THE GIVEN LOCATIONS ARE EXACT. CONFIRMATION OF EXISTENCE AND EXACT LOCATION OF ALL SERVICES MUST BE OBTAINED FROM THE INDIVIDUAL UTILITIES BEFORE PROCEEDING WITH CONSTRUCTION.

51-033	S.W. Cor. Grosvenor Ave. & Lanark St. Tbt. in E. Conc. foundation of Westworth United Church, 7.0 m N. & 0.2 m below brick from the S.E. Cor. of Bldg.
ELEV 234.661 m	



DESIGNED BY	RPB	CHECKED BY	WRJ
DRAWN BY	KMB	APPROVED BY	BWB
RELEASED FOR CONSTRUCTION			
DATE	18/01/26	DATE	

PROFESSIONAL'S SEAL
PRELIMINARY DRAWING
 NOT TO BE USED FOR CONSTRUCTION
 CONSULTANT FILE NAME
 1700095-Lanark-PP-01.dwg

THE CITY OF WINNIPEG
 PUBLIC WORKS DEPARTMENT
 ENGINEERING DIVISION

2018 LOCAL STREETS PACKAGE
LANARK STREET
 CORYDON AVE TO GROSVENOR AVE
 REHABILITATION
 PAVING AND GRADING
 CORYDON AVE TO STA 0+220

CITY DRAWING NUMBER: N/A
 SHEET 2 OF 25
 DRAWING No. **2**

BID OPPORTUNITY No. 127-2018



Certificate of Authorization MORRISON HERSHFIELD No. 1736