

- NOTES**
- ADJUST MH AND CB RIMS TO NEW GRADES.
 - LAMP STANDARDS, HYDRO POLES, AND ANCHORS THAT REQUIRE TEMPORARY SUPPORT, REMOVAL OR REPLACEMENT, TO BE DONE SO AT THE EXPENSE OF THE CONTRACTOR AS NECESSARY.
 - CONTRACTOR TO REGRADE/RENEW EXISTING PRIVATE SIDEWALKS TO LIMITS AS SHOWN. SIDEWALKS TO BE RENEWED WITH CONCRETE UNLESS NOTED OTHERWISE.
 - CONTRACTOR TO TAKE PRECAUTIONARY STEPS TO PROTECT EXISTING TREES WITHIN THE LIMITS OF CONSTRUCTION FROM DAMAGE FROM CONSTRUCTION ACTIVITIES AS OUTLINED IN THE SPECIFICATIONS.
 - CONTRACTOR TO CONFIRM THE LOCATION OF ALL UTILITIES/SERVICES IN THE FIELD PRIOR TO CONSTRUCTION.
 - MODIFIED BARRIER CURB TO BE USED AT ALL INTERSECTION RADII, BACK LANE RADII AND BULLNOSES.
 - CONTRACTOR TO OVERLAY DRIVEWAYS TO ENSURE POSITIVE DRAINAGE TO NEW STREET GRADES. FINAL LIMITS TO BE DETERMINED IN THE FIELD BY CONTRACT ADMINISTRATOR.
 - CB SD-023 & SD-024 OFFSETS ARE DIMENSIONED TO BOC. CB SD-025 OFFSETS ARE DIMENSIONED O/C.
 - REFER TO BID OPPORTUNITY FOR DETAILS REGARDING TRAFFIC MANAGEMENT.
 - ADD 200.000 m TO ABBREVIATED ELEVATIONS TO OBTAIN GEODETIC ELEVATIONS.

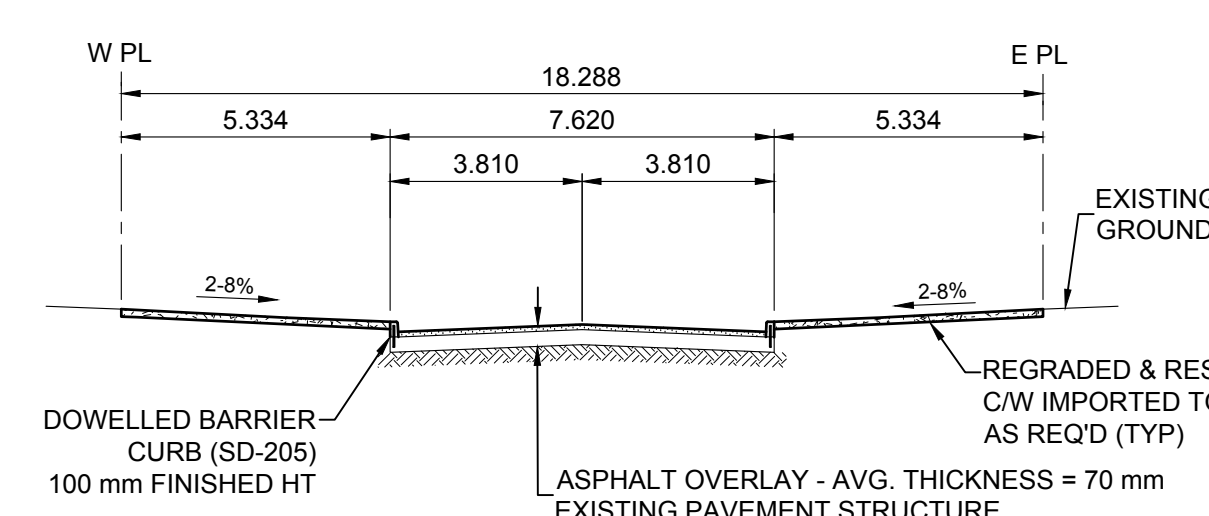
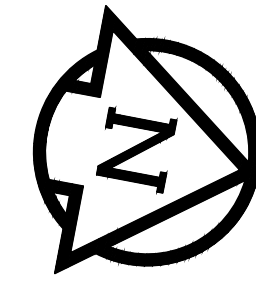
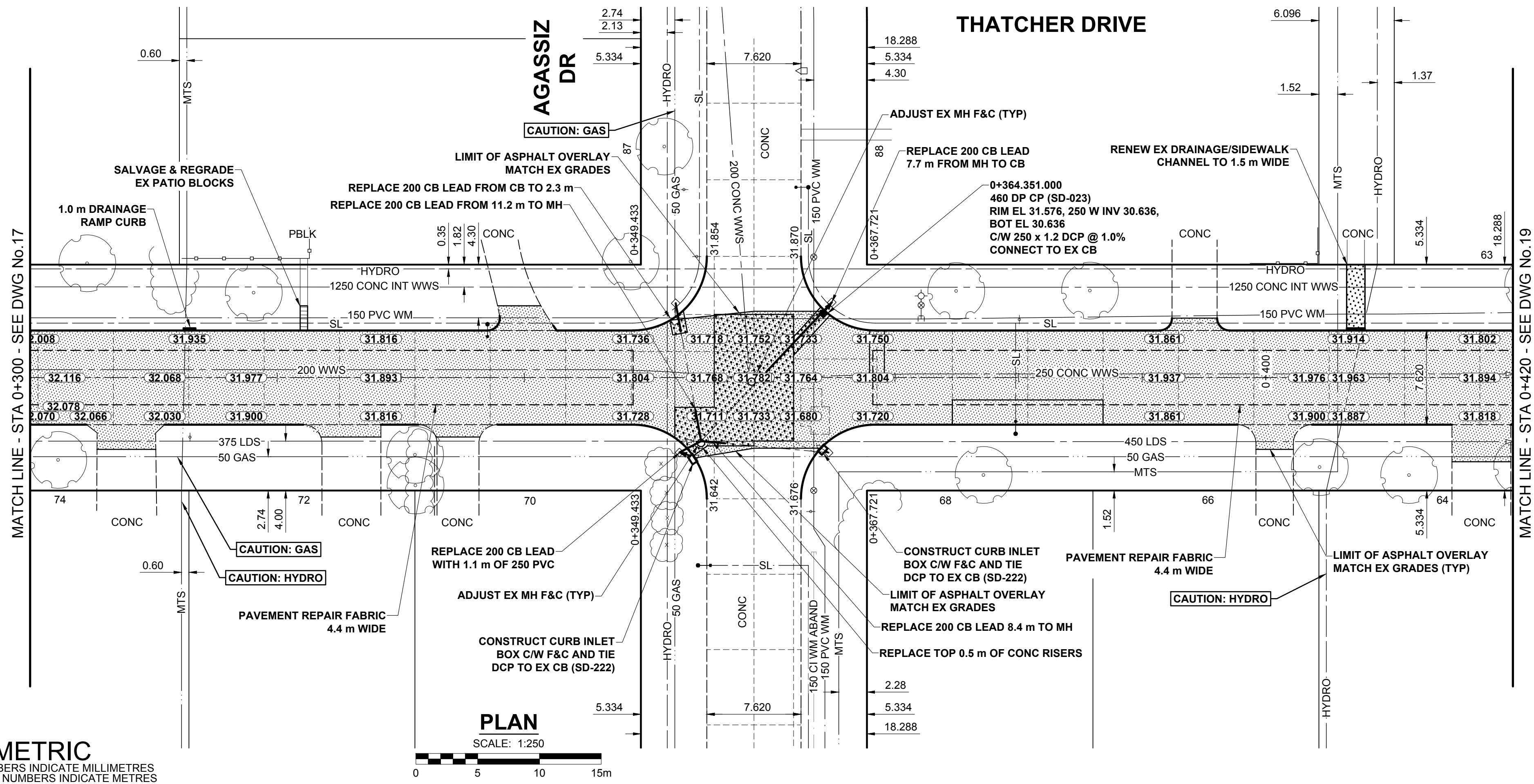

TYPICAL PAVEMENT SECTION
 ASPHALT REHABILITATION
 SCALE: NTS

METRIC
 WHOLE NUMBERS INDICATE MILLIMETRES
 DECIMALIZED NUMBERS INDICATE METRES

---	GAS	○	MANHOLE	●	CONCRETE PAVEMENT	□	LOCATION APPROVED UNDERGROUND STRUCTURES
---	MTS HANDWELL/PEDESTAL	□	CATCH BASIN/CATCH PIT	■	CONC SIDEWALK/MEDIAN	□	DATE
---	HYDRO HANDWELL/CABINET	△	CURB INLET WITH BOX	▲	ASPHALT PAVEMENT	□	COMMITTEE
---	CATV/FIBRE OPTIC	○	TREE	○	PAVING STONE	□	DATE
---	TRAFFIC SIGNALS/PIT	○	TH-12 TEST HOLE	○	GRAVEL	□	NOTE:
---	LAND DRAINAGE SEWER	---	PROPERTY LINE	---	RAMP CURB	---	LOCATION OF UNDERGROUND STRUCTURES AS SHOWN ARE BASED ON THE BEST INFORMATION AVAILABLE BUT NO GUARANTEE IS GIVEN THAT ALL EXISTING UTILITIES ARE SHOWN OR THAT THE GIVEN LOCATIONS ARE EXACT. CONFIRMATION OF EXISTENCE AND EXACT LOCATION OF ALL SERVICES MUST BE OBTAINED FROM THE INDIVIDUAL UTILITIES BEFORE PROCEEDING WITH CONSTRUCTION.
---	SANITARY/COMBINED SEWER	---	SURVEY BAR	---	PLANING/REMOVAL	---	
---	CB LEAD/SSP/DCP	---	FENCE	---		---	
---	WATERMAIN	---	BOC/EDGE OF PAVEMENT	---		---	
---	SUBDRAIN	---	ELEVATION (33.333)	---		---	
---	DITCH	---	TRAFFIC SIGN	---		---	
---	EXISTING	---	LEGEND - PLAN	---		---	
---	NEW	---	EXISTING	---		---	
---	NEW	---	LEGEND - PLAN	---		---	
---	NEW	---	LEGEND - PLAN	---		---	

LOCATION APPROVED UNDERGROUND STRUCTURES
 DATE
 COMMITTEE
 NOTE:
 LOCATION OF UNDERGROUND STRUCTURES AS SHOWN ARE BASED ON THE BEST INFORMATION AVAILABLE BUT NO GUARANTEE IS GIVEN THAT ALL EXISTING UTILITIES ARE SHOWN OR THAT THE GIVEN LOCATIONS ARE EXACT. CONFIRMATION OF EXISTENCE AND EXACT LOCATION OF ALL SERVICES MUST BE OBTAINED FROM THE INDIVIDUAL UTILITIES BEFORE PROCEEDING WITH CONSTRUCTION.

BM 77-024	University Cr. & Chancellor Matheson, in valve box, 1.0 m S. of N.L. of Chancellor Matheson & 22.9 m W. of E.L. of University Cr.	ELEV 232.371 m
No. REVISIONS		
Y/M/D	BY	DATE

MORRISON HERSHFIELD		
DESIGNED BY	RPB	
CHECKED BY	WRJ	
DRAWN BY	DML	
APPROVED BY	BWB	
ISSUED FOR TENDER	18/03/28	RPB
ISSUED FOR CLIENT REVIEW	18/03/02	RPB
REVISIONS	Y/M/D	BY
DATE	18/03/02	DATE

PROFESSIONAL'S SEAL
PRELIMINARY DRAWING
 NOT TO BE USED FOR CONSTRUCTION
 CONSULTANT FILE NAME
 1700095-03_Thatcher-PP-03.dwg

THE CITY OF WINNIPEG
 PUBLIC WORKS DEPARTMENT
 ENGINEERING DIVISION

2018 LOCAL STREETS PACKAGE
THATCHER DRIVE
 UNIVERSITY CR TO NORTH END
 REHABILITATION
 PAVING AND GRADING
 STA 0+300 TO STA 0+420

CITY DRAWING NUMBER: N/A
 SHEET 18 OF 25
 DRAWING No. 18

BID OPPORTUNITY No. 127-2018

