

11"x17" SIZE 279.4mm x 431.8mm

PLOT: 4/5/2018 9:17:58 AM

FILE NAME: 1700095 - Killarney TS.dwg Saved By: dlane

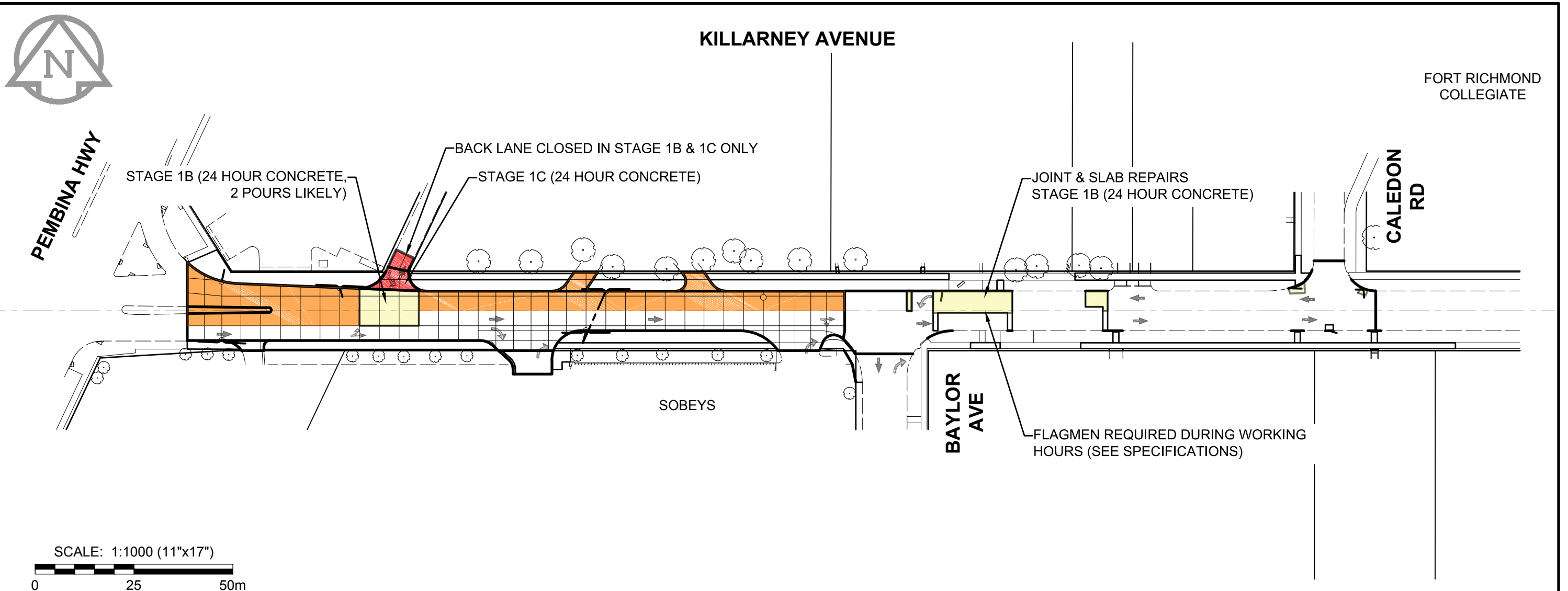

**NOTES:**

1. CONSTRUCTION STAGING IN ACCORDANCE WITH THE LATEST EDITION OF THE CITY OF WINNIPEG "MANUAL OF TEMPORARY TRAFFIC CONTROL ON CITY STREETS".
2. MAINTAIN EXISTING DRAINAGE AND INSTALL PROPOSED DRAINAGE APPURTENANCES AS REQUIRED DURING THE APPROPRIATE STAGES AND AS DIRECTED BY THE CONTRACT ADMINISTRATOR.
3. CONSTRUCT TEMPORARY ASPHALT PAVEMENT AND RAMPS AS REQUIRED TO FACILITATE THE CONSTRUCTION STAGING. THE TEMPORARY ASPHALT PAVEMENT SHALL CONSIST OF 75 mm - TYPE 1A ASPHALTIC CONCRETE PAVEMENT AND 300 BASE COURSE.
4. MAINTAIN PEDESTRIAN ACCESS TO ALL BUSINESSES.

BID OPPORTUNITY No. 127-2018

**METRIC**  
 WHOLE NUMBERS INDICATE MILLIMETRES  
 DECIMALIZED NUMBERS INDICATE METRES



2018 LOCAL STREET PACKAGE (18-R-03)  
**KILLARNEY AVENUE**  
**PEMBINA HWY TO CALEDON RD**  
 CONCRETE RECONSTRUCTION & REHABILITATION  
**CONSTRUCTION STAGING - STAGE 1**

SCALE  
1:1000

DATE  
April 5, 2018

FIGURE NO.  
**01**