

1 OVERALL FURNITURE PLAN
SCALE: 3/16"=1'-0"

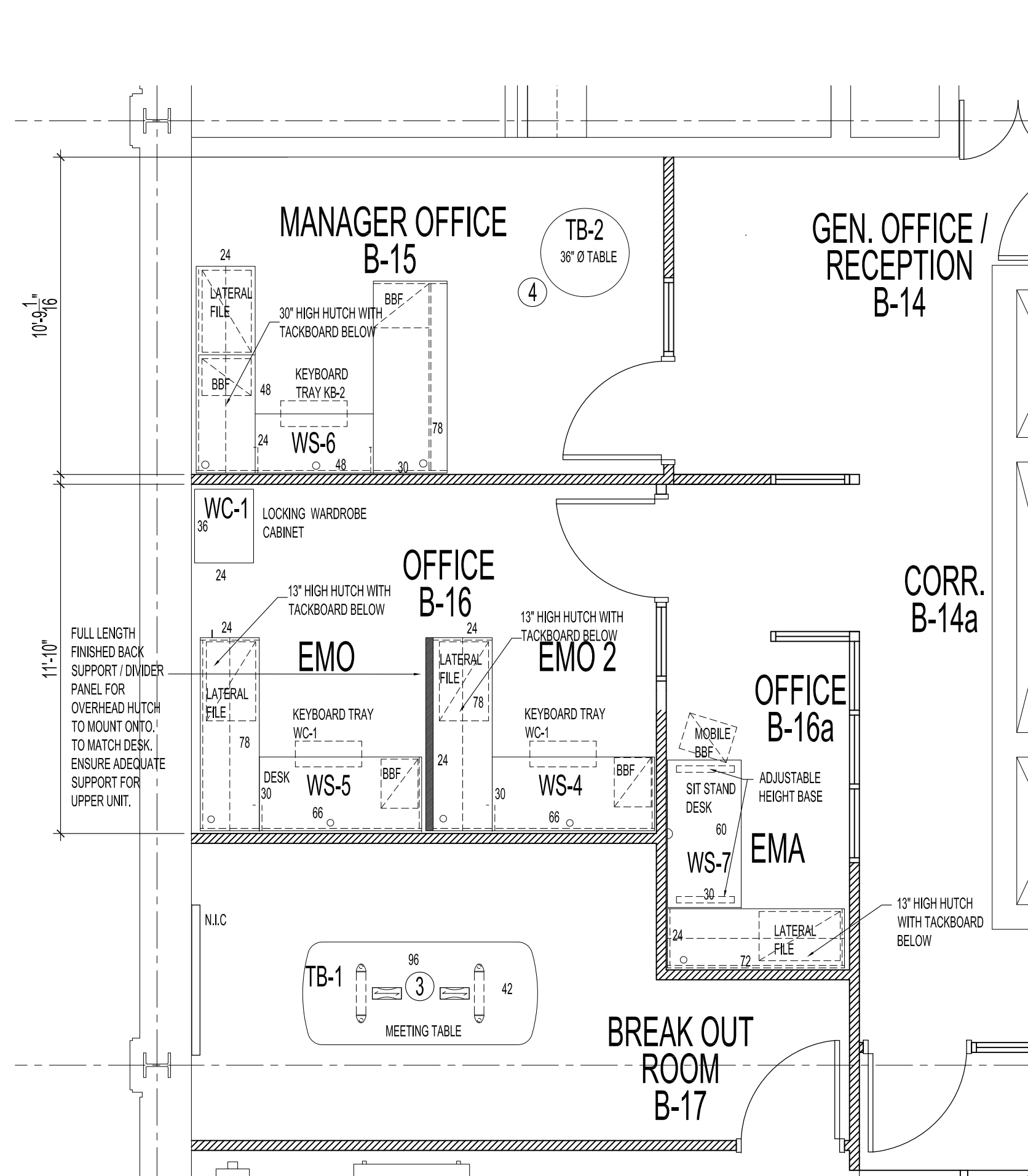

2 ENLARGED OFFICES FURNITURE PLAN
SCALE: 3/4"=1'-0"

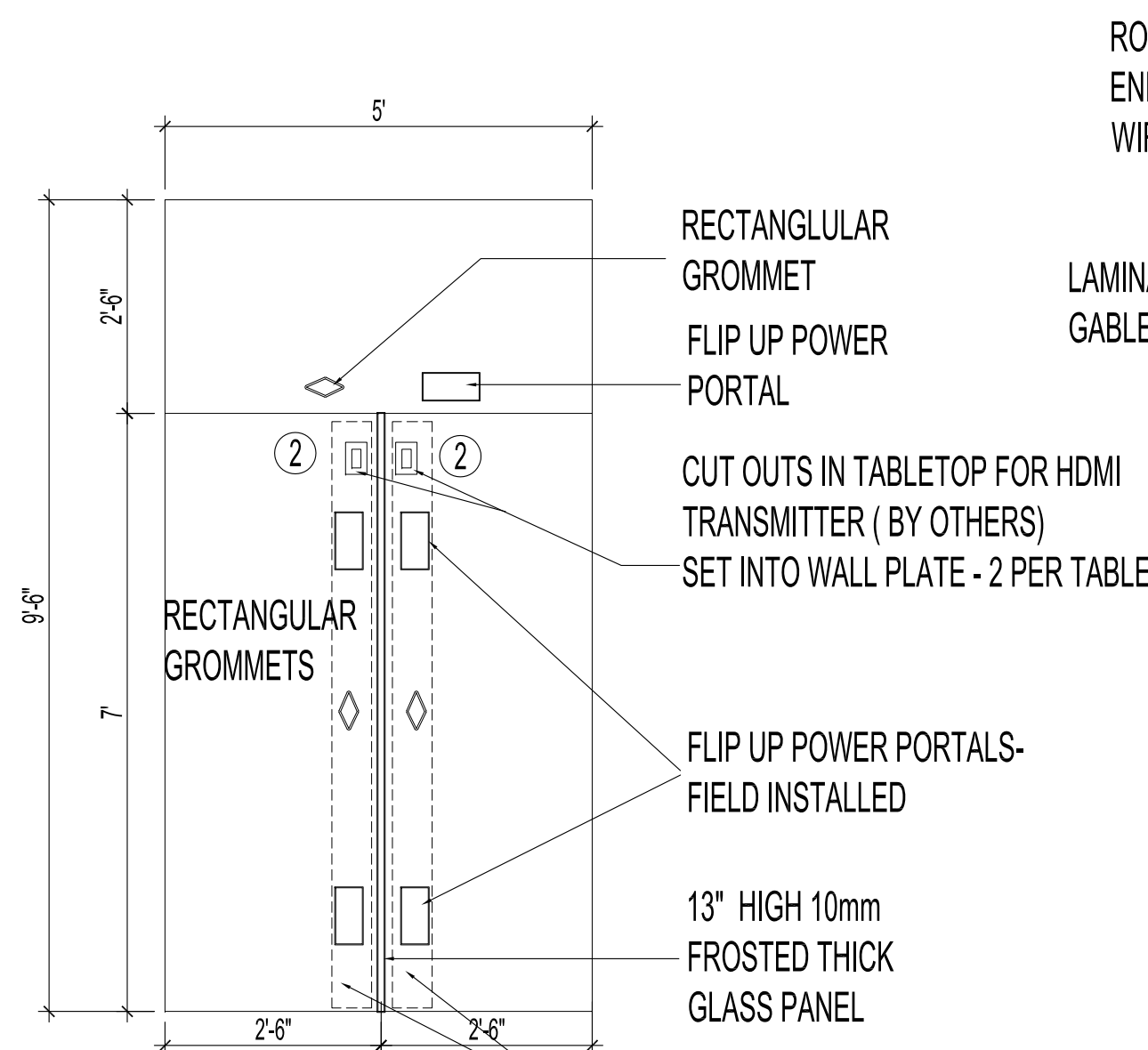

3 WS-1 (POD TABLES 1,2,3 & 4)
SCALE: 3/4"=1'-0"

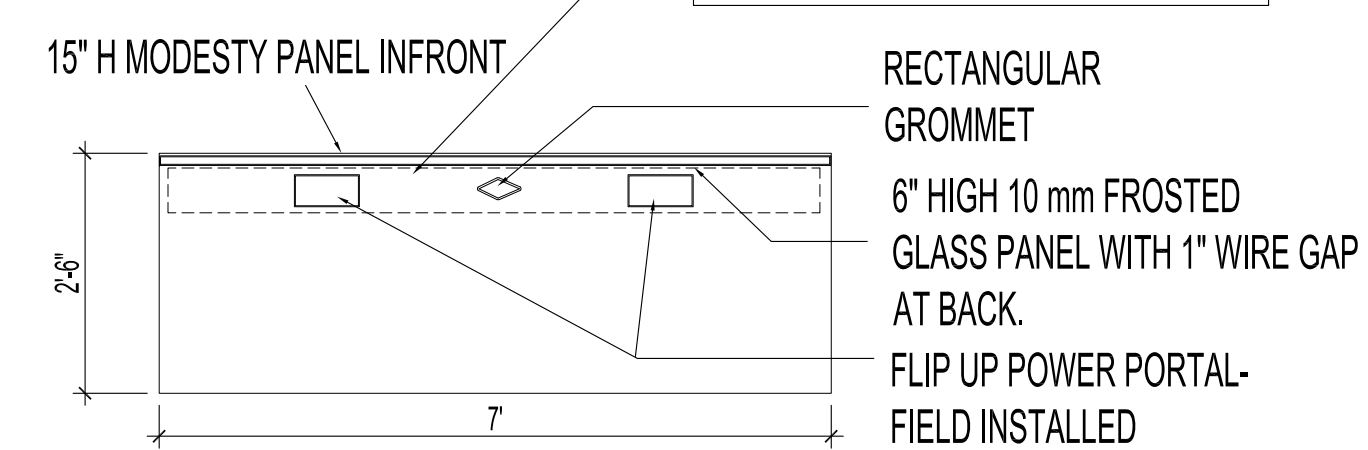

4 WS-2 (POD TABLE 5)
SCALE: 3/4"=1'-0"

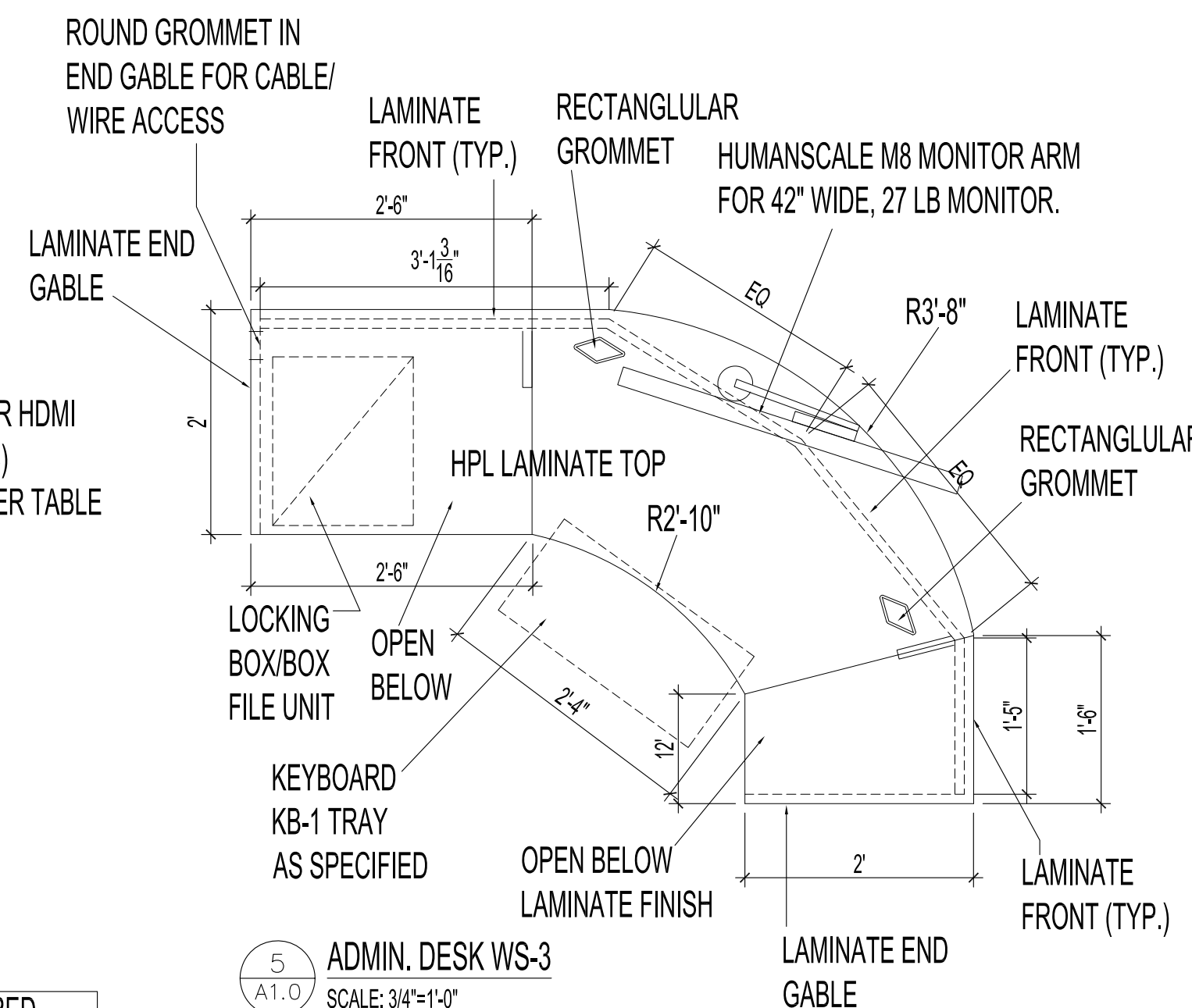

5 ADMIN. DESK WS-3
SCALE: 3/4"=1'-0"

DRAWINGS FOR REFERENCE ONLY.
REFER TO CITY OF WINNIPEG TENDER DOCUMENTS FOR DETAILED DRAWINGS AND SPECIFICATIONS FOR ALL FURNITURE COMPONENTS.

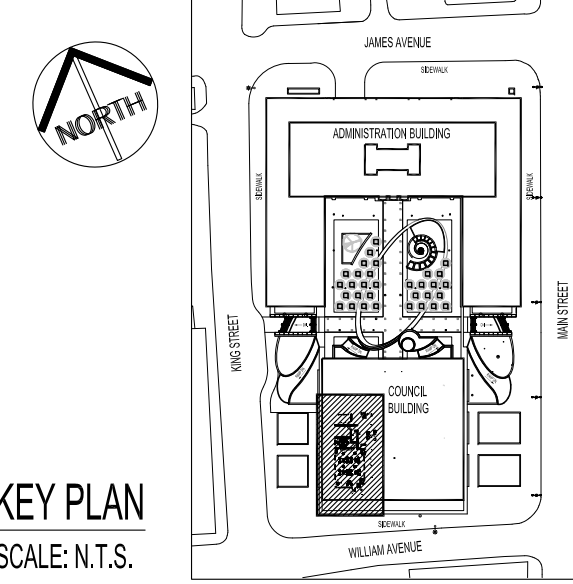

KEY PLAN
SCALE: N.T.S.

NOTES:
THESE DRAWINGS SHALL NOT BE SCALED. CONSULT WITH CONTRACT ADMINISTRATOR AND DESIGNER ON ANY CONCERNS.
THE CONTRACTOR SHALL VISIT THE SITE AND SATISFY ONESELF ALL DIMENSIONS, DATUM, AND DETAILED INFORMATION SHOWN ARE CORRECT.
THE CONTRACTOR IS TO REVIEW AND COORDINATE ALL ARCHITECTURAL, STRUCTURAL, MECHANICAL AND ELECTRICAL DRAWINGS FOR ADDITIONAL OPENINGS THROUGH FLOORS, WALLS, AND CEILINGS FOR DUCTS, PIPES & ELECTRICAL RISERS AND ALL OPENINGS NOT SHOWN ON DRAWINGS.
ALL PRODUCTS AND MATERIALS TO BE USED AND INSTALLED SHALL CONFORM WITH MANUFACTURERS SPECIFICATIONS, APPLICABLE CODES AND AUTHORITY HAVING JURISDICTION.
REFER TO CITY OF WINNIPEG, MATERIALS MANAGEMENT GENERAL TERMS & CONDITIONS FOR PROJECT: [HTTP://WINNIPEG.CA/MATMG/GEN_COND.STM](http://WINNIPEG.CA/MATMG/GEN_COND.STM)

DRAWING NOTES

- ALL FURNISHINGS AND PRODUCTS LISTED ON THE DRAWINGS ARE THE SELECTED PRODUCTS OF THE WPF'S EMERGENCY OPERATIONS CENTRE FOR DURABILITY AND FUNCTIONALITY. HOWEVER ALTERNATE FINISHES AND OR PRODUCTS MAY BE CONSIDERED AS AN APPROVED SUBSTITUTE IN ACCORDANCE WITH B6 AS PER THE CITY OF WINNIPEG TENDER DOCUMENTS.
- FURNITURE SUPPLIER TO COORDINATE ALL CITY SUPPLIED ELECTRICAL COMPONENTS (HDMI SWITCHES) WITH INSTALLATION INTO FURNITURE. FURNITURE SUPPLIER TO INSTALL HDMI SWITCHES UNDER THE DIRECTION OF WPF'S IT DEPARTMENT ONSITE INTO POD TABLES 1,2,3 AND 4.
- FURNITURE SUPPLIER TO PROVIDE DATA CABLE FLOOR TRACK COVER IN BREAK OUT ROOM AS PART OF MEETING TABLE TB-1 PRICE. BLACK FINISH.
- MANAGER'S TABLE IN OFFICE B-15 AND LOCKING WARDROBE CABINET IN OFFICE B-16 TO MATCH OFFICE FURNITURE SUITE FINISHES SPECIFIED.
- EOC AREA B-20 WORKSTATION TABLES WS-1 ARE ALSO REFERRED TO AS POD 1,2,3,4 TO COORDINATE WITH THE CONSTRUCTION DRAWINGS.
- EOC AREA B-20 FURNITURE TO BE INSTALLED FIRST, FOLLOWED BY OFFICE AREA FURNITURE DUE TO THE SET UP OF THE WPF'S IT COMPONENTS.

No.	REVISION/DESCRIPTION	BY	DATE
2	ISSUED FOR BID OPP	KJN	FEB. 11 2019
1	ISSUED FOR 99% CLIENT REVIEW	KJN	FEB. 6 2019
00	ISSUED FOR 60% CLIENT REVIEW	KJN	AUG. 17 2018

DRAWN DATE	CHECKED USER	DESIGNED	APPROVED
2019.02.11			

THE CITY OF WINNIPEG
PLANNING, PROPERTY AND DEVELOPMENT DEPARTMENT
MUNICIPAL ACCOMMODATIONS DIVISION
3-65 GARRY STREET, R3C 4K4

PROJECT
WPF'S EMERGENCY OPERATIONS CENTRE FURNITURE

510 MAIN STREET BID OPP # 1192-2018

SHEET TITLE
FURNITURE OVERALL PLAN