

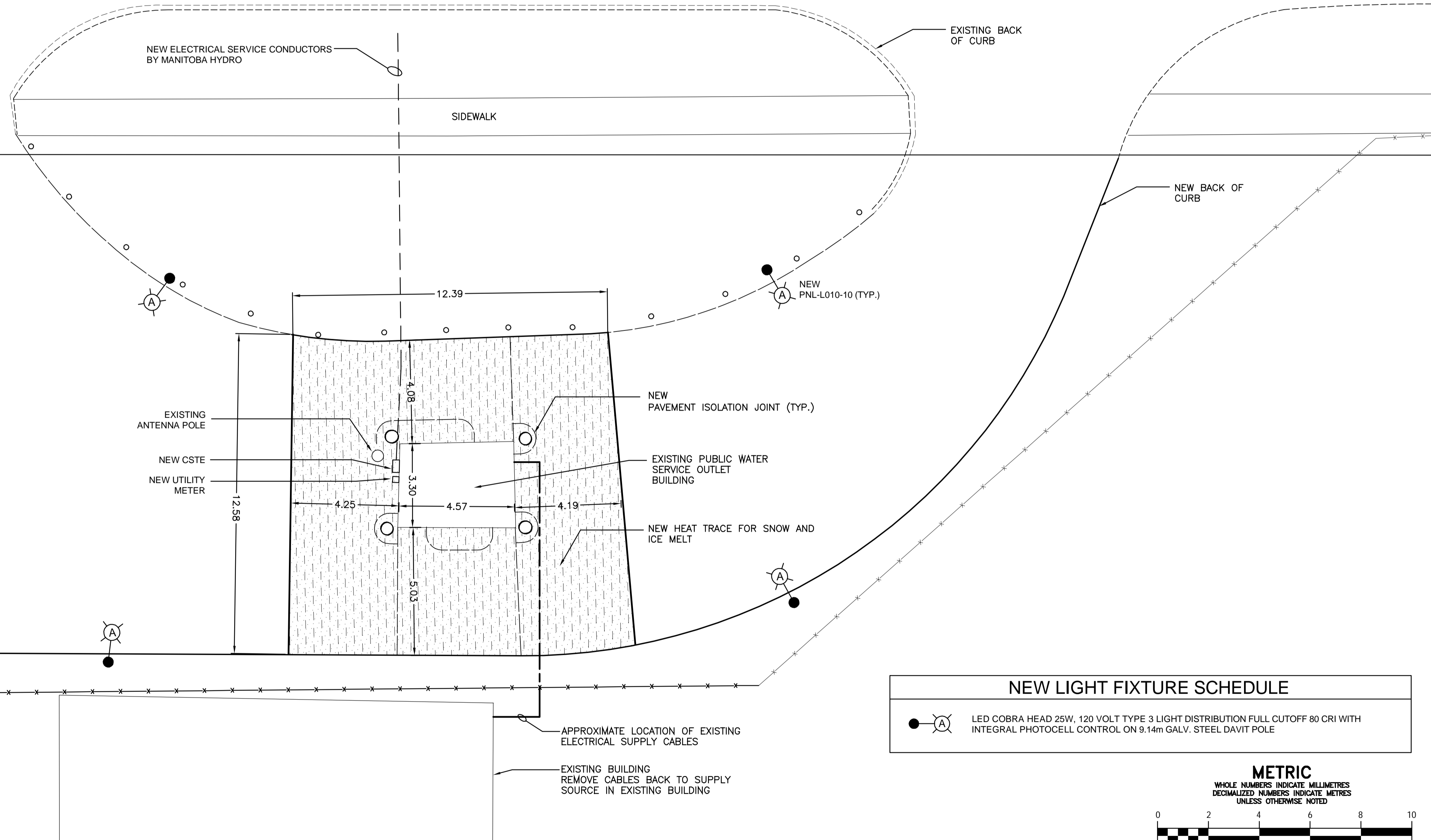

CHEVRIER BOULEVARD

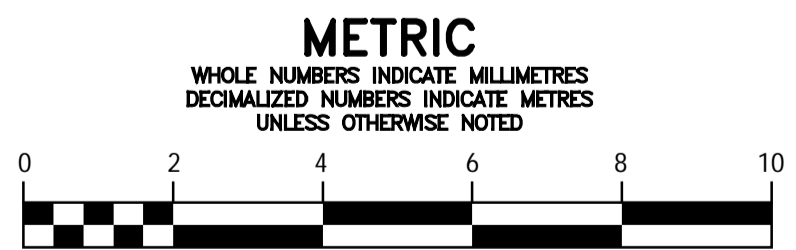

NEW LIGHT FIXTURE SCHEDULE	
	LED COBRA HEAD 25W, 120 VOLT TYPE 3 LIGHT DISTRIBUTION FULL CUTOFF 80 CRI WITH INTEGRAL PHOTOCELL CONTROL ON 9.14m GALV. STEEL DAVIT POLE



FILENAME: C:\PROJECTS\WORKING DIRECTORY\ACTIVE\40SK\175009-05-CHEVRIER-ELECT-SITE.DWG PLOTTED BY: KOWALSKI, STANLEY  
PLOT DATE: 2017-11-24 8:54:11 AM PLOT SCALE: 1:1.0009 PLOT STYLE: FULL-COLOR.CTB



LOCATION APPROVED UNDERGROUND STRUCTURES	
SUPV. U/G STRUCTURES COMMITTEE	DATE
NOTE: LOCATION OF UNDERGROUND STRUCTURES AS SHOWN ARE BASED ON THE BEST INFORMATION AVAILABLE BUT NO GUARANTEE IS GIVEN THAT ALL EXISTING UTILITIES ARE SHOWN OR THAT THE GIVEN LOCATIONS ARE EXACT. CONFIRMATION OF EXISTENCE AND EXACT LOCATION OF ALL SERVICES MUST BE OBTAINED FROM THE INDIVIDUAL UTILITIES BEFORE PROCEEDING WITH CONSTRUCTION.	

B.M. ELEV.	
CONSTRUCTION COMPLETION DATE: YYYY MM DD	
0	ISSUED FOR BID OP 634-2017
NO.	REVISIONS
	DATE
	BY

DESIGNED BY	B.L.M.	CHECKED BY	
DRAWN BY	S.C.K.	APPROVED BY	
SCALE:	HORIZONTAL AS SHOWN	RELEASED FOR CONSTRUCTION	
DATE	2017 07 07	DATE	

ENGINEER'S SEAL  
PROVINCE OF MANITOBA  
Nov 23/17  
B.L. MOORE  
REGISTERED PROFESSIONAL ENGINEER  
CONSULTANT DRAWING NUMBER  
E-01

**THE CITY OF WINNIPEG**  
WATER AND WASTE DEPARTMENT  
ENGINEERING DIVISION  
2017 REHABILITATION OF PUBLIC WATER SERVICE  
OUTLETS: PAVEMENT WORKS, BUILDING SUPPLY  
AND REPAIRS, DEMOLITION AND ELECTRICAL  
ELECTRICAL  
CHEVRIER BLVD - SITE PLAN

SHEET 5 OF 33
CITY DRAWING NUMBER D-14911