

B ACTIVE TRANSPORTATION PATH
STA 1+374 TO STA 1+646
NTS

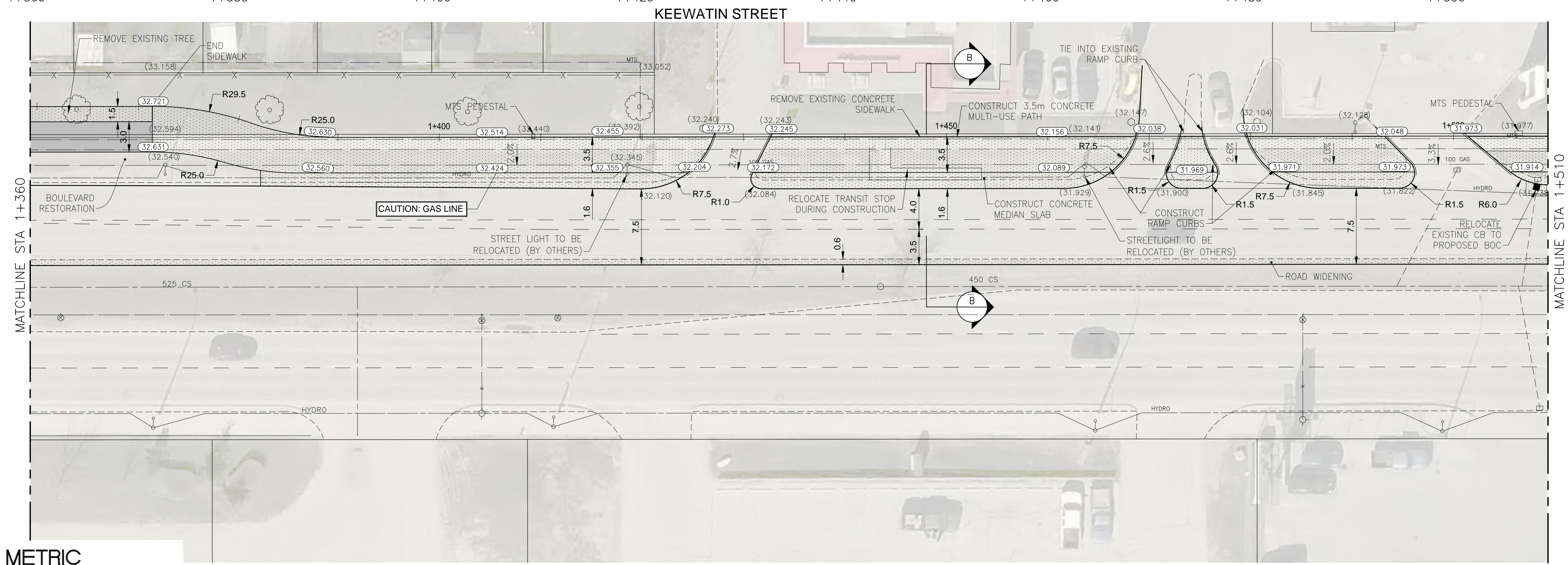

- GENERAL NOTES:
1. MAINTAIN TRAFFIC AS OUTLINED IN THE TRAFFIC MANAGEMENT SPECIFICATION.
 2. LIGHTING FOR PATH FACILITY TO BE INSTALLED BY MANITOBA HYDRO.
 3. BOULEVARD RESTORATION AS DIRECTED BY CONTRACT ADMINISTRATOR.
 4. RECONSTRUCT PRIVATE APPROACHES UP TO 1m WITHIN PROPERTY TO ACHIEVE 2% ACROSS PATH.
 5. CONSTRUCT BARRIER CURB UNLESS OTHERWISE NOTED.

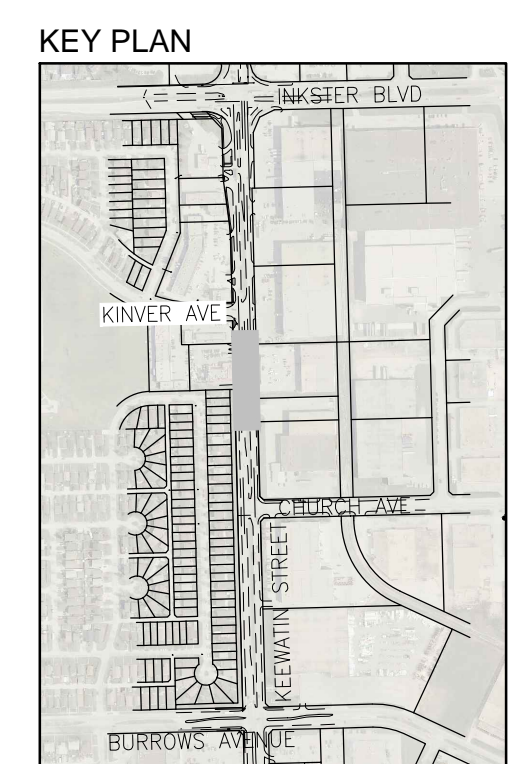

METRIC
WHOLE NUMBERS INDICATE MILLIMETRES
DECIMALIZED NUMBERS INDICATE METRES

WARNING
IF POWER EQUIPMENT OR EXPLOSIVES ARE TO BE USED FOR EXCAVATION ON THIS PROJECT THE CONTRACTOR MUST:
1. NOTIFY THE GAS COMPANY OF THE PROPOSED LOCATION OF EXCAVATION.
2. TAKE PRECAUTION TO AVOID DAMAGE TO GAS COMPANY INSTALLATIONS SEE PROVINCIAL REGULATION 210/72 FOR DETAILS.
3. OBTAIN EXCAVATION PERMITS PRIOR TO CONSTRUCTION.

EXISTING	LEGEND-PLAN	PROPOSED	EXISTING	LEGEND-PLAN	PROPOSED
150 WWS	WATERMAIN	150 WWS	HYDRO	HYDRO	HYDRO
300 LDS	HYDRANT VALVE	300 LDS	M.T.S.	M.T.S.	M.T.S.
250 WWS	LAND DRAINAGE SEWER	250 WWS	CONCRETE	CONCRETE	CONCRETE
	WASTE WATER SEWER		ASPHALT	ASPHALT	ASPHALT
	MANHOLE		CONCRETE SIDEWALK	CONCRETE SIDEWALK	CONCRETE SIDEWALK
	CATCH BASIN		BOREHOLE	BOREHOLE	BOREHOLE
	CURB INLET/CATCH PIT		EASEMENT LINE	EASEMENT LINE	EASEMENT LINE
	CURB RENEWAL		PROPERTY LINE	PROPERTY LINE	PROPERTY LINE
	TRAFFIC ARROW		SURVEY BAR	SURVEY BAR	SURVEY BAR
	GAS		ELEVATION	ELEVATION	ELEVATION
			SIDEWALK DETECTABLE	SIDEWALK DETECTABLE	SIDEWALK DETECTABLE

LOCATION APPROVED UNDERGROUND STRUCTURES

SUPV. U/G STRUCTURES COMMITTEE DATE

NOTE:
LOCATION OF UNDERGROUND STRUCTURES AS SHOWN ARE BASED ON THE BEST INFORMATION AVAILABLE BUT NO GUARANTEE IS GIVEN THAT ALL EXISTING UTILITIES ARE SHOWN OR THAT THE GIVEN LOCATIONS ARE EXACT. CONFIRMATION OF EXISTENCE AND EXACT LOCATION OF ALL SERVICES MUST BE OBTAINED FROM THE INDIVIDUAL UTILITIES BEFORE PROCEEDING WITH CONSTRUCTION.

B.M. ELEV.	NO.	REVISIONS	DATE	BY
	0	ISSUED FOR TENDER	17.06.23	S.B.C.

Stantec
500 - 311 Portage Avenue, Winnipeg MB
www.stantec.com

DESIGNED BY: D.L.	CHECKED BY: R.K.H.
DRAWN BY: G.P.	APPROVED BY: S.B.C.
HOR. SCALE: 1:250	RELEASED FOR CONSTRUCTION: DATE
VERTICAL: DATE	DATE

ENGINEER'S SEAL
PRELIMINARY DRAWING
NOT TO BE USED FOR CONSTRUCTION
CONSULTANT DRAWING NO. C204

THE CITY OF WINNIPEG
PUBLIC WORKS DEPARTMENT
ENGINEERING DIVISION

2017 WALK/BIKE INFRASTRUCTURE PROGRAM
KEEWATIN STREET
BURROWS ST. TO INKSTER BLVD. AT FACILITY
STA. 1+360 TO STA. 1+510

SHEET 5 OF 17
CAD FILE DRAWING NUMBER 07230c-201-903.dwg
CITY DRAWING NUMBER P3483-05