

- CONSTRUCTION NOTES: (RECONSTRUCTION)**
- ADJUST ALL ROADWAY APPURTENANCE TO MATCH FINAL GRADES.
  - ADJUST MANHOLE AND CATCHBASIN WITHIN THE ROADWAY 50mm BELOW FINAL GRADE TO ACCOMMODATE A RISER RING.
  - COMPLETE DRAINAGE INLET WORKS AS NOTED.
  - ALL RADII CURB TO BE MODIFIED BARRIER CURB AND RAMP CURB (TYP.).
  - BACK LANE & SIDE STREET APPROACH PAVEMENT SECTION:
    - 150 REINFORCED CONCRETE PAVEMENT
    - 75 - 20mm CRUSHED BASE COURSE
    - 300 - 50mm CRUSHED SUBBASE
    - SUBGRADE COMPACTION
  - WORKS IN CLOSE PROXIMITY TO THE 400 WM AER TO COMPLY WITH THE CONTRACT SPECIFICATIONS
- GENERAL NOTES:**
- MAINTAIN TRAFFIC AS OUTLINED IN THE TRAFFIC MANAGEMENT SPECIFICATION AND TRAFFIC CONTROL/CONSTRUCTION STAGING DRAWINGS.
  - PROVIDE 1 WEEK NOTICE FOR STREET LIGHT RELOCATES AND EXCAVATION WORK WITHIN 1.5m OF EXISTING HYDRO POLES. COORDINATED WITH MANITOBA HYDRO.

**METRIC WARNING**

WHOLE NUMBERS INDICATE MILLIMETRES  
DECIMALIZED NUMBERS INDICATE METRES

IF POWER EQUIPMENT OR EXPLOSIVES ARE TO BE USED FOR EXCAVATION ON THIS PROJECT THE CONTRACTOR MUST:

- NOTIFY THE GAS COMPANY OF THE PROPOSED LOCATION OF EXCAVATION.
- TAKE PRECAUTION TO AVOID DAMAGE TO GAS COMPANY INSTALLATIONS SEE PROVINCIAL REGULATION 210/72 FOR DETAILS.
- OBTAIN EXCAVATION PERMITS PRIOR TO CONSTRUCTION.

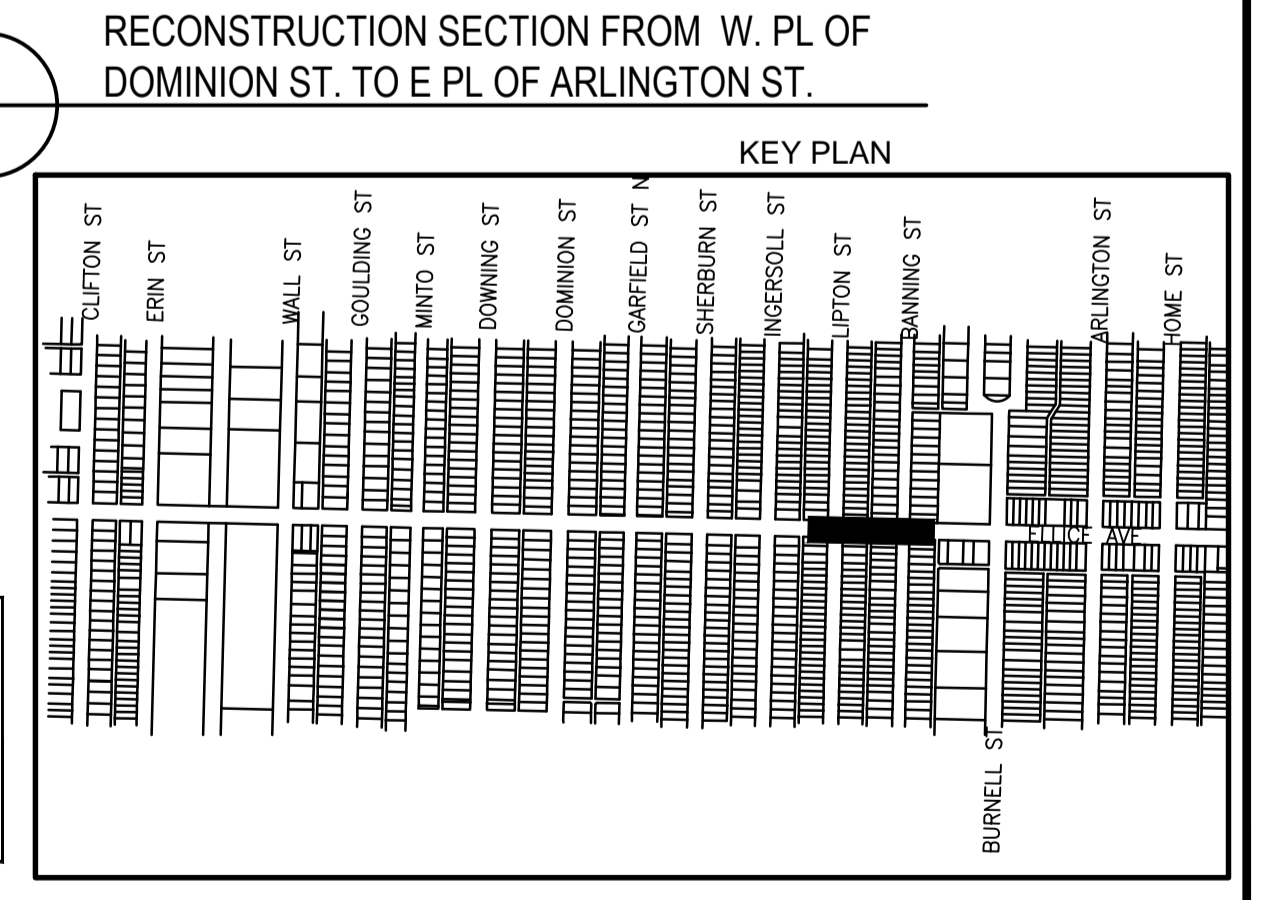
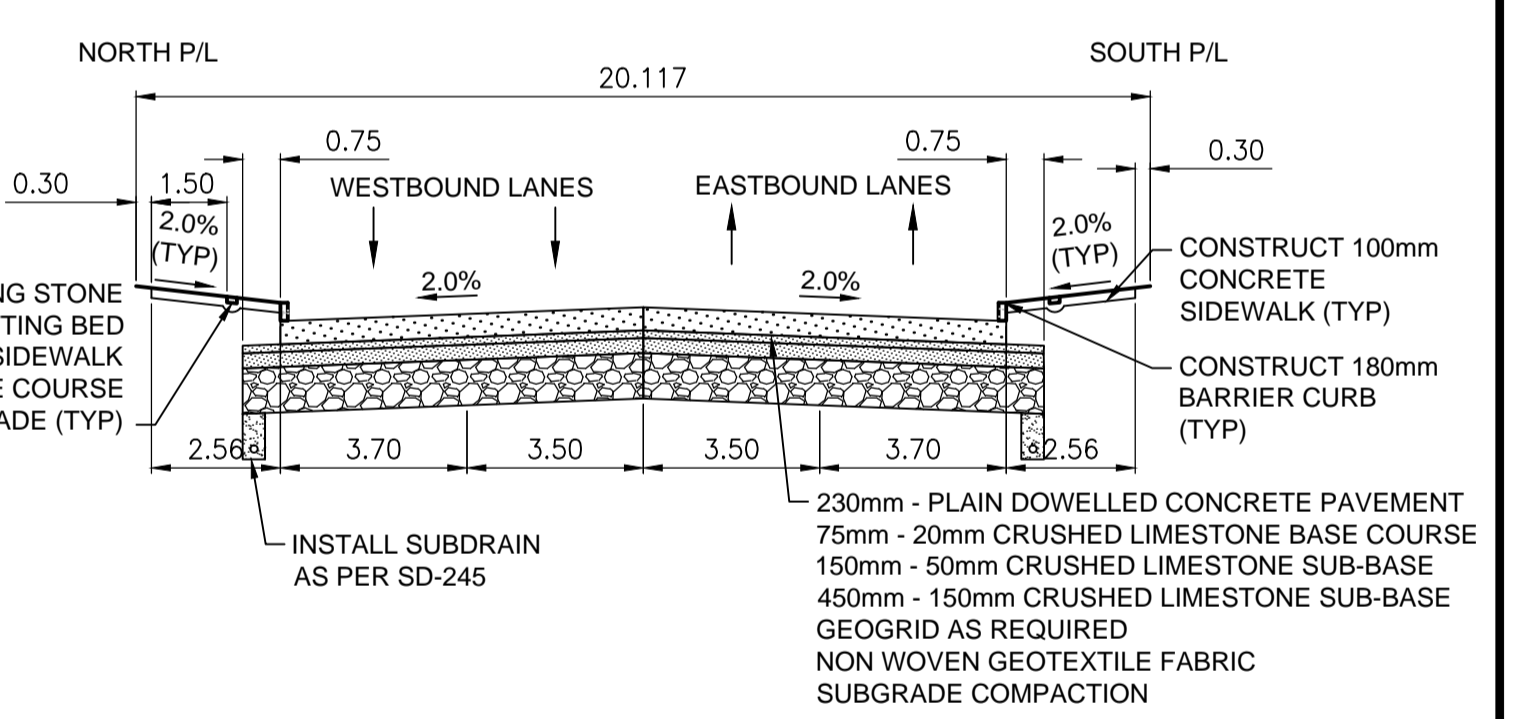
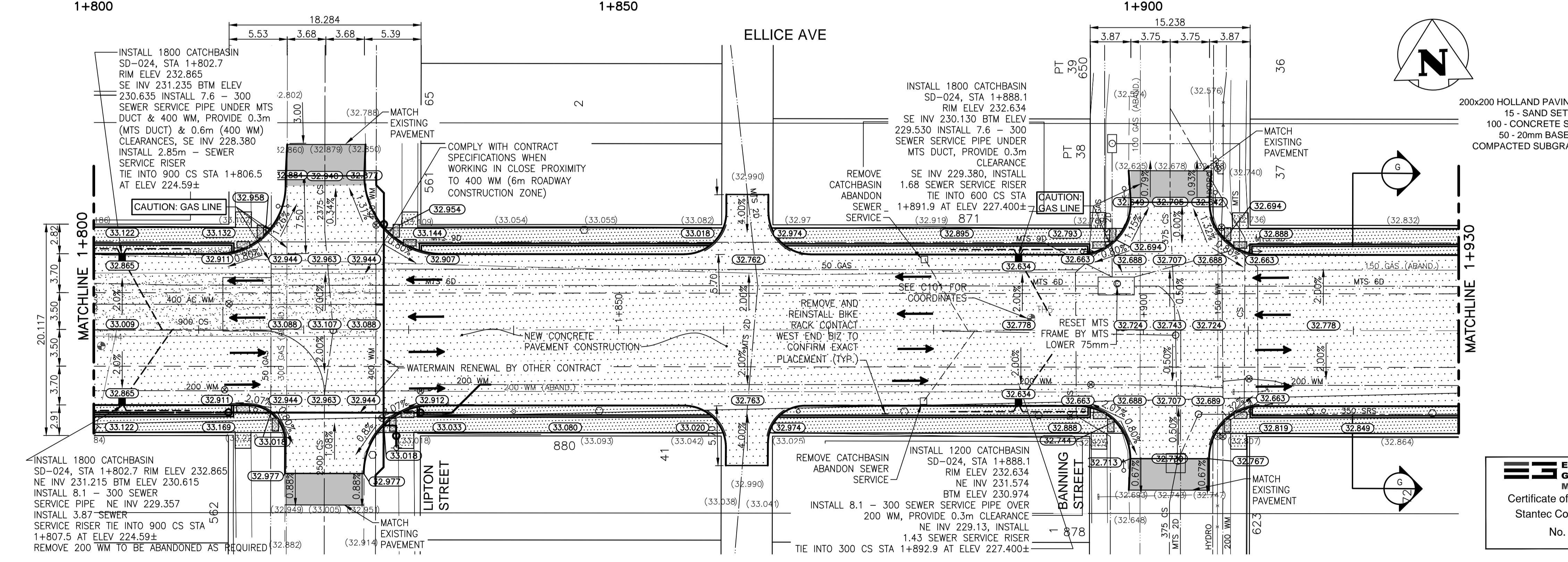

**ENGINEERS GEOSCIENTISTS MANITOBA**  
Certificate of Authorization  
Stantec Consulting Ltd.  
No. 1301

150 WM	WATERMAIN	150 WM	150 WM	WATERMAIN	150 WM	HYDRO
+	HYDRANT, VALVE	+	HYDRANT	+	M.T.S.	CONCRETE
300 LDS	LAND DRAINAGE SEWER	300 LDS	LAND DRAINAGE SEWER	300 LDS	MILL AND OVERLAY	CONCRETE SIDEWALK
250 WWS	WASTE WATER SEWER	250 WWS	WASTE WATER SEWER	250 WWS	CONCRETE SIDEWALK	CONCRETE SIDEWALK
X	PROFILE	X	PROFILE	X	CONCRETE SIDEWALK	CONCRETE SIDEWALK
□	NORTH OR WEST GUTTER	□	MANHOLE	○	HYDRO POLE	HYDRO POLE
○	SOUTH OR EAST GUTTER	○	CATCH BASIN	○	SIGN	SIGN
◇	NORTH OR WEST R	◇	CURB INLET/CATCH PIT	◇	PROPERTY LINE	PROPERTY LINE
◇	SOUTH OR EAST R	◇	CURB RENEWAL	◇	CORE HOLE	CORE HOLE
△	NORTH OR WEST DITCH	△	TRAFFIC SIGNAL	△	ELEVATION	ELEVATION
▽	SOUTH OR EAST DITCH	▽	GAS	▽	SIDEWALK DETECTABLE	SIDEWALK DETECTABLE
EXISTING	LEGEND-PROFILE	PROPOSED	LEGEND-PLAN	PROPOSED	EXISTING	LEGEND-PLAN

**LOCATION APPROVED UNDERGROUND STRUCTURES**

SUPV. U/G STRUCTURES COMMITTEE

DATE

NOTE:  
LOCATION OF UNDERGROUND STRUCTURES AS SHOWN ARE BASED ON THE BEST INFORMATION AVAILABLE BUT NO GUARANTEE IS GIVEN THAT ALL EXISTING UTILITIES ARE SHOWN OR THAT THE GIVEN LOCATIONS ARE EXACT. CONFIRMATION OF EXISTENCE AND EXACT LOCATION OF ALL SERVICES MUST BE OBTAINED FROM THE INDIVIDUAL UTILITIES BEFORE PROCEEDING WITH CONSTRUCTION.

NO.	REVISIONS	DATE	BY
1	ISSUED FOR TENDER	17.06.12	
0	ISSUED FOR REVIEW	17.05.30	

**Stantec**  
500 - 311 Portage Avenue, Winnipeg MB  
www.stantec.com

DESIGNED BY: D.L. CHECKED BY: D.M.  
DRAWN BY: G.P. APPROVED BY: S.B.C.

HOR. SCALE: 1:250  
VERTICAL: 1:10

RELEASED FOR CONSTRUCTION: DATE

DATE: 2017.04.13

ENGINEER'S SEAL  
**PRELIMINARY DRAWING**  
NOT TO BE USED FOR CONSTRUCTION  
CONSULTANT DRAWING NO. C207

**THE CITY OF WINNIPEG**  
PUBLIC WORKS DEPARTMENT  
ENGINEERING DIVISION

2017 REGIONAL STREET RENEWAL PROGRAM  
ELLICE AVENUE  
ERIN STREET TO ARLINGTON STREET  
RECONSTRUCTION

SHEET 14 OF 20  
CAD FILE DRAWING NUMBER 07271c-201-xxx.dwg  
CITY DRAWING NUMBER P-3485-14

V:\1137\active\113707271\0300\_drawing\0302\_sheet\_files\02\_civil\07271c-201-xxx.dwg