

PRELIMINARY

NOT TO BE USED FOR
CONSTRUCTION

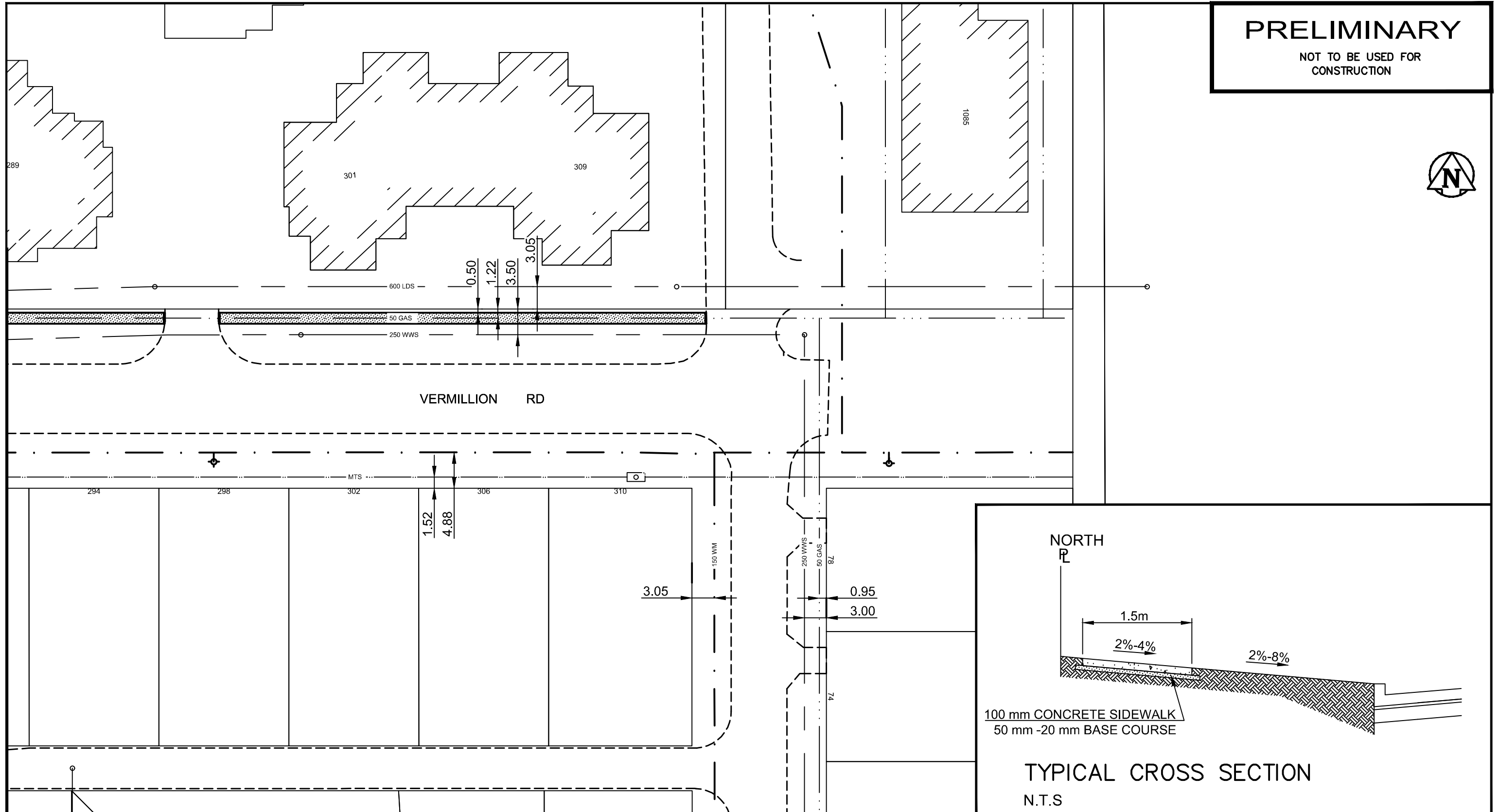

NORTH
↑

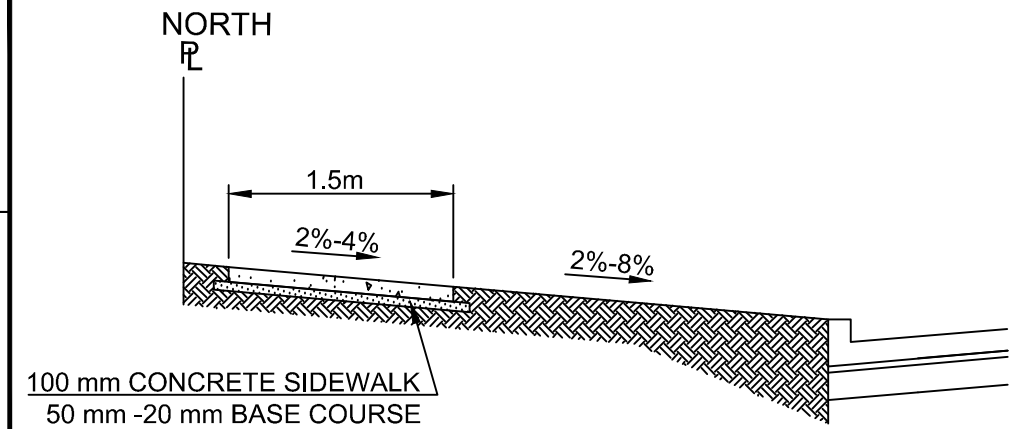

TYPICAL CROSS SECTION

N.T.S



THE CITY OF WINNIPEG
PUBLIC WORKS DEPARTMENT
ENGINEERING DIVISION
TECHNOLOGY SERVICES BRANCH
106 - 1155 PACIFIC AVE

VERMILLION ROAD

FROM LAKEWOOD BLVD TO GROVER HILLS LN
NEW SIDEWALK AND ASSOCIATED WORKS

DATE:
APR 12, 2017

DRAWN BY:
R.B.

SCALE:
1:500

DRAWING #
SE-17-39

SHEET
7 OF 7