

CULVERT END & REINFORCED CONCRETE JOINT DETAIL
SCALE: NTS

- NOTES:**
1. CONSTRUCT CLAY COFFERDAM AT RIVER AS REQUIRED SEE DWG LD-7993.
 2. ALL EXCAVATED MATERIAL WITHIN 107.0 OF THE REGULATED SUMMER RIVER LEVEL (RSRL) MUST BE REMOVED FROM SITE (NO STOCKPILING).
 3. REMOVE AND REPLACE TREES AS DIRECTED BY THE CONTRACT ADMINISTRATOR.
 4. ACCESS TO ZOO TO BE COORDINATED WITH ASSINBOINE PARK CONSERVANCY. CONTACT GLEN SCHILKE @ 204-619-1850.

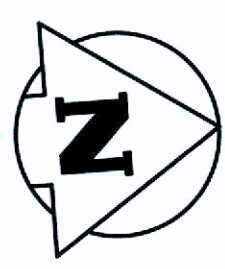
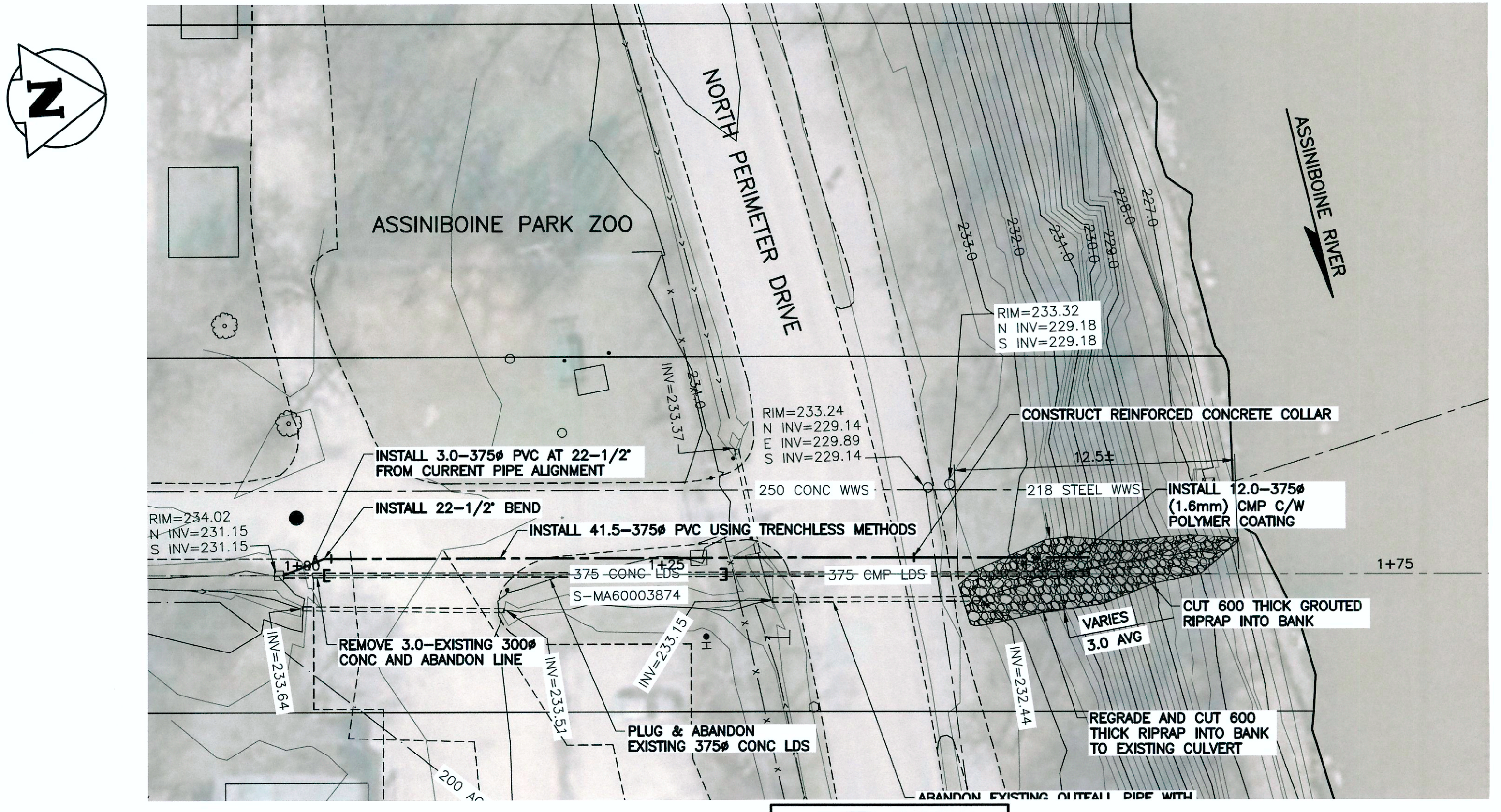
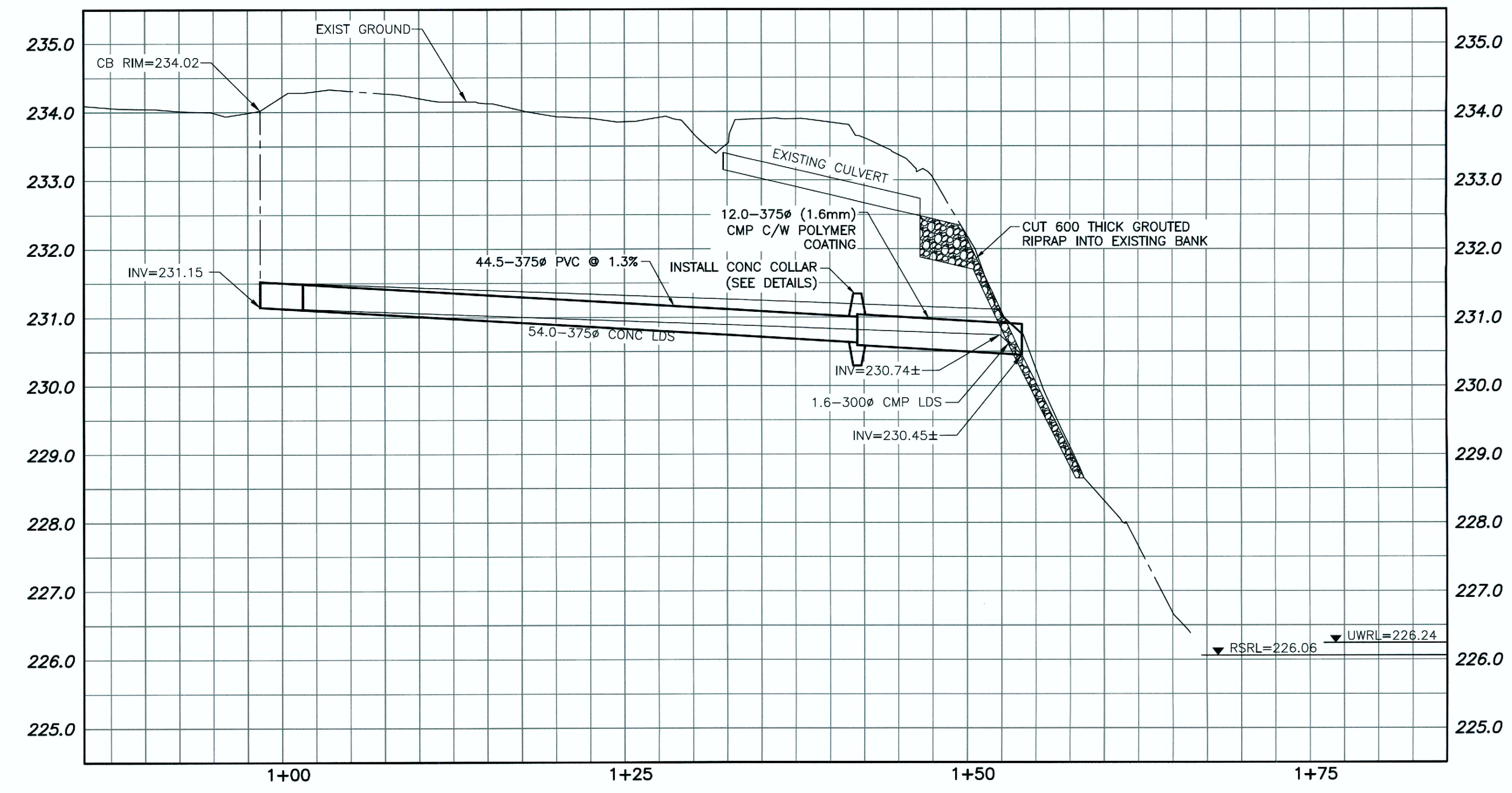

WARNING

1. NOTIFY THE GAS COMPANY OF THE PROPOSED LOCATION OF EXCAVATION.
2. TAKE PRECAUTION TO AVOID DAMAGE TO GAS COMPANY INSTALLATIONS.
3. SEE PROVINCIAL REGULATION 210/72 FOR DETAILS.

PROPERTY LIMITS DELINEATION

DELINEATION OF PROPERTY LIMITS AS SHOWN ON THIS DWG DOES NOT REPRESENT A "LEGAL SURVEY". KGS GROUP MAKES NO REPRESENTATION OR WARRANTY AS TO THE ACCURACY OF PROPERTY LIMITS DELINEATED ON THIS DWG, NOR ON THE DIMENSIONAL ACCURACY OF DWG FEATURES RELATIVE TO THOSE PROPERTY LIMITS.

METRIC

WHOLE NUMBERS INDICATE MILLIMETRES
DECIMALIZED NUMBERS INDICATE METRES

APEGN
Certificate of Authorization
KGS Group
No. 245

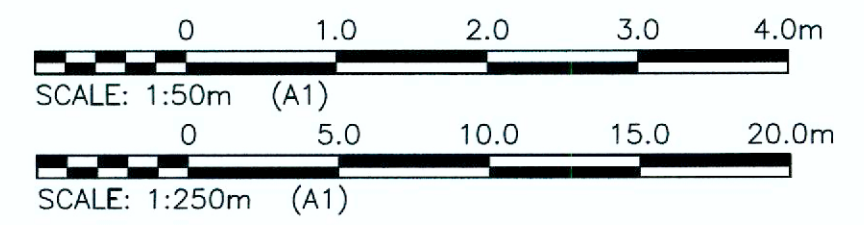

| | | | | | | | |
|---------|---------------------|---------|----------------|----------|----------|----------------|----------|
| 150 WM | WATERMAIN | 150 WM | HYDRO | | | | |
| ⊕ | HYDRANT VALVE | ⊕ | M.T.S. | | | | |
| ⊙ | PROPERTY LINE | --- | SURVEY BAR | + | | | |
| 300_LDS | LAND DRAINAGE SEWER | 300_LDS | LIGHT STANDARD | • | | | |
| 250_WWS | WASTE WATER SEWER | 250_WWS | HYDRO POLE | • | | | |
| □ | MANHOLE | ● | GUY WIRE | — | | | |
| ○ | CATCH BASIN | ● | SIGN | ○ | | | |
| ▽ | CURB INLET | ▽ | BUSH LINE | ~ | | | |
| + | JUNCTIONS | + | FENCE | --- | | | |
| + | CULVERT | + | ELEVATION | (32.231) | | | |
| + | GAS | + | | | | | |
| --- | EXISTING | --- | LEGEND-PLAN | PROPOSED | EXISTING | LEGEND-PROFILE | PROPOSED |

LOCATION APPROVED UNDERGROUND STRUCTURES

SUPV. U/G STRUCTURES COMMITTEE DATE

NOTE:
LOCATION OF UNDERGROUND STRUCTURES AS SHOWN ARE BASED ON THE BEST INFORMATION AVAILABLE BUT NO GUARANTEE IS GIVEN THAT ALL EXISTING UTILITIES ARE SHOWN OR THAT THE GIVEN LOCATIONS ARE EXACT. CONFIRMATION OF EXISTENCE AND EXACT LOCATION OF ALL SERVICES MUST BE OBTAINED FROM THE INDIVIDUAL UTILITIES BEFORE PROCEEDING WITH CONSTRUCTION.

B.M. KGS_BASE
ELEV=249.213 NAD83 CSRS CGVD28

KGS GROUP
CONSULTING ENGINEERS

DESIGNED BY: JB
DRAWN BY: DMW
CHECKED BY: RBO
APPROVED BY: [Signature]

HOR. SCALE: 1:250
VERTICAL: 1:50

RELEASSED FOR CONSTRUCTION: ORIGINAL SIGNED BY KAS ZUREK
DATE: NOV 04 2016

| | | | |
|-----|-------------------------|----------|----|
| NO. | REVISIONS | DATE | BY |
| 1 | ISSUED FOR CONSTRUCTION | 15/11/16 | JB |
| 0 | ISSUED FOR CONSTRUCTION | 03/11/16 | JB |

ENGINEER'S SEAL

PROVINCE OF MANITOBA
J.A. BOSCHOW
Member
34888
2016-11-5

CONSULTANT DRAWING NO.
16-0107-021-C05

THE CITY OF WINNIPEG
WATER & WASTE DEPARTMENT

**2017 OUTFALL RENEWAL/
REHABILITATION PROGRAM**

**ASSINBOINE PARK NORTH PERIMETER DRIVE
300mm LAND DRAINAGE SEWER OUTFALL (AS-43)
PLAN AND PROFILE MA60003874**

SHEET **05** OF **08**

CAD FILE DRAWING NUMBER
16-0107-021_CALL

CITY DRAWING NUMBER
LD-7990

File Name: U:\ENVS\16-0107-021\16-0107-021_CALL.dwg - Tab: C05 Plotted By: dweber 16/11/15 [Tue 11:05am] A1/PLOT SCALE=1:1