

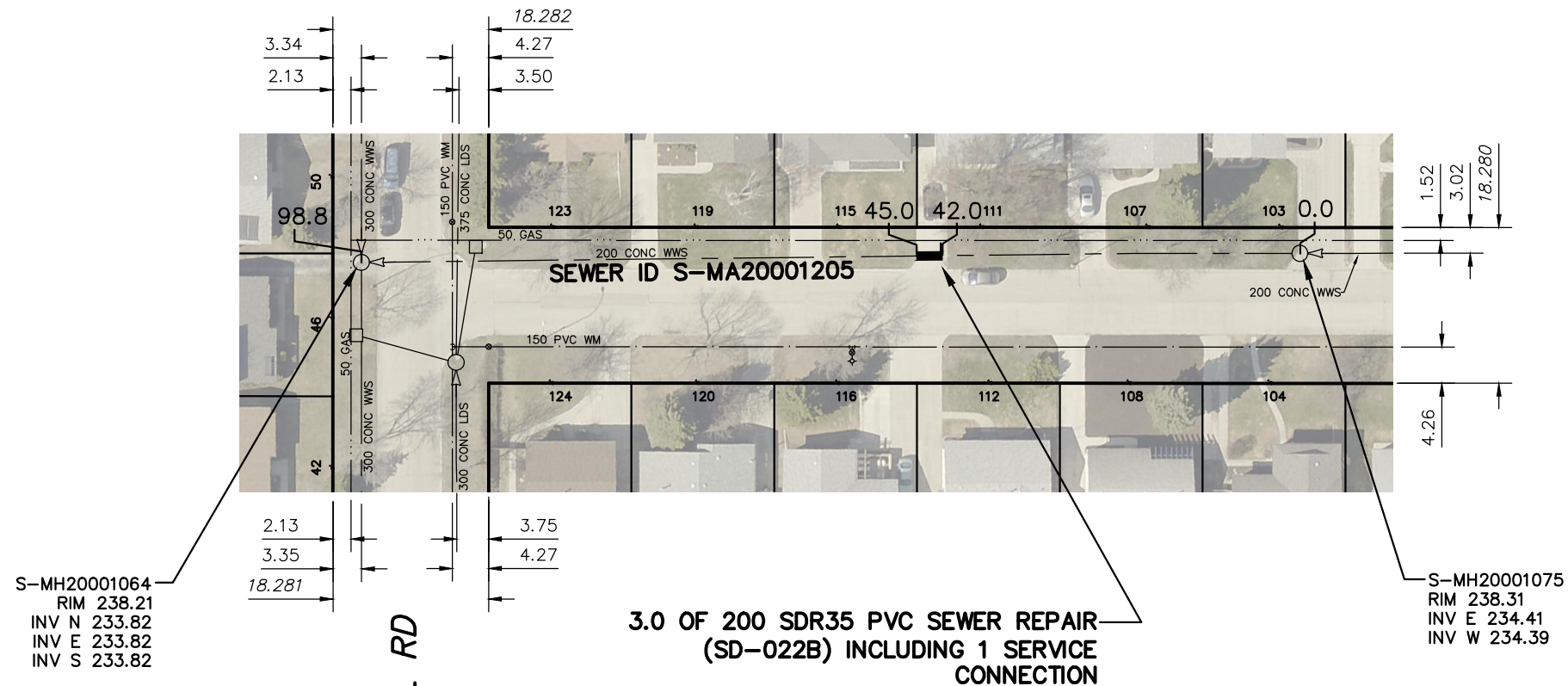

# BUFFIE BAY (N LEG)



SEWER JUNCTION INFORMATION FROM SEWER VIDEO INSPECTION		
SEWER ID S-MA20001205		
DISTANCE FROM MH ID S-MH20001075		
DISTANCE	DIAMETER	CLOCK
6.7	150	11
7.9	150	2
23.8	150	11
25.0	150	2
41.0	150	11
42.2	150	2
***REVERSAL REQUIRED***		

SEWER JUNCTION INFORMATION FROM SEWER VIDEO INSPECTION		
SEWER ID S-MA20001205		
DISTANCE FROM MH ID S-MH20001064		
DISTANCE	DIAMETER	CLOCK
23.8	150	10
25.0	150	2
40.9	150	10
42.2	150	2
***REVERSAL REQUIRED***		

**FOR INDEX SEE 11308**

## METRIC

WHOLE NUMBERS INDICATE MILLIMETRES  
DECIMALIZED NUMBERS INDICATE METRES

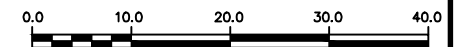

### WARNING

IF POWER EQUIPMENT OR EXPLOSIVES ARE TO BE USED FOR EXCAVATION ON THIS PROJECT THE CONTRACTOR MUST:

- 1) NOTIFY THE GAS COMPANY OF THE PROPOSED LOCATION OF EXCAVATION.
- 2) TAKE PRECAUTION TO AVOID DAMAGE TO GAS COMPANY INSTALLATIONS.

SEE PROVINCIAL REGULATION 210/72 FOR DETAILS

### LOCATION APPROVED UNDERGROUND STRUCTURES

SUPV. U/G STRUCTURES COMMITTEE DATE

#### NOTE:

LOCATION OF UNDERGROUND STRUCTURES AS SHOWN ARE BASED ON THE BEST INFORMATION AVAILABLE BUT NO GUARANTEE IS GIVEN THAT ALL EXISTING UTILITIES ARE SHOWN OR THAT THE GIVEN LOCATIONS ARE EXACT. CONFIRMATION OF EXISTENCE AND EXACT LOCATION OF ALL SERVICES MUST BE OBTAINED FROM THE INDIVIDUAL UTILITIES BEFORE PROCEEDING WITH CONSTRUCTION.

B.M. ELEV.			
NO.	REVISIONS	DATE	BY

DESIGNED BY	TS	CHECKED BY	SC
DRAWN BY	RJ	APPROVED BY	KZ
SCALE:	1:750	RELEASED FOR CONSTRUCTION	K. ZUREK
HORIZONTAL		DATE	
VERTICAL	DATE	2016 11 18	

ENGINEER'S SEAL  
**ORIGINAL SIGNED BY S.R.J. COURNOYER 16/11/14**  
CONSULTANT DRAWING NUMBER -

**THE CITY OF WINNIPEG**  
WATER AND WASTE DEPARTMENT  
ENGINEERING DIVISION

**2016 SEWER MAIN RENEWALS BY EXTERNAL POINT REPAIR BUFFIE BAY (N LEG) 1ST MH E OF GOSWELL ROAD TO MH AT GOSWELL ROAD**

SHEET **7** OF **29**  
CITY DRAWING NUMBER  
**11314**

PLOT DATE: 2016 11 18

BID OPPORTUNITY: 967-2016  
CONTRACT NUMBER: 6A

FILE PATH: R:\DRAWINGS\SEWER\2016 RENEWALS\Contract 6A\CONSTRUCTION\  
FILE NAME: BUFFIE\_S-MA20001205.dwg