

BROADWAY, WESTBOUND

BROADWAY, EASTBOUND

EDMONTON ST

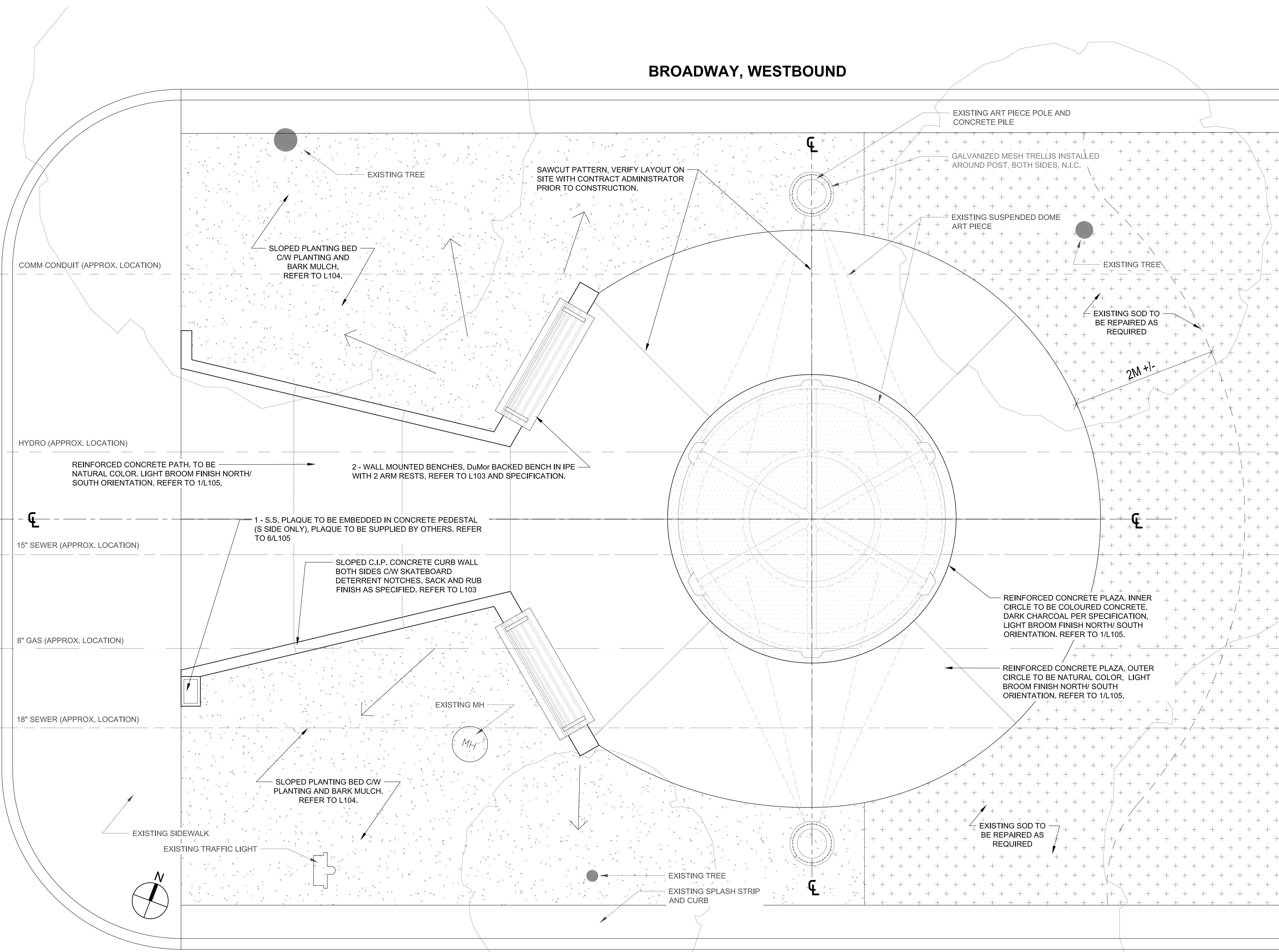

NOTES:

GENERAL NOTES:

1. ALL EXISTING STRUCTURES, TREES, SIDEWALKS, CURBS, SOD, UTILITIES AND PAVING TO BE PROTECTED (UNLESS OTHERWISE NOTED) DURING CONSTRUCTION TO CITY OF WINNIPEG STANDARDS. CONTRACTOR TO MAKE GOOD ALL AREAS DAMAGED DURING CONSTRUCTION BOTH ON AND OFF SITE TO CITY OF WINNIPEG STANDARDS, AND AT NO COST TO THE CITY.
2. CONSTRUCTION ACCESS TO BE LIMITED TO THE ROUTES IDENTIFIED AT THE CONSTRUCTION START UP MEETING OR OTHERWISE NOTED.
3. ALL NOTES IN GRAY INDICATE WORK TO BE COMPLETED BY OTHERS UNDER SEPARATE CONTRACT
4. CONTRACTOR TO BE RESPONSIBLE FOR:
 - A. LOCATING ALL UTILITIES PRIOR TO EXCAVATION
 - B. TAKING NECESSARY PRECAUTION TO PROTECT ALL UTILITIES AND EXISTING INFRASTRUCTURE AND SITE FEATURES PRIOR TO CONSTRUCTION.
 - C. ENSURING PROPER ROAD CLOSURE PERMITS ARE IN PLACE, IF REQUIRED, PRIOR TO CONSTRUCTION
5. CONFIRMATION OF EXISTENCE AND EXACT LOCATION OF ALL SERVICES MUST BE OBTAINED FROM THE INDIVIDUAL UTILITIES BEFORE PROCEEDING WITH CONSTRUCTION
6. CONFIRM ALL EXISTING AND PROPOSED DIMENSIONS, MATERIALS, CONDITIONS ON SITE AND REPORT ANY DISCREPANCIES TO THE CONTRACT ADMINISTRATOR PRIOR TO CONSTRUCTION
7. REFER ALSO TO WRITTEN SPECIFICATIONS

REV	YY/MM/DD	DESCRIPTION	BY
1	16/10/11	REVISED AND RE-ISSUED FOR TENDER	AH
0	16/09/30	ISSUED FOR TENDER	AH

A. SECTION LETTER OR DETAIL NUMBER.
 B. DRAWING WHERE SECTION OR DETAIL IS DRAWN.
 OR
 DRAWING WHERE SECTION OR DETAIL IS INDICATED.
 - SECTION OR DETAIL SHOWN ON SAME DRAWING.

SEAL

SCATLIFF + MILLER + MURRAY
 visionary urban design + landscapes

CLIENT
CITY OF WINNIPEG

PROJECT
BROADWAY PLAZA AND WEBB PLACE SIDEWALK

TITLE
BROADWAY PLAZA SITE AND MATERIALS PLAN

DESIGN	DRAWN	DATE - Y / M / D	SCALE
AH/NH	NH	2016/09/30	1:25 AT 24"x36"
CHECKED	APPROVED	JOB NO.	DRAWING NO.
DKM	DKM	16-0107-006	L102