

2:\Projects\0015 City of Winnipeg\015 014 00 Lyndale Monck to Gauvin\3.4 CAD\3.4.3 Working Folder\015 014 00 SHT09.dwg Last Saved: 9/28/2016 2:16 PM by dnevies Plotted: 9/28/2016 2:16 PM by Daniel Neves ISO A1 - 594mm x 841mm

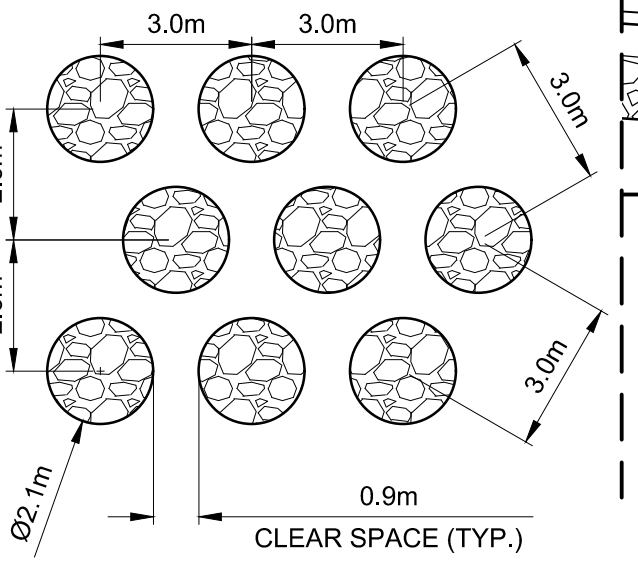
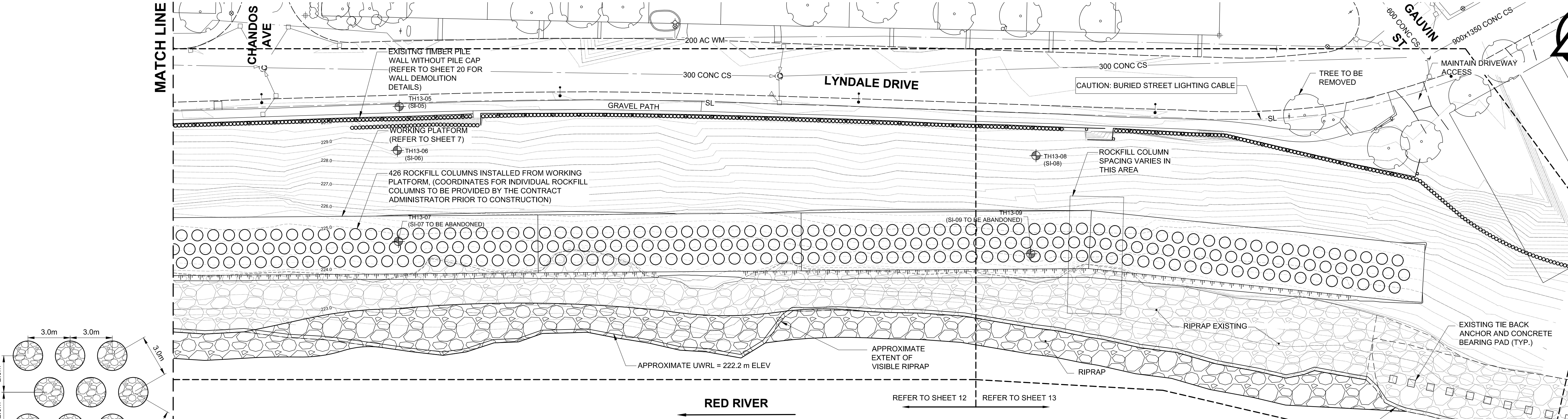
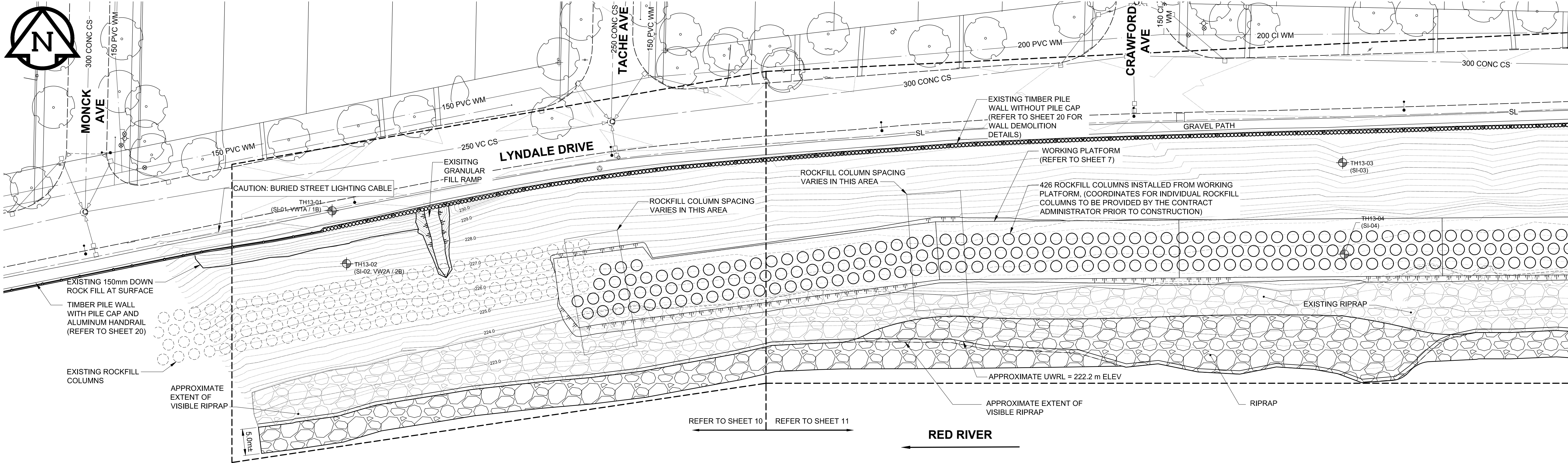
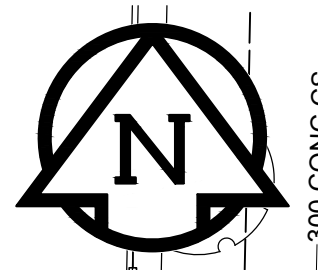

TYPICAL ROCKFILL COLUMN LAYOUT
SCALE 1:150

PLAN
SCALE: 1:400

- NOTE:**
1. UWRL (UNREGULATED WINTER RIVER LEVEL) = APPROXIMATELY 222.2 m ELEV.
 2. EXISTING GEOTECHNICAL INSTRUMENTATION CONSISTING OF SLOPE INCLINOMETER (SI) AND VIBRATING-WIRE PIEZOMETERS (VW) TO BE PROTECTED UNLESS OTHERWISE NOTED.

---	GAS	○	MANHOLE	●	CONCRETE PAVEMENT	---	LOCATION APPROVED UNDERGROUND STRUCTURES
---○---	MTS HANDWELL/PEDESTAL	□	CATCH BASIN/CATCH PIT	■	CONC SIDEWALK/MEDIAN	---	DATE
---△---	HYDRO HANDWELL/CABINET	△	CURB INLET WITH BOX	▲	ASPHALT PAVEMENT	---	DATE
---	CATV/FIBRE OPTIC	○	TREE	○	PAVING STONE	---	DATE
---	TRAFFIC SIGNALS/PIT	⊕	TEST HOLE	⊕	GRAVEL	---	DATE
---	LAND DRAINAGE SEWER	---	PROPERTY LINE	---	RAMP CURB	---	DATE
---	SANITARY/COMBINED SEWER	---	SURVEY BAR	---	PLANING/REMOVAL	---	DATE
---	CB LEAD/SSP/DCP	---	FENCE	---	---	---	DATE
---	WATERMAIN	---	BOC/EDGE OF PAVEMENT	---	---	---	DATE
---	SUBDRAIN	---	ELEVATION	---	---	---	DATE
---	DITCH	---	TRAFFIC SIGN	---	---	---	DATE
---	EXISTING	---	LEGEND - PLAN	---	---	---	DATE
---	NEW	---	LEGEND - PLAN	---	---	---	DATE

LOCATION APPROVED UNDERGROUND STRUCTURES

DATE

NOTE:
LOCATION OF UNDERGROUND STRUCTURES AS SHOWN ARE BASED ON THE BEST INFORMATION AVAILABLE BUT NO GUARANTEE IS GIVEN THAT ALL EXISTING UTILITIES ARE SHOWN OR THAT THE GIVEN LOCATIONS ARE EXACT. CONFIRMATION OF EXISTENCE AND EXACT LOCATION OF ALL SERVICES MUST BE OBTAINED FROM THE INDIVIDUAL UTILITIES BEFORE PROCEEDING WITH CONSTRUCTION.

BM 34-007	ELEV 231.455 m	S.W. Cor. Tache Ave. and Lyndale Dr. Toll In E. Cor. Pile 11.9 W. of E.L. of Tache Ave. & 2.7 S. of S. curb of Pav'l on Lyndale Dr.	
C	ISSUED FOR TENDER	16/09/29	MVH
B	ISSUED FOR 90% REVIEW	16/09/09	MVH
A	ISSUED FOR 75% REVIEW	16/08/17	MVH
No.	REVISIONS	YY/MM/DD	BY

DESIGNED BY	MVH	CHECKED BY	KMS
DRAWN BY	BIT	APPROVED BY	
RELEASED FOR CONSTRUCTION			
DATE	16/09/29	DATE	



METRIC
WHOLE NUMBERS INDICATE MILLIMETRES
DECIMAL NUMBERS INDICATE METRES

THE CITY OF WINNIPEG
PUBLIC WORKS DEPARTMENT
ENGINEERING DIVISION

LYNDALE DRIVE RIVERBANK STABILIZATION AND ASSOCIATED WORKS
MONCK AVENUE TO GAUVIN STREET
RIVERBANK STABILIZATION WORKS GENERAL LAYOUT

CITY DRAWING NUMBER: RW751-2016-009
SHEET 9 OF 32
DRAWING No. 9 REV C

BID OPPORTUNITY No. 721-2016

