

REFER TO C2-LS-015 FOR GRANT AVE LANDSCAPE PLAN

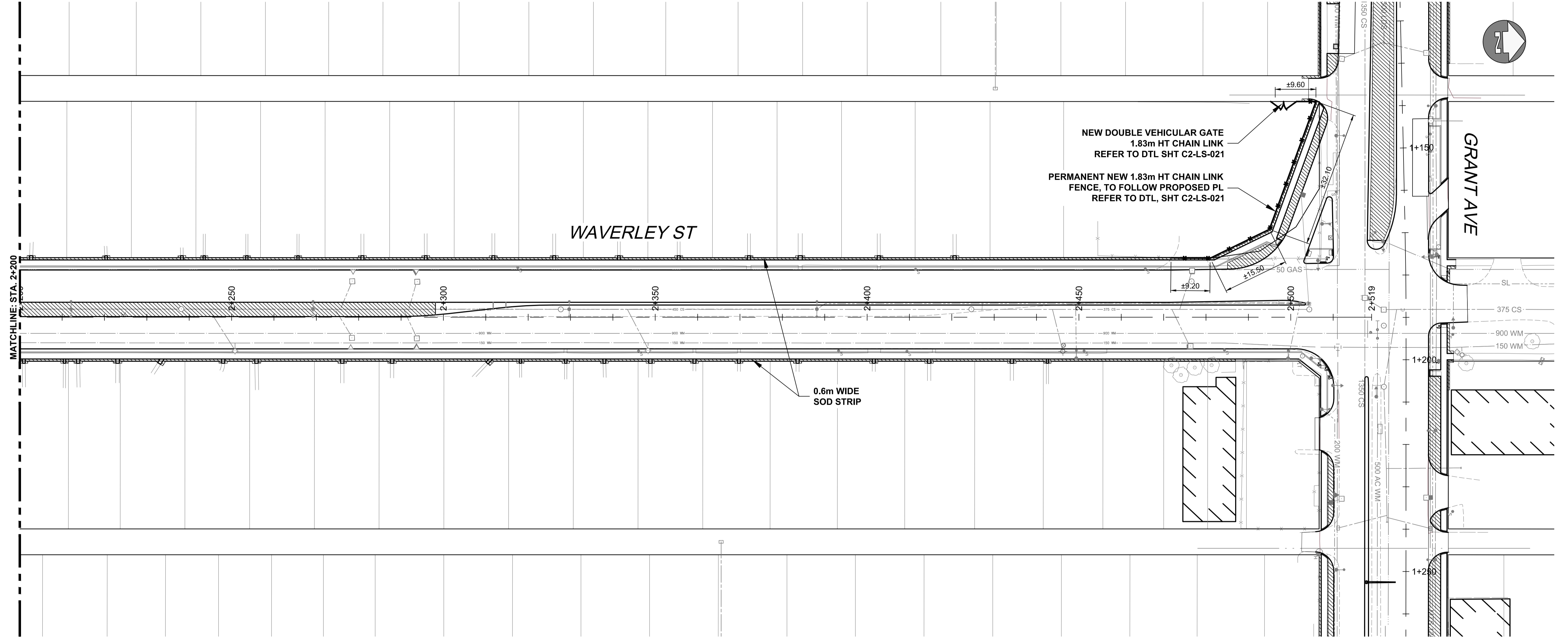

MATCHLINE: STA. 2+200

NEW DOUBLE VEHICULAR GATE
1.83m HT CHAIN LINK
REFER TO DTL SHT C2-LS-021

PERMANENT NEW 1.83m HT CHAIN LINK
FENCE, TO FOLLOW PROPOSED PL
REFER TO DTL, SHT C2-LS-021

WAVERLEY ST

GRANT AVE

0.6m WIDE
SOD STRIP

LEGEND

BLUEGRASS/FESCUE SOD

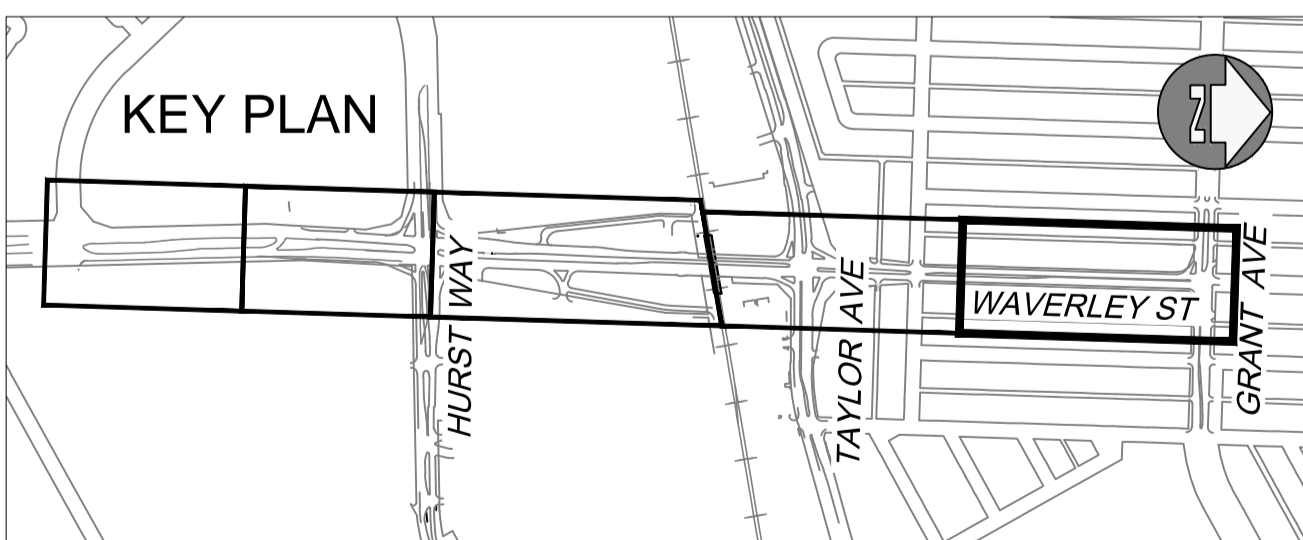

WARNING

- IF POWER EQUIPMENT OR EXPLOSIVES ARE TO BE USED FOR EXCAVATION ON THIS PROJECT THE CONTRACTOR MUST:
1. NOTIFY THE GAS COMPANY OF THE PROPOSED LOCATION OF EXCAVATION.
 2. TAKE PRECAUTION TO AVOID DAMAGE TO GAS COMPANY INSTALLATIONS SEE PROVINCIAL REGULATION 210/72 FOR DETAILS.
 3. OBTAIN EXCAVATION PERMITS PRIOR TO CONSTRUCTION.

METRIC
WHOLE NUMBERS INDICATE MILLIMETRES
DECIMALIZED NUMBERS INDICATE METRES

APEGM
Certificate of Authorization
UMA Engineering Ltd. (MB)
No. 256 Date: 17/01/09

150 WM	WATERMAIN	150 WM	CONCRETE				
	HYDRANT		ASPHALT				
	VALVE		SIDEWALK				
	MANHOLE		PAVING STONES				
	CATCH BASIN		PROPERTY LINE				
	CURB INLET		DRAINAGE ARROW				
300 LDS	LAND DRAINAGE SEWER	300 LDS	CURB RAMP				
250 WWS	WASTE WATER SEWER	250 WWS	CULVERT				
HYDRO	HYDRO	HYDRO					
M.T.S.	M.T.S.	M.T.S.					
100 GAS	GAS	100 GAS					
EXISTING	LEGEND-PLAN	PROPOSED	EXISTING	LEGEND-PROFILE	PROPOSED		

UNDERGROUND STRUCTURES							
SUPV. U/G STRUCTURES		DATE					
<p>LOCATION OF UNDERGROUND STRUCTURES AS SHOWN ARE BASED ON THE BEST INFORMATION AVAILABLE. BUT NO GUARANTEE IS GIVEN THAT ALL EXISTING UTILITIES ARE SHOWN OR THAT THE GIVEN LOCATIONS ARE EXACT. CONFIRMATION OF EXISTENCE AND EXACT LOCATION OF ALL SERVICES MUST BE OBTAINED FROM THE INDIVIDUAL UTILITIES BEFORE PROCEEDING WITH CONSTRUCTION.</p>							

B.M. ELEV.							
0	ISSUED FOR TENDER	17/01/09	LJV				
NO.	REVISIONS	DATE	BY	DATE			

AECOM			
DESIGNED BY	LJV	CHECKED BY	
DRAWN BY	LJV	APPROVED BY	
HOR. SCALE	1:500	RELEASED FOR CONSTRUCTION	
VERTICAL	NA		
CONSULTANT PROJECT NUMBER			
60321148			

<p>ENGINEER'S SEAL the manitoba association of landscape architects L. JOY VIBERG member no. 125</p>	
<p>CONSULTANT PROJECT NUMBER 60321148</p>	

<p>THE CITY OF WINNIPEG PUBLIC WORKS DEPARTMENT</p>	
<p>WAVERLEY STREET UNDERPASS AT CN MILE 3.89 RIVERS SUB CONTRACT 2: UNDERPASS STRUCTURE, RAILWORKS, ROADWORKS, LAND DRAINAGE SEWER, PUMPING STATION AND LANDSCAPING WORKS</p>	
<p>WAVERLEY STREET - STA. 2+200 TO END LANDSCAPE PLAN</p>	
<p>CITY DRAWING NUMBER U-239-2016-C2-LS-007</p>	<p>SHEET OF 007 OF 021</p>
<p>CONSULTANT DRAWING NUMBER C2-LS-007</p>	

PA: 60321148; 900-Work\910-CAD\20-SHEETS\163353-C2-CON-LS-WAVERLEY.dwg