

CHAINAGE ALONG WB MEDIAN OF TAYLOR AVE

EXISTING STORM WATER RETENTION BASIN
SRB 6-22:
NWL - 229.82
HWL - 231.04

NOTE: REFER TO LDS STRUCTURE & LOCATION SCHEDULE ON DRAWING C2-CU-035 FOR FURTHER CATCHBASIN, CATCHPIT, DITCH INLET & MANHOLE INFORMATION

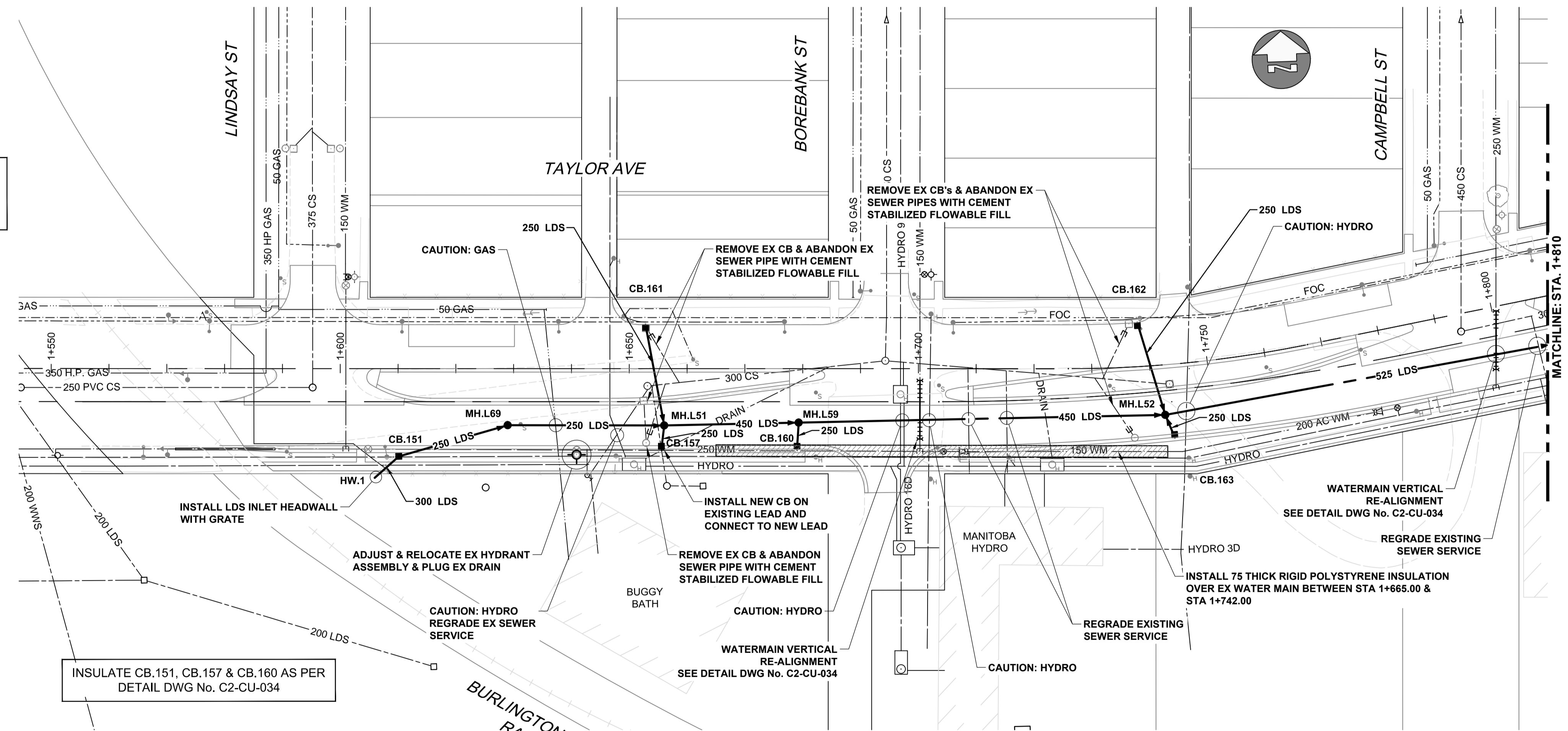

WARNING

- IF POWER EQUIPMENT OR EXPLOSIVES ARE TO BE USED FOR EXCAVATION ON THIS PROJECT THE CONTRACTOR MUST:
1. NOTIFY THE GAS COMPANY OF THE PROPOSED LOCATION OF EXCAVATION.
 2. TAKE PRECAUTION TO AVOID DAMAGE TO GAS COMPANY INSTALLATIONS SEE PROVINCIAL REGULATION 210/72 FOR DETAILS.
 3. OBTAIN EXCAVATION PERMITS PRIOR TO CONSTRUCTION.

INSULATE CB.151, CB.157 & CB.160 AS PER DETAIL DWG No. C2-CU-034

METRIC
WHOLE NUMBERS INDICATE MILLIMETRES
DECIMALIZED NUMBERS INDICATE METRES

APECM
Certificate of Authorization
AECOM Canada Ltd.
No. 4671 Date: _____
BID OPPORTUNITY NO. 473-2016

| EXISTING | LEGEND - PLAN | NEW | EXISTING | LEGEND - PLAN | NEW | EXISTING | LEGEND - PROFILE | NEW |
|----------|--------------------------|---------|-------------------|---------------|---------------------|----------|--|------------|
| 150 WM | WATER MAIN | 150 WM | PIPE ABANDONMENTS | 150 WM | WATER MAIN | 150 WM | UNDERGROUND STRUCTURES | B.M. ELEV. |
| ⊕ | HYDRANT | ⊕ | ⊕ | ⊕ | HYDRANT | ⊕ | SUPV. U/G STRUCTURES | DATE |
| ⊕ | VALVE | ⊕ | ⊕ | ⊕ | VALVE | ⊕ | LOCATION OF UNDERGROUND STRUCTURES AS SHOWN ARE BASED ON THE BEST INFORMATION AVAILABLE. BUT NO GUARANTEE IS GIVEN THAT ALL EXISTING UTILITIES ARE SHOWN OR THAT THE GIVEN LOCATIONS ARE EXACT. CONFIRMATION OF EXISTENCE AND EXACT LOCATION OF ALL SERVICES MUST BE OBTAINED FROM THE INDIVIDUAL UTILITIES BEFORE PROCEEDING WITH CONSTRUCTION. | |
| 300 LDS | LAND DRAINAGE SEWER | 300 LDS | ⊕ | ⊕ | LAND DRAINAGE SEWER | 300 LDS | | |
| 250 WWS | WASTE WATER SEWER | 250 WWS | ⊕ | ⊕ | WASTE WATER SEWER | 250 WWS | | |
| --- | SEWER SERVICE PIPE | --- | ⊕ | ⊕ | PAVEMENT CROWN | --- | | |
| --- | DRAINAGE CONNECTION PIPE | --- | ⊕ | ⊕ | N/W PROPERTY LINE | --- | | |
| ○ | MANHOLE | ○ | ⊕ | ⊕ | S/E PROPERTY LINE | --- | | |
| □ | CATCH BASIN | □ | ⊕ | ⊕ | N/W GUTTER | --- | | |
| △ | CURB INLET | △ | ⊕ | ⊕ | S/E GUTTER | --- | | |
| --- | CULVERT | --- | ⊕ | ⊕ | TESTHOLE | --- | | |
| --- | LEGEND - PLAN | --- | ⊕ | ⊕ | LAMP STANDARD | --- | | |

| DESIGNED BY | MPG | CHECKED BY | |
|-------------|-------------------|---------------------------|-----|
| DRAWN BY | KLC | APPROVED BY | |
| HOR. SCALE | 1:500 | RELEASED FOR CONSTRUCTION | |
| VERTICAL | 1:100 | | |
| 0 | ISSUED FOR TENDER | 17/01/09 | Wjd |
| NO. | REVISIONS | DATE | BY |

AECOM

CONSULTANT PROJECT NUMBER: 60321148

ENGINEER'S SEAL
PROVINCE OF MANITOBA
M.P.A. GAUDREAU
Member 32167
REGISTERED PROFESSIONAL ENGINEER

THE CITY OF WINNIPEG
PUBLIC WORKS DEPARTMENT

WAVERLEY STREET UNDERPASS AT CN MILE 3.89 RIVERS SUB
CONTRACT 2: UNDERPASS STRUCTURE, RAILWORKS,
ROADWORKS, LAND DRAINAGE SEWER, PUMPING STATION
AND LANDSCAPING WORKS

TAYLOR AVENUE - PLAN/PROFILE
LDS
STA 1+550 to STA 1+810

CITY DRAWING NUMBER: U239-2016-C2-CU-016
SHEET 16 OF 41
CONSULTANT DRAWING NUMBER: C2-CU-016

P:\60321148\900-Work\9100-DD CAD\200-SHEETS\Municipal\63353-C2-CON-CU-Taylor-001.dwg