

- CONSTRUCTION NOTES:**
- ISOLATE MISCELLANEOUS ITEMS IN NEW CONCRETE WORKS AS PER SD-228C.
  - LEGAL PLAN AND UNDERGROUND INFORMATION FROM CITY OF WINNIPEG L.B.S. CONTRACTOR VERIFY ALL UNDERGROUNDS IN THE FIELD.
  - CONTRACTOR TO TAKE PRECAUTIONARY STEPS TO AVOID DAMAGE FROM CONSTRUCTION ACTIVITIES TO TREES WITHIN THE LIMITS OF CONSTRUCTION.
  - LOCATION OF EXISTING SERVICES TO BE CONFIRMED IN THE FIELD BY THE CONTRACTOR.
  - INSTALL CB LEADS AT MIN. 1.0% SLOPE OR AS DIRECTED BY CONTRACT ADMINISTRATOR.
  - FOR CB LEADS, RIP RAP AND LDS INFORMATION SEE "CU" DRAWINGS.
  - CONTRACTOR SHALL CONFIRM EXISTING LEAD INVERT ELEVATIONS PRIOR TO INSTALLATION.

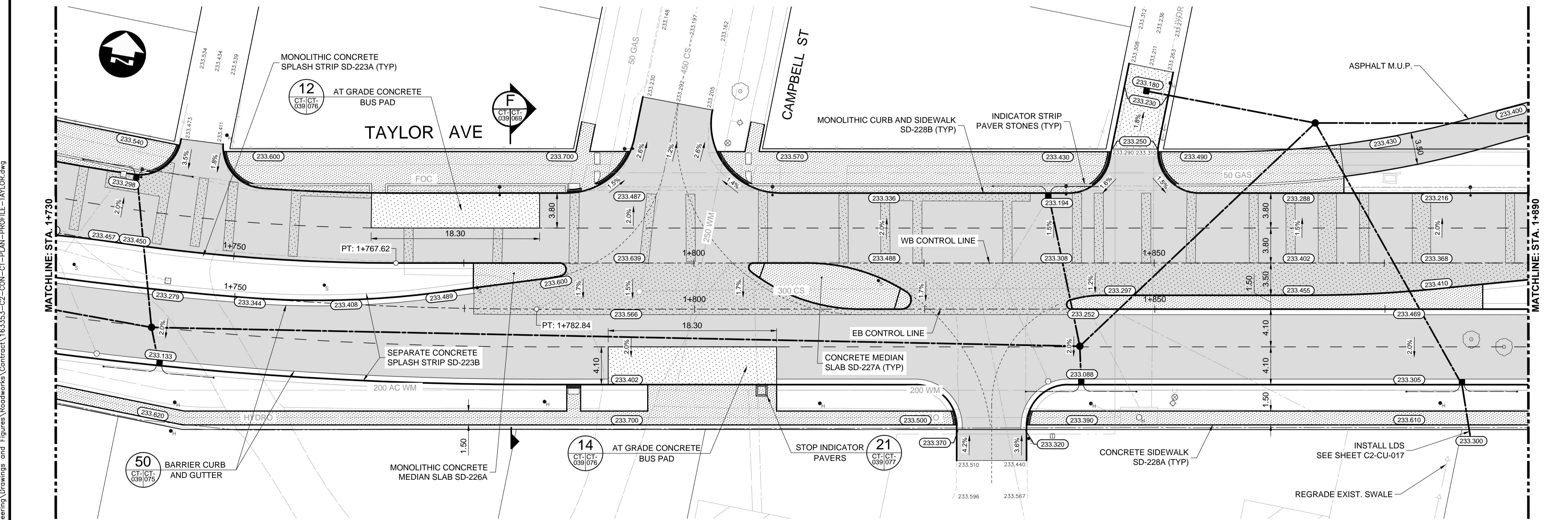

**METRIC**

WHOLE NUMBERS INDICATE MILLIMETRES  
DECIMALIZED NUMBERS INDICATE METRES

- WARNING**
- IF POWER EQUIPMENT OR EXPLOSIVES ARE TO BE USED FOR EXCAVATION ON THIS PROJECT THE CONTRACTOR MUST:
- NOTIFY THE GAS COMPANY OF THE PROPOSED LOCATION OF EXCAVATION.
  - TAKE PRECAUTION TO AVOID DAMAGE TO GAS COMPANY INSTALLATIONS SEE PROVINCIAL REGULATION 210/72 FOR DETAILS.
  - OBTAIN EXCAVATION PERMITS PRIOR TO CONSTRUCTION.



150 WM	WATERMAIN	150 WM	CONCRETE	150 WM	WATERMAIN	150 WM	WATERMAIN
300 LDS	HYDRANT VALVE	300 LDS	ASPHALT PLANING SIDEWALK	300 LDS	LAND DRAINAGE SEWER	300 LDS	LAND DRAINAGE SEWER
250 WWS	MANHOLE	250 WWS	PAVING STONES	250 WWS	WASTE WATER SEWER	250 WWS	WASTE WATER SEWER
300 LDS	CATCH BASIN	300 LDS	PARTIAL DEPTH REPAIR	300 LDS	HYDRANT	300 LDS	HYDRANT
250 WWS	CURB INLET	250 WWS	PROPERTY LINE	250 WWS	VALVE	250 WWS	VALVE
HYDRO	LAND DRAINAGE SEWER	HYDRO	DRAINAGE ARROW	HYDRO	C PROFILE	HYDRO	C PROFILE
M.T.S.	WASTE WATER SEWER	M.T.S.	CURB RAMP (SD-229C)	M.T.S.	NORTH/WEST GUTTER	M.T.S.	NORTH/WEST GUTTER
100 GAS	HYDRO	100 GAS	DETECTABLE WARNING SURFACE TILE (SD-229AA)	100 GAS	SOUTH/EAST GUTTER	100 GAS	SOUTH/EAST GUTTER
EXISTING	LEGEND-PLAN	PROPOSED	EXISTING	LEGEND-PLAN	PROPOSED	EXISTING	LEGEND-PROFILE

**UNDERGROUND STRUCTURES**

SUPPLY, U/G STRUCTURES DATE

LOCATION OF UNDERGROUND STRUCTURES AS SHOWN ARE BASED ON THE BEST INFORMATION AVAILABLE BUT NO GUARANTEE IS GIVEN THAT ALL EXISTING UTILITIES ARE SHOWN OR THAT THE GIVEN LOCATIONS ARE EXACT. CONFIRMATION OF EXISTENCE AND EXACT LOCATION OF ALL SERVICES MUST BE OBTAINED FROM THE INDIVIDUAL UTILITIES BEFORE PROCEEDING WITH CONSTRUCTION.

B.M. ELEV.	SEE SHEET C2-CT-007 FOR CONTROL POINT INFORMATION
0	ISSUED FOR TENDER
NO.	REVISIONS

**DILLON CONSULTING**

DESIGNED BY	RTP	CHECKED BY	DBW
DRAWN BY	RD	APPROVED BY	DBW
HOR. SCALE	1:250	RELEASED FOR CONSTRUCTION	
VERTICAL	1:10	DATE	

**ENGINEER'S SEAL**

PROVINCE OF MANITOBA  
REGISTERED PROFESSIONAL ENGINEER  
D.B. WIEBE  
Member 22480

CONSULTANT PROJECT NUMBER  
16-3353

**THE CITY OF WINNIPEG PUBLIC WORKS DEPARTMENT**

Waverley Street Underpass at CN Mile 3.89 Rivers Sub  
Contract 2: Underpass Structures, Railworks, Roadworks, Land Drainage Sewer, Pumping Station and Landscaping Works

TAYLOR AVENUE - STA. 1+730 TO 1+890 (PLAN-PROFILE)

CITY DRAWING NUMBER  
U-239-2016-C2-CT-039  
SHEET 039 OF 081  
CONSULTANT DRAWING NUMBER  
C2-CT-039

G:\CAD\163353\Technical\Workspaces\Engineering\Drawings and Figures\Roadworks\Contract\163353-C2-CON-CT-PLAN-PROFILE-TAYLOR.dwg