

CONSTRUCTION NOTES:

- ISOLATE MISCELLANEOUS ITEMS IN NEW CONCRETE WORKS AS PER SD-228C.
- LEGAL PLAN AND UNDERGROUND INFORMATION FROM CITY OF WINNIPEG LBIS. CONTRACTOR VERIFY ALL UNDERGROUNDS IN THE FIELD.
- CONTRACTOR TO TAKE PRECAUTIONARY STEPS TO AVOID DAMAGE FROM CONSTRUCTION ACTIVITIES TO TREES WITHIN THE LIMITS OF CONSTRUCTION.
- LOCATION OF EXISTING SERVICES TO BE CONFIRMED IN THE FIELD BY THE CONTRACTOR.
- INSTALL CB LEADS AT MIN. 1.0% SLOPE OR AS DIRECTED BY CONTRACT ADMINISTRATOR.
- FOR CB LEADS, RIP RAP AND LDS INFORMATION SEE "CU" DRAWINGS.
- CONTRACTOR SHALL CONFIRM EXISTING LEAD INVERT ELEVATIONS PRIOR TO INSTALLATION.

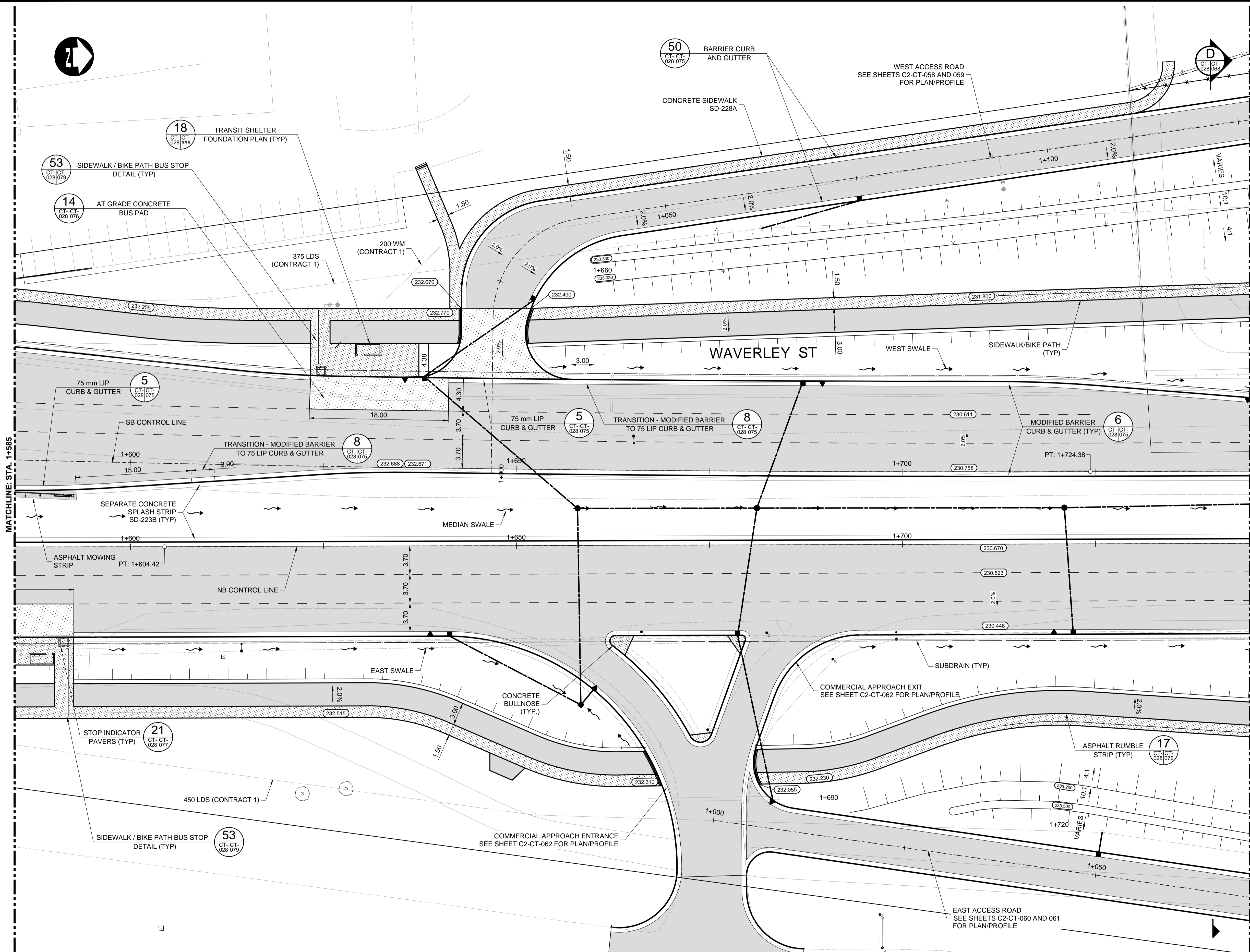

METRIC

WHOLE NUMBERS INDICATE MILLIMETRES
DECIMALIZED NUMBERS INDICATE METRES

WARNING

IF POWER EQUIPMENT OR EXPLOSIVES ARE TO BE USED FOR EXCAVATION ON THIS PROJECT THE CONTRACTOR MUST:

- NOTIFY THE GAS COMPANY OF THE PROPOSED LOCATION OF EXCAVATION.
- TAKE PRECAUTION TO AVOID DAMAGE TO GAS COMPANY INSTALLATIONS SEE PROVINCIAL REGULATION 210/72 FOR DETAILS.
- OBTAIN EXCAVATION PERMITS PRIOR TO CONSTRUCTION.

APEGM
Certificate of Authorization
Dillon Consulting Limited (MB)
No. 1789 Date: 17/01/09

G:\CAD\163353\Technical\Workspaces\Drawings and Figures\Roadworks\Contract\163353-C2-CON-CT-PLAN-PROFILE-WAVERLEY-SOUTH.dwg

| EXISTING | LEGEND-PLAN | PROPOSED | EXISTING | LEGEND-PLAN | PROPOSED | EXISTING | LEGEND-PROFILE | PROPOSED |
|----------|---------------------|----------|--|-------------|---------------------|----------|---------------------|----------|
| 150 WM | WATERMAIN | 150 WM | CONCRETE | 150 WM | WATERMAIN | 150 WM | WATERMAIN | 150 WM |
| 300 LDS | HYDRANT | 300 LDS | ASPHALT | 300 LDS | LAND DRAINAGE SEWER | 300 LDS | LAND DRAINAGE SEWER | 300 LDS |
| 250 WWS | VALVE | 250 WWS | PLANING | 250 WWS | WASTE WATER SEWER | 250 WWS | WASTE WATER SEWER | 250 WWS |
| 300 LDS | MANHOLE | 300 LDS | SIDEWALK | 300 LDS | HYDRANT | 300 LDS | HYDRANT | 300 LDS |
| 250 WWS | CATCH BASIN | 250 WWS | PAVING STONES | 250 WWS | VALVE | 250 WWS | VALVE | 250 WWS |
| 100 GAS | CURB INLET | 100 GAS | PARTIAL DEPTH REPAIR | 100 GAS | PROFILE | 100 GAS | PROFILE | 100 GAS |
| 100 GAS | LAND DRAINAGE SEWER | 100 GAS | PROPERTY LINE | 100 GAS | NORTH/WEST GUTTER | 100 GAS | NORTH/WEST GUTTER | 100 GAS |
| 100 GAS | WASTE WATER SEWER | 100 GAS | DRAINAGE ARROW | 100 GAS | SOUTH/EAST GUTTER | 100 GAS | SOUTH/EAST GUTTER | 100 GAS |
| 100 GAS | HYDRO | 100 GAS | CURB RAMP (SD-229C) | 100 GAS | NORTH/WEST DITCH | 100 GAS | NORTH/WEST DITCH | 100 GAS |
| 100 GAS | M.T.S. | 100 GAS | DETECTABLE WARNING SURFACE TILE (SD-229AA) | 100 GAS | SOUTH/EAST DITCH | 100 GAS | SOUTH/EAST DITCH | 100 GAS |
| 100 GAS | GAS | 100 GAS | | 100 GAS | | 100 GAS | | 100 GAS |

UNDERGROUND STRUCTURES

SUPPLY: U/G STRUCTURES DATE

LOCATION OF UNDERGROUND STRUCTURES AS SHOWN ARE BASED ON THE BEST INFORMATION AVAILABLE, BUT NO GUARANTEE IS GIVEN THAT ALL EXISTING UTILITIES ARE SHOWN OR THAT THE GIVEN LOCATIONS ARE EXACT. CONFIRMATION OF EXISTENCE AND EXACT LOCATION OF ALL SERVICES MUST BE OBTAINED FROM THE INDIVIDUAL UTILITIES BEFORE PROCEEDING WITH CONSTRUCTION.

| B.M. ELEV. | SEE SHEET C2-CT-007 FOR CONTROL POINT INFORMATION | DATE |
|------------|---|------|
| | | |
| | | |

| | | | |
|-------------|-------------------|---------------------------|-----|
| DESIGNED BY | RTP | CHECKED BY | DBW |
| DRAWN BY | TJH | APPROVED BY | DBW |
| HOR. SCALE | 1:250 | RELEASED FOR CONSTRUCTION | |
| VERTICAL | 1:10 | DATE | |
| 0 | ISSUED FOR TENDER | 17/01/09 | DBW |
| NO. | REVISIONS | DATE | BY |

ENGINEER'S SEAL

PROVINCE OF MANITOBA

D.B. WIEBE
Member 22480
REGISTERED PROFESSIONAL ENGINEER

CONSULTANT PROJECT NUMBER
16-3353

THE CITY OF WINNIPEG
PUBLIC WORKS DEPARTMENT

Winnipeg

WAVELEY STREET UNDERPASS AT CN MILE 3.89 RIVERS SUB CONTRACT 2: UNDERPASS STRUCTURES, RAILWORKS, ROADWORKS, LAND DRAINAGE SEWER, PUMPING STATION AND LANDSCAPING WORKS

WAVELEY STREET - STA. 1+585 TO 1+745 (PLAN VIEW)

CITY DRAWING NUMBER
U-239-2016-C2-CT-028
SHEET 028 OF 081
CONSULTANT DRAWING NUMBER
C2-CT-028