

WAVERLEY STREET SOUTHBOUND

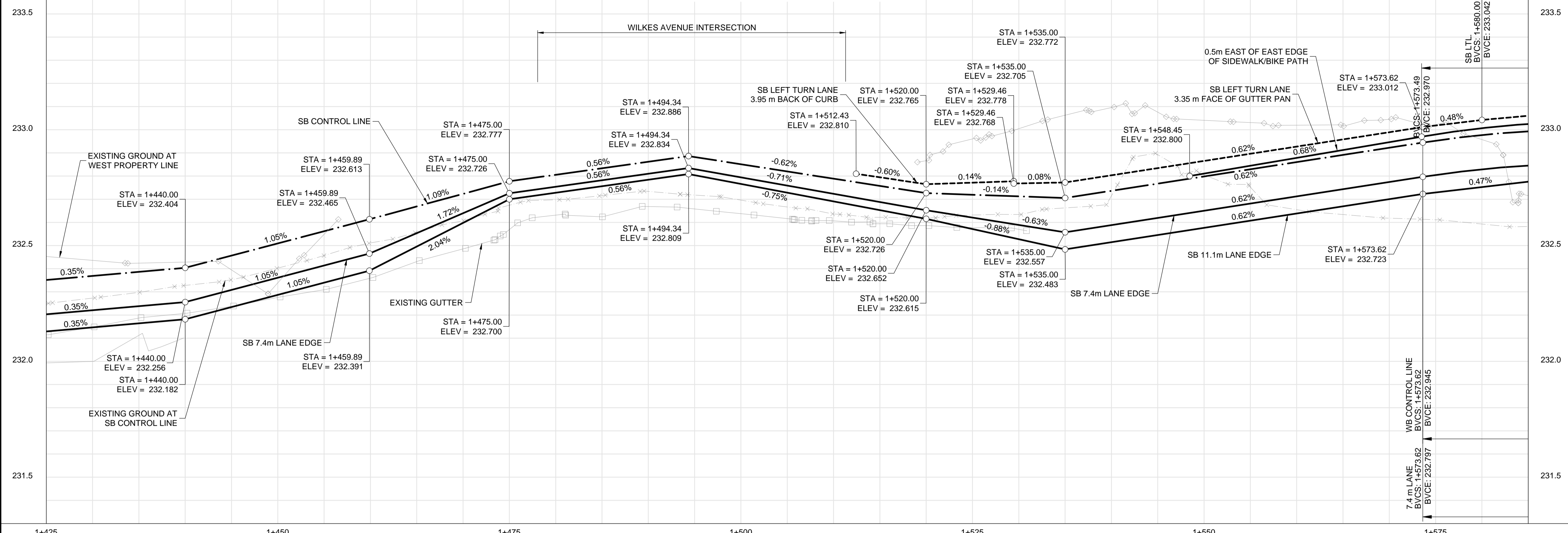

- CONSTRUCTION NOTES:**
- ISOLATE MISCELLANEOUS ITEMS IN NEW CONCRETE WORKS AS PER SD-228C.
 - LEGAL PLAN AND UNDERGROUND INFORMATION FROM CITY OF WINNIPEG LBIS. CONTRACTOR VERIFY ALL UNDERGROUNDS IN THE FIELD.
 - CONTRACTOR TO TAKE PRECAUTIONARY STEPS TO AVOID DAMAGE FROM CONSTRUCTION ACTIVITIES TO TREES WITHIN THE LIMITS OF CONSTRUCTION.
 - LOCATION OF EXISTING SERVICES TO BE CONFIRMED IN THE FIELD BY THE CONTRACTOR.
 - INSTALL CB LEADS AT MIN. 1.0% SLOPE OR AS DIRECTED BY CONTRACT ADMINISTRATOR.
 - FOR CB LEADS, RIP RAP AND LDS INFORMATION SEE "CU" DRAWINGS.
 - CONTRACTOR SHALL CONFIRM EXISTING LEAD INVERT ELEVATIONS PRIOR TO INSTALLATION.

WAVERLEY STREET NORTHBOUND

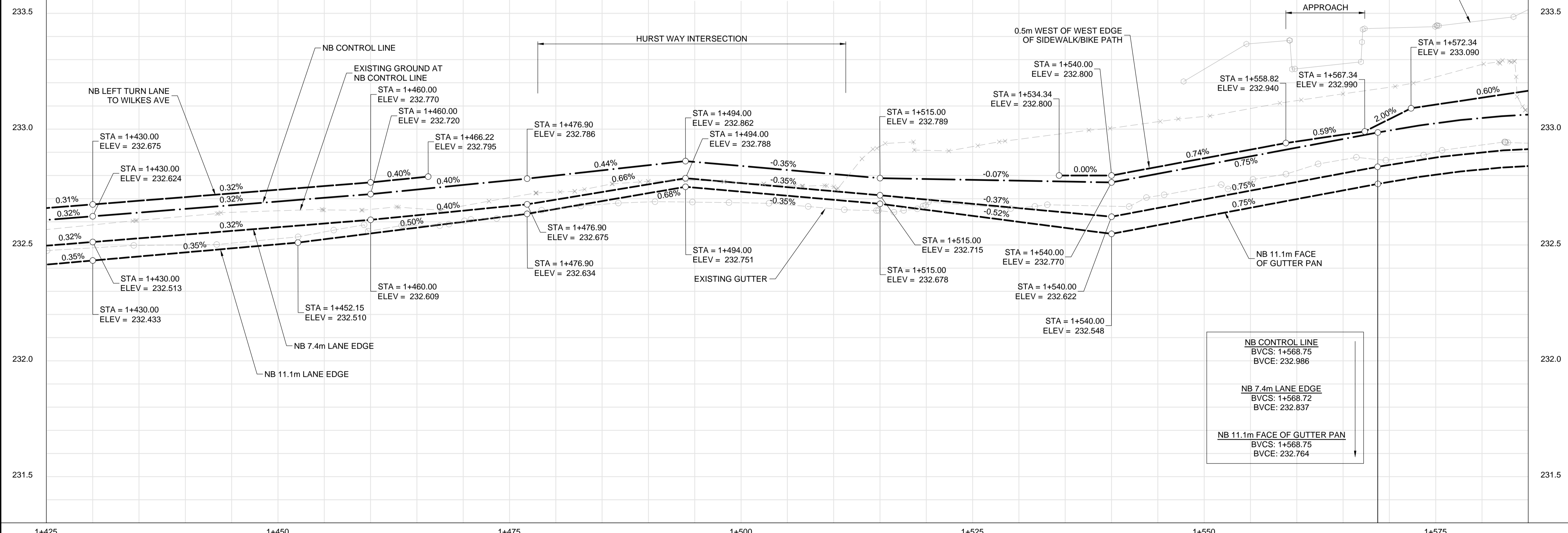

METRIC
WHOLE NUMBERS INDICATE MILLIMETRES
DECIMALIZED NUMBERS INDICATE METRES

WARNING
IF POWER EQUIPMENT OR EXPLOSIVES ARE TO BE USED FOR EXCAVATION ON THIS PROJECT THE CONTRACTOR MUST:

- NOTIFY THE GAS COMPANY OF THE PROPOSED LOCATION OF EXCAVATION.
- TAKE PRECAUTION TO AVOID DAMAGE TO GAS COMPANY INSTALLATIONS SEE PROVINCIAL REGULATION 210/72 FOR DETAILS.
- OBTAIN EXCAVATION PERMITS PRIOR TO CONSTRUCTION.



G:\CAD\163353\Technical\Workspaces\Drawings and Figures\Roadworks\Contract\163353-C2-CON-CT-PLAN-PROFILE-WAVERLEY-SOUTH.dwg

150 WWS	WATERMAIN	150 WM	CONCRETE	150 WWS	WATERMAIN	150 WM
	HYDRANT		ASPHALT		LAND DRAINAGE SEWER	
	VALVE		PLANING		WASTE WATER SEWER	
	MANHOLE		SIDEWALK		HYDRANT	
	CATCH BASIN		PAVING STONES		VALVE	
	CURB INLET		PARTIAL DEPTH REPAIR		PROFILE	
	LAND DRAINAGE SEWER		PROPERTY LINE		NORTH/WEST GUTTER	
	WASTE WATER SEWER		DRAINAGE ARROW		SOUTH/EAST GUTTER	
	HYDRO		CURB RAMP (SD-229C)		NORTH/WEST DITCH	
	M.T.S.		DETECTABLE WARNING		SOUTH/EAST DITCH	
	GAS		SURFACE TILE (SD-229AA)			
	EXISTING		LEGEND-PLAN		EXISTING	
	PROPOSED		LEGEND-PROFILE		PROPOSED	

UNDERGROUND STRUCTURES

SUPPLY: U/G STRUCTURES DATE

LOCATION OF UNDERGROUND STRUCTURES AS SHOWN ARE BASED ON THE BEST INFORMATION AVAILABLE BUT NO GUARANTEE IS GIVEN THAT ALL EXISTING UTILITIES ARE SHOWN OR THAT THE GIVEN LOCATIONS ARE EXACT. CONFIRMATION OF EXISTENCE AND EXACT LOCATION OF ALL SERVICES MUST BE OBTAINED FROM THE INDIVIDUAL UTILITIES BEFORE PROCEEDING WITH CONSTRUCTION.

B.M. ELEV.

SEE SHEET C2-CT-007 FOR CONTROL POINT INFORMATION

NO.	REVISIONS	DATE	BY
0	ISSUED FOR TENDER	17/01/09	DBW

DESIGNED BY RTP

CHECKED BY DBW

DRAWN BY TJH

APPROVED BY DBW

HOR. SCALE 1:250

RELEASED FOR CONSTRUCTION

VERTICAL 1:10

CONSULTANT PROJECT NUMBER 16-3353

THE CITY OF WINNIPEG PUBLIC WORKS DEPARTMENT

WAVERLEY STREET UNDERPASS AT CN MILE 3.89 RIVERS SUB CONTRACT 2: UNDERPASS STRUCTURES, RAILWORKS, ROADWORKS, LAND DRAINAGE SEWER, PUMPING STATION AND LANDSCAPING WORKS

WAVERLEY STREET - STA. 1+425 TO 1+585 (SB & NB PROFILES)

CITY DRAWING NUMBER U-239-2016-C2-CT-024

SHEET 024 **OF** 081

CONSULTANT DRAWING NUMBER C2-CT-024