

TAYLOR MULTI-USE PATH (M.U.P.)						
SEGMENT	STATION (START)	STATION (END)	NORTHING (START)	EASTING (START)	NORTHING (END)	EASTING (END)
L100	1+000.000	1+050.534	5523520.790	629957.780	5523529.204	630007.609
C100	1+050.534	1+079.596	5523529.204	630007.609	5523538.110	630035.165
C101	1+079.596	1+137.848	5523538.110	630035.165	5523547.637	630091.801
C102	1+137.848	1+152.461	5523547.637	630091.801	5523547.950	630106.359
L101	1+152.461	1+228.856	5523547.950	630106.359	5523560.713	630181.680
C103	1+228.856	1+248.658	5523560.713	630181.680	5523567.744	630200.054
C104	1+248.658	1+337.403	5523567.744	630200.054	5523583.041	630285.250
C105	1+337.403	1+364.428	5523583.041	630285.250	5523587.174	630311.354
C106	1+364.428	1+425.995	5523587.174	630311.354	5523600.068	630370.565
C107	1+425.995	1+467.660	5523600.068	630370.565	5523601.955	630412.053
L102	1+467.660	1+550.993	5523601.955	630412.053	5523617.229	630493.975
C108	1+550.993	1+566.528	5523617.229	630493.975	5523620.982	630509.041
L103	1+566.528	1+595.661	5523620.982	630509.041	5523629.698	630536.839
C109	1+595.661	1+624.521	5523629.698	630536.839	5523642.161	630562.758
C110	1+624.521	1+666.087	5523642.161	630562.758	5523653.169	630602.109
C111	1+666.087	1+695.918	5523653.169	630602.109	5523656.972	630631.542
L104	1+695.918	1+727.494	5523656.972	630631.542	5523666.423	630661.671
C112	1+727.494	1+753.252	5523666.423	630661.671	5523679.988	630683.233
C113	1+753.252	1+787.975	5523679.988	630683.233	5523687.802	630715.105
C114	1+787.975	1+802.203	5523687.802	630715.105	5523687.049	630729.122
L105	1+802.203	1+846.944	5523687.049	630729.122	5523697.286	630772.677
L106	1+846.944	1+878.034	5523697.286	630772.677	5523706.600	630802.338
L107	1+878.034	1+903.683	5523706.600	630802.338	5523712.070	630827.397
C115	1+903.683	1+943.581	5523712.070	630827.397	5523715.325	630867.045
C116	1+943.581	1+968.353	5523715.325	630867.045	5523725.544	630888.507
L108	1+968.353	1+980.212	5523725.544	630888.507	5523735.119	630895.503
C117	1+980.212	1+993.027	5523735.119	630895.503	5523746.915	630900.142
L109	1+993.027	2+024.065	5523746.915	630900.142	5523777.736	630903.809

CURVE DATA						
#	R.	Δc	Tc	L.	L.C.	
C100	100.000	16°39'04"	14.634	29.062	28.959	
C101	100.000	33°22'34"	29.979	58.252	57.432	
C102	50.000	16°44'44"	7.359	14.613	14.561	
C103	50.000	22°41'31"	10.033	19.802	19.673	
C104	115.000	44°12'52"	46.714	88.744	86.559	
C105	37.000	41°51'00"	14.147	27.025	26.429	
C106	100.000	35°16'31"	31.794	61.567	60.599	
C107	149.998	15°54'54"	20.967	41.665	41.531	
C108	130.000	6°50'49"	7.777	15.535	15.526	
C109	100.000	16°32'09"	14.531	28.860	28.760	
C110	65.000	36°38'22"	21.521	41.566	40.861	
C111	85.000	20°06'28"	15.070	29.830	29.678	
C112	50.000	29°30'59"	13.172	25.758	25.474	
C113	30.000	66°18'55"	19.600	34.723	32.817	
C114	25.000	32°36'34"	7.313	14.229	14.037	
C115	150.000	15°14'24"	20.068	39.899	39.781	
C116	25.000	56°46'18"	13.509	24.771	23.770	
C117	25.000	29°22'12"	6.552	12.815	12.675	

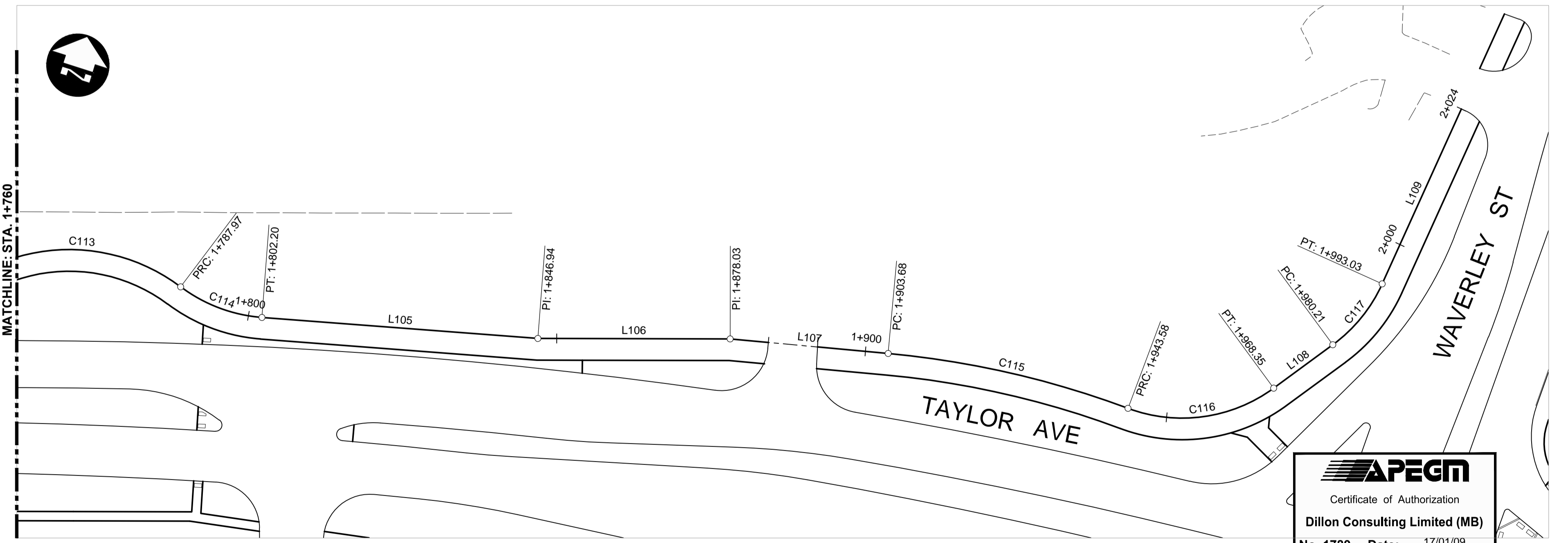

**APEGM**  
 Certificate of Authorization  
 Dillon Consulting Limited (MB)  
 No. 1789 Date: 17/01/09

UNDERGROUND STRUCTURES  SUPV. U/G STRUCTURES DATE	B.M. ELEV. SEE SHEET C2-CT-007 FOR CONTROL POINT INFORMATION		ENGINEER'S SEAL 	<b>THE CITY OF WINNIPEG</b> PUBLIC WORKS DEPARTMENT	
				WAVERLEY STREET UNDERPASS AT CN MILE 3.89 RIVERS SUB CONTRACT 2: UNDERPASS STRUCTURES, RAILWORKS, ROADWORKS, LAND DRAINAGE SEWER, PUMPING STATION AND LANDSCAPING WORKS	
LOCATION OF UNDERGROUND STRUCTURES AS SHOWN ARE BASED ON THE BEST INFORMATION AVAILABLE BUT NO GUARANTEE IS GIVEN THAT ALL EXISTING UTILITIES ARE SHOWN OR THAT THE GIVEN LOCATIONS ARE EXACT. CONFIRMATION OF EXISTENCE AND EXACT LOCATION OF ALL SERVICES MUST BE OBTAINED FROM THE INDIVIDUAL UTILITIES BEFORE PROCEEDING WITH CONSTRUCTION.	0 ISSUED FOR TENDER 17/01/09 DBW	DESIGNED BY RTP CHECKED BY DBW DRAWN BY TJH APPROVED BY DBW HOR. SCALE 1:500 RELEASED FOR CONSTRUCTION VERTICAL DATE	CONSULTANT PROJECT NUMBER 16-3353	CITY DRAWING NUMBER U-239-2016-C2-CT-016	
				CONTROL LINE GEOMETRY TAYLOR MULTI-USE PATH	
			SHEET 016 OF 081 CONSULTANT DRAWING NUMBER C2-CT-016		

G:\CAD\163353\Technical\Workspaces\Drawings and Figures\Roadworks\Contract\163353-C2-CON-CT-CONTROL-LINE-GEOMETRY-M.U.P.dwg