

NOTE:
SEE DRAWING "C2-CR-502" FOR FINAL
MAINTRACK TRACK CONSTRUCTION.

NOTE:
RAILWAY EQUIPMENT AND FACILITIES TO BE
PROTECTED DURING CONSTRUCTION.

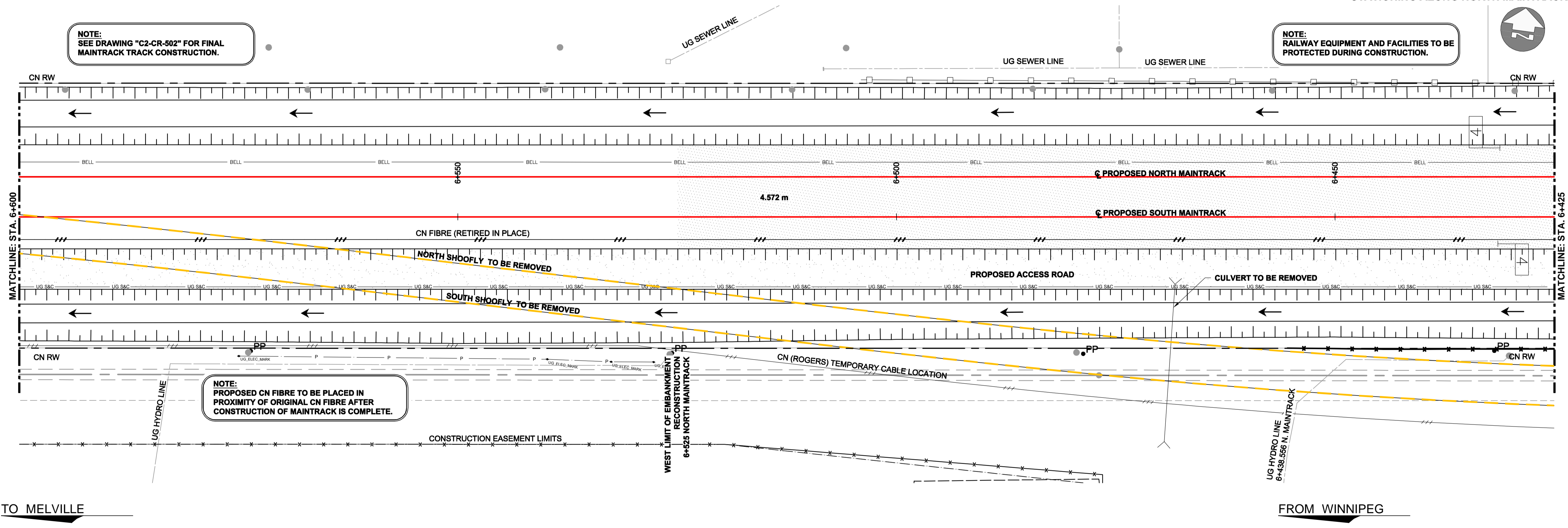

TO MELVILLE

FROM WINNIPEG

P:\60321148\900-Work\910-CAD\20-SHEETS\A-CR\Detailed Design\Final Top of Rail\163353-C2-CR-110.dwg

UNDERGROUND STRUCTURES		B.M. ELEV.
SUPV. U/G STRUCTURES	DATE	
<small>LOCATION OF UNDERGROUND STRUCTURES AS SHOWN ARE BASED ON THE BEST INFORMATION AVAILABLE BUT NO GUARANTEE IS GIVEN THAT ALL EXISTING UTILITIES ARE SHOWN OR THAT THE GIVEN LOCATIONS ARE EXACT. CONFIRMATION OF EXISTENCE AND EXACT LOCATION OF ALL SERVICES MUST BE OBTAINED FROM THE INDIVIDUAL UTILITIES BEFORE PROCEEDING WITH CONSTRUCTION.</small>		
0	ISSUED FOR TENDER	17/01/09 DBW
NO.	REVISIONS	DATE BY

AECOM	
DESIGNED BY	CHECKED BY
DRAWN BY	APPROVED BY
HOR. SCALE 1:250	RELEASED FOR CONSTRUCTION
VERTICAL 1:10	DATE

ENGINEER'S SEAL
CONSULTANT PROJECT NUMBER
16-3353

THE CITY OF WINNIPEG
PUBLIC WORKS DEPARTMENT

CITY DRAWING NUMBER
U-239-2016-C2-CR-014

SHEET 14 OF 55

CONSULTANT DRAWING NUMBER
C2-CR-110

WAVERLEY STREET UNDERPASS AT CN MILE 3.89 RIVERS SUB
CONTRACT 2: UNDERPASS STRUCTURE, RAILWORKS,
ROADWORKS, LAND DRAINAGE SEWER, PUMPING STATION
AND LANDSCAPING WORKS

MAIN TRACK GRADING
STA. 6+425.000 TO STA. 6+600.000