

**A**  
HOR. SCALE 1:500  
VER. SCALE 1:100

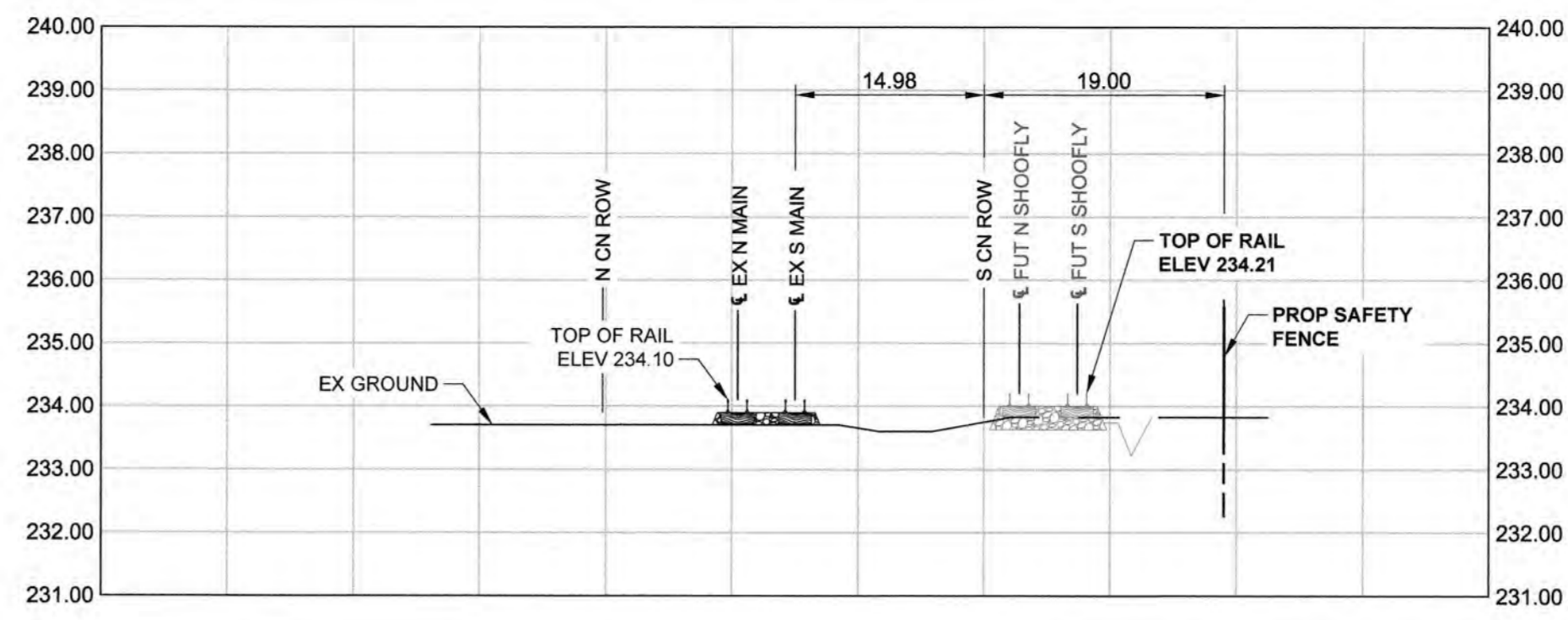

**D**  
HOR. SCALE 1:500  
VER. SCALE 1:100

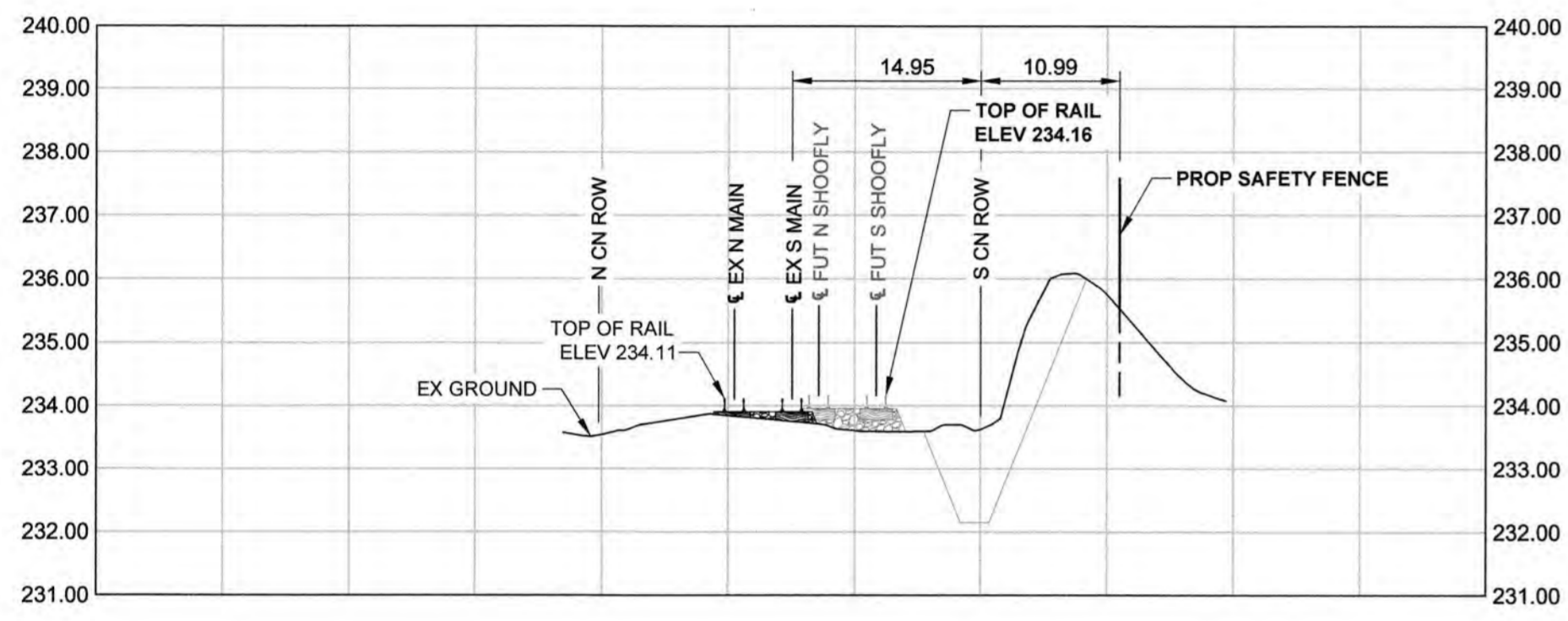

**B**  
HOR. SCALE 1:500  
VER. SCALE 1:100

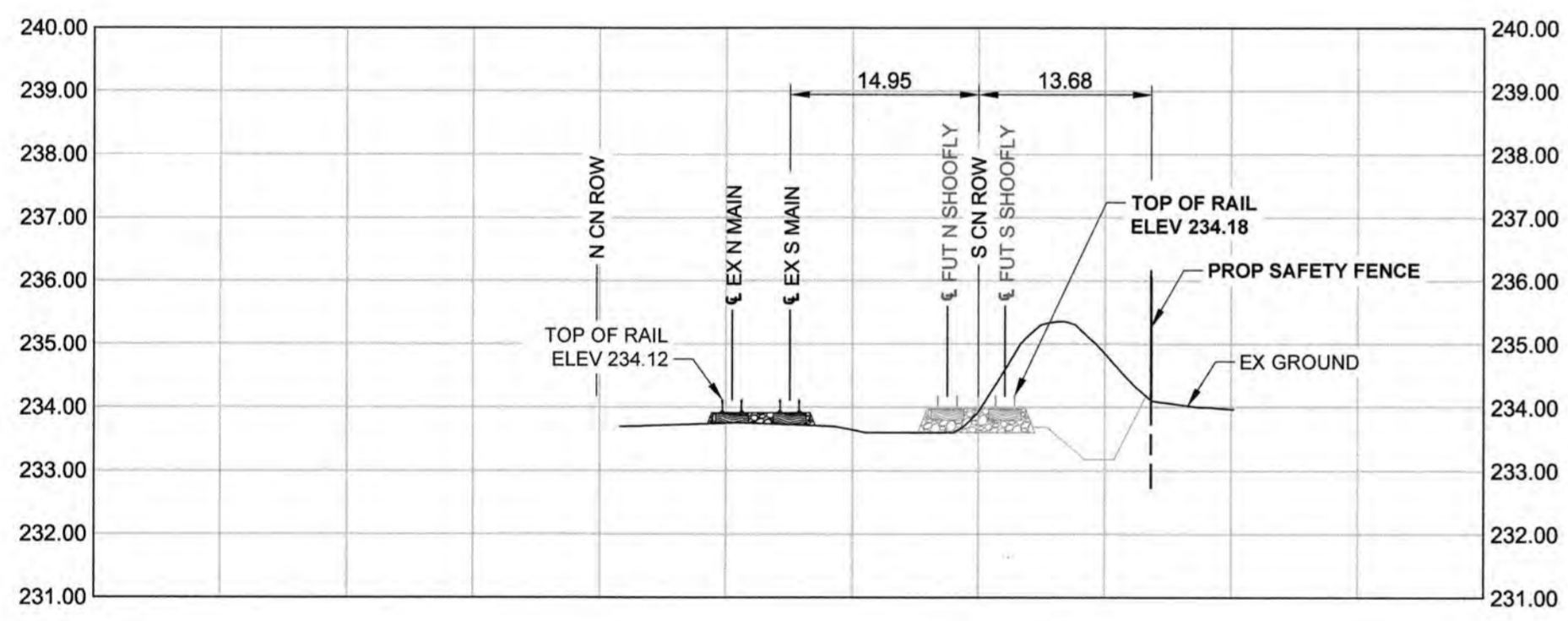

**C**  
HOR. SCALE 1:500  
VER. SCALE 1:100

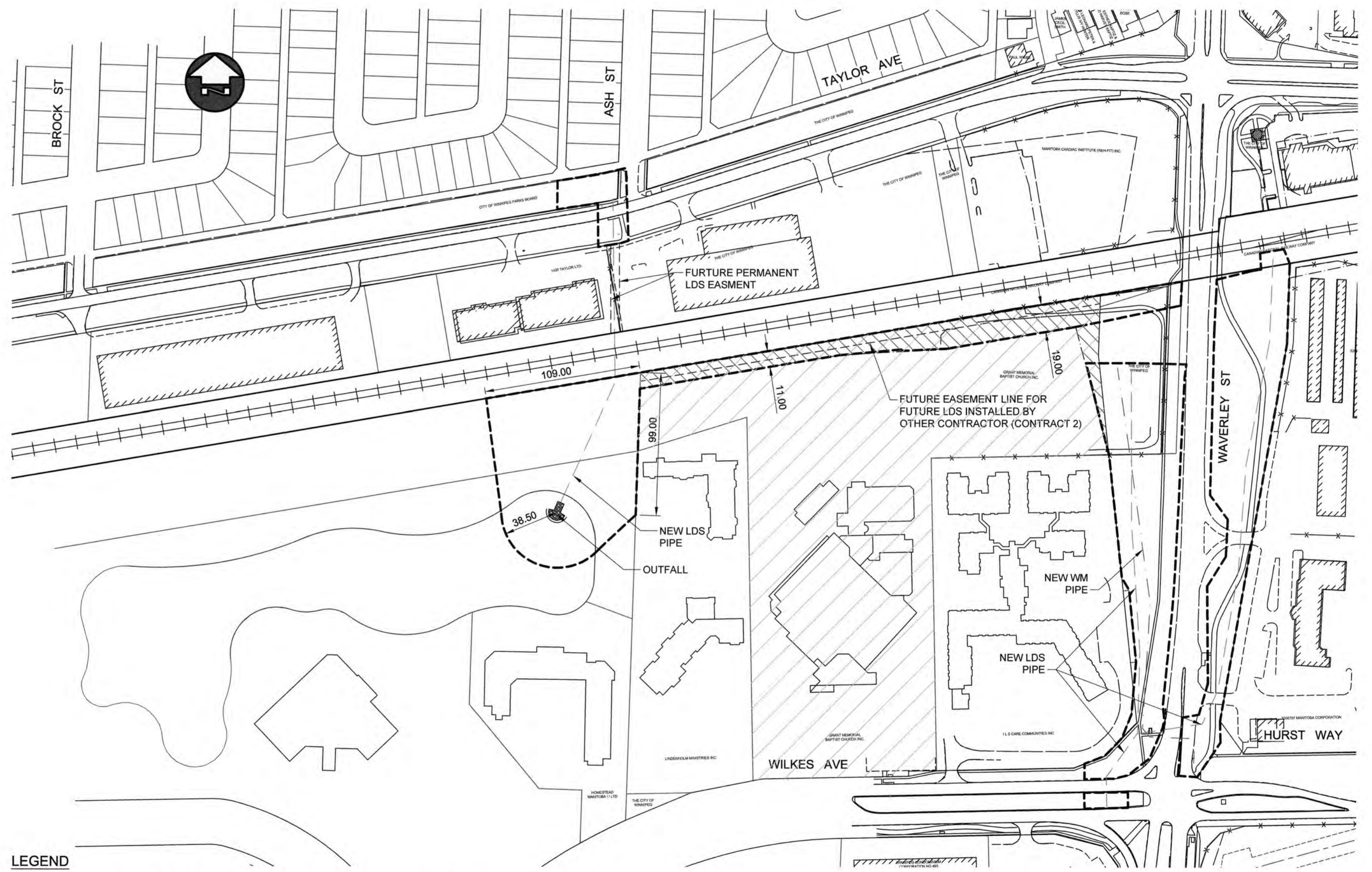

**LEGEND**

- TEMPORARY CONSTRUCTION EASEMENT
- LINDEN
- SITE

**SITE DELINEATION**  
Scale 1:2000

**AECOM**  
Certificate of Authorization  
AECOM Canada Ltd.  
No. 4671 Date: Oct 14, 2016

**METRIC**  
WHOLE NUMBERS INDICATE MILLIMETRES  
DECIMALIZED NUMBERS INDICATE METRES

**WARNING**

- IF POWER EQUIPMENT OR EXPLOSIVES ARE TO BE USED FOR EXCAVATION ON THIS PROJECT THE CONTRACTOR MUST:
1. NOTIFY THE GAS COMPANY OF THE PROPOSED LOCATION OF EXCAVATION.
  2. TAKE PRECAUTION TO AVOID DAMAGE TO GAS COMPANY INSTALLATIONS SEE PROVINCIAL REGULATION 210/72 FOR DETAILS.
  3. OBTAIN EXCAVATION PERMITS PRIOR TO CONSTRUCTION.

150 WM	WATER MAIN	150 WM	PIPE ABANDONMENTS	150 WM	WATER MAIN	150 WM	WATER MAIN
⊕	HYDRANT	⊕	SURVEY BAR	+	HYDRANT	+	HYDRANT
⊙	VALVE	⊙	CURB STOP	X	VALVE	X	VALVE
300 LDS	LAND DRAINAGE SEWER	300 LDS	REDUCER	300 LDS	LAND DRAINAGE SEWER	300 LDS	LAND DRAINAGE SEWER
250 WWS	WASTE WATER SEWER	250 WWS	COUPLING	250 WWS	WASTE WATER SEWER	250 WWS	WASTE WATER SEWER
---	SEWER SERVICE PIPE	---	ANODE	---	PAVEMENT CROWN	---	PAVEMENT CROWN
---	DRAINAGE CONNECTION PIPE	---	HYDRO	---	N/W PROPERTY LINE	---	N/W PROPERTY LINE
○	MANHOLE	○	MTS	○	S/E PROPERTY LINE	○	S/E PROPERTY LINE
□	CATCH BASIN	□	GAS	□	N/W GUTTER	□	N/W GUTTER
△	CURB INLET	△	TESTHOLE	△	S/E GUTTER	△	S/E GUTTER
---	CULVERT	---	LAMP STANDARD	---		---	
---	EXISTING	---	LEGEND - PLAN	---	LEGEND - PROFILE	---	LEGEND - PROFILE

**UNDERGROUND STRUCTURES**

SUPV: U/G STRUCTURES DATE

LOCATION OF UNDERGROUND STRUCTURES AS SHOWN ARE BASED ON THE BEST INFORMATION AVAILABLE. BUT NO GUARANTEE IS GIVEN THAT ALL EXISTING UTILITIES ARE SHOWN OR THAT THE GIVEN LOCATIONS ARE EXACT. CONFIRMATION OF EXISTENCE AND EXACT LOCATION OF ALL SERVICES MUST BE OBTAINED FROM THE INDIVIDUAL UTILITIES BEFORE PROCEEDING WITH CONSTRUCTION.

0	ISSUED FOR TENDER	18/10/17	KLC
NO.	REVISIONS	DATE	BY

**AECOM**

DESIGNED BY: MRP  
CHECKED BY: [Signature]  
DRAWN BY: KLC  
APPROVED BY: [Signature]

HOR. SCALE: AS SHOWN  
VERTICAL: AS SHOWN

RELEASED FOR CONSTRUCTION

**PROVINCE OF MANITOBA**  
REGISTERED PROFESSIONAL ENGINEER  
M.P.A. GAUDREAU  
Member 32167  
2016

CONSULTANT PROJECT NUMBER: 60321148

**THE CITY OF WINNIPEG**  
PUBLIC WORKS DEPARTMENT

Waverley Street Underpass at CN Mile 3.89 Rivers Sub  
Contract 1: Preliminary Underground Works and Security Fencing

CITY DRAWING NUMBER: U239-2016-C1-CU-003  
SHEET 5 OF 9  
CONSULTANT DRAWING NUMBER: C1-CU-003

P:\60321148\900-Work\9100-DD-CAU\200-SHEETS\Municipal\63353-C1--CON--CU--Construction-Access.dwg