

PEMBINA HIGHWAY SOUTHBOUND PROFILE

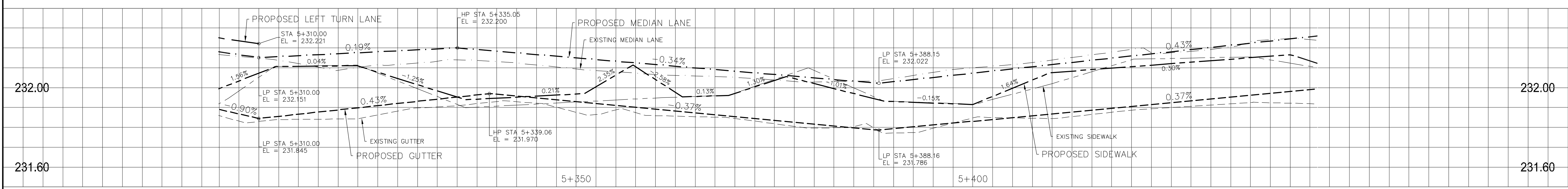

PEMBINA HIGHWAY NORTHBOUND PROFILE

Curve Table		Curve Table	
Curve #	Length	Curve #	Length
C19	Δ R T L C19 6°22'00" 30.000 1.67 3.33	C23	Δ R T L C23 7°38'01" 162.650 10.85 21.67
	BC 5525441.673 633178.344		BC 5525546.158 633202.573
	EC 5525438.410 633177.670		EC 5525525.001 633197.958
C20	Δ R T L C20 24°02'59" 25.000 5.33 10.49	C21	Δ R T L C21 11°17'58" 262.650 2.98 5.96
	BC 5525460.676 633186.165		BC 5525522.583 633177.515
	EC 5525470.433 633189.815		EC 5525516.701 633176.569
C22	Δ R T L C22 7°24'34" 250.000 16.19 32.33	C24	Δ R T L C24 15°10'41" 17.000 2.26 4.50
	BC 5525546.411 633195.906		BC 5525547.135 633196.937
	EC 5525514.833 633189.090		EC 5525547.416 633201.419

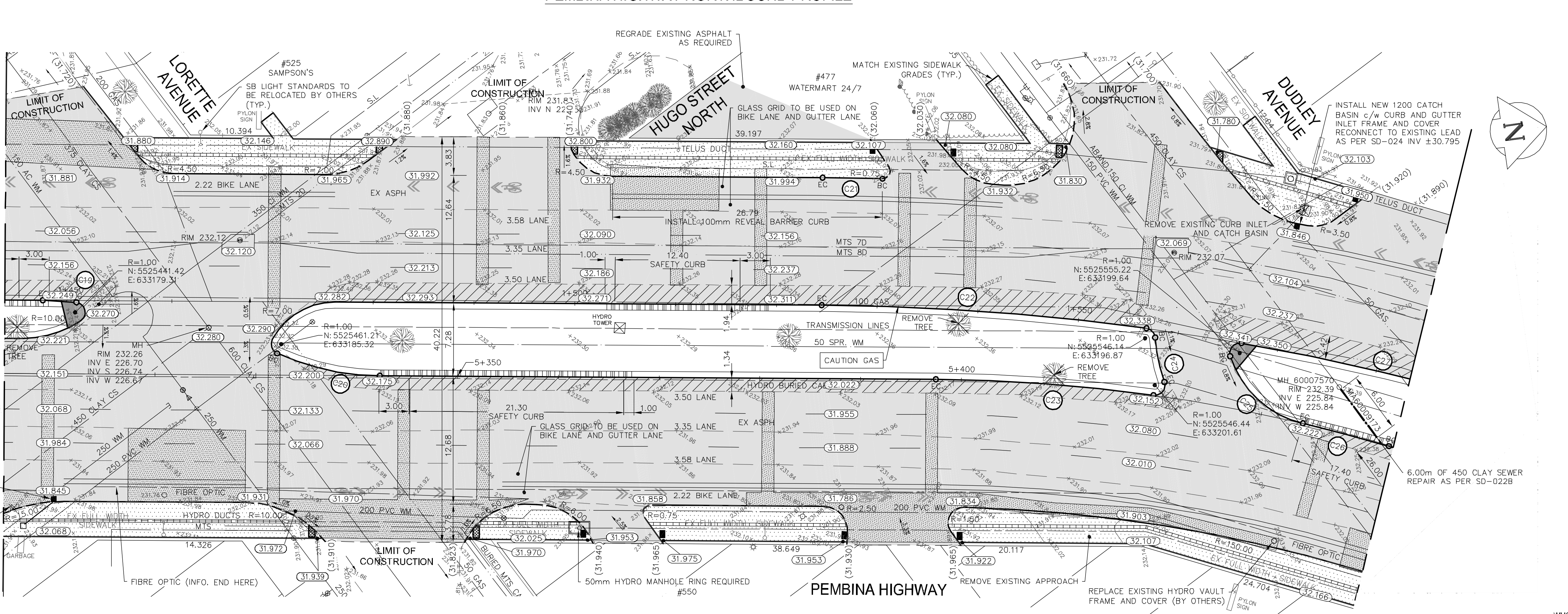

Curve Table	
Curve #	Length
C24	Δ R T L C24 15°10'41" 17.000 2.26 4.50
	BC 5525547.135 633196.937
	EC 5525547.416 633201.419
C25	Δ R T L C25 58°49'00" 10.000 5.64 10.27
	BC 5525554.238 633199.814
	EC 5525560.439 633207.429
C26	Δ R T L C26 3°06'40" 250.000 4.42 8.83
	BC 5525568.567 633210.878
	EC 5525560.439 633207.429
C27	Δ R T L C27 6°26'49" 250.000 14.08 28.13
	BC 5525581.727 633208.912
	EC 5525555.534 633198.694

EXISTING	LEGEND-PLAN	PROPOSED	EXISTING	LEGEND-PLAN	PROPOSED	EXISTING	LEGEND-PROFILE	PROPOSED
---	WATER MAIN	---	#111	CIVIC ADDRESS	---	---	LEFT TURN LANE	---
---	LAND DRAINAGE SEWER	---	○	HYDRO POLE & LIGHT STANDARD	---	---	WEST MEDIAN GUTTER	---
---	WASTE WATER SEWER	---	○	LIGHT STANDARD	---	---	EAST MEDIAN GUTTER	---
---	HYDRO	---	HP	HYDRO POLE	---	---	SIDEWALK	---
---	M.T.S.	---	□	CURB RAMP	---	---	WEST SIDEWALK	---
---	GAS	---	■	DETECTABLE WARNING SURFACE TILE c/w RAMP	---	---	EAST SIDEWALK	---
---	SIGNALS	---	---	EDGE OF SIDEWALK	---	---	ROADWAY CENTRE LINE	---
○	MANHOLE	●	---	PROPERTY LINE	---	---	WEST GUTTER	---
□	CATCH BASIN	■	---	EDGE OF ASPHALT	---	---	EAST GUTTER	---
△	CURB INLET	▽	---	MODIFIED BARRIER CURB	---	---	---	---
△	UTILITIES ADJUSTED	△	---	BARRIER CURB	---	---	---	---
J	PLUG	J	---	BARRIER CURB WITH SPLASH STRIP	---	---	---	---
⊕	HYDRANT	⊕	---	TRAFFIC SIGNAL	---	---	---	---
⊕	VALVE	⊕	---	SIDEWALK	---	---	---	---
⊕	CURB STOP	⊕	---	CONCRETE SLAB REPAIR	---	---	---	---
---	GROUND GRADE	---	---	ASPHALT	---	---	---	---
---	PAVEMENT GRADE	(31.000)	---	CONCRETE	---	---	---	---
---	LOT GRADE	(31.000)	---	INTERLOCKING PAVING STONES	---	---	---	---
---	ANCHOR	---	---	BULLNOSE	---	---	---	---

FOR SECTIONS AND DETAILS REFER TO C-20

FOR TENDER PURPOSES ONLY

NOTES: These design documents are prepared solely for the use by the party with whom the design professional has entered into a contract and there are no representations of any kind made by the design professional to any party with whom the design professional has not entered into a contract.

LOCATIONS APPROVED UNDERGROUND STRUCTURES

SIGNED BY: _____ DATE: _____

LOCATION OF UNDERGROUND STRUCTURES AS SHOWN ARE BASED ON THE BEST INFORMATION AVAILABLE BUT NO GUARANTEE IS GIVEN THAT ALL EXISTING UTILITIES ARE SHOWN OR THAT THE GIVEN LOCATIONS ARE EXACT CONFIRMATION OF EXISTENCE AND EXACT LOCATION OF ALL SERVICES MUST BE OBTAINED FROM THE INDIVIDUAL UTILITIES BEFORE PROCEEDING

MMM GROUP

DESIGNED BY: SQ/JP
CHECKED BY: VM/TP
DRAWN BY: HK/LT
APPROVED BY: VM

ISSUED FOR TENDER: 16.MAY.16 VM
ISSUED TO UNDERGROUND STRUCTURES: 16.MAY.16 VM
ISSUED FOR CLIENT REVIEW: 28.APR.16 VM

NO. REVISIONS DATE BY

HOR SCALE: 1:250
VERTICAL: 1:10

DATE: MARCH 2016

THE CITY OF WINNIPEG
PUBLIC WORKS DEPARTMENT
ENGINEERING DIVISION

PEMBINA HIGHWAY
FROM CARTER AVENUE TO OSBORNE STREET

PAVEMENT REHABILITATION
SOUTHBOUND STA. 1+443 - STA. 1+583

BID NO. 386-2016

PROVINCE OF MANITOBA
REGISTERED PROFESSIONAL ENGINEER
V.M. MAROTI
Member 30809

CONSULTANT CAD DRAW NO. 5516006-C-05

CITY DRAWING NUMBER SHEET 05 OF 27

May 16, 2016 - 11:57am
P:\5516001-5516006- Pembina Hwy Pavement Rehab. & Bike Lane\MMW Drawings\Construction Drawings\5516006 C01-C02 Rehabilitation issued for Tender 20160516.dwg - tab: STA. 1+480.00 - STA. 1+610.00