

COLVIN AVENUE

ROCH ST

1.0m OF 300mm PVC SEWER REPAIRS (SD-022A) INCLUDING 1 SERVICE CONNECTION

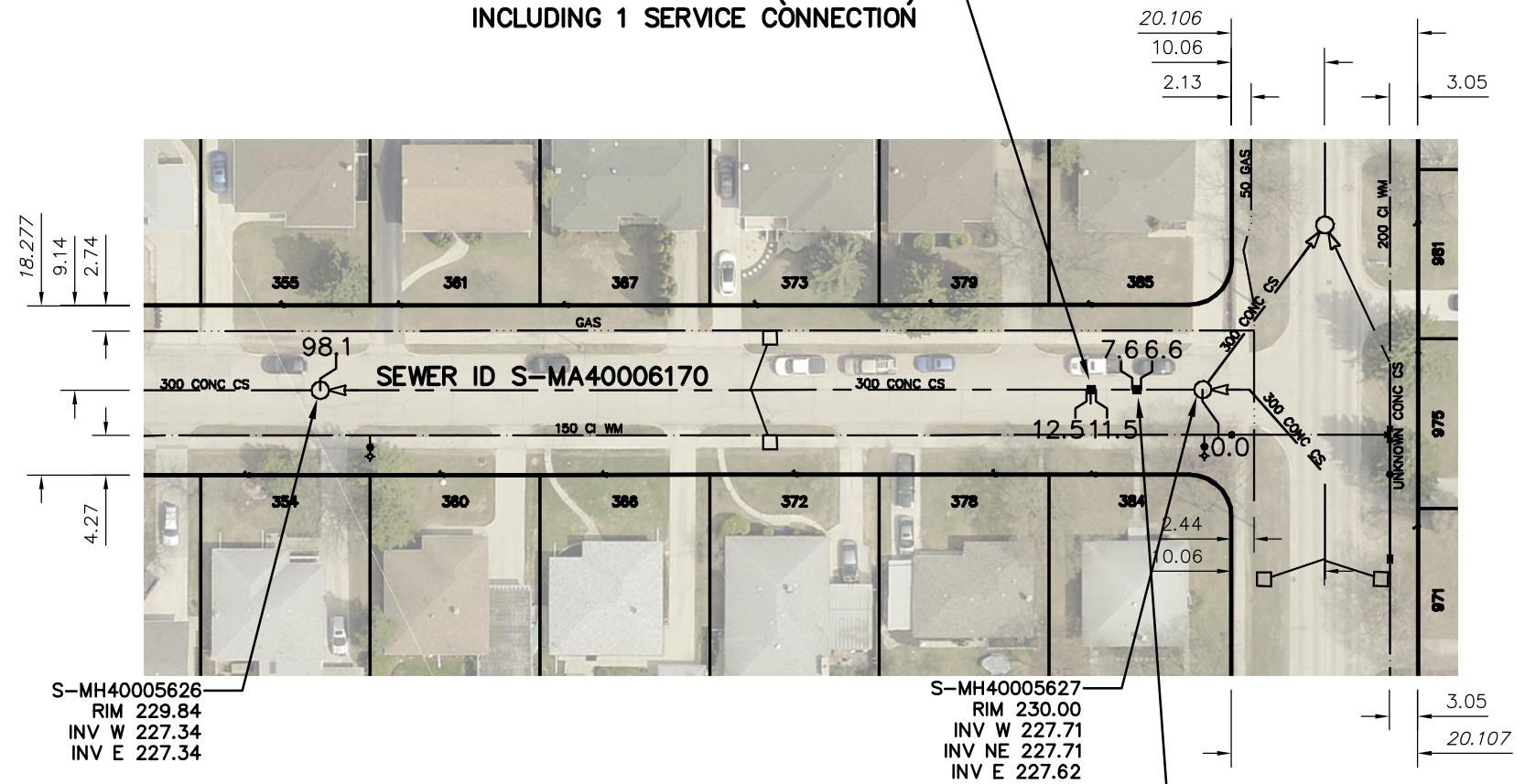

SEWER JUNCTION INFORMATION FROM SEWER VIDEO INSPECTION		
SEWER ID S-MA40006170		
DISTANCE FROM MH ID S-MH40005627		
DISTANCE	DIAMETER	CLOCK
1.4	150	10
5.4	150	10
12.1	150	10
16.4	150	2
17.1	150	10
23.4	150	10
35.1	150	2
44.6	150	10
48.0	150	2
48.5	150	10
53.0	150	2
65.6	150	10
70.9	150	2
71.8	150	2
84.0	150	10
89.5	150	2
91.1	150	2
91.5	150	10

WARNING

IF POWER EQUIPMENT OR EXPLOSIVES ARE TO BE USED FOR EXCAVATION ON THIS PROJECT THE CONTRACTOR MUST:

- 1) NOTIFY THE GAS COMPANY OF THE PROPOSED LOCATION OF EXCAVATION.
- 2) TAKE PRECAUTION TO AVOID DAMAGE TO GAS COMPANY INSTALLATIONS.

SEE PROVINCIAL REGULATION 210/72 FOR DETAILS

METRIC

WHOLE NUMBERS INDICATE MILLIMETRES
DECIMALIZED NUMBERS INDICATE METRES



LOCATION APPROVED UNDERGROUND STRUCTURES

SUPV. U/G STRUCTURES COMMITTEE	DATE

NOTE:
LOCATION OF UNDERGROUND STRUCTURES AS SHOWN ARE BASED ON THE BEST INFORMATION AVAILABLE BUT NO GUARANTEE IS GIVEN THAT ALL EXISTING UTILITIES ARE SHOWN OR THAT THE GIVEN LOCATIONS ARE EXACT. CONFIRMATION OF EXISTENCE AND EXACT LOCATION OF ALL SERVICES MUST BE OBTAINED FROM THE INDIVIDUAL UTILITIES BEFORE PROCEEDING WITH CONSTRUCTION.

B.M. ELEV.			

DESIGNED BY	NC	CHECKED BY	SC
DRAWN BY	RJ	APPROVED BY	KZ
SCALE:	1: 750	RELEASED FOR CONSTRUCTION	KAZ ZUREK
HORIZONTAL		DATE	
VERTICAL	DATE	2016 05 04	
PLOT DATE: 2016 04 26			

ENGINEER'S SEAL

ORIGINAL SIGNED BY
S.R.J.
COURNOYER
16-04-22

CONSULTANT DRAWING NUMBER

THE CITY OF WINNIPEG
WATER AND WASTE DEPARTMENT
ENGINEERING DIVISION

2015 SUPPLEMENTAL SEWER REPAIRS
BY EXTERNAL POINT REPAIR
COLVIN AVENUE
MH AT ROCH STREET W $\overline{\text{R}}$ TO
1ST MH W OF ROCH STREET

SHEET **3** OF **21**
CITY DRAWING NUMBER
11263