

MATCHLINE 0+210

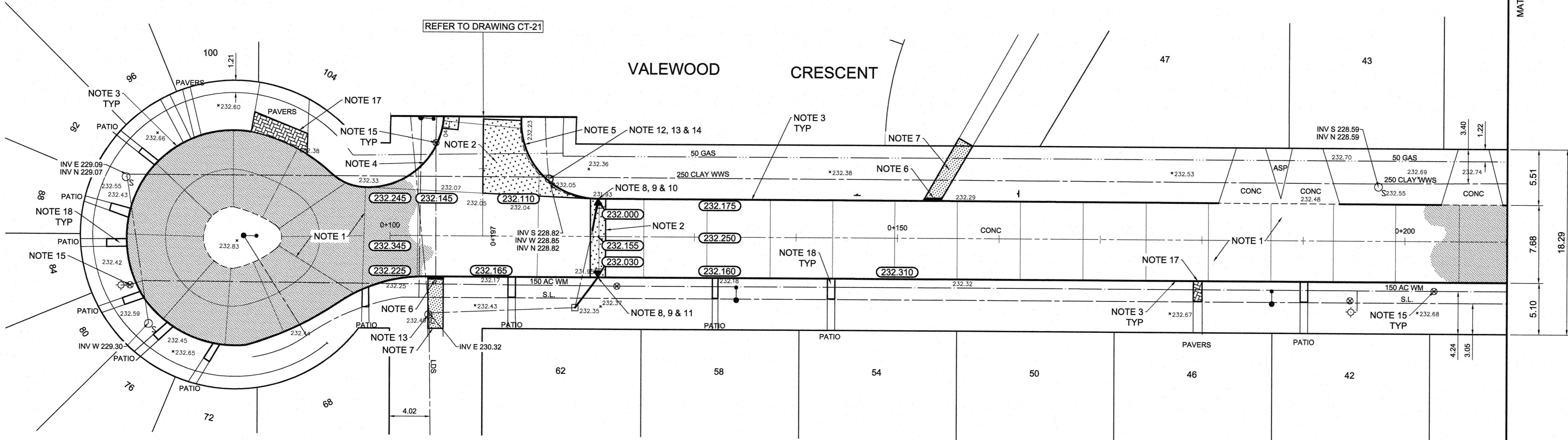

- REFERENCE NOTES**
- PAVEMENT DIMENSIONS ARE TO BACK OF CURB
 - BASELINE IS CENTRE LINE RIGHT-OF-WAY
 - PROPERTY LINES OBTAINED FROM CITY OF WINNIPEG L.B.I.S., AND NO SCALE FACTOR WAS APPLIED
 - REFER TO AECOM FIELD BOOK NO. 4914

- CONSTRUCTION NOTES**
- PLACE NEW ASPHALTIC PAVEMENT TYPE 1A (AVG. THICKNESS 85mm)
 - REMOVE EXISTING CONCRETE PAVEMENT AND CONSTRUCT NEW 150mm REINFORCED CONCRETE PAVEMENT c/w 85mm ASPHALT OVERLAY
 - REMOVE EXISTING LIP CURB AND CONSTRUCT NEW CONCRETE BARRIER CURB (100mm REVEAL HT. DOWELLED)
 - REMOVE EXISTING BARRIER CURB AND CONSTRUCT NEW CONCRETE MODIFIED BARRIER CURB (100mm REVEAL HT. DOWELLED)
 - REMOVE EXISTING BARRIER CURB AND CONSTRUCT NEW CONCRETE MODIFIED BARRIER CURB (100mm REVEAL HT. SEPARATE)
 - CONSTRUCT CURB RAMP (10mm HT. INTEGRAL)
 - RENEW EXISTING 100mm CONCRETE SIDEWALK
 - REMOVE EXISTING CATCHPIT
 - INSTALL NEW CURB AND GUTTER INLET c/w CATCHPIT (SD-023)
 - CONNECT NEW LEAD TO EXISTING LEAD
 - CONNECT NEW LEAD TO EXISTING CATCHBASIN
 - REMOVE EXISTING FRAME AND COVER AND PLACE NEW FRAME AND SOLID COVER (AP-004/AP-005)
 - ADJUST EXISTING MANHOLE/CATCHBASIN TO GRADE
 - INSTALL CAST IRON RISER RING
 - ADJUST EXISTING WATER VALVE TO GRADE
 - ADJUST CURB STOP
 - ADJUST EXISTING PAVING STONES
 - ADJUST EXISTING PATIO BLOCKS



METRIC
WHOLE NUMBERS INDICATE MILLIMETRES
DECIMALIZED NUMBERS INDICATE METRES

| 150 mm W.M. | | 300 mm L.D.S. | | 250 mm W.W.S. | | 235.750 | | 3000 | |
|-------------|------------------------|---------------|------------------------|---------------|---------------------------|---------|---------------------------|------|---------|
| | WATERMAIN HYDRANT | | VALVE | | LAND DRAINAGE SEWER | | WASTEWATER SEWER | | MANHOLE |
| | CATCH BASIN | | CATCH PIT | | JUNCTIONS | | CULVERT | | GAS |
| | EXISTING LEGEND - PLAN | | PROPOSED LEGEND - PLAN | | EXISTING LEGEND - PROFILE | | PROPOSED LEGEND - PROFILE | | |

LOCATION APPROVED UNDERGROUND STRUCTURES

| SUPV. U/G STRUCTURES COMMITTEE | DATE |
|--------------------------------|------|
| | |

NOTE:
LOCATION OF UNDERGROUND STRUCTURES AS SHOWN ARE BASED ON THE BEST INFORMATION AVAILABLE. BUT NO GUARANTEE IS GIVEN THAT ALL EXISTING UTILITIES ARE SHOWN OR THAT THE GIVEN LOCATIONS ARE EXACT. CONFIRMATION OF EXISTENCE AND EXACT LOCATION OF ALL SERVICES MUST BE OBTAINED FROM THE INDIVIDUAL UTILITIES BEFORE PROCEEDING WITH CONSTRUCTION.

B.M. 15 - 036 32R528 N.E. Cor. Inkster Garden Dr. & Marianne Rd., 1.8m on top of 0.65m dia. x 2.4m iron pipe, 2.6m ELEV. 232.566 S. of N.L. Inkster Garden Dr.

| NO. | REVISIONS | DATE | BY |
|-----|-------------------|------------|----|
| 0 | ISSUED FOR TENDER | 03/22/2016 | BC |
| A | ISSUED FOR REVIEW | 03/16/2016 | BC |

AECOM

| | |
|-------------------|-------------------------------|
| DESIGNED BY: SS | CHECKED BY: BC/KWR |
| DRAWN BY: JC/SS | APPROVED BY: |
| HOR. SCALE: 1:250 | RELEASED FOR CONSTRUCTION BY: |
| VERTICAL: 1:10 | DATE: MAR 22/16 |



THE CITY OF WINNIPEG
PUBLIC WORKS DEPARTMENT
ENGINEERING DIVISION

2016 LOCAL STREET RENEWAL PROGRAM

VALEWOOD CR. - INKSTER GARDEN DR. TO MARIANNE ROAD
REHABILITATION
STATION 0+100 TO STATION 0+210

CITY DRAWING NUMBER: SHEET 22 OF 24