

ANSI B SIZE 11" x 17" (279mm x 432mm)

PLOT: 2016-04-25 11:31:30 AM

FILE NAME: W160015-EPR Lorette-02.dwg Saved By: dlane

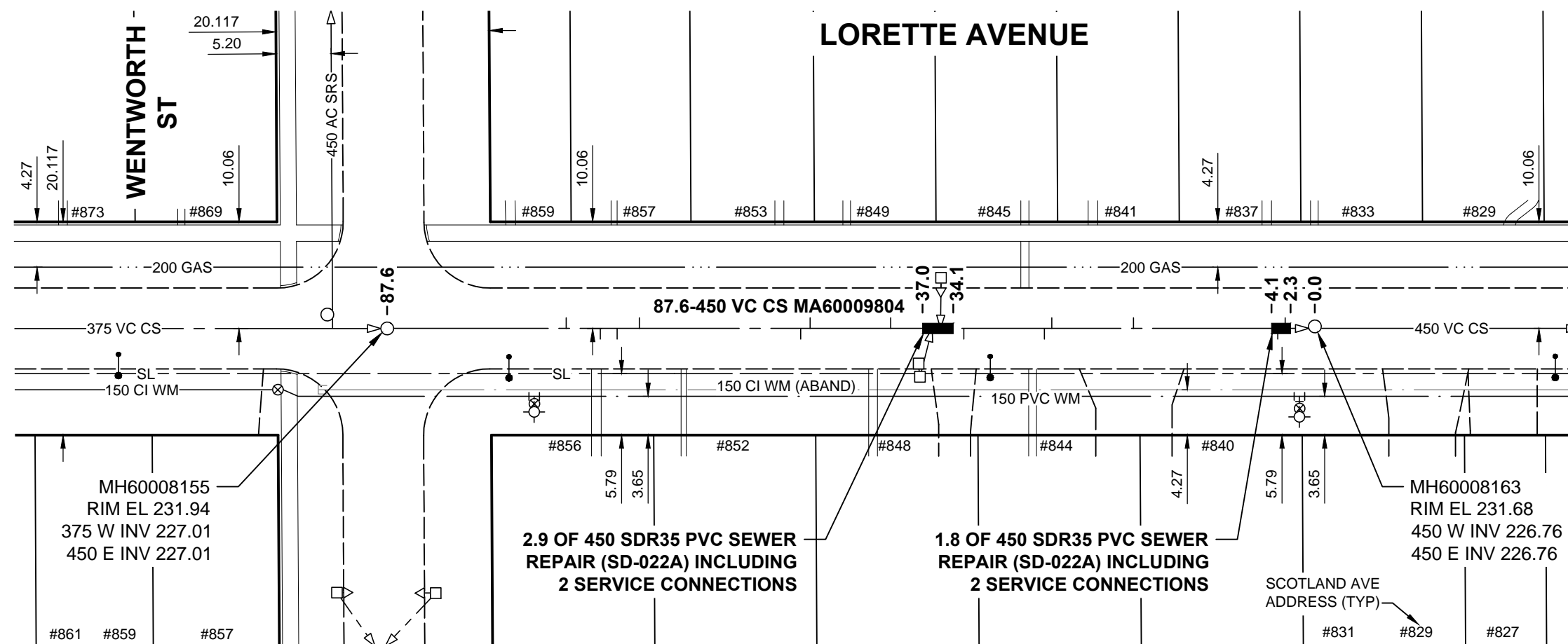

SEWER JUNCTION INFORMATION FROM SEWER VIDEO INSPECTION
SEWER ID MA60009804

DISTANCE FROM MH ID MH60008163		
DISTANCE	DIAMETER	CLOCK
2.8	100	2
3.5	100	10
17.1	100	2
24.8	100	2
25.5	100	10
33.1	100	10
35.3	150	2
36.1	150	10
40.0	100	2
47.6	100	1
48.5	100	10
63.7	100	2
65.8	100	10
67.4	100	10
70.6	100	2

TELEVISED IN UPSTREAM DIRECTION

PLAN

SCALE: 1:500

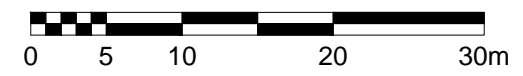

APEGM
Certificate of Authorization
MORRISON HERSHFIELD
No. 1736

METRIC
WHOLE NUMBERS INDICATE MILLIMETRES
DECIMALIZED NUMBERS INDICATE METRES

BID OPPORTUNITY No. 180-2016

LOCATION APPROVED UNDERGROUND STRUCTURES

SUPR. U/G STRUCTURES	DATE

NOTE:
LOCATION OF UNDERGROUND STRUCTURES AS SHOWN ARE BASED ON THE BEST INFORMATION AVAILABLE BUT NO GUARANTEE IS GIVEN THAT ALL EXISTING UTILITIES ARE SHOWN OR THAT THE GIVEN LOCATIONS ARE EXACT. CONFIRMATION OF EXISTENCE AND EXACT LOCATION OF ALL SERVICES MUST BE OBTAINED FROM THE INDIVIDUAL UTILITIES BEFORE PROCEEDING WITH CONSTRUCTION.

BM ELEV	52-023 231.873 m	SW Cor. Wentworth St. & Weatherdon Ave., Brass plug in 4.6 m Conc. pile, 2.6 m E. of W.L. Wentworth St. & 0.6 m S. of S.L. Weatherdon Ave.
A	ISSUED FOR TENDER	16/04/25 HAK
No.	REVISIONS	YY/MM/DD BY

MORRISON HERSHFIELD

DESIGNED BY	MR	CHECKED BY	HAK
DRAWN BY	DML	APPROVED BY	RPB
HOR. SCALE	1:500	RELEASED FOR CONSTRUCTION	
VERT. SCALE			
DATE	16/03/18	DATE	

PROFESSIONAL'S SEAL

CONSULTANT DRAWING No.
W160015-EPR Lorette-02.dwg

THE CITY OF WINNIPEG
Winnipeg WATER AND WASTE DEPARTMENT

2016 LOCAL STREETS PACKAGE
LORETTE AVENUE
450 CLAY CS POINT REPAIR
MH AT WENTWORTH ST TO
1st MH W OF LILAC ST

SHEET	OF
2	3
CITY DRAWING NUMBER	
11293	