

ANSI B SIZE 11" x 17" (279mm x 432mm)

PLOT: 2016-04-25 11:31:21 AM

FILE NAME: W160015-EPR Lorette-01.dwg Saved By: dplane

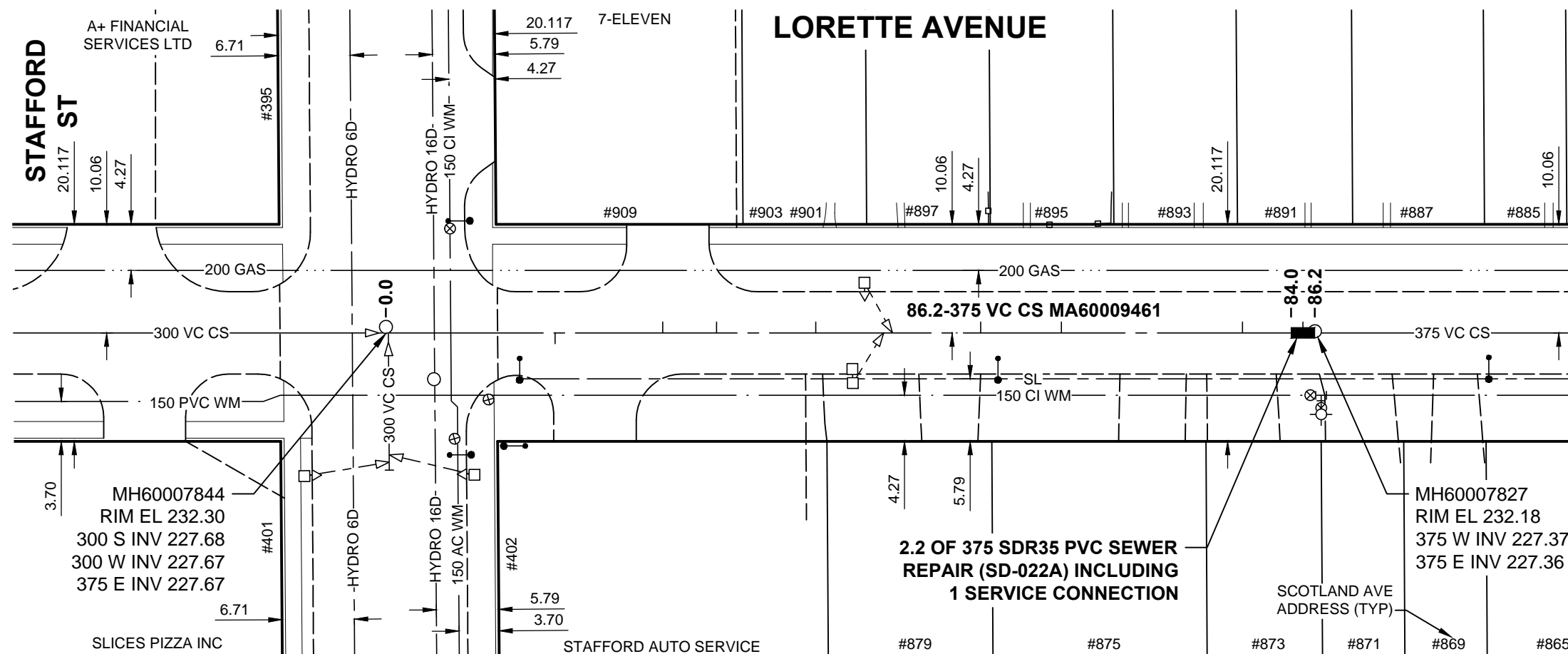

PLAN

SCALE: 1:500

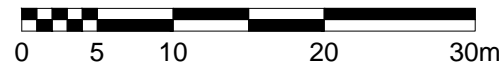

SEWER JUNCTION
INFORMATION FROM
SEWER VIDEO INSPECTION

SEWER ID MA60009461

DISTANCE FROM MH ID MH60007844		
DISTANCE	DIAMETER	CLOCK
15.7	100	1
25.7	100	10
30.7	100	10
39.9	100	10
46.2	150	2
47.0	150	10
55.2	100	11
62.7	100	10
79.5	100	10
85.1	100	11

2.2 OF 375 SDR35 PVC SEWER
REPAIR (SD-022A) INCLUDING
1 SERVICE CONNECTION

SCOTLAND AVE
ADDRESS (TYP)

MH60007827
RIM EL 232.18
375 W INV 227.37
375 E INV 227.36

APEGM
Certificate of Authorization
MORRISON HERSHFIELD
No. 1736

METRIC
WHOLE NUMBERS INDICATE MILLIMETRES
DECIMALIZED NUMBERS INDICATE METRES

BID OPPORTUNITY No. 180-2016

LOCATION APPROVED
UNDERGROUND STRUCTURES

SUPR. U/G STRUCTURES COMMITTEE DATE

NOTE:
LOCATION OF UNDERGROUND STRUCTURES AS SHOWN ARE BASED ON THE BEST INFORMATION AVAILABLE BUT NO GUARANTEE IS GIVEN THAT ALL EXISTING UTILITIES ARE SHOWN OR THAT THE GIVEN LOCATIONS ARE EXACT. CONFIRMATION OF EXISTENCE AND EXACT LOCATION OF ALL SERVICES MUST BE OBTAINED FROM THE INDIVIDUAL UTILITIES BEFORE PROCEEDING WITH CONSTRUCTION.

BM ELEV	52-023 231.873 m	SW Cor. Wentworth St. & Weatherdon Ave., Brass plug in 4.6 m Conc. pile, 2.6 m E. of W.L. Wentworth St. & 0.6 m S. of S.L. Weatherdon Ave.
No.	ISSUED FOR TENDER	16/04/25 HAK
No.	REVISIONS	YY/MM/DD BY

DESIGNED BY	MR	CHECKED BY	HAK
DRAWN BY	DML	APPROVED BY	RPB
HOR. SCALE	1:500	RELEASED FOR CONSTRUCTION	
VERT. SCALE		DATE	16/03/18

PROFESSIONAL'S SEAL

CONSULTANT DRAWING No.
W160015-EPR Lorette-01.dwg

THE CITY OF WINNIPEG
WATER AND WASTE DEPARTMENT

2016 LOCAL STREETS PACKAGE

LORETTE AVENUE

375 CLAY CS POINT REPAIR
MH AT STAFFORD ST TO
1st MH W OF WENTWORTH ST

SHEET	OF
1	3
CITY DRAWING NUMBER	
11292	