

PRINCE RUPERT AVENUE

102.2 OF 300 CLAY CS TO BE LINED
S-MA40008027
(FULLY DETERIORATED)

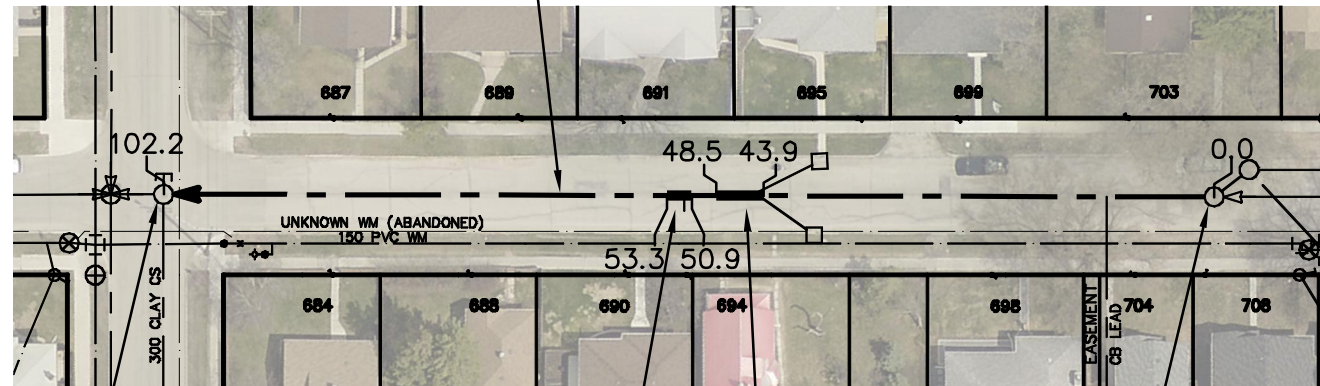

S-MH70022435
RIM 230.24
INV W 225.51
INV E 225.51
INV N 225.75
INV S 225.74

GREY ST

S-MH40007309
RIM 230.01
INV W 226.76
INV E 226.76
INV NE 226.83

2.4m OF 300mm PVC
SEWER REPAIR (SD-022A)
INCLUDING 1 SERVICE CONNECTION
(TO BE DONE BY OTHERS)

4.6m OF 300mm PVC
SEWER REPAIR (SD-022B)
(TO BE DONE BY OTHERS)

SEWER JUNCTION INFORMATION FROM SEWER VIDEO INSPECTION SEWER ID S-MA40008027		
DISTANCE FROM MH ID S-MH40007309		
DISTANCE	DIAMETER	CLOCK
2.1	150	9
4.4	150	9
7.4	150	10
10.5	150	2
10.8	150	11
19.8	150	10
24.6	150	2
25.5	150	2
34.2	150	1
38.4	150	11
41.9	150	1
51.1	150	10
54.2	150	11
58.0	150	2
60.5	150	1
66.8	150	1
72.7	150	10
88.2	150	10
89.4	150	1
95.1	150	11
97.7	150	2

WARNING

IF POWER EQUIPMENT OR EXPLOSIVES
ARE TO BE USED FOR EXCAVATION ON
THIS PROJECT THE CONTRACTOR MUST:

- 1) NOTIFY THE GAS COMPANY OF THE PROPOSED LOCATION OF EXCAVATION.
- 2) TAKE PRECAUTION TO AVOID DAMAGE TO GAS COMPANY INSTALLATIONS.

SEE PROVINCIAL REGULATION 210/72 FOR DETAILS

METRIC

WHOLE NUMBERS INDICATE MILLIMETRES
DECIMALIZED NUMBERS INDICATE METRES

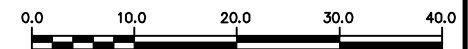

LOCATION APPROVED
UNDERGROUND STRUCTURES

SUPV. U/G STRUCTURES COMMITTEE DATE

NOTE:

LOCATION OF UNDERGROUND STRUCTURES AS SHOWN ARE BASED ON THE BEST INFORMATION AVAILABLE BUT NO GUARANTEE IS GIVEN THAT ALL EXISTING UTILITIES ARE SHOWN OR THAT THE GIVEN LOCATIONS ARE EXACT. CONFIRMATION OF EXISTENCE AND EXACT LOCATION OF ALL SERVICES MUST BE OBTAINED FROM THE INDIVIDUAL UTILITIES BEFORE PROCEEDING WITH CONSTRUCTION.

B.M. ELEV.			
CONSTRUCTION COMPLETION DATE: YYYY MM DD			
DESIGNED BY	NC		
CHECKED BY	SC		
DRAWN BY	RJ		
APPROVED BY	KZ		
SCALE:			
HORIZONTAL	1:750		
VERTICAL			
RELEASED FOR CONSTRUCTION	KAZ ZUREK		
NO.	REVISIONS	DATE	BY

DESIGNED BY	NC	CHECKED BY	SC
DRAWN BY	RJ	APPROVED BY	KZ
SCALE:		RELEASED FOR CONSTRUCTION	KAZ ZUREK
HORIZONTAL	1:750		
VERTICAL			
DATE	2016 03 29	DATE	2016 03 24
PLOT DATE:	2016 03 29		

ENGINEER'S SEAL

ORIGINAL
SIGNED BY
S.R.J.
COURNOYER
16-03-22

CONSULTANT DRAWING NUMBER
-



THE CITY OF WINNIPEG
WATER AND WASTE DEPARTMENT
ENGINEERING DIVISION

2015 SEWER RENEWALS
BY CIPP LINING
PRINCE RUPERT AVENUE
1ST MH E OF GREY STREET TO
MH AT GREY STREET (E OF C)

SHEET 40 OF 47
CITY DRAWING NUMBER

11252