

# JOHNSON AVENUE W

104.7 OF 375 CLAY CS TO BE LINED  
S-MA40008875  
(FULLY DETERIORATED)

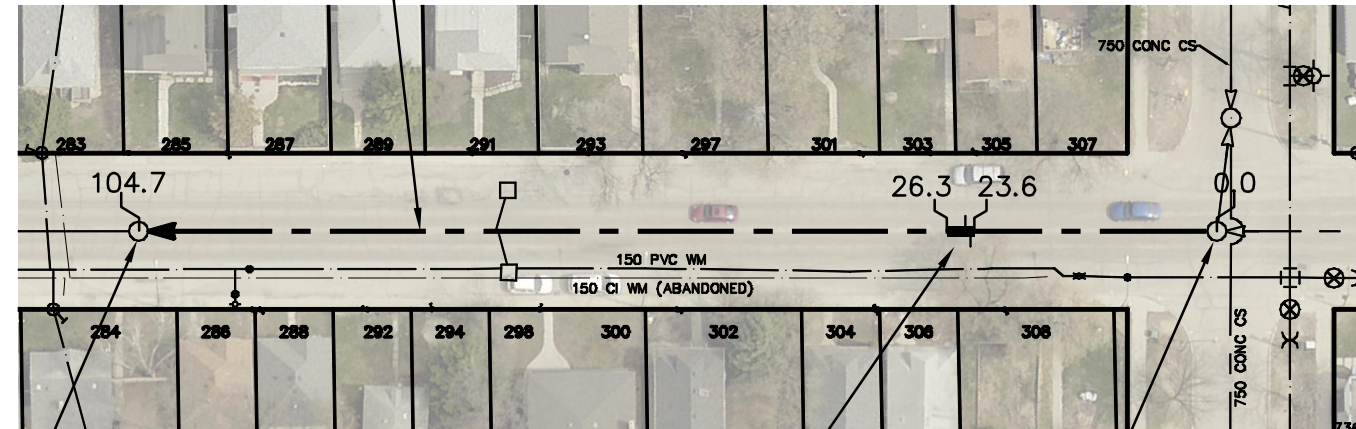

S-MH40008092  
RIM 230.95  
INV E 226.85  
INV W 226.84

2.7m OF 375mm PVC  
SEWER REPAIR (SD-022A)  
INCLUDING 2 SERVICE CONNECTIONS  
(TO BE DONE BY OTHERS)

S-MH40008062  
RIM 231.16  
INV W 227.42  
INV E 227.41  
INV N 227.35

ROCH ST

SEWER JUNCTION INFORMATION FROM SEWER VIDEO INSPECTION		
SEWER ID S-MA40008875		
DISTANCE FROM MH ID S-MH40008062		
DISTANCE	DIAMETER	CLOCK
24.0	150	10
24.5	150	2
30.5	150	1
39.1	150	10
39.7	150	2
54.5	150	10
55.1	150	2
66.6	150	10
67.2	150	2
69.5	150	10
70.1	150	2
85.0	150	10
85.5	150	2
97.5	100	11
100.3	150	10
100.9	150	2

## WARNING

IF POWER EQUIPMENT OR EXPLOSIVES ARE TO BE USED FOR EXCAVATION ON THIS PROJECT THE CONTRACTOR MUST:

- 1) NOTIFY THE GAS COMPANY OF THE PROPOSED LOCATION OF EXCAVATION.
- 2) TAKE PRECAUTION TO AVOID DAMAGE TO GAS COMPANY INSTALLATIONS.

SEE PROVINCIAL REGULATION 210/72 FOR DETAILS

## METRIC

WHOLE NUMBERS INDICATE MILLIMETRES  
DECIMALIZED NUMBERS INDICATE METRES

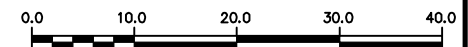

LOCATION APPROVED  
UNDERGROUND STRUCTURES

B.M.  
ELEV.

CONSTRUCTION COMPLETION DATE: YYYY MM DD

SUPV. U/G STRUCTURES COMMITTEE DATE

NOTE:

LOCATION OF UNDERGROUND STRUCTURES AS SHOWN ARE BASED ON THE BEST INFORMATION AVAILABLE BUT NO GUARANTEE IS GIVEN THAT ALL EXISTING UTILITIES ARE SHOWN OR THAT THE GIVEN LOCATIONS ARE EXACT. CONFIRMATION OF EXISTENCE AND EXACT LOCATION OF ALL SERVICES MUST BE OBTAINED FROM THE INDIVIDUAL UTILITIES BEFORE PROCEEDING WITH CONSTRUCTION.

NO.	REVISIONS	DATE	BY

DESIGNED BY	NC	CHECKED BY	SC
DRAWN BY	RJ	APPROVED BY	KZ
SCALE:	1:750	RELEASED FOR CONSTRUCTION	KAZ ZUREK
HORIZONTAL		DATE	2016 03 29
VERTICAL		DATE	2016 03 24

ENGINEER'S SEAL

ORIGINAL  
SIGNED BY  
S.R.J.  
COURNOYER  
16-03-22

CONSULTANT DRAWING NUMBER

BID OPPORTUNITY: 173-2016  
CONTRACT NUMBER: 2



**THE CITY OF WINNIPEG**  
WATER AND WASTE DEPARTMENT  
ENGINEERING DIVISION

2015 SEWER RENEWALS  
BY CIPP LINING  
**JOHNSON AVENUE W**  
MH AT ROCH STREET TO  
1ST MH W OF ROCH STREET

SHEET 20 OF 47

CITY DRAWING NUMBER

11232

FILE PATH: R:\DRAWINGS\SEWER\2015 RENEWALS\RENEWALS & ASSOCIATED WORKS\Contract 2\Construction Dwg\  
FILE NAME: JOHNSON\_S-MA40008875.dwg