

SEVEN OAKS AVENUE

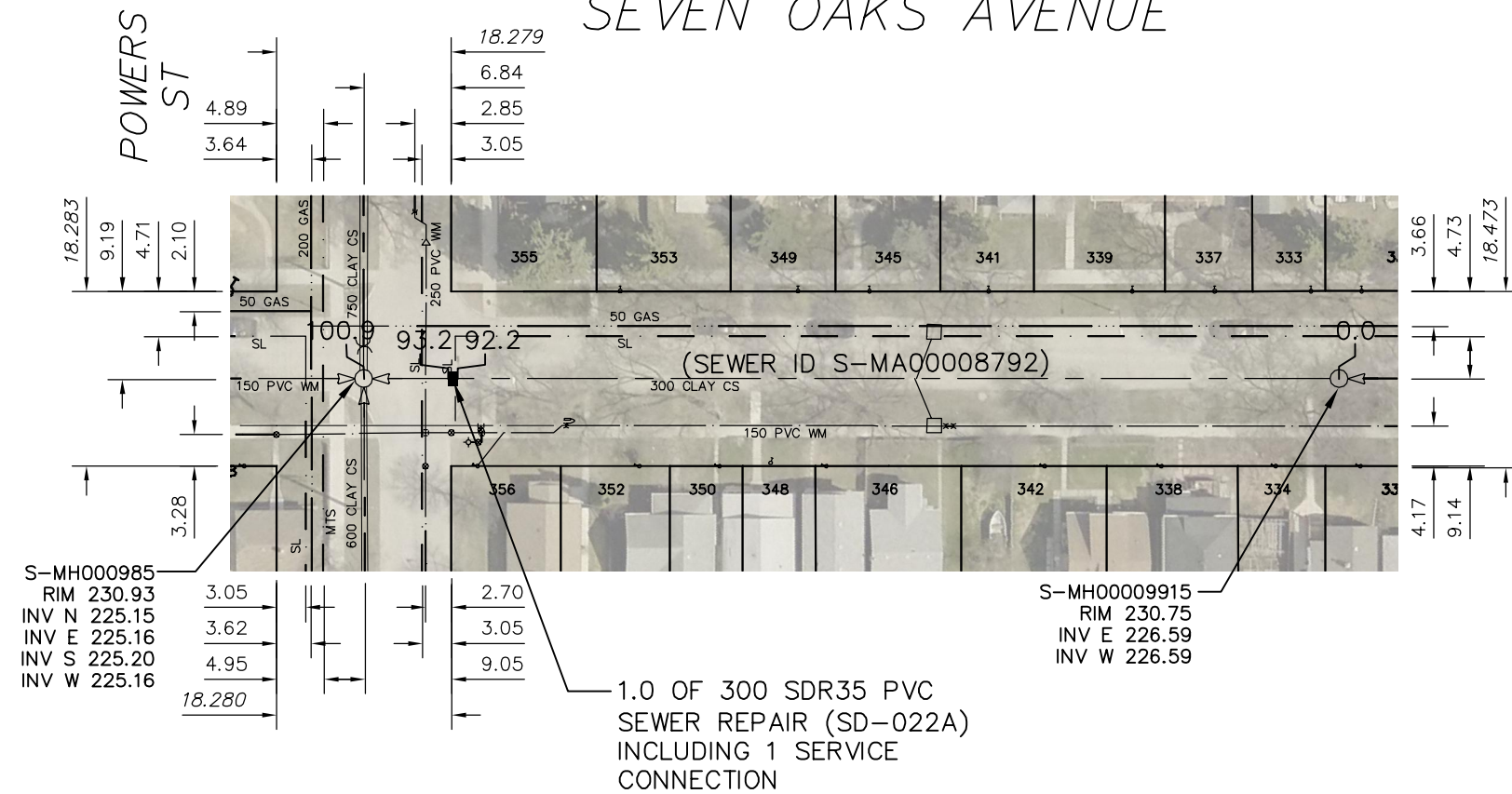

SEWER JUNCTION INFORMATION FROM SEWER VIDEO INSPECTION		
SEWER ID S-MA00008792		
DISTANCE FROM MH ID S-MH00009915		
DISTANCE	DIAMETER	CLOCK
2.2	150	2
7.4	150	2
8.1	150	10
14.4	150	2
23.0	150	2
23.8	150	10
32.4	150	10
37.1	150	2
43.4	200	2
44.2	200	10
52.1	150	2
53.1	150	10
58.6	150	11
59.3	150	2
69.7	150	11
75.9	150	11
76.7	150	2
90.7	100	11
92.5	150	10

FOR INDEX SEE
11159

WARNING

IF POWER EQUIPMENT OR EXPLOSIVES ARE TO BE USED FOR EXCAVATION ON THIS PROJECT THE CONTRACTOR MUST:

- 1) NOTIFY THE GAS COMPANY OF THE PROPOSED LOCATION OF EXCAVATION.
- 2) TAKE PRECAUTION TO AVOID DAMAGE TO GAS COMPANY INSTALLATIONS.

SEE PROVINCIAL REGULATION 210/72 FOR DETAILS

METRIC

WHOLE NUMBERS INDICATE MILLIMETRES
DECIMALIZED NUMBERS INDICATE METRES



<p style="text-align: center;">LOCATION APPROVED UNDERGROUND STRUCTURES</p> <p>SUPV. U/G STRUCTURES COMMITTEE _____ DATE _____</p> <p>NOTE: LOCATION OF UNDERGROUND STRUCTURES AS SHOWN ARE BASED ON THE BEST INFORMATION AVAILABLE BUT NO GUARANTEE IS GIVEN THAT ALL EXISTING UTILITIES ARE SHOWN OR THAT THE GIVEN LOCATIONS ARE EXACT. CONFIRMATION OF EXISTENCE AND EXACT LOCATION OF ALL SERVICES MUST BE OBTAINED FROM THE INDIVIDUAL UTILITIES BEFORE PROCEEDING WITH CONSTRUCTION.</p>	<p>B.M. ELEV.</p> <table border="1" style="width: 100%; border-collapse: collapse;"> <tr><td> </td><td> </td><td> </td><td> </td></tr> <tr><td> </td><td> </td><td> </td><td> </td></tr> <tr><td> </td><td> </td><td> </td><td> </td></tr> <tr><td> </td><td> </td><td> </td><td> </td></tr> <tr><td> </td><td> </td><td> </td><td> </td></tr> <tr><td> </td><td> </td><td> </td><td> </td></tr> <tr><td> </td><td> </td><td> </td><td> </td></tr> <tr><td> </td><td> </td><td> </td><td> </td></tr> </table>																																	<table border="1" style="width: 100%; border-collapse: collapse;"> <tr> <td>DESIGNED BY</td><td style="text-align: center;">TS</td> <td>CHECKED BY</td><td style="text-align: center;">SC</td> </tr> <tr> <td>DRAWN BY</td><td style="text-align: center;">RS</td> <td>APPROVED BY</td><td style="text-align: center;">KZ</td> </tr> <tr> <td>SCALE:</td><td></td> <td>RELEASED FOR CONSTRUCTION</td><td></td> </tr> <tr> <td>HORIZONTAL</td><td style="text-align: center;">1:750</td> <td></td><td></td> </tr> <tr> <td>VERTICAL</td><td></td> <td></td><td></td> </tr> <tr> <td>DATE</td><td style="text-align: center;">2015 12 17</td> <td>DATE</td><td></td> </tr> <tr> <td>PLOT DATE:</td><td style="text-align: center;">2015 12 17</td> <td></td><td></td> </tr> </table>	DESIGNED BY	TS	CHECKED BY	SC	DRAWN BY	RS	APPROVED BY	KZ	SCALE:		RELEASED FOR CONSTRUCTION		HORIZONTAL	1:750			VERTICAL				DATE	2015 12 17	DATE		PLOT DATE:	2015 12 17			<p style="text-align: center;">ENGINEER'S SEAL</p> <p style="text-align: center;">ORIGINAL SIGNED BY S.R.J. COURNOYER 12/07/15</p> <p>CONSULTANT DRAWING NUMBER: -</p>	<div style="display: flex; justify-content: space-between;"> <div style="text-align: center;"> <p>THE CITY OF WINNIPEG</p> <p>WATER AND WASTE DEPARTMENT ENGINEERING DIVISION</p> </div> </div> <div style="text-align: center; margin-top: 10px;"> <p>2015 SEWER RENEWALS BY EXTERNAL POINT REPAIR SEVEN OAKS AVENUE 1ST MH E OF POWERS STREET TO MH AT POWERS STREET</p> </div>	<p style="text-align: center;">SHEET 42 OF 49</p> <p style="text-align: center;">CITY DRAWING NUMBER</p> <p style="text-align: center; font-size: 1.2em;">11203</p>
DESIGNED BY	TS	CHECKED BY	SC																																																														
DRAWN BY	RS	APPROVED BY	KZ																																																														
SCALE:		RELEASED FOR CONSTRUCTION																																																															
HORIZONTAL	1:750																																																																
VERTICAL																																																																	
DATE	2015 12 17	DATE																																																															
PLOT DATE:	2015 12 17																																																																