

STERLING AVENUE

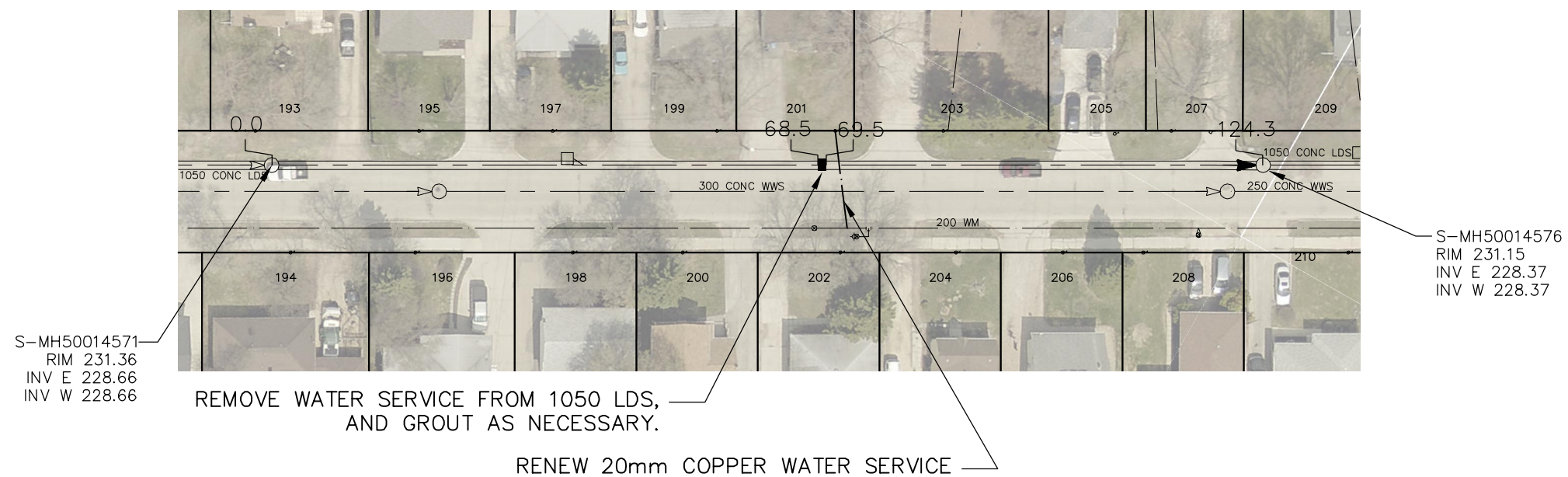

SEWER JUNCTION INFORMATION FROM SEWER VIDEO INSPECTION		
SEWER ID S-MA50018074		
DISTANCE FROM MH ID S-MH50014571	DIAMETER	CLOCK
39.4	150	10

WARNING

IF POWER EQUIPMENT OR EXPLOSIVES ARE TO BE USED FOR EXCAVATION ON THIS PROJECT THE CONTRACTOR MUST:

- 1) NOTIFY THE GAS COMPANY OF THE PROPOSED LOCATION OF EXCAVATION.
- 2) TAKE PRECAUTION TO AVOID DAMAGE TO GAS COMPANY INSTALLATIONS.

SEE PROVINCIAL REGULATION 210/72 FOR DETAILS

METRIC

WHOLE NUMBERS INDICATE MILLIMETRES
DECIMALIZED NUMBERS INDICATE METRES

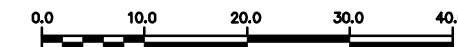

LOCATION APPROVED UNDERGROUND STRUCTURES SUPV. U/G STRUCTURES COMMITTEE _____ DATE _____ NOTE: LOCATION OF UNDERGROUND STRUCTURES AS SHOWN ARE BASED ON THE BEST INFORMATION AVAILABLE BUT NO GUARANTEE IS GIVEN THAT ALL EXISTING UTILITIES ARE SHOWN OR THAT THE GIVEN LOCATIONS ARE EXACT. CONFIRMATION OF EXISTENCE AND EXACT LOCATION OF ALL SERVICES MUST BE OBTAINED FROM THE INDIVIDUAL UTILITIES BEFORE PROCEEDING WITH CONSTRUCTION.	B.M. ELEV.			ENGINEER'S SEAL		 THE CITY OF WINNIPEG WATER AND WASTE DEPARTMENT ENGINEERING DIVISION 2015 SEWER RENEWALS BY STABILIZATION STERLING AVENUE 2ND MH E SIFERTS COVE TO 3RD MH E SIFERTS COVE	SHEET 38 OF 41
	DESIGNED BY TS	CHECKED BY SC	ORIGINAL SIGNED BY S.R.J. COURNOYER 12/05/15		CONSULTANT DRAWING NUMBER		CITY DRAWING NUMBER
NO.	REVISIONS	DATE	BY	DRAWN BY RS	APPROVED BY KZ	11155	
				SCALE: HORIZONTAL 1:750 VERTICAL	RELEASED FOR CONSTRUCTION		
				DATE 2015 12 16	DATE		
				PLOT DATE: 2015 12 16			