

FAWCETT AVENUE

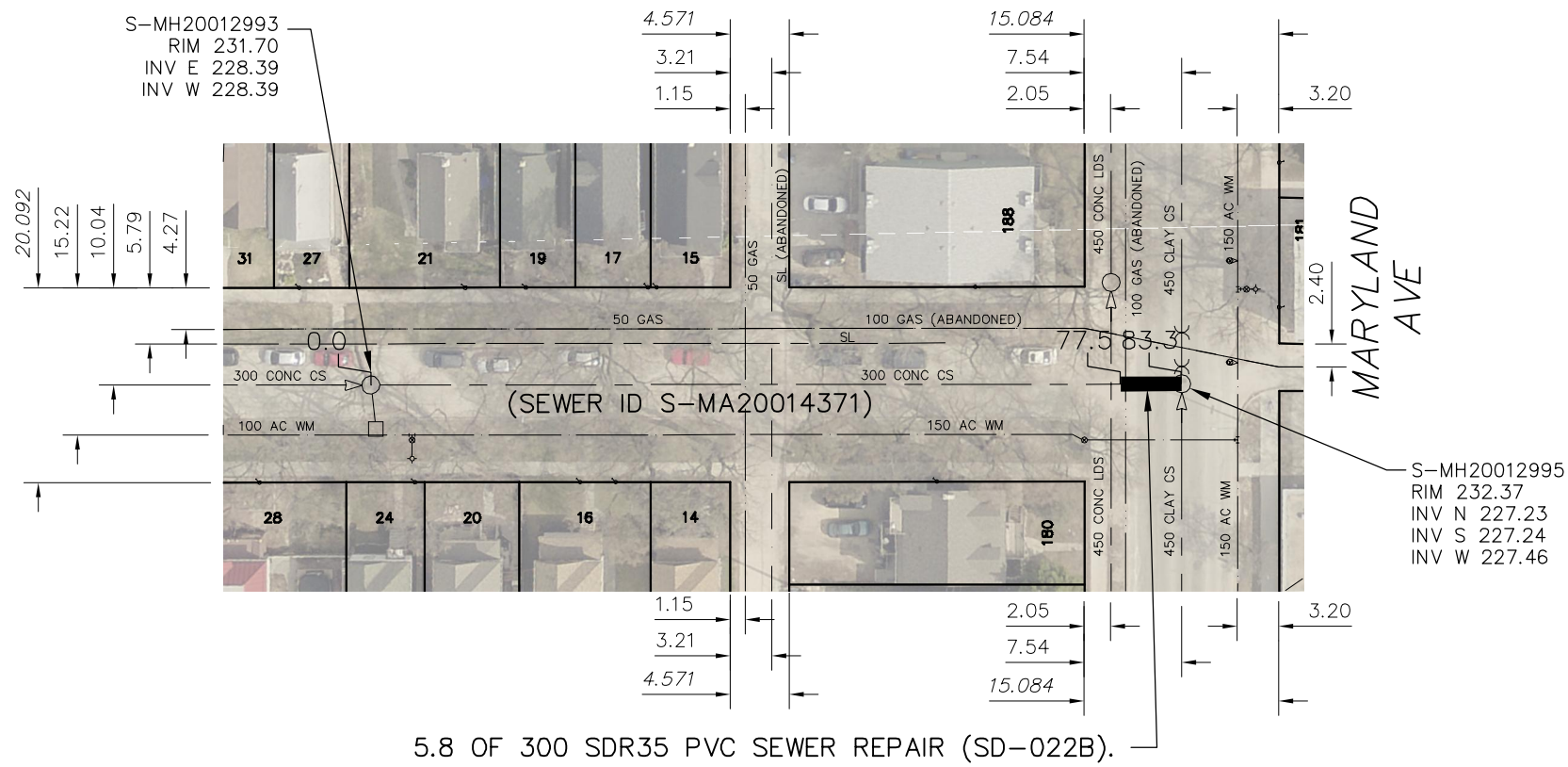

SEWER JUNCTION INFORMATION FROM SEWER VIDEO INSPECTION

SEWER ID S-MA20014371

DISTANCE FROM MH ID S-MH20012993

DISTANCE	DIAMETER	CLOCK
3.6	150	3
4.1	150	11
4.3	150	1
4.4	150	1
10.5	150	10
14.3	150	11
17.8	150	10
25.1	150	2
35.0	150	10
62.0	150	3
62.2	150	10

WARNING

IF POWER EQUIPMENT OR EXPLOSIVES ARE TO BE USED FOR EXCAVATION ON THIS PROJECT THE CONTRACTOR MUST:

- 1) NOTIFY THE GAS COMPANY OF THE PROPOSED LOCATION OF EXCAVATION.
- 2) TAKE PRECAUTION TO AVOID DAMAGE TO GAS COMPANY INSTALLATIONS.

SEE PROVINCIAL REGULATION 210/72 FOR DETAILS

METRIC

WHOLE NUMBERS INDICATE MILLIMETRES
DECIMALIZED NUMBERS INDICATE METRES



LOCATION APPROVED UNDERGROUND STRUCTURES

SUPV. U/G STRUCTURES COMMITTEE DATE

NOTE:
LOCATION OF UNDERGROUND STRUCTURES AS SHOWN ARE BASED ON THE BEST INFORMATION AVAILABLE BUT NO GUARANTEE IS GIVEN THAT ALL EXISTING UTILITIES ARE SHOWN OR THAT THE GIVEN LOCATIONS ARE EXACT. CONFIRMATION OF EXISTENCE AND EXACT LOCATION OF ALL SERVICES MUST BE OBTAINED FROM THE INDIVIDUAL UTILITIES BEFORE PROCEEDING WITH CONSTRUCTION.

NO.	REVISIONS	DATE	BY

DESIGNED BY	TS	CHECKED BY	SC
DRAWN BY	RS	APPROVED BY	KZ
SCALE:	1:750	RELEASED FOR CONSTRUCTION	
HORIZONTAL			
VERTICAL			
DATE	2015 12 16	DATE	

ENGINEER'S SEAL

ORIGINAL SIGNED BY S.R.J. COURNOYER 12/07/15

CONSULTANT DRAWING NUMBER



2015 SEWER RENEWALS
BY EXTERNAL POINT REPAIR
FAWCETT AVENUE
1ST MH W MARYLAND STREET TO
MH AT MARYLAND STREET (☺)

SHEET 16 OF 41
CITY DRAWING NUMBER
11133

PLOT DATE: 2015 12 16

BID OPPORTUNITY: 971-2015
CONTRACT NUMBER: 4

FILE PATH: R:\DRAWINGS\SEWER\2015 RENEWALS\RENEWALS & ASSOCIATED WORKS\Contract 4\Contract 4_Final\
FILE NAME: FAWCETT_S-MA20014371.dwg