

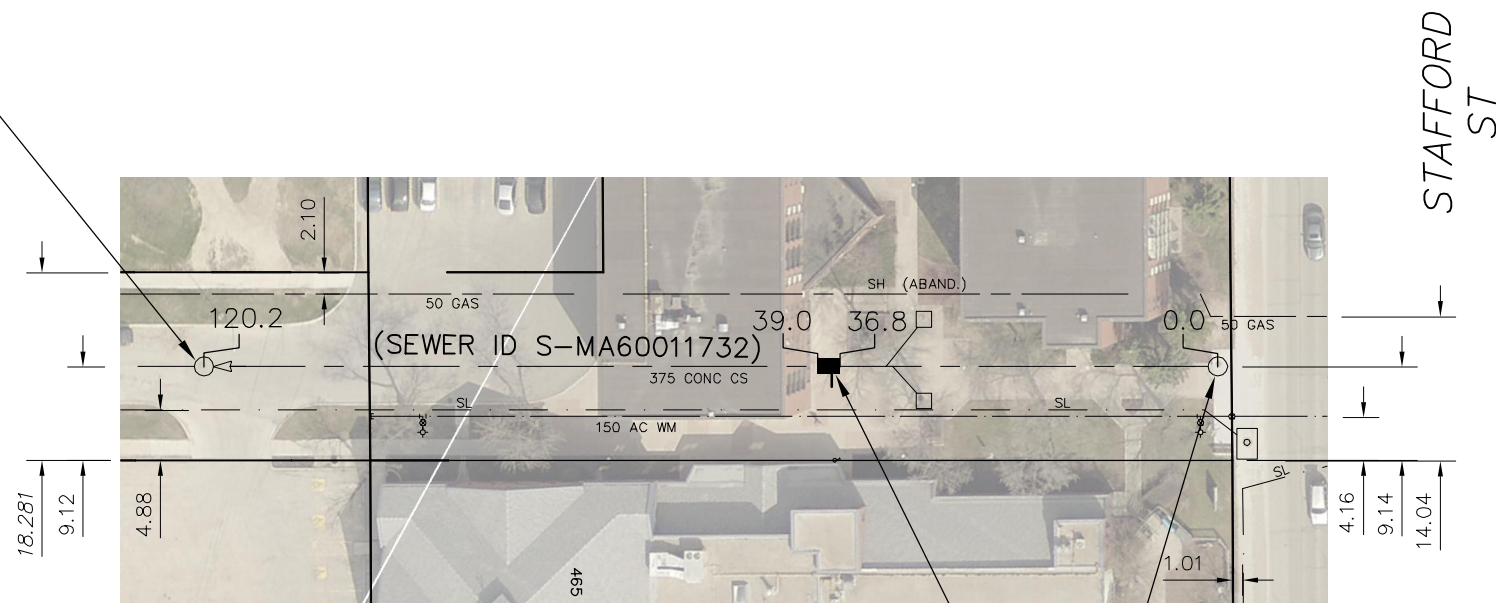

# CARTER AVENUE

S-MH60009961  
RIM 232.18  
INV W 228.65  
INV E 228.65



STAFFORD ST

2.2 OF 375 SDR35 PVC SEWER REPAIR (SD-022A), INCLUDING 1 SERVICE CONNECTION.

S-MH60009994  
RIM 232.16  
INV W 228.42

SEWER JUNCTION INFORMATION FROM SEWER VIDEO INSPECTION		
SEWER ID S-MA60011732		
DISTANCE FROM MH ID S-MH60009994		
DISTANCE	DIAMETER	CLOCK
1.8	200	9
3.7	150	10
20.6	150	2
31.7	150	10
32.4	150	2
37.6	150	11
59.5	150	1
64.8	150	1
65.7	150	10
72.6	200	2
74.3	150	10
80.4	150	10
83.6	150	10
84.6	150	10

### WARNING

IF POWER EQUIPMENT OR EXPLOSIVES ARE TO BE USED FOR EXCAVATION ON THIS PROJECT THE CONTRACTOR MUST:

- 1) NOTIFY THE GAS COMPANY OF THE PROPOSED LOCATION OF EXCAVATION.
- 2) TAKE PRECAUTION TO AVOID DAMAGE TO GAS COMPANY INSTALLATIONS.

SEE PROVINCIAL REGULATION 210/72 FOR DETAILS

METRIC  
WHOLE NUMBERS INDICATE MILLIMETRES  
DECIMALIZED NUMBERS INDICATE METRES



### LOCATION APPROVED UNDERGROUND STRUCTURES

SUPV. U/G STRUCTURES COMMITTEE DATE

#### NOTE:

LOCATION OF UNDERGROUND STRUCTURES AS SHOWN ARE BASED ON THE BEST INFORMATION AVAILABLE BUT NO GUARANTEE IS GIVEN THAT ALL EXISTING UTILITIES ARE SHOWN OR THAT THE GIVEN LOCATIONS ARE EXACT. CONFIRMATION OF EXISTENCE AND EXACT LOCATION OF ALL SERVICES MUST BE OBTAINED FROM THE INDIVIDUAL UTILITIES BEFORE PROCEEDING WITH CONSTRUCTION.

NO.	REVISIONS	DATE	BY

DESIGNED BY	<b>TS</b>	CHECKED BY	<b>SC</b>
DRAWN BY	<b>RS</b>	APPROVED BY	<b>KZ</b>
SCALE:	<b>1:750</b>	RELEASED FOR CONSTRUCTION	
HORIZONTAL			
VERTICAL			
DATE	<b>2015 12 16</b>	DATE	

ENGINEER'S SEAL

ORIGINAL SIGNED BY S.R.J. COURNOYER  
12/07/15

CONSULTANT DRAWING NUMBER



## THE CITY OF WINNIPEG

WATER AND WASTE DEPARTMENT  
ENGINEERING DIVISION

2015 SEWER RENEWALS  
BY EXTERNAL POINT REPAIR  
CARTER AVENUE  
MH AT STAFFORD STREET (W R) TO  
1ST MH W OF STAFFORD STREET

SHEET 9 OF 41

CITY DRAWING NUMBER

11126