

NOTES:

- SEE DRAWING 1-0169L-S0004 FOR GENERAL NOTES.
- SEE DRAWING 1-0169L-S0005 FOR STRUCTURAL NOTES.

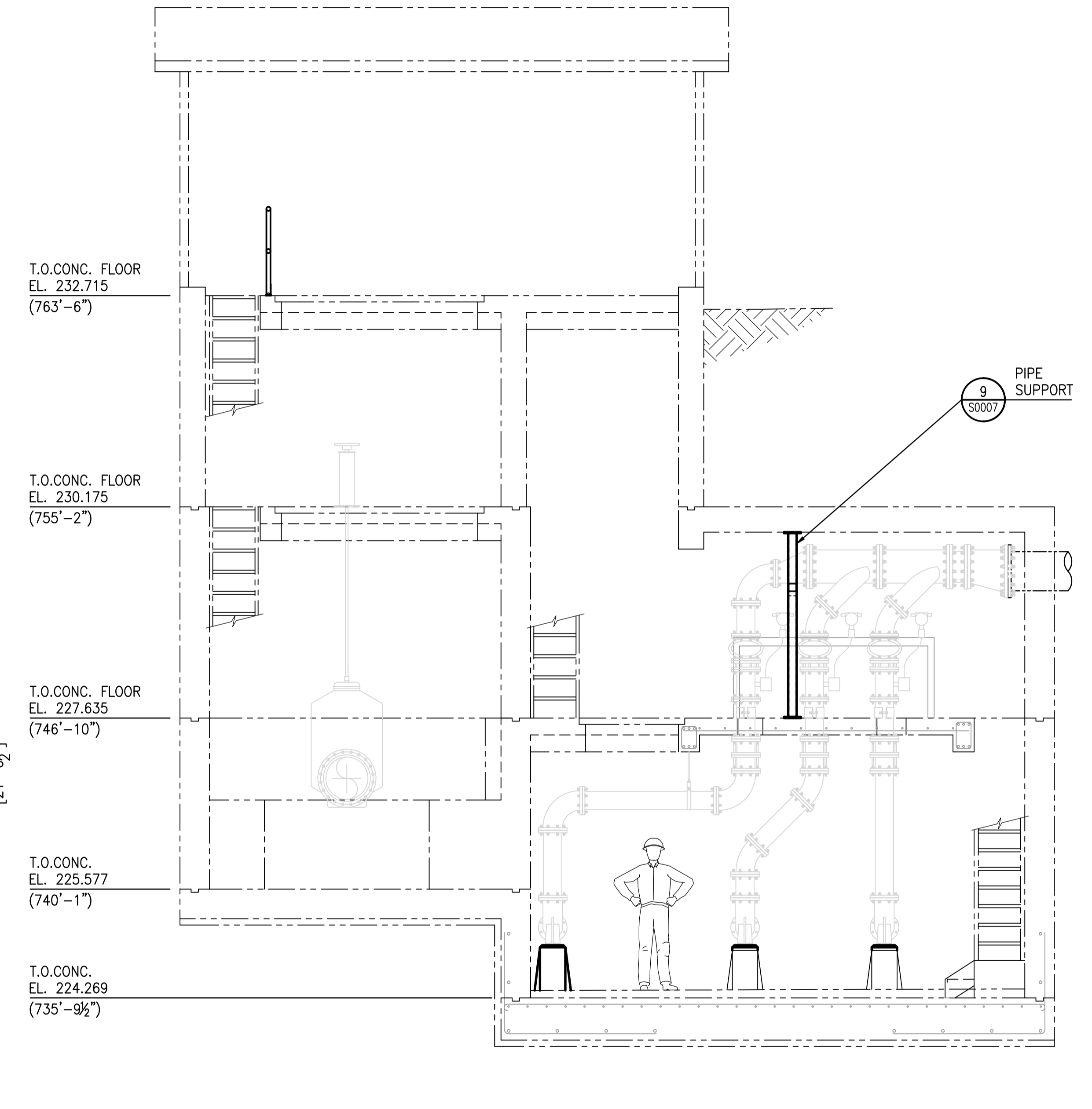

403-B	AINSLIE COMM. & PUMPING STATION - SUPERSTRUCTURE & DETAILS
403-A	AINSLIE COMM. & PUMPING STATION - REINFORCING DETAILS
403	AINSLIE COMM. & PUMPING STATION
DRAWING NUMBER	REFERENCE DRAWINGS

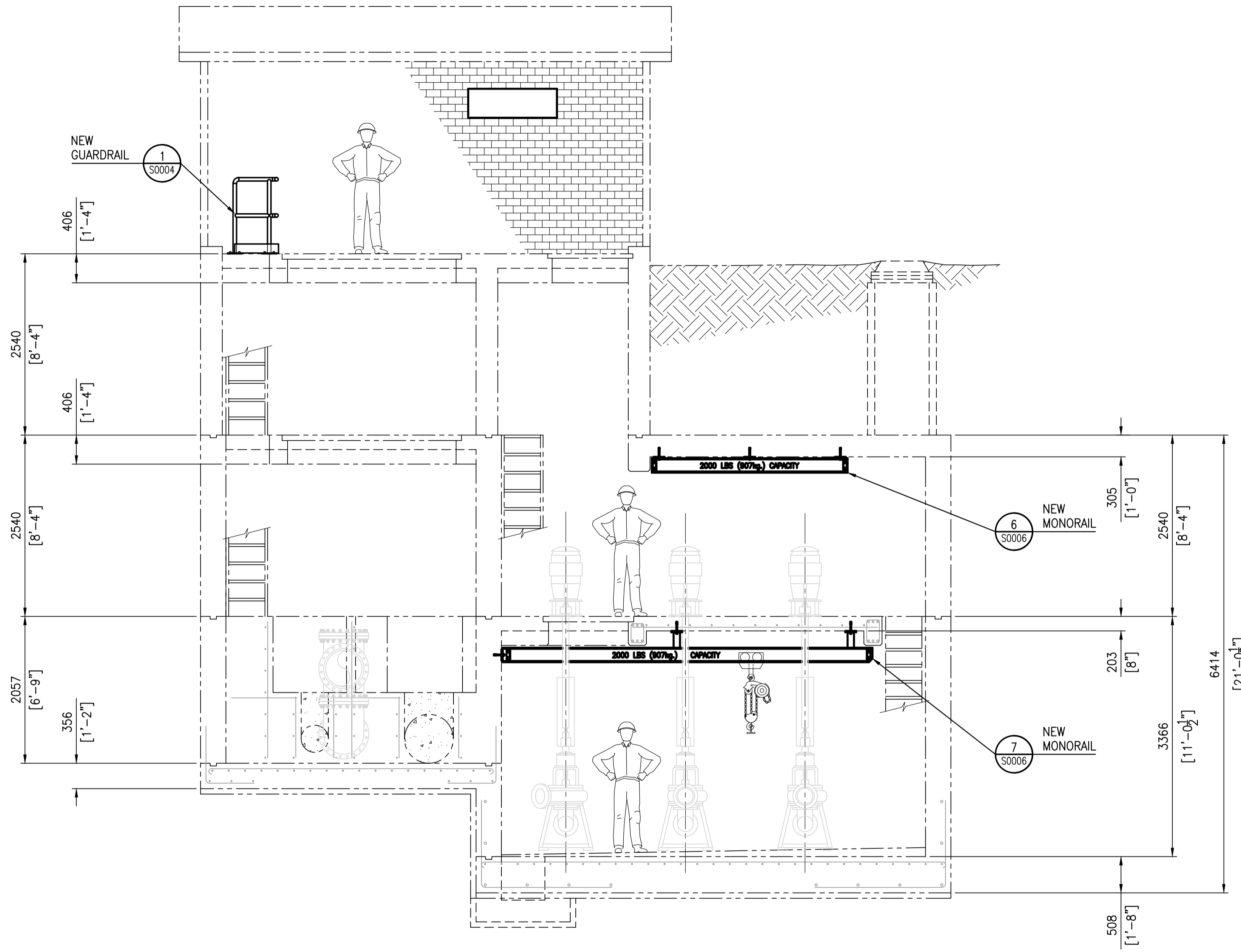
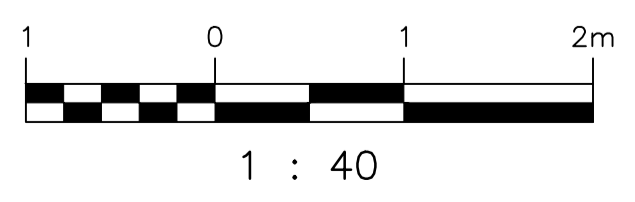

APEGM
Certificate of Authorization
SNC-Lavalin Inc.
No. 4489

DESIGNED BY:	K. KOTYK	CHECKED BY:	D. COATES
DRAWN BY:	B. DICKSON	APPROVED BY:	I. PARKINSON
SCALE:	1:40	ISSUED FOR CONSTRUCTION BY:	
DATE:	2015/06/22	DATE:	
CONSULTANT NO.:			
NO. REVISIONS		DATE	DESIGN/CHECK

SNC-LAVALIN INC.
148 Nature Park Way
Winnipeg, MB, Canada R3P 0X7
204-786-8080

PRELIMINARY
NOT TO BE USED FOR CONSTRUCTION

ENGINEER'S SEAL

THE CITY OF WINNIPEG
WATER AND WASTE DEPARTMENT

OLIVE WASTEWATER LIFT STATION
2015 UPGRADES
ELEVATIONS
STRUCTURAL MODIFICATIONS

CITY DRAWING NUMBER: 1-0169L-S0002
SHEET: 001
REV.: 00
SIZE: A1