



PUBLIC RESERVE
"B"

M.T.S. EASEMENT

HYDRO POLE LINE

M.T.S. DUCT

24" ϕ CONC PIPE

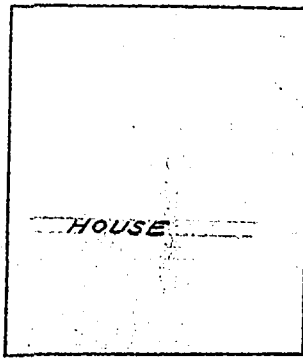

SUPER-
STRUCTURE
16' X 22'

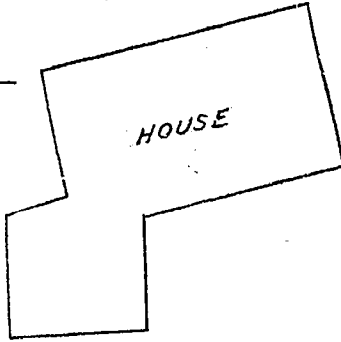

HOUSE

32'-6"

28'

ASSINIBOINE

PROPOSED
DRIVEWAY

12" ϕ SEWER

8" ϕ W.M.
18" ϕ SEWER
10" ϕ SEWER
24" ϕ FORCE MAIN

PROPOSED INLET
SEWER TO PUMP
STATION

PUBLIC
RESERVE "A"

GATE CHAMBER

THE METROPOLITAN CORPORATION OF GREATER WPG
WATERWORKS & WASTE DISPOSAL DIVISION
SEWER DISPOSAL BRANCH

ST. JAMES INTERCEPTOR
SITE PLAN
AINSLIE PUMPING STATION

REVISIONS

- ⚠ DRIVEWAY RELOCATED JUNE 20/63 V.D.
- ⚠ SUPERSTRUCTURE DIMENSIONS ADDED 13 MAY 64

APPROVED BY	DESIGNED BY	CHECKED BY H.B.S.	DWG. No.
	DRAWN BY V.D.	DATE MARCH 20/63	S-265
SCALES 1" = 40'			