

NOTES:

- ISOLATE EXISTING HYDRO POLES AS DIRECTED BY CONTRACT ADMINISTRATOR
- RENEW EXISTING APPROACHES AS DIRECTED BY CONTRACT ADMINISTRATOR
- ADDITIONAL EXCAVATION AND INSTALLATION OF SUBGRADE GEOGRID TO BE DETERMINED BY CONTRACT ADMINISTRATOR
- ADJUSTMENTS TO PROPOSED CROSSFALL, WHERE REQUIRED, ARE TO BE DETERMINED BY CONTRACT ADMINISTRATOR TO SUIT EXISTING DRIVEWAYS, APPROACHES, ETC.
- ALL LAND DRAINAGE SEWER EXCAVATION TO BE JETTED, FLOODED AND TAMPED AS PER CW2030-R7

CHAINAGE ALONG C OF PUBLIC LANE
EDGEWOOD STREET / LARIVIERE STREET

FOR CONTINUATION SEE
 DWG 141-24150-00-06

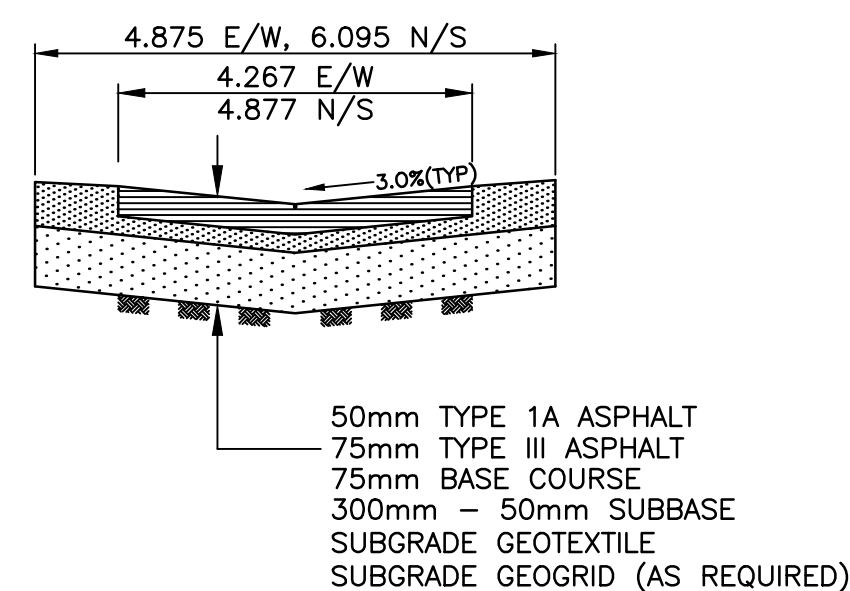

TYPICAL ALLEY CROSS SECTION
 N.T.S.

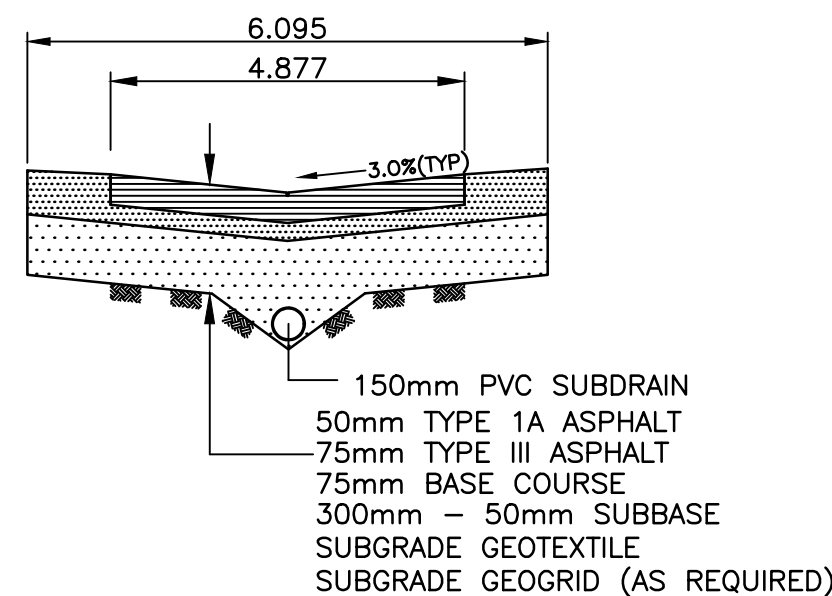

TYPICAL ALLEY CROSS SECTION WITH SUBDRAIN
 N.T.S.

*Description of property limits, and existing and/or proposed features relative to these limits as shown on this drawing do not represent a Legal Survey. WSP makes no representation or guarantee that the property limit information is accurate. WSP accepts no responsibility for damages, if any, suffered by any third party as a result of decisions made or actions based on this drawing.

TEST HOLE DATUM
 TH45 - N 5526883, E 635985
 TH46 - N 5526889, E 636043
 TH47 - N 5526902, E 636107

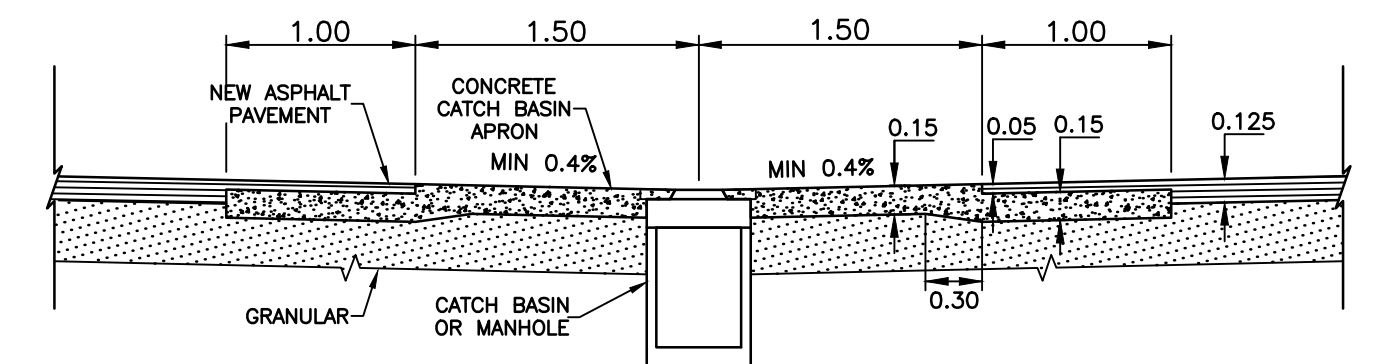
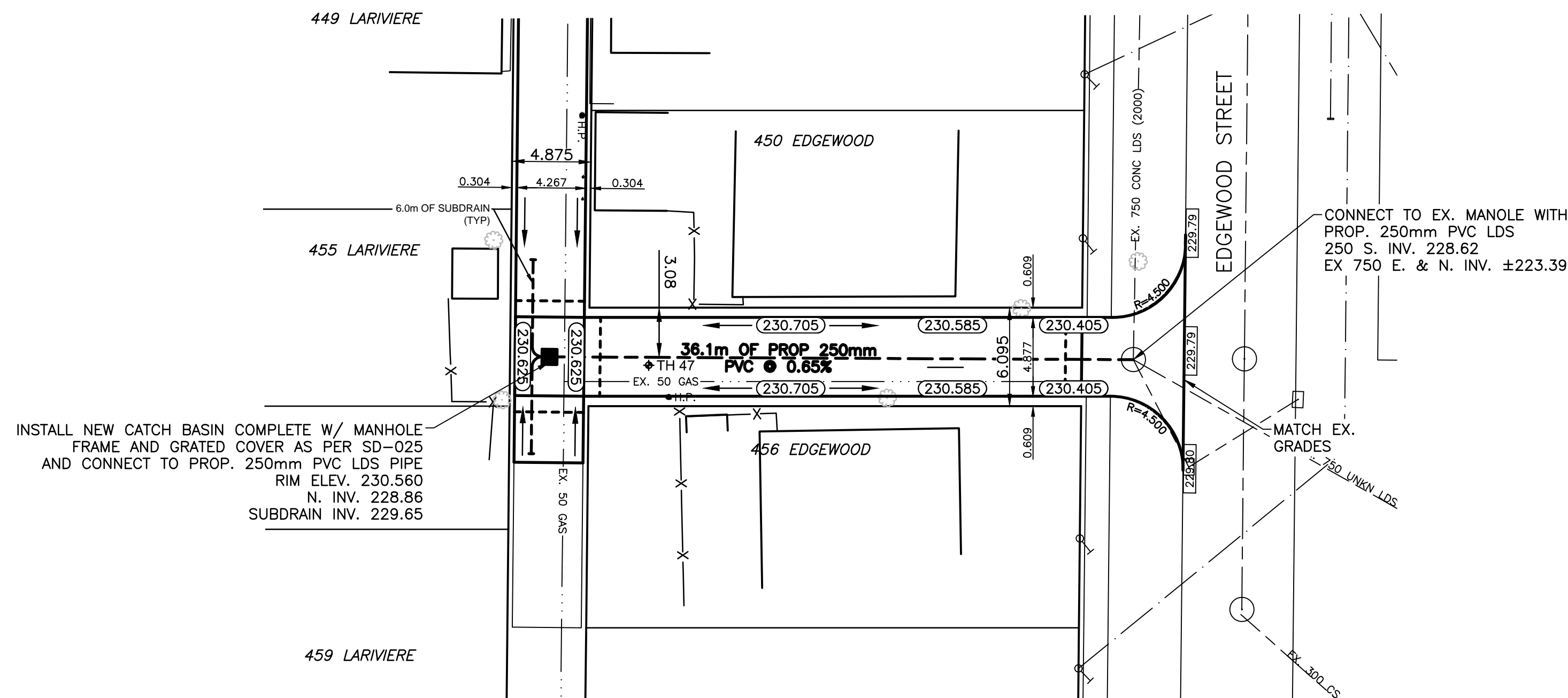

TYPICAL CATCHBASIN APRON DETAIL
 N.T.S.

EXISTING	LEGEND - PLAN	PROPOSED	EXISTING	LEGEND - PLAN	PROPOSED	EXISTING	LEGEND - PROFILE	PROPOSED
—	WATERMAIN	—	—	M.T.S.	—	—	WATERMAIN	—
⊕	HYDRANT	⊕	—	TRAFFIC SIGNAL	—	—	VALVE	—
⊗	VALVE	⊗	—	CONCRETE/ASPHALT	—	—	LAND DRAINAGE SEWER	—
—	CURB STOP	—	—	SIDEWALK	—	—	WASTE WATER SEWER	—
—	WASTE WATER SEWER	—	—	CURB RAMP	—	—	CENTERLINE	—
—	LAND DRAINAGE SEWER	—	—	PROPERTY LINE	—	—	SOUTH & EAST GUTTER	—
—	C.B. LEAD	—	—	ELEVATIONS	—	—	NORTH & WEST GUTTER	—
○	MANHOLE	○	—		—	—	TEST HOLE LOCATION	—
□	CATCH BASIN	□	—		—	—	S. & E. PAD/GARG.	—
—	GAS	—	—		—	—	N. & W. PAD/GARG.	—
—	HYDRO	—	—		—	—		—

LOCATION APPROVED
 UNDERGROUND STRUCTURES

SUPV. U/G STRUCTURES DATE COMMITTEE
 NOTE:
 LOCATION OF UNDERGROUND STRUCTURES AS SHOWN ARE BASED ON THE BEST INFORMATION AVAILABLE BUT NO GUARANTEE IS GIVEN THAT ALL EXISTING UTILITIES ARE SHOWN OR THAT THE GIVEN LOCATIONS ARE EXACT. CONFIRMATION OF EXISTENCE AND EXACT LOCATION OF ALL SERVICES MUST BE OBTAINED FROM THE INDIVIDUAL UTILITIES BEFORE PROCEEDING WITH CONSTRUCTION.

DESCRIPTION
 NORTH EAST CORNER RUE DES MEURONS AND DUBUC STREET, TABLET IN WEST CONCRETE FOUNDATION OF NO. 361 DUBUC STREET, 0.5M NORTH AND 0.5M BELOW CEDAR SIDING OF THE SOUTH WEST CORNER OF DWELLING.

NOTE:
 ROW WIDTH 4.875M E/W, 6.095M N/S
 NEW LANE DESIGN WIDTH 4.267 E/W, 4.877M N/S

DESIGNED BY	A.B.	CHECKED BY	S.M.
DRAWN BY	A.B.	APPROVED BY	I.McK.
HOR. SCALE:	1:250	RELEASED FOR CONSTRUCTION	---
VERT. SCALE:	1:25	DATE	---
DATE	MAY 2015		

CONSULTANT DRAWING NO.
 141-24150-00-07

METRIC
 WHOLE NUMBERS INDICATE MILLIMETRES
 DECIMALIZED NUMBERS INDICATE METRES

WSP
 1600 BUFFALO PLACE
 WINNIPEG, MB, R3T 6B8
 PHONE: 204-477-6650
 FAX: 204-474-2864
 WWW.WSPGROUP.COM

THE CITY OF WINNIPEG
 PUBLIC WORKS DEPARTMENT

2015 LOCAL IMPROVEMENTS - CONTRACT 1
 EDGEWOOD ST./ LARIVIERE ST. LANE

N. LIMIT OF THE E./W. ALLEY LEG TO THE S. GUTTER OF EDGEWOOD STREET ASPHALT PAVEMENT

CITY DRAWING NO.
 SHEET 2 OF 2
 426-2015

