

DETAIL 'B'
SCALE: N.T.S.

NOTE: CHAINAGES SHOWN ARE ALONG E. P/L OF LACY ST.

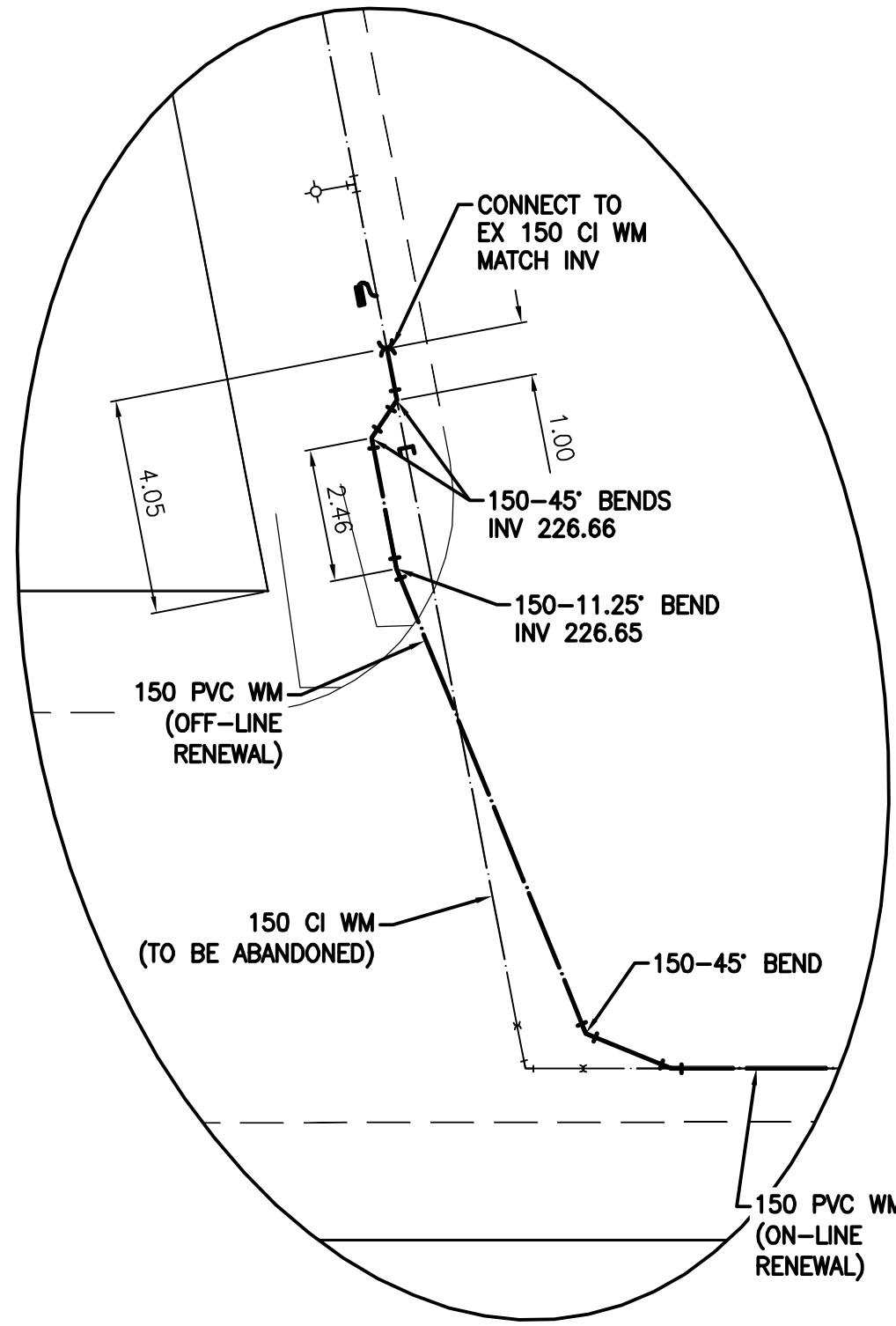

DETAIL 'A'
SCALE: N.T.S.

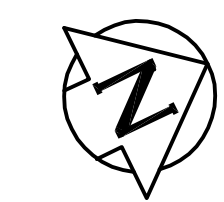
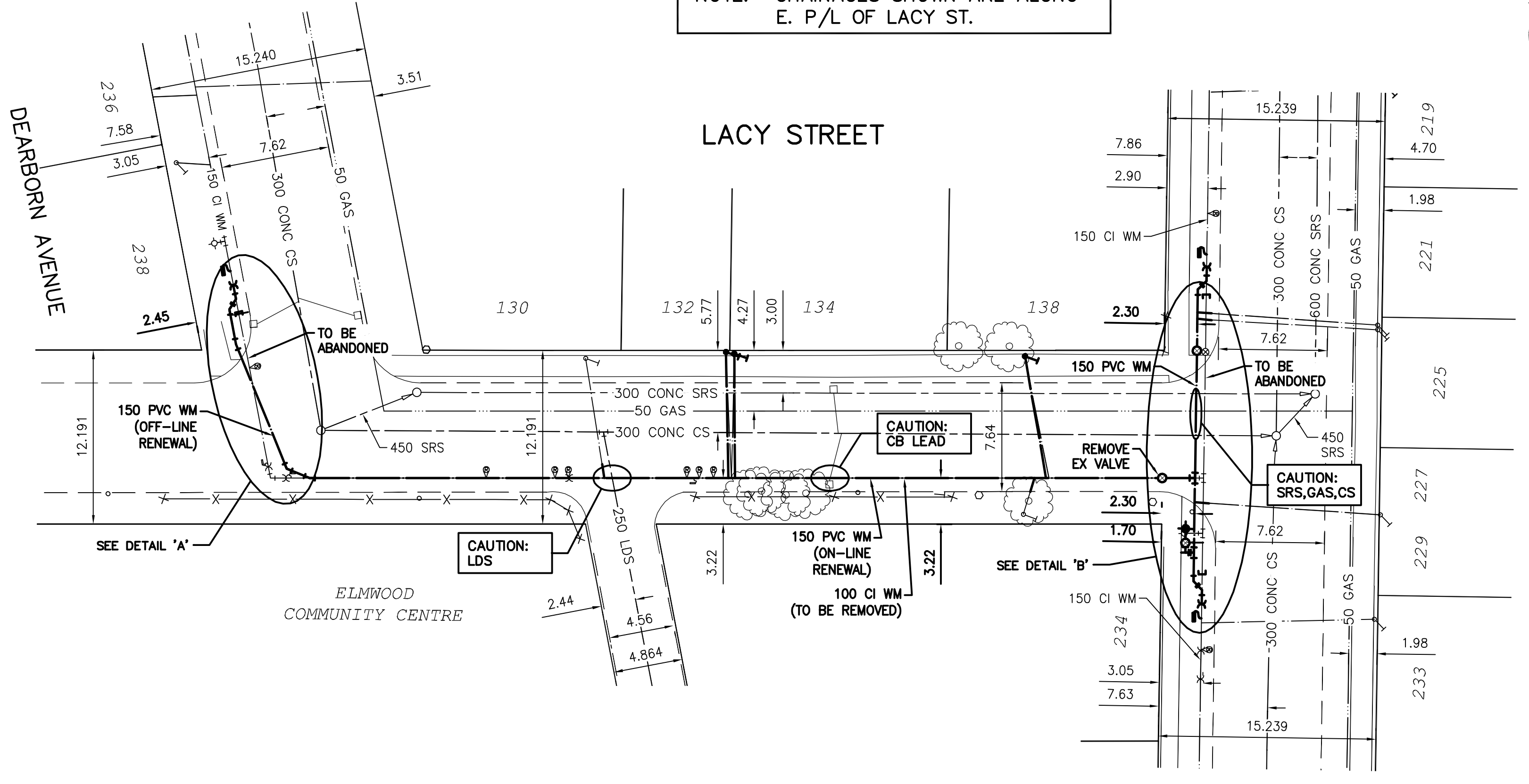

WATER SERVICE INFORMATION

ADDRESS	SIZE (mm) MATERIAL (STREET)	SIZE (mm) MATERIAL (PROP.)	SHORT & LONG MEASUREMENT	CORP. LOCATION	REMARKS
238 DEARBORN AV RESIDENTIAL	20 CU	12 LEAD	0.91 EWL HSE 13.41 WWL LACY	0.46 E OF S/C	-
128 LACY ST RESIDENTIAL	20 CU	20	5.18 WEL HSE 0.61 E S/C	0.61 E OF S/C	SERVICE OFF DEARBORN
130 LACY ST RESIDENTIAL	20 CU	12	1.22	OPP S/C	RECONNECT SERVICE
* 132 LACY ST RESIDENTIAL	12 LEAD	12	1.68 SSL HSE	OPP S/C	RENEW SERVICE
* 134 LACY ST RESIDENTIAL	12 LEAD	12	21.64>NNL DEARBORN	-	RENEW SERVICE
* 138 LACY ST RESIDENTIAL	12 LEAD	12	1.52 SNL HSE	OPP S/C	RENEW SERVICE
221 GORDON AV RESIDENTIAL	20 CU	12 LEAD	8.53 OUT FROM FRONT	0.61 W OF S/C	RECONNECT SERVICE
225 GORDON AV RESIDENTIAL	20 CU	12 LEAD	2.13 WWL OF LACY	0.91 W OF S/C	RECONNECT SERVICE
227 GORDON AV RESIDENTIAL	20 CU	20	2.13 WWL OF LACY	0.91 W OF S/C	RECONNECT SERVICE
229 GORDON AV RESIDENTIAL	20 CU	20	1.52 SNL HSE	0.61 S OF S/C	RECONNECT SERVICE
234 GORDON AV RESIDENTIAL	20 CU	20	9.14 SSL GORDON	-	RECONNECT SERVICE

* SERVICES TO BE RENEWED TO R, ALL OTHERS TO BE RECONNECTED

NOTE: ALL GATE VALVES TO BE INSTALLED CLOCKWISE TO CLOSE

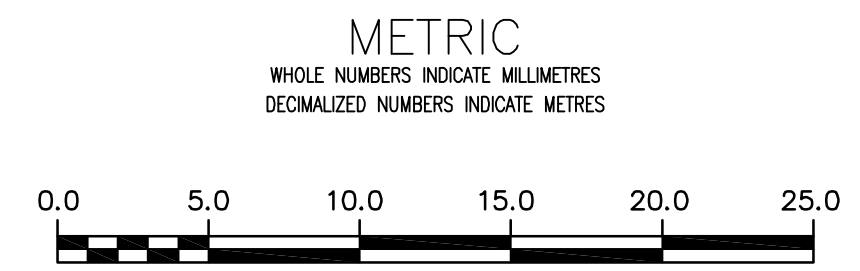

WARNING
IF POWER EQUIPMENT OR EXPLOSIVES ARE TO BE USED FOR EXCAVATION ON THIS PROJECT THE CONTRACTOR MUST:
1) NOTIFY THE GAS COMPANY OF THE PROPOSED LOCATION OF EXCAVATION.
2) TAKE PRECAUTION TO AVOID DAMAGE TO GAS COMPANY INSTALLATIONS.
SEE PROVINCIAL REGULATION 2107/2 FOR DETAILS

LOCATION APPROVED
UNDERGROUND STRUCTURES
SUPV. U/G STRUCTURES COMMITTEE DATE
NOTE:
LOCATION OF UNDERGROUND STRUCTURES AS SHOWN ARE BASED ON THE BEST INFORMATION AVAILABLE BUT NO GUARANTEE IS GIVEN THAT ALL EXISTING UTILITIES ARE SHOWN OR THAT THE GIVEN LOCATIONS ARE EXACT. CONFIRMATION OF EXISTENCE AND EXACT LOCATION OF ALL SERVICES MUST BE OBTAINED FROM THE INDIVIDUAL UTILITIES BEFORE PROCEEDING WITH CONSTRUCTION.

B.M. 27-032 85R646 - N.W. Cor. Poplar Ave. & Roeh St. Tbt. on top of 0.05 m dia. x 2.4 m iron pipe, 2.8 m S. of N. ELEV. 230.868m
L. of Poplar Ave. & on W.L. of Roeh St.

CONSTRUCTION COMPLETION DATE: YYYY MM DD

NO.	ISSUED FOR TENDER	REVISIONS	DATE	BY
0	ISSUED FOR TENDER		15/03/24	R.S.

DESIGNED BY: J.H. CHECKED BY: R.S.
DRAWN BY: J.H. APPROVED BY: R.S.
SCALE: HORIZONTAL 1:250 VERTICAL 1:50
DATE: 2015 03 24

ENGINEER'S SEAL
CONSULTANT DRAWING NUMBER: C-215

THE CITY OF WINNIPEG
WATER AND WASTE DEPARTMENT
ENGINEERING DIVISION
2015 WATERMAIN RENEWALS
CONTRACT 1
LACY STREET
DEARBORN AVENUE TO
GORDON AVENUE
SHEET 16 OF 18
CITY DRAWING NUMBER: D-13930