

Owner

| No. | Date | Revision Notes |
|-----|------------|-------------------------|
| 1. | 2015.05.08 | Issued for Construction |
| 2. | 2015.06.18 | Issued for Addendum 3 |

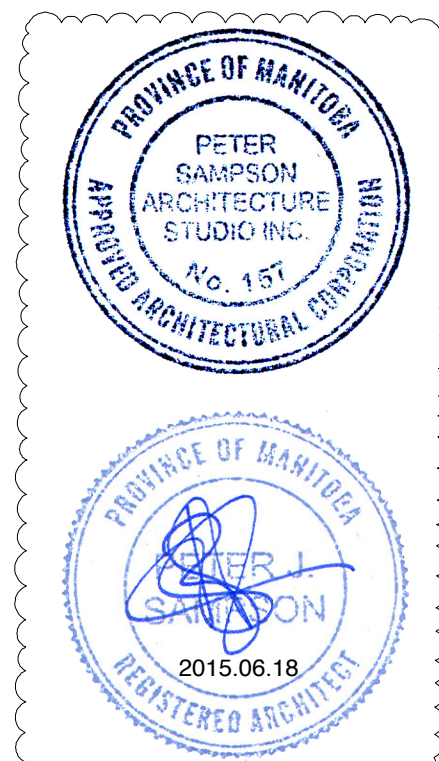

This drawing must not be scaled. The contractors shall verify all dimensions and other data on site prior to commencement of work. Discrepancies, errors, and omissions are to be reported to the Architect prior to proceeding with the Work.

Drawings and specifications as instruments of service are the property of the Architect; the copyright in the same being reserved to him.

No reproduction or revision to these drawings may be made without the permission of the Architect and when made, must bear his name. All prints to be returned to the Architect upon request.

Project
St. Vital Park Washrooms

Drawing
Building Sections and Wall Sections

| | |
|-------------------|----------------------------|
| Drawn By MP | Reviewed By PS |
| Scale As Noted | Drawing No. A-06 |

| | | |
|--------------|---------------------|-------------------|
| Date 2015 | Project No. 1445 | Revision No. 0 |
|--------------|---------------------|-------------------|

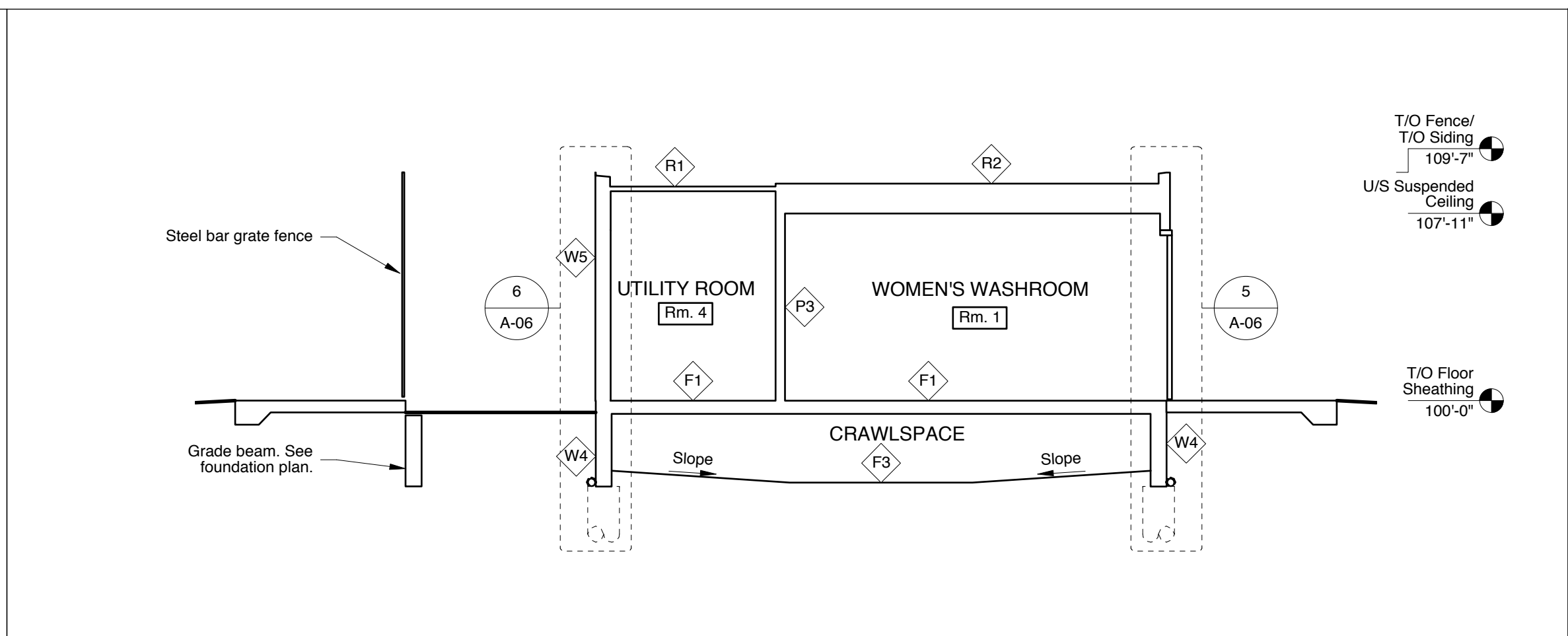
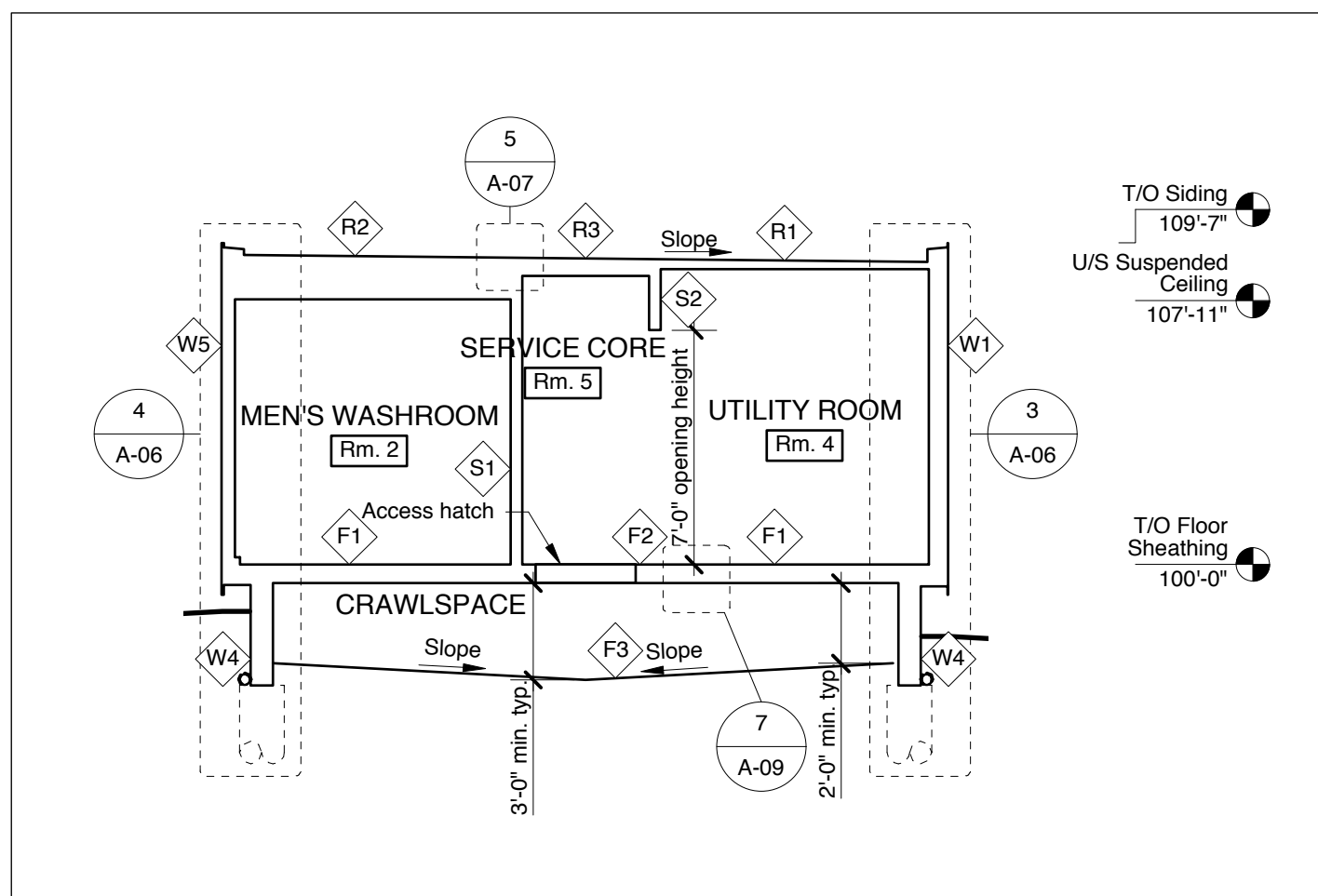

2 Transverse Section
 3/16"=1'-0"

1 Longitudinal Section
 3/16"=1'-0"

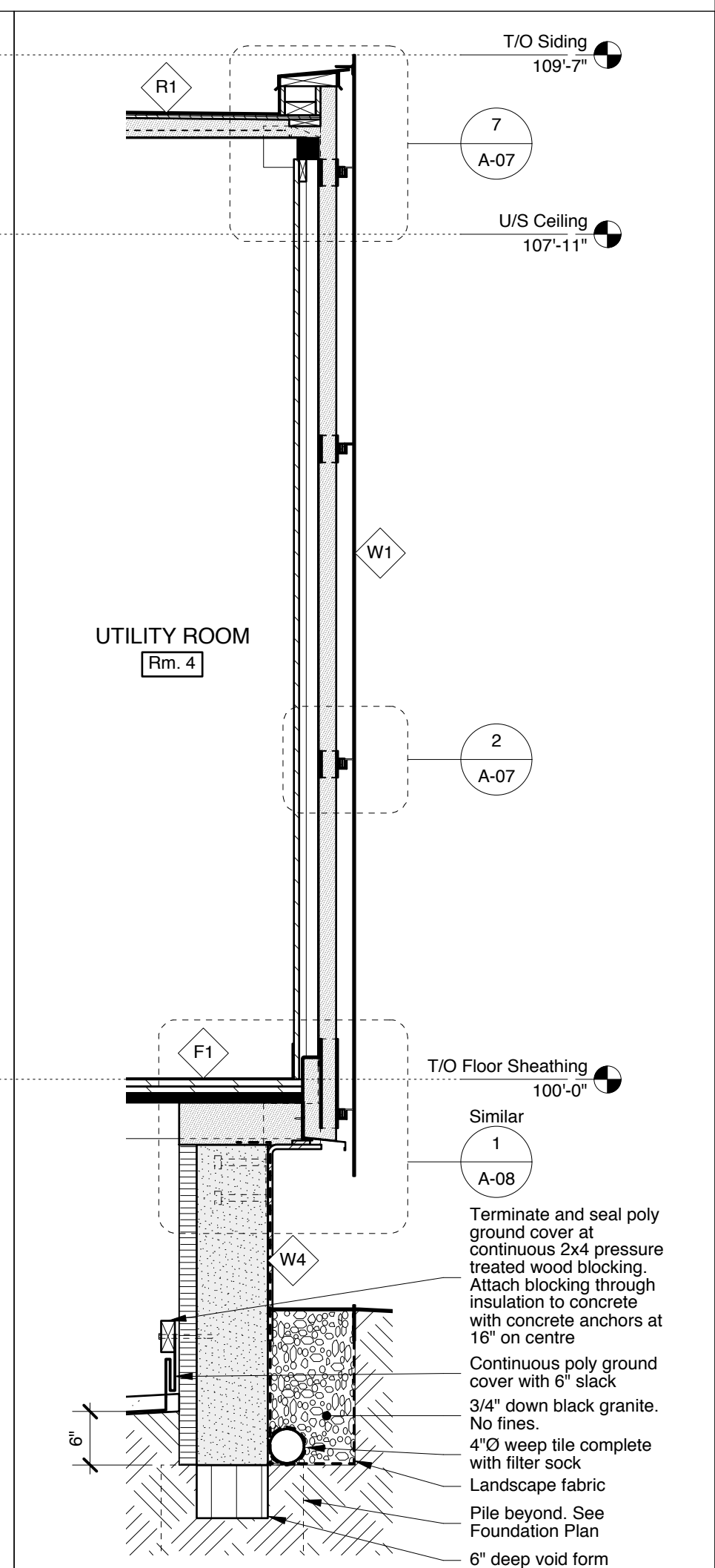
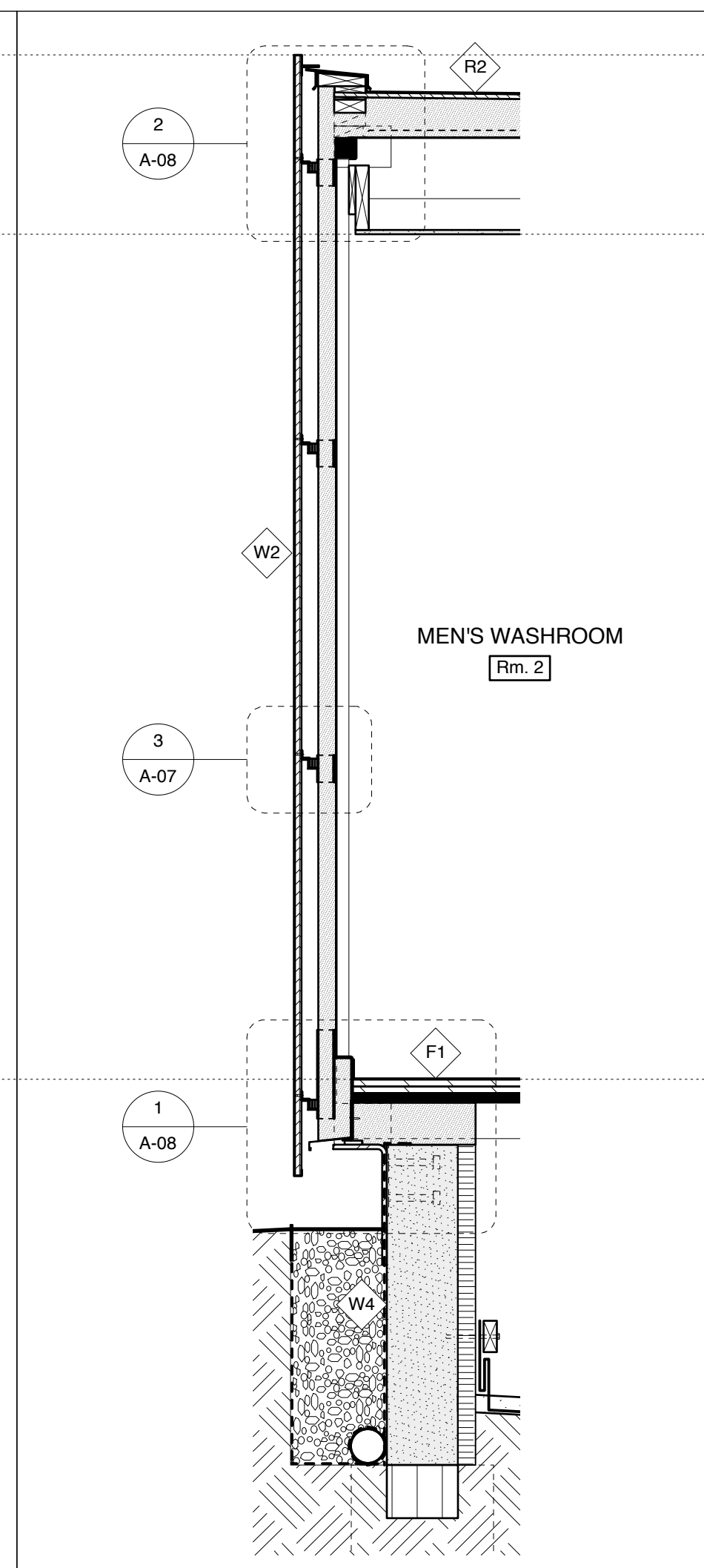
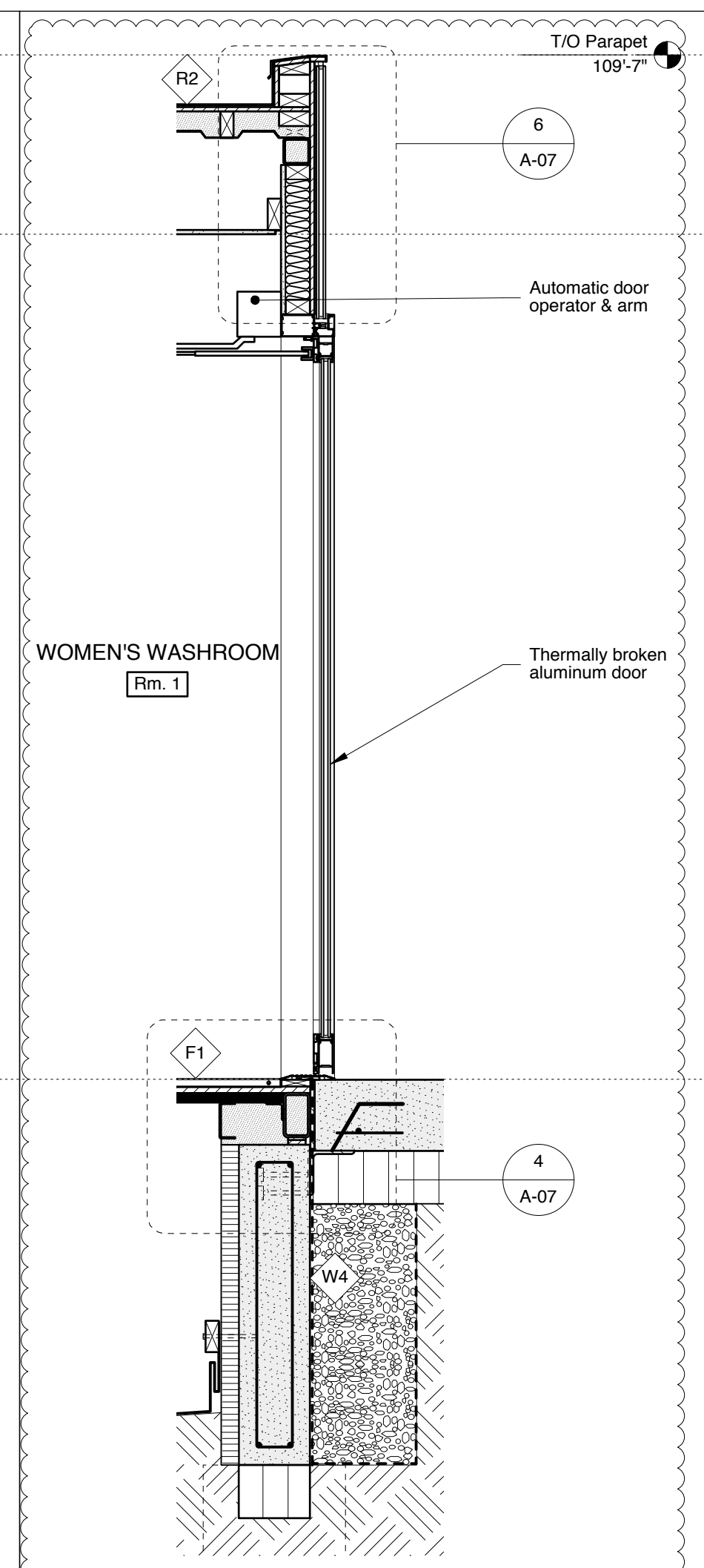
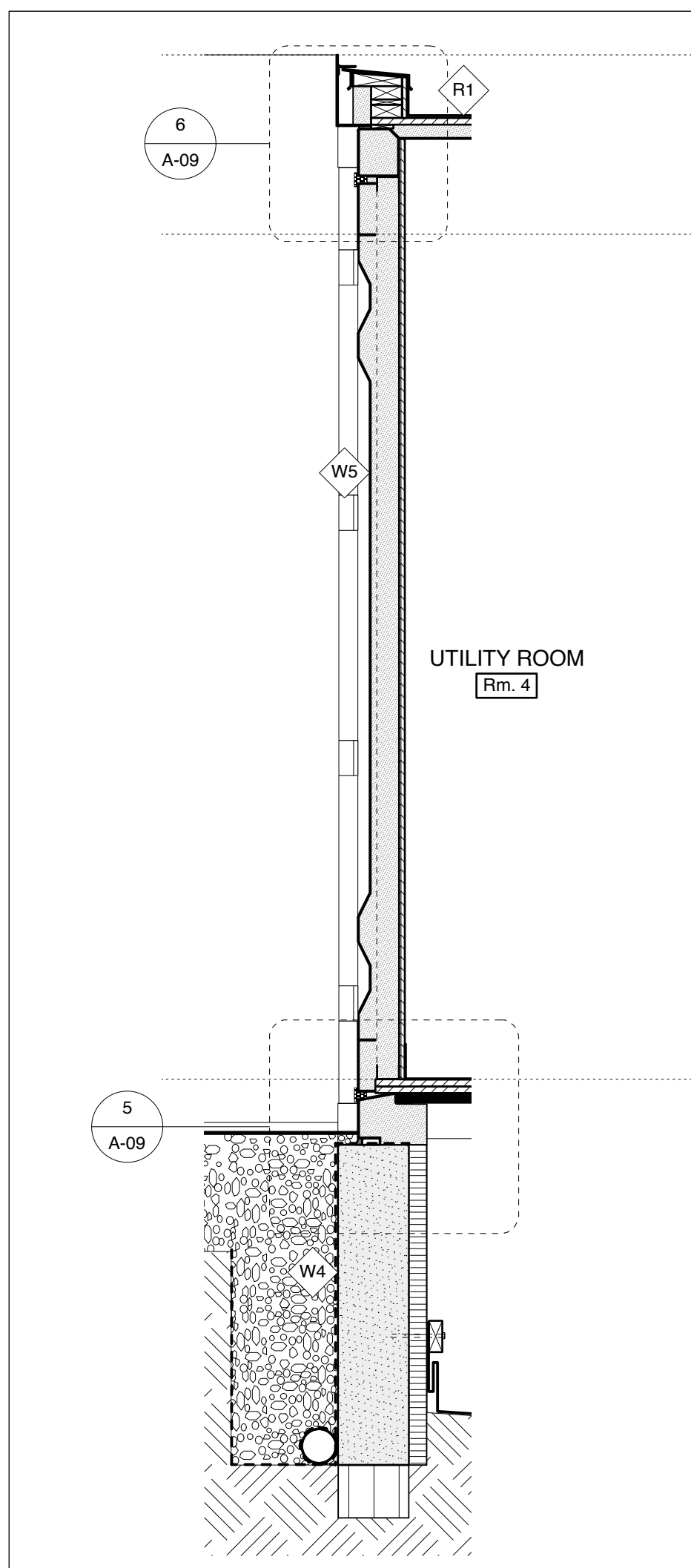

6 Wall Section Through Fixed Container Door
 3/4"=1'-0"

5 Wall Section Through Re-Constructed Container End
 3/4"=1'-0"

4 Wall Section Through Polished Steel Siding
 3/4"=1'-0"

3 Wall Section Through Corten Siding
 3/4"=1'-0"