

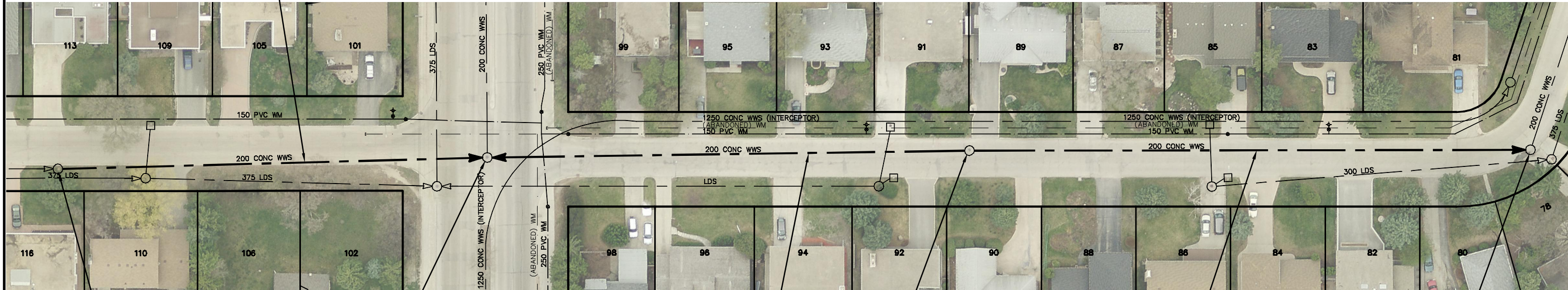

THATCHER DRIVE

82.80 OF 200 CONC WWS
TO BE LINED S-MA60016099
(PARTIALLY DETERIORATED)



S-MH60013857
RIM 232.33
INV E 228.78
INV W 228.80

S-MH60013859
RIM 232.72
INV E 228.44
INV W 228.50
INV N 228.47

93.20 OF 200 CONC CS
TO BE LINED S-MA60016101
(PARTIALLY DETERIORATED)

S-MH60013892
RIM 231.89
INV E 229.49
INV W 229.51

109.10 OF 200 CONC WWS
TO BE LINED S-MA60016140
(FULLY DETERIORATED)

S-MH60013910
RIM 231.97
INV W 228.97
INV N 229.07

SEWER JUNCTION INFORMATION FROM SEWER VIDEO INSPECTION SEWER ID S-MA60016099		
DISTANCE FROM MH ID S-MH60013857		
DISTANCE	DIAMETER	CLOCK
1.4	100	10
1.5	100	9
14.8	100	3
15.0	100	11
37.0	100	11
57.0	100	11

SEWER JUNCTION INFORMATION FROM SEWER VIDEO INSPECTION SEWER ID S-MA60016101		
DISTANCE FROM MH ID S-MH60013892		
DISTANCE	DIAMETER	CLOCK
2.7	100	1
12.5	100	10
18.0	100	2
32.1	100	10
32.5	100	2
51.4	100	11
51.8	100	2
67.5	100	10
67.9	100	2

SEWER JUNCTION INFORMATION FROM SEWER VIDEO INSPECTION SEWER ID S-MA60016140		
DISTANCE FROM MH ID S-MH60013892		
DISTANCE	DIAMETER	CLOCK
5.0	100	1
16.6	100	10
19.8	100	1
21.6	100	1
34.0	100	11
40.9	100	1
50.9	100	10
64.7	100	2
67.9	100	10
78.6	100	2
87.5	100	10
93.5	150	2

WARNING

IF POWER EQUIPMENT OR EXPLOSIVES ARE TO BE USED FOR EXCAVATION ON THIS PROJECT THE CONTRACTOR MUST:

- 1) NOTIFY THE GAS COMPANY OF THE PROPOSED LOCATION OF EXCAVATION.
- 2) TAKE PRECAUTION TO AVOID DAMAGE TO GAS COMPANY INSTALLATIONS.

SEE PROVINCIAL REGULATION 210/72 FOR DETAILS

METRIC
WHOLE NUMBERS INDICATE MILLIMETRES
DECIMALIZED NUMBERS INDICATE METRES



LOCATION APPROVED
UNDERGROUND STRUCTURES

SUPV. U/G STRUCTURES COMMITTEE DATE

NOTE:

LOCATION OF UNDERGROUND STRUCTURES AS SHOWN ARE BASED ON THE BEST INFORMATION AVAILABLE BUT NO GUARANTEE IS GIVEN THAT ALL EXISTING UTILITIES ARE SHOWN OR THAT THE GIVEN LOCATIONS ARE EXACT. CONFIRMATION OF EXISTENCE AND EXACT LOCATION OF ALL SERVICES MUST BE OBTAINED FROM THE INDIVIDUAL UTILITIES BEFORE PROCEEDING WITH CONSTRUCTION.

B.M. ELEV.	
CONSTRUCTION COMPLETION DATE: YYYY MM DD	
NO.	REVISIONS
	DATE
	BY

DESIGNED BY	SC	CHECKED BY	SC
DRAWN BY	MA	APPROVED BY	KZ
SCALE:		RELEASED FOR CONSTRUCTION	
HORIZONTAL	1:750		
VERTICAL			
DATE	2014 10 08	DATE	

ENGINEER'S SEAL

ORIGINAL SIGNED BY
S.R.J. COURNOYER
14-10-07

CONSULTANT DRAWING NUMBER

BID OPPORTUNITY: 946-2014
CONTRACT NUMBER: 12



THE CITY OF WINNIPEG
WATER AND WASTE DEPARTMENT
ENGINEERING DIVISION

2014 SEWER RENEWALS
BY CIPP LINING - CONTRACT 12

THATCHER DRIVE
1ST MH SW OF UNIVERSITY CRESCENT TO
MH @ THATCHER DRIVE (ELEG)

SHEET 59 OF 66

CITY DRAWING NUMBER

10870

FILE PATH: R:\DRAWINGS\SEWER\2014 RENEWALS\CIPP'S\CONTRACT 12\Drawings\
FILE NAME: 10870.dwg