

GENTHON STREET

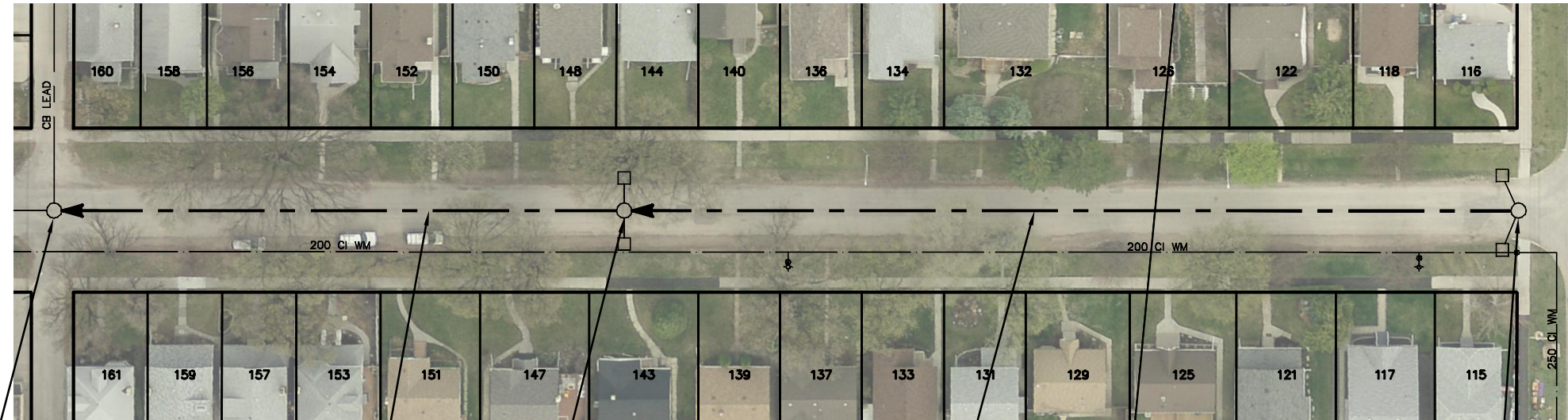

S-MH50003665
RIM 231.24
INV N 226.25

71.20 OF 450 CONC CS
TO BE LINED S-MA50004208
(PARTIALLY DETERIORATED)

S-MH50003664
RIM 231.14
INV S 227.23
INV N 227.23

109.30 OF 300 CONC CS
TO BE LINED S-MA50004207
(PARTIALLY DETERIORATED)

S-MH50003663
RIM 230.87
INV N 227.85

NIVERVILLE AV

SEWER JUNCTION INFORMATION FROM SEWER VIDEO INSPECTION SEWER ID S-MA50004208		
DISTANCE FROM MH ID S-MH50003664		
DISTANCE	DIAMETER	CLOCK
3.9	150	3
13.3	150	11
17.8	150	1
21.6	150	10
30.6	150	1
35.3	150	11
42.3	150	1
46.8	150	1
50.1	150	11
55.7	150	10
57.9	150	2
65.4	150	1
67.6	150	9

SEWER JUNCTION INFORMATION FROM SEWER VIDEO INSPECTION SEWER ID S-MA50004207		
DISTANCE FROM MH ID S-MH50003663		
DISTANCE	DIAMETER	CLOCK
9.0	150	2
11.8	150	10
18.5	150	11
19.5	150	1
34.3	150	10
35.6	150	1
46.4	150	11
51.2	150	1
59.5	150	2
60.8	150	11
66.6	150	11
78.2	150	2
78.9	150	11
87.5	150	11
88.5	150	1
89.7	150	11
92.6	150	10
101.1	150	1
105.4	150	10
106.4	150	1

WARNING

IF POWER EQUIPMENT OR EXPLOSIVES
ARE TO BE USED FOR EXCAVATION ON
THIS PROJECT THE CONTRACTOR MUST:

- 1) NOTIFY THE GAS COMPANY OF THE PROPOSED LOCATION OF EXCAVATION.
- 2) TAKE PRECAUTION TO AVOID DAMAGE TO GAS COMPANY INSTALLATIONS.

SEE PROVINCIAL REGULATION 210/72 FOR DETAILS

METRIC
WHOLE NUMBERS INDICATE MILLIMETRES
DECIMALIZED NUMBERS INDICATE METRES

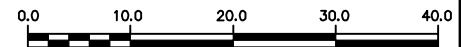

LOCATION APPROVED
UNDERGROUND STRUCTURES

SUPV. U/G STRUCTURES COMMITTEE DATE

NOTE:

LOCATION OF UNDERGROUND STRUCTURES AS SHOWN ARE BASED ON THE BEST INFORMATION AVAILABLE BUT NO GUARANTEE IS GIVEN THAT ALL EXISTING UTILITIES ARE SHOWN OR THAT THE GIVEN LOCATIONS ARE EXACT. CONFIRMATION OF EXISTENCE AND EXACT LOCATION OF ALL SERVICES MUST BE OBTAINED FROM THE INDIVIDUAL UTILITIES BEFORE PROCEEDING WITH CONSTRUCTION.

B.M. ELEV.	
CONSTRUCTION COMPLETION DATE: YYYY MM DD	
NO.	REVISIONS

DESIGNED BY	SC	CHECKED BY	SC
DRAWN BY	MA	APPROVED BY	KZ
SCALE:		RELEASED FOR CONSTRUCTION	
HORIZONTAL	1:750		
VERTICAL			
DATE	2014 10 08	DATE	
PLOT DATE:	2014 10 08		

ENGINEER'S SEAL

ORIGINAL SIGNED BY
S.R.J. COURNOYER
14-10-07

CONSULTANT DRAWING NUMBER



THE CITY OF WINNIPEG
WATER AND WASTE DEPARTMENT
ENGINEERING DIVISION

2014 SEWER RENEWALS
BY CIPP LINING - CONTRACT 12
GENTHON STREET
MH AT NIVERVILLE AVENUE (N PL) TO
2ND MH N OF NIVERVILLE AVENUE

SHEET **24** OF **66**
CITY DRAWING NUMBER
10835