

TYPICAL CROSS SECTION

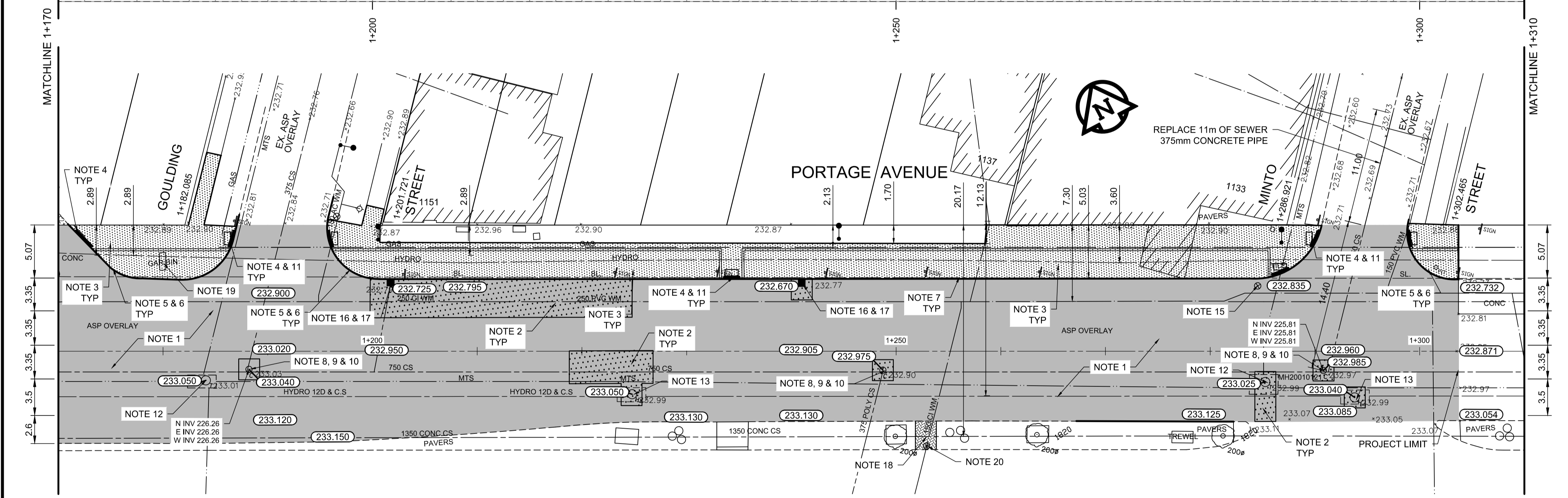

REFERENCE NOTES

- A. PAVEMENT DIMENSIONS ARE TO BACK OF CURB
- B. BASELINE IS 12.0M SOUTH OF NORTH GUTTER
- C. PROPERTY LINES OBTAINED FROM THE CITY OF WINNIPEG L.B.I.S., AND NO SCALE FACTOR WAS APPLIED
- D. REFER TO AECOM FIELD BOOK NO. 4821, 4822 & 4823

CONSTRUCTION NOTES:

1. PLANE EXISTING ASPHALT AND CONSTRUCT NEW ASPHALTIC CONCRETE OVERLAY (AVERAGE THICKNESS 85mm)
2. REMOVE EXISTING PAVEMENT AND CONSTRUCT NEW 200mm REINFORCED CONCRETE SIDEWALK
3. REMOVE EXISTING CONCRETE SIDEWALK AND CONSTRUCT NEW 100mm SIDEWALK c/w PAVING STONE BAND (SEE DETAIL 1)
4. RENEW EXISTING MONOLITHIC CURB RAMP (150mm HT. INTEGRAL)
5. CONSTRUCT NEW MODIFIED BARRIER CURB (150mm AVG. HT. SEPARATE)
6. REMOVE EXISTING BARRIER CURB
7. RENEW BARRIER CURBS (100mm AVG. HT. REVEAL)
8. ADJUST EXISTING CATCH BASIN/MANHOLE TO GRADE
9. REMOVE EXISTING FRAME AND COVER AND PLACE NEW FRAME AND COVER (AP-004 AND AP-005)
10. INSTALL NEW CAST IRON RISER RING
11. INSTALL NEW DETECTABLE SURFACE WARNING TILES
12. REBUILD MTS MANHOLE (BY MTS)
13. ADJUST EXISTING HYDRO MANHOLE (BY OTHERS)
14. ADJUST EXISTING CURB STOP TO GRADE
15. INSTALL NEW VALVE BOX EXTENSION
16. REMOVE EXISTING CATCHBASIN AND CURB INLET
17. INSTALL NEW CURB AND GUTTER INLET c/w CATCHBASIN (SD-024 - 1800mm) AND CONNECT TO EXISTING LEAD
18. REGRADE EXISTING PAVING STONES
19. REMOVE AND REPLACE EXISTING GARBAGE BIN (BY OTHERS)
20. ADJUST VALVE BOX

150 mm W.M.	WATERMAIN	150 mm W.M.	HYDRO	PROPERTY LINE	EXISTING	LEGEND - PROFILE	PROPOSED
300mm L.D.S.	LAND DRAINAGE SEWER	300mm L.D.S.	M.T.S.	SURVEY BAR	EXISTING	LEGEND - PROFILE	PROPOSED
250mm W.W.S.	WASTEWATER SEWER	250mm W.W.S.	CONCRETE	ELEVATION (35.750)	EXISTING	LEGEND - PROFILE	PROPOSED
	MANHOLE		ASPHALT	TREE	EXISTING	LEGEND - PROFILE	PROPOSED
	CATCH BASIN		PROPERTY LINE	SIDEWALK RAMP	EXISTING	LEGEND - PROFILE	PROPOSED
	CURB INLET		CONCRETE	CONCRETE SIDEWALK	EXISTING	LEGEND - PROFILE	PROPOSED
	JUNCTIONS		PROPERTY LINE	FENCE	EXISTING	LEGEND - PROFILE	PROPOSED
	CULVERT		CONCRETE	CONCRETE SIDEWALK	EXISTING	LEGEND - PROFILE	PROPOSED
	GAS		PROPERTY LINE	FENCE	EXISTING	LEGEND - PROFILE	PROPOSED

LOCATION APPROVED UNDERGROUND STRUCTURES	DATE
SUPV. U/G STRUCTURES COMMITTEE	
NOTE:	
LOCATION OF UNDERGROUND STRUCTURES AS SHOWN ARE BASED ON THE BEST INFORMATION AVAILABLE. BUT NO GUARANTEE IS GIVEN THAT ALL EXISTING UTILITIES ARE SHOWN OR THAT THE GIVEN LOCATIONS ARE EXACT. CONFIRMATION OF EXISTENCE AND EXACT LOCATION OF ALL SERVICES MUST BE OBTAINED FROM THE INDIVIDUAL UTILITIES BEFORE PROCEEDING WITH CONSTRUCTION.	

B.M. 89R581	S.W. corner Portage Ave. & Sprague St., Tbt. on pipe, 4.8m E. of W.L. Sprague St. produced from the W. along the S.L. of Portage Ave.		
ELEV. 232.540			
NO.	REVISIONS	DATE	BY
0	ISSUED FOR TENDER	2014/06/26	KWR

AECOM

DESIGNED BY	BC	CHECKED BY	KWR
DRAWN BY	RT, PB	APPROVED BY	
HOR. SCALE:	1:250	RELEASED FOR CONSTRUCTION BY:	
VERTICAL:	1:10		

ENGINEER'S SEAL

PROVINCE OF MANITOBA

ORIGINAL SIGNED BY

K.W. RAE

REGISTERED PROFESSIONAL ENGINEER

06/26/2014

CONSULTANT DRAWING NO. CT-21

METRIC

WHOLE NUMBERS INDICATE MILLIMETRES

DECIMALIZED NUMBERS INDICATE METRES

THE CITY OF WINNIPEG

Winnipeg PUBLIC WORKS DEPARTMENT

ENGINEERING DIVISION

PORTAGE AVENUE REHABILITATION:

PART A- EASTBOUND FROM SHERBURN ST. TO MARYLAND ST.

PART B- WESTBOUND FROM EMPRESS ST. TO MINTO ST.

PLAN / PROFILE PART B

STATION 1+170 STATION 1+304

CITY DRAWING NUMBER P-3356-10

SHEET 21 OF 21