

- REFERENCE NOTES**
- PAVEMENT DIMENSIONS ARE TO BACK OF CURB
  - BASELINE IS 12.0M SOUTH OF NORTH GUTTER
  - PROPERTY LINES OBTAINED FROM THE CITY OF WINNIPEG L.B.I.S., AND NO SCALE FACTOR WAS APPLIED
  - REFER TO AECOM FIELD BOOK NO. 4821, 4822 & 4823

- CONSTRUCTION NOTES:**
- PLANE EXISTING ASPHALT AND CONSTRUCT NEW ASPHALTIC PAVEMENT OVERLAY TYPE 1A (AVERAGE THICKNESS 85mm)
  - REMOVE EXISTING PAVEMENT AND CONSTRUCT NEW 200mm REINFORCED CONCRETE PAVEMENT c/w 85mm TYPE 1A ASPHALT OVERLAY
  - REMOVE EXISTING CONCRETE SIDEWALK AND CONSTRUCT NEW 100mm SIDEWALK c/w PAVING STONE BAND (SEE DETAIL 1)
  - RENEW EXISTING MONOLITHIC CURB RAMP (10mm HT. INTEGRAL)
  - CONSTRUCT NEW MODIFIED BARRIER CURB (150mm AVG. HT. REVEAL SEPARATE)
  - REMOVE EXISTING BARRIER CURB
  - RENEW EXISTING BARRIER CURB (100mm AVG. HT. REVEAL)
  - ADJUST EXISTING CATCH BASIN/MANHOLE TO GRADE
  - REMOVE EXISTING FRAME AND COVER AND PLACE NEW FRAME AND COVER (AP-004 AND AP-005)
  - INSTALL NEW CAST IRON RISER RING
  - INSTALL NEW DETECTABLE SURFACE WARNING TILES
  - REBUILD MTS MANHOLE (BY OTHERS)
  - ADJUST EXISTING HYDRO MANHOLE (BY OTHERS)
  - ADJUST EXISTING CURB STOP TO GRADE
  - INSTALL VALVE BOX EXTENSION
  - REMOVE EXISTING CATCHBASIN AND CURB INLET
  - INSTALL NEW CURB AND GUTTER INLET c/w CATCHBASIN (SD-024 - 1800mm) AND CONNECT TO EXISTING LEAD
  - REGRADE EXISTING PAVING STONES
  - REMOVE EXISTING TREE WELL
  - REMOVE AND RE-INSTALL EXISTING BENCH (BY OTHERS)
  - REMOVE AND RE-INSTALL EXISTING GARBAGE BIN (BY OTHERS)
  - REMOVE AND RE-INSTALL EXISTING BUS SHELTER (BY OTHERS)
  - INSTALL PAVING STONE (SEE DETAIL 2)
  - REMOVE AND REPLACE TRANSIT INFORMATION POST BASE (BY OTHERS)
  - REMOVE AND REPLACE SPECIALTY TRANSIT STOP SIGN POST (BY OTHERS)
  - REMOVE AND REPLACE CANADA POST BOX (BY OTHERS)

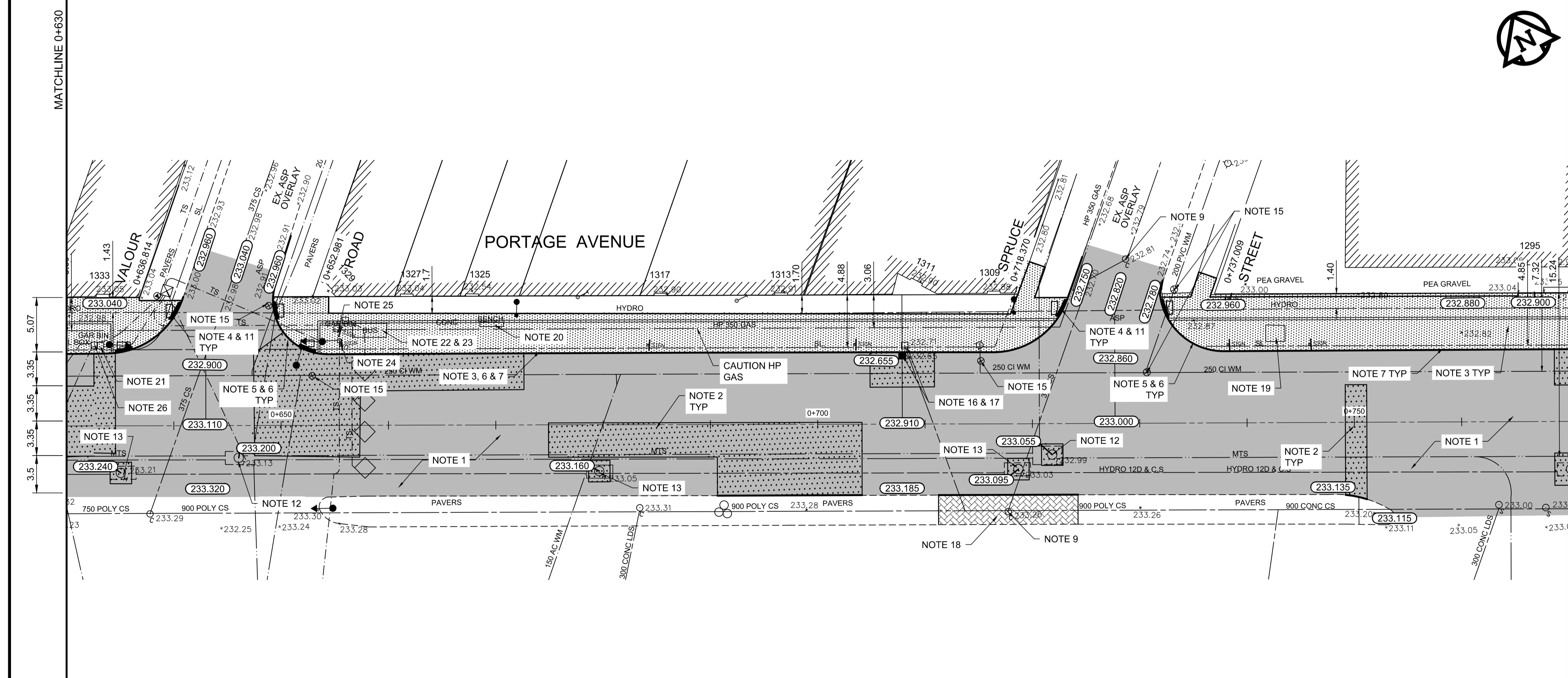

150 mm W.M.		300mm L.D.S.		250mm W.W.S.		HYDRO		PROPERTY LINE		SURVEY BAR		ELEVATION		TREE		SIDEWALK RAMP		CONCRETE SIDEWALK		FENCE		
WATERMAIN	HYDRANT	VALVE	LAND DRAINAGE SEWER	WASTEWATER SEWER	MANHOLE	CATCH BASIN	CURB INLET	JUNCTIONS	CULVERT	GAS	EXISTING	PROPOSED	EXISTING	PROPOSED	EXISTING	PROPOSED	EXISTING	PROPOSED	EXISTING	PROPOSED	EXISTING	PROPOSED

**LOCATION APPROVED UNDERGROUND STRUCTURES**

SUPV. / U/G STRUCTURES COMMITTEE DATE

**NOTE:**  
LOCATION OF UNDERGROUND STRUCTURES AS SHOWN ARE BASED ON THE BEST INFORMATION AVAILABLE. BUT NO GUARANTEE IS GIVEN THAT ALL EXISTING UTILITIES ARE SHOWN OR THAT THE GIVEN LOCATIONS ARE EXACT. CONFIRMATION OF EXISTENCE AND EXACT LOCATION OF ALL SERVICES MUST BE OBTAINED FROM THE INDIVIDUAL UTILITIES BEFORE PROCEEDING WITH CONSTRUCTION.

NO.	REVISIONS	DATE	BY
0	ISSUED FOR TENDER	2014/06/26	KWR

**AECOM**

DESIGNED BY: BC  
DRAWN BY: RT, PB  
HOR. SCALE: 1:250  
VERTICAL: 1:10

CHECKED BY: KWR  
APPROVED BY:  
RELEASED FOR CONSTRUCTION BY:

ISSUED FOR TENDER: 2014/06/26  
NO. REVISIONS: 0

ENGINEER'S SEAL

PROVINCE OF MANITOBA  
ORIGINAL SIGNED BY  
**K.W. RAE**  
REGISTERED PROFESSIONAL ENGINEER  
06/26/2014

CONSULTANT DRAWING NO. CT-17

**METRIC**  
WHOLE NUMBERS INDICATE MILLIMETRES  
DECIMALIZED NUMBERS INDICATE METRES

**THE CITY OF WINNIPEG**  
PUBLIC WORKS DEPARTMENT  
ENGINEERING DIVISION

PORTAGE AVENUE REHABILITATION:  
PART A- EASTBOUND FROM SHERBURN ST. TO MARYLAND ST.  
PART B- WESTBOUND FROM EMPRESS ST. TO MINTO ST.

PLAN / PROFILE PART B  
STATION 0+630 TO STATION 0+770

CITY DRAWING NUMBER P-3356-06  
SHEET 17 OF 21