

- REFERENCE NOTES**
- A. PAVEMENT DIMENSIONS ARE TO BACK OF CURB
 - B. BASELINE IS 12.0M NORTH OF SOUTH PROPERTY LINE
 - C. PROPERTY LINES OBTAINED FROM THE CITY OF WINNIPEG L.B.I.S., AND NO SCALE FACTOR WAS APPLIED
 - D. REFER TO AECOM FIELD BOOK NO. 4821, 4822 & 4823
- CONSTRUCTION NOTES:**
1. PLANE EXISTING ASPHALT AND CONSTRUCT NEW ASPHALTIC PAVEMENT OVERLAY TYPE 1A (AVERAGE THICKNESS 85mm)
 2. REMOVE EXISTING PAVEMENT AND CONSTRUCT NEW 200mm REINFORCED CONCRETE PAVEMENT c/w 85mm TYPE 1A ASPHALT OVERLAY
 3. REMOVE EXISTING CONCRETE SIDEWALK AND CONSTRUCT NEW 100mm SIDEWALK c/w PAVING STONE BAND (SEE DETAIL 1)
 4. RENEW EXISTING MONOLITHIC CURB RAMP (10mm HT. INTEGRAL)
 5. CONSTRUCT NEW MODIFIED BARRIER CURB (150mm AVG. HT. REVEAL SEPARATE)
 6. REMOVE EXISTING BARRIER CURB
 7. RENEW EXISTING BARRIER CURB (100mm AVG. HT. REVEAL)
 8. ADJUST EXISTING CATCH BASIN/MANHOLE TO GRADE
 9. REMOVE EXISTING FRAME AND COVER AND PLACE NEW FRAME AND COVER (AP-004 AND AP-005)
 10. INSTALL NEW CAST IRON RISER RING
 11. INSTALL NEW DETECTABLE SURFACE WARNING TILES
 12. ADJUST MTS MANHOLE FRAME AND COVER C/W 50mm CAST IRON RISER RING
 13. ADJUST SIGNAL SERVICE BOX
 14. ADJUST EXISTING CURB STOP TO GRADE
 15. INSTALL VALVE BOX EXTENSION
 16. REMOVE EXISTING CATCHBASIN
 17. INSTALL NEW CURB AND GUTTER INLET c/w CATCHPI (SD-023) AND CONNECT TO EXISTING LEAD
 18. INSTALL NEW CURB AND GUTTER INLET c/w CATCHBASIN (SD-024) AND CONNECT TO EXISTING LEAD
 19. REMOVE EXISTING CURB INLET
 20. REMOVE AND REINSTALL PAVERS

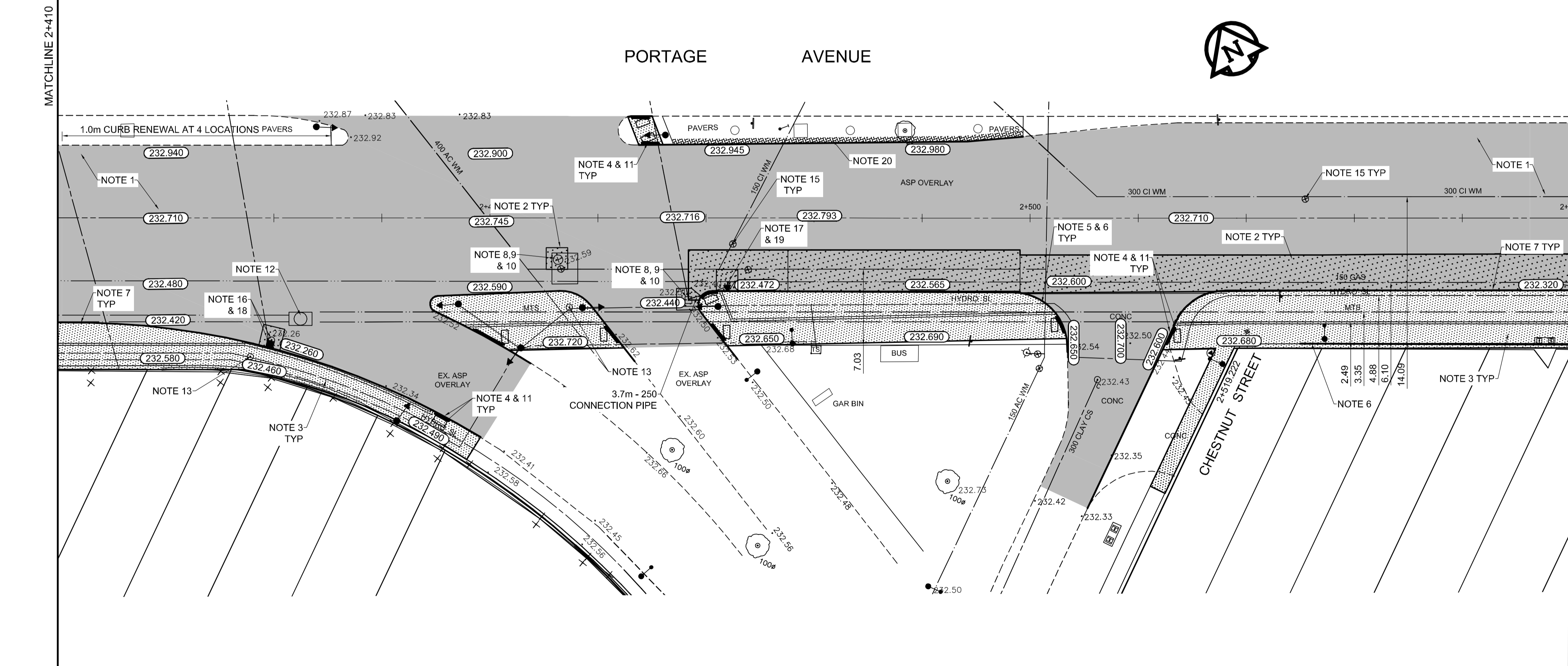

EXISTING	LEGEND - PLAN	PROPOSED	EXISTING	LEGEND - PLAN	PROPOSED	EXISTING	LEGEND - PROFILE	PROPOSED
150 mm W.M.	WATERMAIN	150 mm W.M.	---	HYDRO	---	x	C PROFILE	---
Hydrant	HYDRANT	Hydrant	---	M.T.S.	---	o	SOUTH/EAST GUTTER	---
Valve	VALVE	Valve	---	CONCRETE	---	o	MEDIAN GUTTER	---
300mm L.D.S.	LAND DRAINAGE SEWER	300mm L.D.S.	---	ASPHALT	---	o	N/W PROPERTY LINE	---
250mm W.W.S.	WASTEWATER SEWER	250mm W.W.S.	---	PROPERTY LINE	---	o	S/E PROPERTY LINE	---
Manhole	MANHOLE	Manhole	---	SURVEY BAR	---	o		---
Catch Basin	CATCH BASIN	Catch Basin	---	ELEVATION	(35.750)	o		---
Curb Inlet	CURB INLET	Curb Inlet	---	TREE	---	o		---
Building Outline	BUILDING OUTLINE	Building Outline	---	SIDEWALK RAMP	---	o		---
Culvert	CULVERT	Culvert	---	CONCRETE SIDEWALK	---	o		---
Gas	GAS	Gas	---	FENCE	---	o		---

LOCATION APPROVED UNDERGROUND STRUCTURES

SUPV. U/G STRUCTURES COMMITTEE DATE

NOTE:
LOCATION OF UNDERGROUND STRUCTURES AS SHOWN ARE BASED ON THE BEST INFORMATION AVAILABLE, BUT NO GUARANTEE IS GIVEN THAT ALL EXISTING UTILITIES ARE SHOWN OR THAT THE GIVEN LOCATIONS ARE EXACT. CONFIRMATION OF EXISTENCE AND EXACT LOCATION OF ALL SERVICES MUST BE OBTAINED FROM THE INDIVIDUAL UTILITIES BEFORE PROCEEDING WITH CONSTRUCTION.

B.M. 89R581
ELEV. 232.540
S.W. corner Portage Ave. & Sprague St., Tbl. on pipe, 4.8m E. of W.L. Sprague St. produced from the W. along the S.L. of Portage Ave.

AECOM

DESIGNED BY: BC
CHECKED BY: KWR

DRAWN BY: RT, PB
APPROVED BY:

HOR. SCALE: 1:250
VERTICAL: 1:10

RELEASED FOR CONSTRUCTION BY:

0 ISSUED FOR TENDER
NO. REVISIONS

2014/06/26 KWR
DATE BY

2014/06/26
DATE

ENGINEER'S SEAL

PROVINCE OF MANITOBA
ORIGINAL SIGNED BY
K.W. RAE
06/26/2014
REGISTERED PROFESSIONAL ENGINEER

CONSULTANT DRAWING NO.
CT-09

METRIC
WHOLE NUMBERS INDICATE MILLIMETRES
DECIMALIZED NUMBERS INDICATE METRES

THE CITY OF WINNIPEG
PUBLIC WORKS DEPARTMENT
ENGINEERING DIVISION

PORTAGE AVENUE REHABILITATION:
PART A- EASTBOUND FROM SHERBURN ST. TO MARYLAND ST.
PART B- WESTBOUND FROM EMPRESS ST. TO MINTO ST.

PLAN / PROFILE PART A
STATION 2+410 TO STATION 2+550

CITY DRAWING NUMBER
P-3359-09
SHEET 9 OF 21