

MATCHLINE 2+270

MATCHLINE 2+410

EASTBOUND

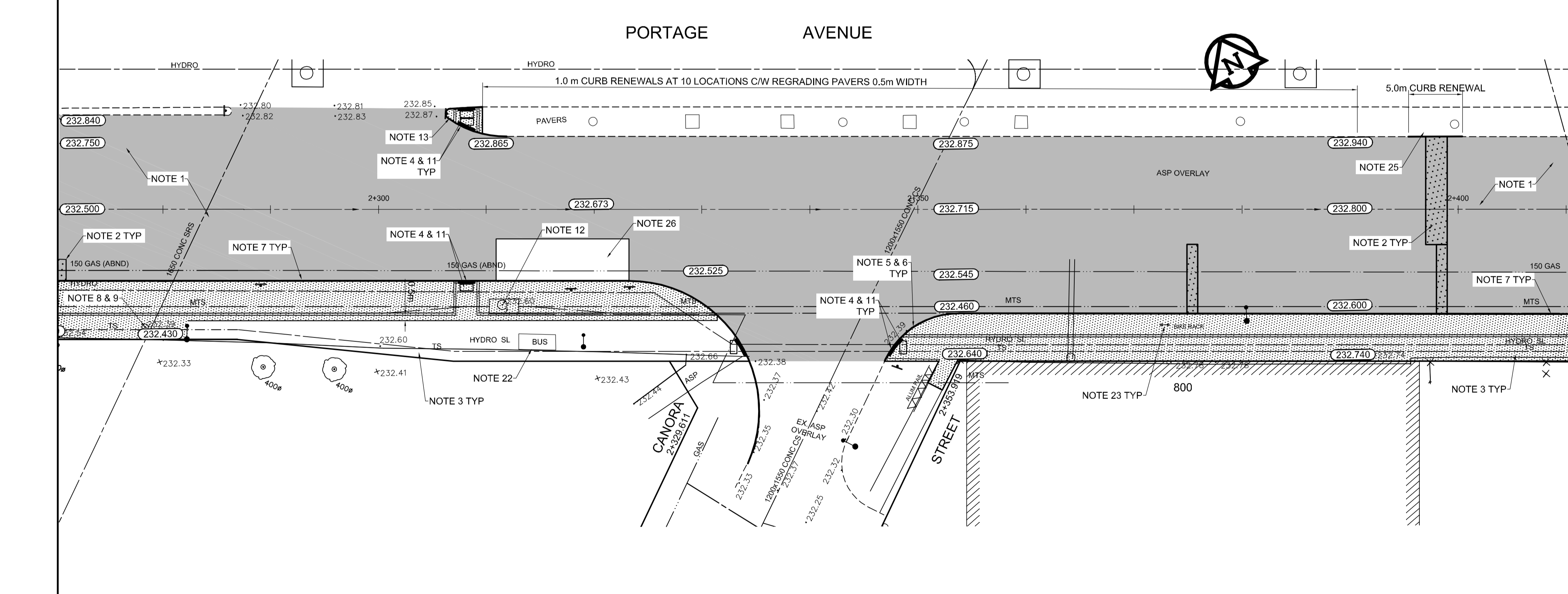

- REFERENCE NOTES**
- PAVEMENT DIMENSIONS ARE TO BACK OF CURB
 - BASELINE IS 12.0M NORTH OF SOUTH PROPERTY LINE
 - PROPERTY LINES OBTAINED FROM THE CITY OF WINNIPEG L.B.I.S., AND NO SCALE FACTOR WAS APPLIED
 - REFER TO AECOM FIELD BOOK NO. 4821, 4822 & 4823

- CONSTRUCTION NOTES:**
- PLANE EXISTING ASPHALT AND CONSTRUCT NEW ASPHALTIC PAVEMENT OVERLAY TYPE 1A (AVERAGE THICKNESS 85mm)
 - REMOVE EXISTING PAVEMENT AND CONSTRUCT NEW 200mm REINFORCED CONCRETE PAVEMENT c/w 85mm TYPE 1A ASPHALT OVERLAY
 - REMOVE EXISTING CONCRETE SIDEWALK AND CONSTRUCT NEW 100mm SIDEWALK c/w PAVING STONE BAND (SEE DETAIL 1)
 - RENEW EXISTING MONOLITHIC CURB RAMP (10mm HT. INTEGRAL)
 - CONSTRUCT NEW MODIFIED BARRIER CURB (150mm AVG. HT. REVEAL SEPARATE)
 - REMOVE EXISTING BARRIER CURB
 - RENEW EXISTING BARRIER CURB (100mm AVG. HT. REVEAL)
 - ADJUST EXISTING CATCH BASIN/MANHOLE TO GRADE
 - REMOVE EXISTING FRAME AND COVER AND PLACE NEW FRAME AND COVER (AP-004 AND AP-005)
 - INSTALL NEW CAST IRON RISER RING
 - INSTALL NEW DETECTABLE SURFACE WARNING TILES
 - ADJUST MTS MANHOLE FRAME AND COVER
 - CONSTRUCT MONOLITHIC CONCRETE BULLNOSE
 - ADJUST EXISTING CURB STOP TO GRADE
 - INSTALL VALVE BOX EXTENTION
 - REMOVE EXISTING CATCHBASIN AND CURB INLET
 - INSTALL NEW CURB AND GUTTER INLET c/w CATCHBASIN (SD-024) AND CONNECT TO EXISTING LEAD
 - REGRADE EXISTING PAVING STONES
 - REMOVE EXISTING TREE WELL
 - REMOVE AND INSTALL EXISTING BENCH (BY OTHERS)
 - REMOVE AND INSTALL EXISTING GARBAGE BIN (BY OTHERS)
 - REMOVE AND INSTALL EXISTING BUS SHELTER (BY OTHERS)
 - REMOVE AND INSTALL EXISTING BIKE RACK
 - INSTALL PAVING STONE (SEE DETAIL 2)
 - REMOVE AND REINSTALL PAVERS
 - EXISTING CONCRETE SLABS, MATCH GRADE

150 mm W.M.	WATERMAIN	150 mm W.M.	HYDRO	C PROFILE	LOCATION APPROVED	B.M. 89R581				THE CITY OF WINNIPEG PUBLIC WORKS DEPARTMENT ENGINEERING DIVISION	PORTAGE AVENUE REHABILITATION: PART A- EASTBOUND FROM SHERBURN ST. TO MARYLAND ST. PART B- WESTBOUND FROM EMPRESS ST. TO MINTO ST.	CITY DRAWING NUMBER P-3359-08 SHEET 8 OF 21
300mm L.D.S.	LAND DRAINAGE SEWER	300mm L.D.S.	CONCRETE	SOUTH/EAST GUTTER	UNDERGROUND STRUCTURES	ELEV. 232.540						
250mm W.W.S.	WASTEWATER SEWER	250mm W.W.S.	ASPHALT	MEDIAN GUTTER			DESIGNED BY BC	CHECKED BY KWR	PLANNING	PLAN / PROFILE PART A		
	MANHOLE		PROPERTY LINE	N/W PROPERTY LINE			DRAWN BY RT, PB	APPROVED BY	CONSTRUCTION	STATION 2+270 TO STATION 2+410		
	CATCH BASIN		SURVEY BAR	S/E PROPERTY LINE			HOR. SCALE: 1:250	RELEASED FOR CONSTRUCTION BY:				
	CURB INLET		ELEVATION (35.750)				VERTICAL: 1:10					
	BUILDING OUTLINE		TREE									
	CULVERT		SIDEWALK RAMP									
	GAS		CONCRETE SIDEWALK									
EXISTING	LEGEND - PLAN	PROPOSED	FENCE									
			LEGEND - PLAN	PROPOSED	EXISTING	LEGEND - PROFILE	PROPOSED					

NOTE: LOCATION OF UNDERGROUND STRUCTURES AS SHOWN ARE BASED ON THE BEST INFORMATION AVAILABLE, BUT NO GUARANTEE IS GIVEN THAT ALL EXISTING UTILITIES ARE SHOWN OR THAT THE GIVEN LOCATIONS ARE EXACT. CONFIRMATION OF EXISTENCE AND EXACT LOCATION OF ALL SERVICES MUST BE OBTAINED FROM THE INDIVIDUAL UTILITIES BEFORE PROCEEDING WITH CONSTRUCTION.

0 ISSUED FOR TENDER 2014/06/26 KWR

NO. REVISIONS DATE BY

CONSULTANT DRAWING NO. CT-08