

DWG NORTH

REMOVE CATCHBASIN & ABANDON INLETS  
 PLUG CATCHBASIN LEAD  
 INSTALL NEW CATCHBASIN (SD-024)  
 C/W 2.5 OF 250 CB LEAD  
 RIM 34.010  
 INV 32.360, BOT 31.760  
 NOTE:  
 OMIT SECOND INLET IF POSSIBLE  
 (DETERMINE IN FIELD)

- CONSTRUCTION NOTES:**
1. LOCATION OF ALL SEWER AND WATER LINES TO BE CONFIRMED IN THE FIELD.
  2. SEWER AND WATER SERVICES SHOWN ON DRAWINGS ARE APPROXIMATE ONLY.
  3. INSTALL NEW SEWER AND CATCHBASIN LEADS BY TRENCHLESS METHODS, UNLESS NOTED OTHERWISE.

- GENERAL NOTES:**
1. CHAINAGE IS ALONG WEST LIMIT OF BROOKLYN STREET.
  2. STATION 6+00 = SOUTH LIMIT OF NESS AVENUE.
  3. SEE SPECIFICATIONS FOR DETAILED TEST HOLE INFORMATION.

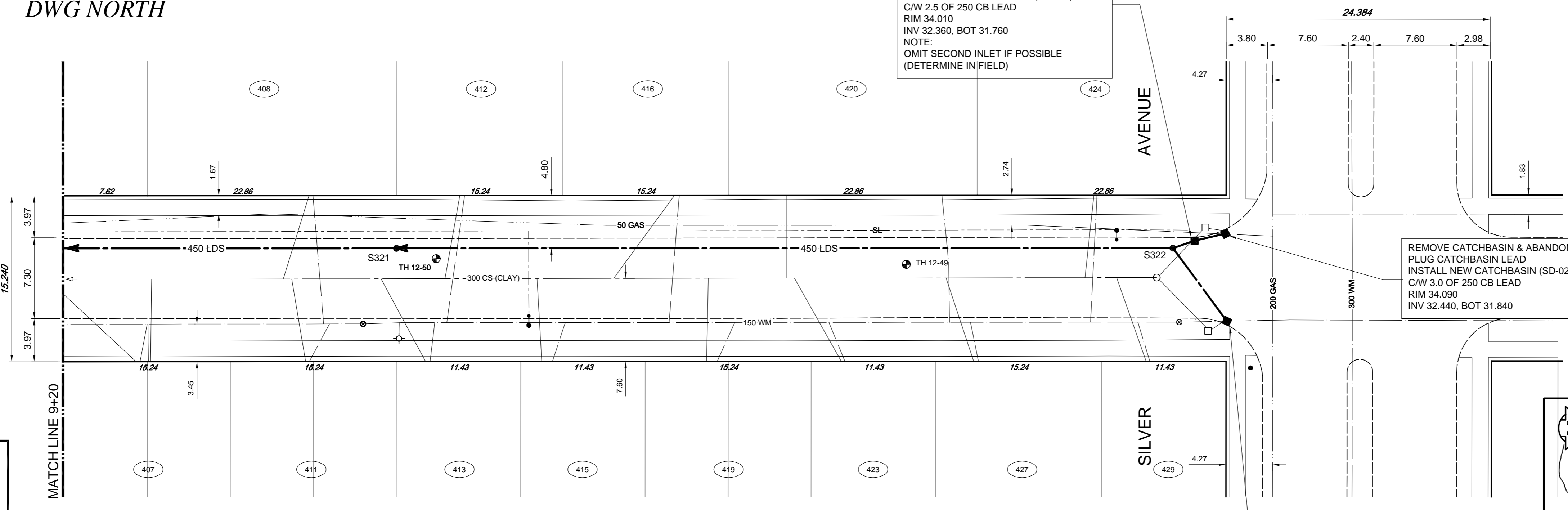

REMOVE CATCHBASIN & ABANDON INLETS  
 PLUG CATCHBASIN LEAD  
 INSTALL NEW CATCHBASIN (SD-024)  
 C/W 3.0 OF 250 CB LEAD  
 RIM 34.080  
 INV 32.440, BOT 31.840

REMOVE CATCHBASIN & ABANDON INLETS  
 PLUG CATCHBASIN LEAD  
 INSTALL NEW CATCHBASIN (SD-024)  
 C/W 8.5 OF 250 CB LEAD  
 RIM 34.030  
 INV 32.380, BOT 31.780

**APEGM**  
 Certificate of Authorization  
**TETRA TECH WEI Inc.**  
 No. 5313 Date: April 30, 2014

**WARNING**  
 IF POWER EQUIPMENT OR EXPLOSIVES ARE TO BE USED FOR EXCAVATION ON THIS PROJECT THE CONTRACTOR MUST:  
 1. NOTIFY THE GAS COMPANY OF THE PROPOSED LOCATION OF EXCAVATION.  
 2. TAKE PRECAUTION TO AVOID DAMAGE TO GAS COMPANY INSTALLATIONS. SEE PROVINCIAL REGULATION 1409/2 FOR DETAILS.

**BROOKLYN STREET**

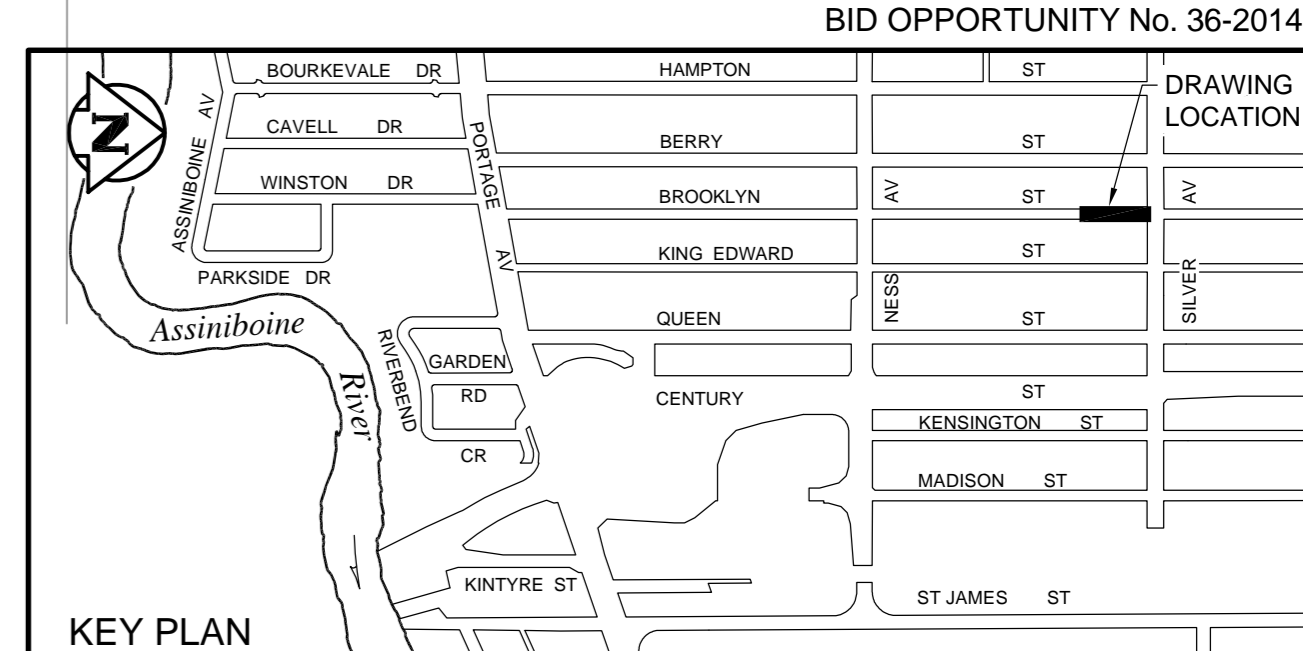

EXISTING	LEGEND-PLAN	PROPOSED	EXISTING	LEGEND-PLAN	PROPOSED	EXISTING	LEGEND-PLAN	PROPOSED
150 WM	WATERMAIN	150 WM	ANCHOR	ANCHOR	ANCHOR	400 FM	FEEDERMAIN	400 FM
300 LDS	LAND DRAINAGE SEWER	300 LDS	TREE	TREE	TREE	250 WWS	WASTEWATER SEWER	250 WWS
300 CS	COMBINED SEWER	300 CS	LEGAL DIMENSION	LEGAL DIMENSION	LEGAL DIMENSION	200 FCM	FORCEMAIN	200 FCM
200 FCM	FORCEMAIN	200 FCM	SURVEY BAR	SURVEY BAR	SURVEY BAR		JUNCTIONS	JUNCTIONS
	HYDRANT	HYDRANT	TRAFFIC SIGNAL	TRAFFIC SIGNAL	TRAFFIC SIGNAL		HYDRANT	HYDRANT
	VALVE	VALVE	GAS	GAS	GAS		VALVE	VALVE
	REDUCER	REDUCER	HYDRO	HYDRO	HYDRO		REDUCER	REDUCER
			MTS	MTS	MTS			
			SIDEWALK	SIDEWALK	SIDEWALK			
			CURB	CURB	CURB			

**LOCATION APPROVED UNDERGROUND STRUCTURES**

SUPV. U/G STRUCTURES COMMITTEE DATE

NOTE:  
 LOCATION OF UNDERGROUND STRUCTURES AS SHOWN ARE BASED ON THE BEST INFORMATION AVAILABLE. BUT NO GUARANTEE IS GIVEN THAT ALL EXISTING UTILITIES ARE SHOWN OR THAT THE GIVEN LOCATIONS ARE EXACT. CONFIRMATION OF EXISTENCE AND EXACT LOCATION OF ALL SERVICES MUST BE OBTAINED FROM THE INDIVIDUAL UTILITIES BEFORE PROCEEDING WITH CONSTRUCTION.

NO.	REVISIONS	DATE	BY
01	ISSUED FOR TENDER	14.01.28	KJM
00	ISSUED FOR APPROVAL	14.01.27	KJM

**TETRA TECH**

DESIGNED BY: KJM, GWC  
 CHECKED BY: BLM  
 DRAWN BY: NL  
 APPROVED BY: GS

HOR. SCALE: 1 : 250  
 VERTICAL: 1 : 50

RELEASED FOR CONSTRUCTION

DATE: 13.09.24

ORIGINAL DRAWING REVISION "00" SEALED BY  
**K.J. McRAE**  
 14.01.27

CONSULTANT DRAWING NO.  
 1000120300-DWG-C0141

**THE CITY OF WINNIPEG**  
 WATER AND WASTE DEPARTMENT

FERRY ROAD AND RIVERBEND  
 COMBINED SEWER RELIEF WORKS  
 CONTRACT 3

**BROOKLYN STREET**  
 107m SOUTH OF SILVER AVENUE TO  
 SILVER AVENUE

CITY DRAWING NUMBER  
 10677

SHEET 14 OF 14

C0314

BID OPPORTUNITY No. 36-2014

DRAWING LOCATION