

DWG NORTH

REMOVE CATCHBASIN & ABANDON INLETS
 PLUG CATCHBASIN LEAD
 INSTALL NEW CATCHBASIN (SD-024)
 C/W 2.0 OF 250 CB LEAD
 RIM 35.330
 INV 33.680, BOT 33.080

INSTALL NEW MH & CONNECT TO EX CB
 LEAD EAST
 PLUG AND ABANDON EX LEAD EAST
 *SIZE & INV ELEVATION TO BE CONFIRMED
 IN FIELD. PRIOR TO CONSTRUCTION

INSTALL NEW MH & CONNECT TO EX CB
 LEAD EAST
 PLUG AND ABANDON EX LEAD WEST
 *SIZE & INV ELEVATION TO BE CONFIRMED
 IN FIELD. PRIOR TO CONSTRUCTION

REMOVE CATCHBASIN & ABANDON INLETS
 PLUG CATCHBASIN LEAD
 INSTALL NEW CATCHBASIN (SD-024)
 C/W 6.0 OF 250 CB LEAD
 RIM 35.320
 INV 33.670, BOT 33.070

CONSTRUCTION NOTES:

1. LOCATION OF ALL SEWER AND WATER LINES TO BE CONFIRMED IN THE FIELD.
2. SEWER AND WATER SERVICES SHOWN ON DRAWINGS ARE APPROXIMATE ONLY.
3. INSTALL NEW SEWER AND CATCHBASIN LEADS BY TRENCHLESS METHODS, UNLESS NOTED OTHERWISE.

GENERAL NOTES:

1. CHAINAGE IS ALONG WEST LIMIT OF BROOKLYN STREET.
2. STATION 6+00 = SOUTH LIMIT OF NESS AVENUE.
3. SEE SPECIFICATIONS FOR DETAILED TEST HOLE INFORMATION.

SEE DRAWING C0309

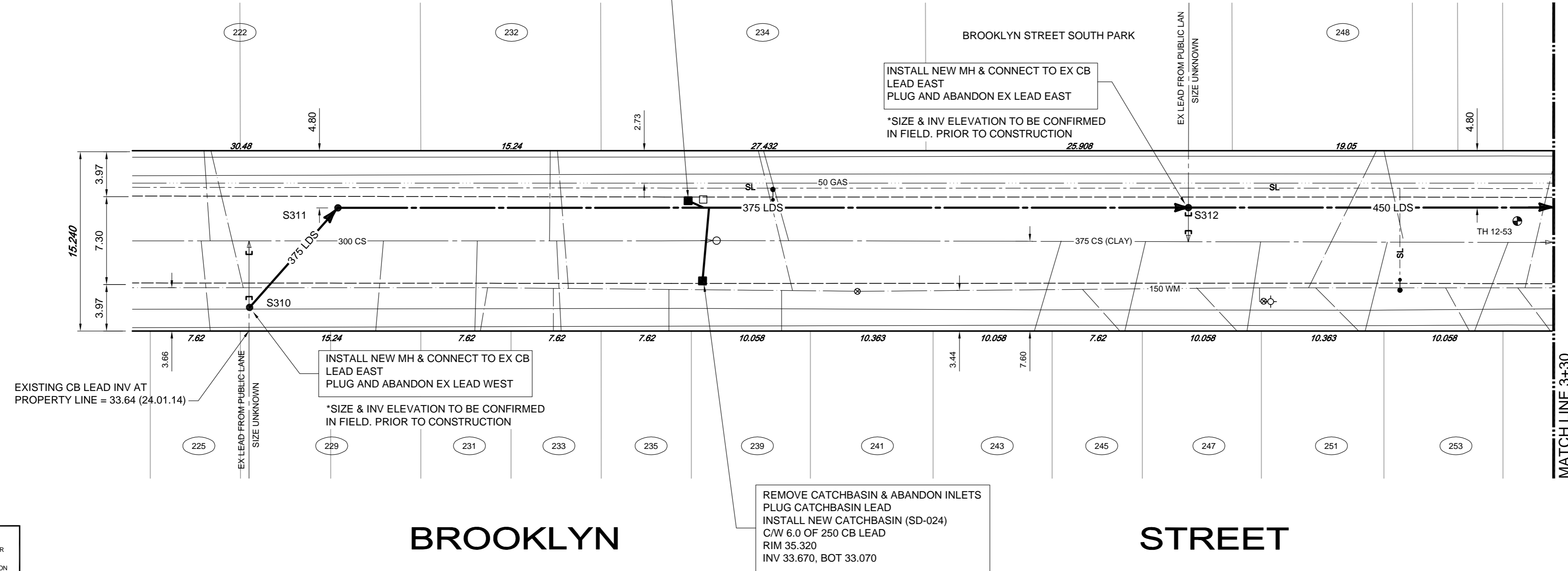

APEGM
 Certificate of Authorization
TETRA TECH WEI Inc.
 No. 5313 Date: April 30, 2014

WARNING
 IF POWER EQUIPMENT OR EXPLOSIVES ARE TO BE USED FOR EXCAVATION ON THIS PROJECT THE CONTRACTOR MUST:
 1. NOTIFY THE GAS COMPANY OF THE PROPOSED LOCATION OF EXCAVATION.
 2. TAKE PRECAUTION TO AVOID DAMAGE TO GAS COMPANY INSTALLATIONS. SEE PROVINCIAL REGULATION 140/92 FOR DETAILS.

EXISTING	LEGEND-PLAN	PROPOSED	EXISTING	LEGEND-PLAN	PROPOSED	EXISTING	LEGEND-PLAN	PROPOSED
150 WM	WATERMAIN	150 WM	ANCHOR	ANCHOR	ANCHOR	LOCATION APPROVED UNDERGROUND STRUCTURES	LOCATION APPROVED UNDERGROUND STRUCTURES	LOCATION APPROVED UNDERGROUND STRUCTURES
400 FM	FEEDERMAIN	400 FM	TREE	TREE	TREE			
300 LDS	LAND DRAINAGE SEWER	300 LDS	LEGAL DIMENSION	LEGAL DIMENSION	LEGAL DIMENSION			
250 WWS	WASTEWATER SEWER	250 WWS	SURVEY BAR	SURVEY BAR	SURVEY BAR			
300 CS	COMBINED SEWER	300 CS	TRAFFIC SIGNAL	TRAFFIC SIGNAL	TRAFFIC SIGNAL			
200 FCM	FORCEMAIN	200 FCM	GAS	GAS	GAS			
	JUNCTIONS		HYDRO	HYDRO	HYDRO			
	HYDRANT		MTS	MTS	MTS			
	VALVE		SIDEWALK	SIDEWALK	SIDEWALK			
	REDUCER		CURB	CURB	CURB			

LOCATION APPROVED UNDERGROUND STRUCTURES
 SUPV. U/G STRUCTURES COMMITTEE DATE
 NOTE:
 LOCATION OF UNDERGROUND STRUCTURES AS SHOWN ARE BASED ON THE BEST INFORMATION AVAILABLE. BUT NO GUARANTEE IS GIVEN THAT ALL EXISTING UTILITIES ARE SHOWN OR THAT THE GIVEN LOCATIONS ARE EXACT. CONFIRMATION OF EXISTENCE AND EXACT LOCATION OF ALL SERVICES MUST BE OBTAINED FROM THE INDIVIDUAL UTILITIES BEFORE PROCEEDING WITH CONSTRUCTION.

NO.	REVISIONS	DATE	BY
01	ISSUED FOR TENDER	14.01.28	KJM
00	ISSUED FOR APPROVAL	14.01.27	KJM

TETRA TECH

DESIGNED BY: KJM, GWC
 CHECKED BY: BLM
 DRAWN BY: NL
 APPROVED BY: GS
 HOR. SCALE: 1 : 250
 VERTICAL: 1 : 50
 RELEASED FOR CONSTRUCTION
 DATE: 13.09.24

ORIGINAL DRAWING REVISION "00" SEALED BY
K.J. McRAE
 14.01.27

THE CITY OF WINNIPEG
 WATER AND WASTE DEPARTMENT

FERRY ROAD AND RIVERBEND
 COMBINED SEWER RELIEF WORKS
 CONTRACT 3

BROOKLYN STREET
 125m NORTH OF PORTAGE AVENUE TO
 245m NORTH OF PORTAGE AVENUE

CITY DRAWING NUMBER: 10671
 SHEET: 8 OF 14
 C0308

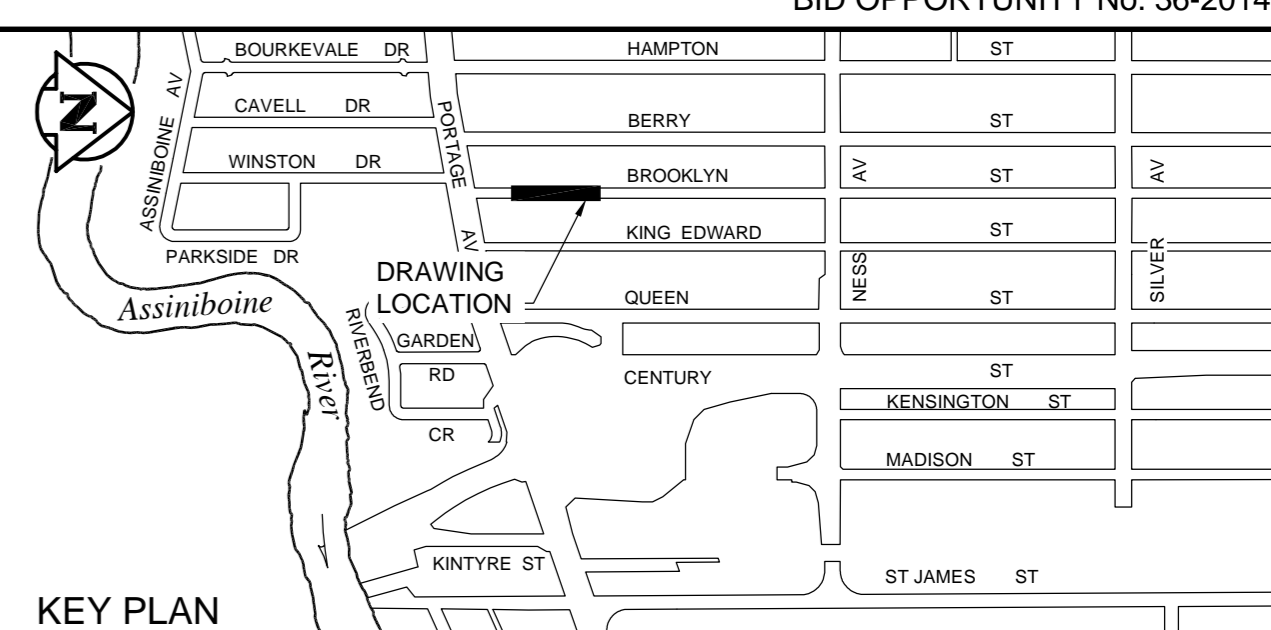

BID OPPORTUNITY No. 36-2014