

DWG NORTH

ABANDON INLET & CATCHBASIN
 PLUG CATCHBASIN LEAD
 INSTALL NEW CATCHBASIN (SD-024)
 C/W 2.5 OF 250 CB LEAD AT 2%
 RIM 35.720
 INV 34.070, BOT 33.470

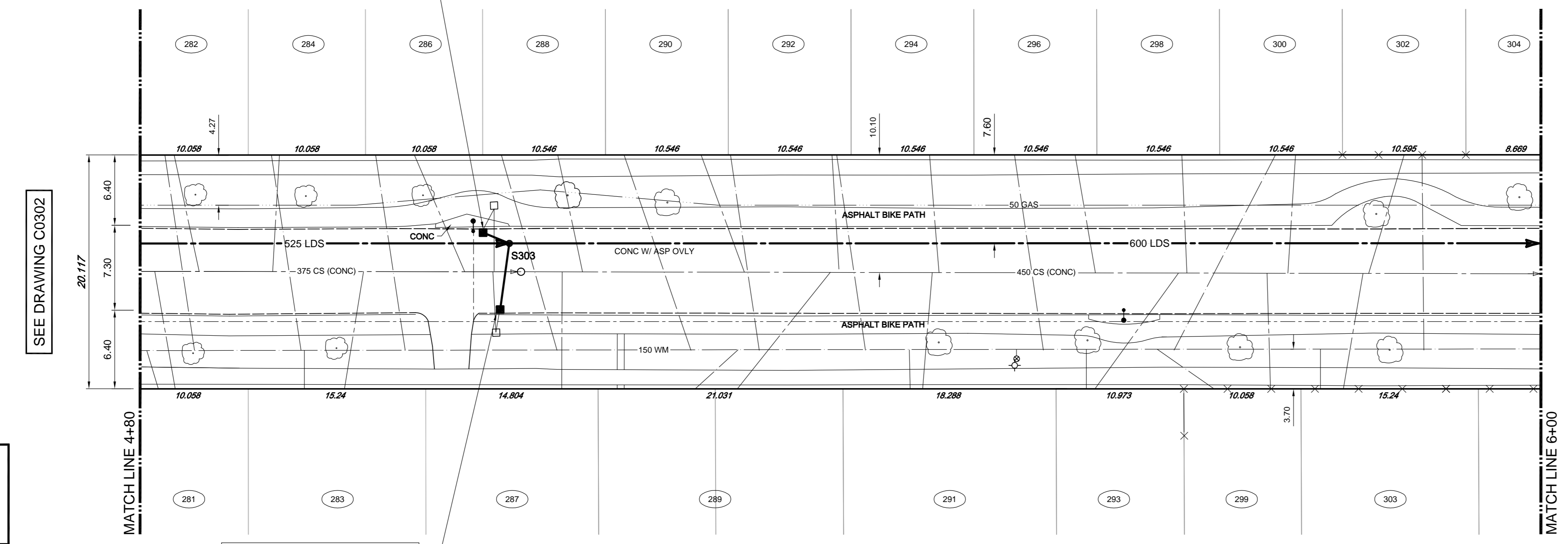

SEE DRAWING C0302

SEE DRAWING C0304

- CONSTRUCTION NOTES:**
1. LOCATION OF ALL SEWER AND WATER LINES TO BE CONFIRMED IN THE FIELD.
 2. SEWER AND WATER SERVICES SHOWN ON DRAWINGS ARE APPROXIMATE ONLY.
 3. INSTALL NEW SEWER AND CATCHBASIN LEADS BY TRENCHLESS METHODS, UNLESS NOTED OTHERWISE.

- GENERAL NOTES:**
1. CHAINAGE IS ALONG WEST LIMIT OF BERRY STREET.
 2. STATION 1+00 = NORTH LIMIT OF PORTAGE AVENUE AND WEST LIMIT OF BERRY STREET.
 3. SEE SPECIFICATIONS FOR DETAILED TEST HOLE INFORMATION.

APEGM
 Certificate of Authorization
TETRA TECH WEI Inc.
 No. 5313 Date: April 30, 2014

WARNING
 IF POWER EQUIPMENT OR EXPLOSIVES ARE TO BE USED FOR EXCAVATION ON THIS PROJECT THE CONTRACTOR MUST:
 1. NOTIFY THE GAS COMPANY OF THE PROPOSED LOCATION OF EXCAVATION.
 2. TAKE PRECAUTION TO AVOID DAMAGE TO GAS COMPANY INSTALLATIONS. SEE PROVINCIAL REGULATION 140/92 FOR DETAILS.

ABANDON INLET & CATCHBASIN
 PLUG CATCHBASIN LEAD
 INSTALL NEW CATCHBASIN (SD-024)
 C/W 6.0 OF 250 CB LEAD AT 2%
 RIM 35.730
 INV 34.080, BOT 33.480

BERRY STREET



EXISTING	LEGEND-PLAN	PROPOSED	EXISTING	LEGEND-PLAN	PROPOSED	EXISTING	LEGEND-PLAN	PROPOSED
150 WM	WATERMAIN	150 WM	ANCHOR	ANCHOR	ANCHOR	15.240	LEGAL DIMENSION	LEGAL DIMENSION
400 FM	FEEDERMAIN	400 FM	TREE	TREE	TREE		SURVEY BAR	SURVEY BAR
300 LDS	LAND DRAINAGE SEWER	300 LDS					TRAFFIC SIGNAL	TRAFFIC SIGNAL
250 WWS	WASTEWATER SEWER	250 WWS					GAS	GAS
300 CS	COMBINED SEWER	300 CS					HYDRO	HYDRO
200 FCM	FORCEMAIN	200 FCM					MTS	MTS
	JUNCTIONS						SIDEWALK	SIDEWALK
	HYDRANT						CURB	CURB
	VALVE							
	REDUCER							

LOCATION APPROVED UNDERGROUND STRUCTURES

SUPV. U/G STRUCTURES COMMITTEE DATE

NOTE:
 LOCATION OF UNDERGROUND STRUCTURES AS SHOWN ARE BASED ON THE BEST INFORMATION AVAILABLE. BUT NO GUARANTEE IS GIVEN THAT ALL EXISTING UTILITIES ARE SHOWN OR THAT THE GIVEN LOCATIONS ARE EXACT. CONFIRMATION OF EXISTENCE AND EXACT LOCATION OF ALL SERVICES MUST BE OBTAINED FROM THE INDIVIDUAL UTILITIES BEFORE PROCEEDING WITH CONSTRUCTION.

NO.	REVISIONS	DATE	BY
01	ISSUED FOR TENDER	14.01.28	KJM
00	ISSUED FOR APPROVAL	14.01.27	KJM

TETRA TECH

DESIGNED BY: KJM, GWC
 CHECKED BY: BLM
 DRAWN BY: GMD
 APPROVED BY: GS

HOR. SCALE: 1 : 250
 VERTICAL: 1 : 50

RELEASED FOR CONSTRUCTION

ORIGINAL DRAWING REVISION "00" SEALED BY
K.J. McRAE
 14.01.27

CONSULTANT DRAWING NO.
 1000120300-DWG-C0129

THE CITY OF WINNIPEG
 WATER AND WASTE DEPARTMENT

FERRY ROAD AND RIVERBEND
 COMBINED SEWER RELIEF WORKS
 CONTRACT 3

BERRY STREET
 150m SOUTH OF NESS AVENUE TO
 30m SOUTH OF NESS AVENUE

CITY DRAWING NUMBER
 10666

SHEET 3 OF 14

C0303

BID OPPORTUNITY No. 36-2014