

**WATER SERVICE INFORMATION**

ADDRESS	SIZE (mm) MATERIAL (STREET)	SIZE (mm) MATERIAL (PROP.)	SHORT & LONG MEASUREMENT	CORPORATION LOCATION	REMARKS
326 MELROSE AV W	-	-	0.5 W E HSE LINE		
RESIDENTIAL			11.7 FROM HSE FRONT		
327 MELROSE AV W	20	12	2.4 W E HSE LINE	1.83 W E HSE LINE	
RESIDENTIAL	CU	LEAD	6.4 FR. HSE. FRT.		
328 MELROSE AV W	-	20	3.4 W E HSE LINE		
RESIDENTIAL	-	CU	6.3 FROM HSE FRONT		
329 MELROSE AV W	20	12	1.4 E W HSE LINE	0.30 E S/C	
RESIDENTIAL	-	-	-		
330 MELROSE AV W	-	-	0.3 W E HSE LINE		
RESIDENTIAL	-	-	5.9 FROM HSE FRONT		
332 MELROSE AV W	-	-	1.0 E E HSE LINE		
RESIDENTIAL	-	-	6.1 FROM HSE FRON		
333 MELROSE AV W	-	16	1.4 W E HSE LINE		
RESIDENTIAL	-	LEAD	3.8 FROM HSE FRONT		
334 MELROSE AV W	20	12	2.4 W E HSE LINE	8.23 W S/C	
RESIDENTIAL	CU	LEAD	4.0 OUT FROM BLDG		
335 MELROSE AV W	-	-	1.2 W W HSE LINE	1.22 W W HSE LINE	
RESIDENTIAL	-	-	7.1 FROM HSE FRONT		
338 MELROSE AV W	-	16	0.3 E W HSE LINE		
RESIDENTIAL	-	LEAD	6.2 FROM HSE FRONT		
339 MELROSE AV W	-	-	1.2 E W HSE LINE		
RESIDENTIAL	-	-	5.9 FROM HSE FRONT		
340 MELROSE AV W	16	16	0.9 E W HSE LINE	1.52 W S/C	RENEW TO PROPERTY
RESIDENTIAL	LEAD	LEAD	4.0 FROM HSE FRONT		
341 MELROSE AV W	20	16	0.2 W W HSE LINE	0.61 W S/C	
RESIDENTIAL	CU	LEAD	6.4 FROM HSE FRONT		
342 MELROSE AV W	-	-	1.4 E W HSE LINE		
RESIDENTIAL	-	-	5.9 FROM HSE FRONT		
343 MELROSE AV W	20	20	1.8 E W HSE LINE	42.49 W HYD @ #333	
RESIDENTIAL	CU	CU	6.2 OUT		
344 MELROSE AV W	20	12	3.2 W E HSE LINE	3.05 W S/C	
RESIDENTIAL	CU	LEAD	0.3 STREET LINE		
345 MELROSE AV W	-	20	2.4 E W HSE LINE		
RESIDENTIAL	-	CU	6.4 OUT		
346 MELROSE AV W	-	-	1.2 W W HSE LINE	0.61 W S/C	
RESIDENTIAL	-	-	0.3 STREET LINE		
347 MELROSE AV W	-	16	4.0 E W HSE LINE		
RESIDENTIAL	-	LEAD	3.2 FROM HSE FRONT		
348 MELROSE AV W	-	16	3.9 E W LOTLINE		
RESIDENTIAL	-	LEAD	6.1 OUT		
349 MELROSE AV W	20	12	2.4 E W HSE LINE	2.44 E W HSE LINE	
RESIDENTIAL	CU	LEAD	5.8 OUT		
352 MELROSE AV W	20	16	0.9 W W HSE LINE	3.66 W W LOTLINE	
RESIDENTIAL	CU	LEAD	6.2 FROM HSE FRONT		
353 MELROSE AV W	20	12	0.1 E W LOTLINE	4.88 W W LOTLINE	
RESIDENTIAL	CU	HDPE	5.2 OUT		

NOTE: CHAINAGES SHOWN ARE ALONG N. P. OF MELROSE AVE WEST

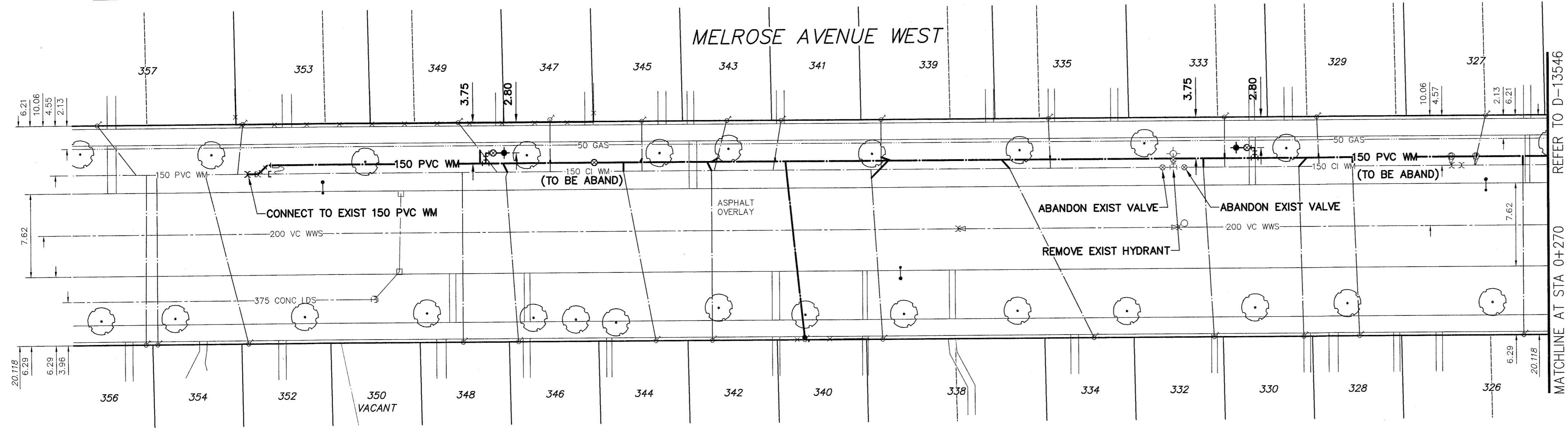

NOTE: REPLACE ALL EXISTING LEAD SERVICES FROM THE PROPOSED WATERMAIN TO PROPERTY LINE. RECONNECT ALL OTHER SERVICES UNLESS NOTED. LOCATION OF WATER SERVICES SHOWN ON DRAWINGS ARE APPROXIMATE. THE CONTRACTOR SHALL FIELD LOCATE ALL WATER SERVICES PRIOR TO CONSTRUCTION.



ALL VALVES TO BE CLOCKWISE TO CLOSE (BLACK OPERATING NUT)

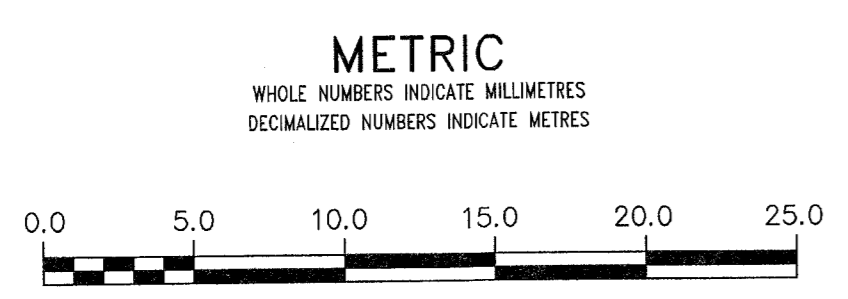

**WARNING**  
IF POWER EQUIPMENT OR EXPLOSIVES ARE TO BE USED FOR EXCAVATION ON THIS PROJECT THE CONTRACTOR MUST:  
1) NOTIFY THE GAS COMPANY OF THE PROPOSED LOCATION OF EXCAVATION.  
2) TAKE PRECAUTION TO AVOID DAMAGE TO GAS COMPANY INSTALLATIONS.  
SEE PROVINCIAL REGULATION 210/72 FOR DETAILS

**LOCATION APPROVED UNDERGROUND STRUCTURES**  
SUPV. U/G STRUCTURES COMMITTEE DATE  
NOTE: LOCATION OF UNDERGROUND STRUCTURES AS SHOWN ARE BASED ON THE BEST INFORMATION AVAILABLE BUT NO GUARANTEE IS GIVEN THAT ALL EXISTING UTILITIES ARE SHOWN OR THAT THE GIVEN LOCATIONS ARE EXACT CONFIRMATION OF EXISTENCE AND EXACT LOCATION OF ALL SERVICES MUST BE OBTAINED FROM THE INDIVIDUAL UTILITIES BEFORE PROCEEDING WITH CONSTRUCTION.

B.M. 30-034 87462 - S. side Pandora Ave. W. & Winona St. 101E on top of 0.09 m sq. x 2.4 m iron tube, 61 m E. of E. wall No. 301 Pandora Ave. W. & 5.7 m S. of C.L. Conc. Pavt. on Pandora Ave. W. or 4 m E. of W.L. Winona St. & 20.9 m S. of N.L. Pandora Ave. W.			
CONSTRUCTION COMPLETION DATE:			
NO.	ISSUED FOR TENDER	14/04/07	GSK
A	PRELIMINARY	14/03/28	GSK
NO.	REVISIONS	DATE	BY

**AECOM**

DESIGNED BY: GK  
DRAWN BY: JP  
SCALE: HORIZONTAL 1:250, VERTICAL 1:50  
CHECKED BY: [Signature]  
APPROVED BY: [Signature]  
RELEASED FOR CONSTRUCTION: [Signature]  
DATE: 2014 04 07

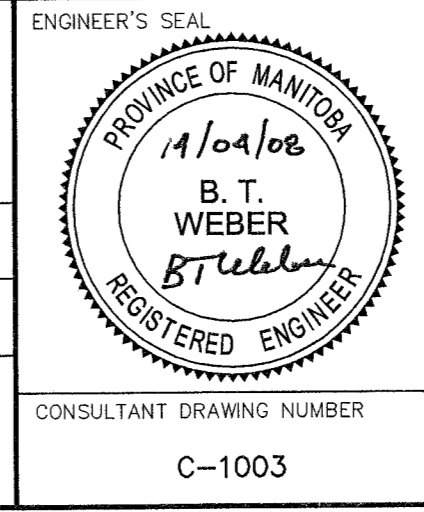

**THE CITY OF WINNIPEG**  
WATER AND WASTE DEPARTMENT  
ENGINEERING DIVISION

2014 WATER RENEWALS  
CONTRACT 1  
**MELROSE AVENUE WEST**  
34m EAST OF MADELINE STREET TO  
173m EAST OF MADELINE STREET

SHEET 4 OF 13  
CITY DRAWING NUMBER  
D-13545

CONSULTANT DRAWING NUMBER: C-1003